

United States Department of the Interior
National Park Service

NATIONAL REGISTER OF HISTORIC PLACES
REGISTRATION FORM

This form is for use in nominating or requesting determinations for individual properties and districts. See instructions in How to Complete the National Register of Historic Places Registration Form (National Register Bulletin 16A). Complete each item by marking "x" in the appropriate box or by entering the information requested. If any item does not apply to the property being documented, enter "N/A" for "not applicable." For functions, architectural classification, materials, and areas of significance, enter only categories and subcategories from the instructions. Place additional entries and narrative items on continuation sheets (NPS Form 10-900a). Use a typewriter, word processor, or computer, to complete all items.

1. Name of Property

historic name Vigilant Fire Company Firemen's Monument
other names/site number N/A

2. Location

street & number Union Cemetery, west side of PA Route 873, c 1/3 mile south of Slatington
city or town Washington Township not for publication N/A
state PA code PA county Lehigh code 077 vicinity N/A
zip code 18080

3. State/Federal Agency Certification

As the designated authority under the National Historic Preservation Act of 1986, as amended, I hereby certify that this x nomination request for determination of eligibility meets the documentation standards for registering properties in the National Register of Historic Places and meets the procedural and professional requirements set forth in 36 CFR Part 60. In my opinion, the property x meets does not meet the National Register Criteria. I recommend that this property be considered significant nationally statewide x locally. (See continuation sheet for additional comments.)

Andrew J. MacDonald July 1, 2004
Signature of certifying official Date

Pennsylvania Historical & Museum Commission
State or Federal agency and bureau

In my opinion, the property meets does not meet the National Register criteria. (See continuation sheet for additional comments.)

Signature of commenting or other official Date

State or Federal agency and bureau

4. National Park Service Certification

I, hereby certify that this property is:

entered in the National Register _____
(See continuation sheet).
 determined eligible for the _____
National Register
(See continuation sheet).
 determined not eligible for the _____
 removed from the National Register _____
 other (explain):

National Register

Signature of Keeper

Date of Action

5. Classification

Ownership of Property (Check as many boxes as apply)

- private
- public-local
- public-State
- public-Federal

Category of Property (Check only one box)

- building(s)
- district
- site
- structure
- object

Number of Resources within Property

Contributing	Noncontributing	
—	—	buildings
—	—	sites
—	—	structures
<u>1</u>	—	objects
<u>1</u>	<u>0</u>	Total

Number of contributing resources previously listed in the National Register 0

Name of related multiple property listing (Enter "N/A" if property is not part of a multiple property listing.) N/A

6. Function or Use

Historic Functions (Enter categories from instructions)

- Funerary/cemetery
- Recreation & Culture/monument

Current Functions (Enter categories from instructions)

Funerary/cemetery
Recreation & Culture/monument

7. Description

Architectural Classification (Enter categories from instructions)

No Style

Materials (Enter categories from instructions)

foundation
roof
walls
other stone/granite

Narrative Description (Describe the historic and current condition of the property on one or more continuation sheets.)

8. Statement of Significance

Applicable National Register Criteria (Mark "x" in one or more boxes for the criteria qualifying the property for National Register listing)

- A Property is associated with events that have made a significant contribution to the broad patterns of our history.
- B Property is associated with the lives of persons significant in our past.
- C Property embodies the distinctive characteristics of a type, period, or method of construction represents the work of a master, or possesses high artistic values, or represents a significant and distinguishable entity whose components lack individual distinction.
- D Property has yielded, or is likely to yield information important in prehistory or history.

Criteria Considerations (Mark "X" in all the boxes that apply.)

- A owned by a religious institution or used for religious purposes.
- B removed from its original location.
- C a birthplace or a grave.
- D a cemetery.
- E a reconstructed building, object, or structure.
- F a commemorative property.
- G less than 50 years of age or achieved significance within the past 50 years.

Areas of Significance (Enter categories from instructions) Art

Period of Significance 1909

Significant Date(s) N/A

Significant Person (Complete if Criterion B is marked above) N/A

Cultural Affiliation N/A

Architect/Builder Scheirer, Frank A.

Narrative Statement of Significance (Explain the significance of the property on one or more continuation sheets.)

9. Major Bibliographical References

(Cite the books, articles, and other sources used in preparing this form on one or more continuation sheets.)

Previous documentation on file (NPS)

- preliminary determination of individual listing (36 CFR 67) has been requested.
- previously listed in the National Register
- previously determined eligible by the National Register
- designated a National Historic Landmark
- recorded by Historic American Buildings Survey #
- recorded by Historic American Engineering Record #

Primary Location of Additional Data

- State Historic Preservation Office
- Other State agency
- Federal agency
- Local government
- University
- Other

Name of repository: Slatington Library

10. Geographical Data

Acreage of Property less than one acre

UTM References (Place additional UTM references on a continuation sheet)

Zone Easting Northing Zone Easting Northing
18 448200 45001825

See continuation sheet.

Verbal Boundary Description (Describe the boundaries of the property on a continuation sheet.)

Boundary Justification (Explain why the boundaries were selected on a continuation sheet.)

11. Form Prepared By

name/title	Robert Stettner, Board of Governors, Vigilant Fire Company				
organization	Vigilant Fire Company				
street & number	42 S. Walnut Street			date	4/26/04
city or town	Slatington	state	PA	telephone	610/767-2022
				zip code	18080-2022

Additional Documentation

Submit the following items with the completed form:

Continuation Sheets

Maps

A USGS map (7.5 or 15 minute series) indicating the property's location.

A sketch map for historic districts and properties having large acreage or numerous resources.

Photographs

Representative black and white photographs of the property.

Additional items (Check with the SHPO or FPO for any additional items)

Property Owner

(Complete this item at the request of the SHPO or FPO.)

name

street & number

city or town

state

telephone

zip code

Paperwork Reduction Act Statement: This information is being collected for applications to the National Register of Historic Places to nominate properties for listing or determine eligibility for listing, to list properties, and to amend existing listings. Response to this request is required to obtain a benefit in accordance with the National Historic Preservation Act, as amended (16 U.S.C. 470 et seq.).

Estimated Burden Statement: Public reporting burden for this form is estimated to average 18.1 hours per response including the time for reviewing instructions, gathering and maintaining data, and completing and reviewing the form. Direct comments regarding this burden estimate or any aspect of this form to the Chief, Administrative Services Division, National Park Service, P.O. Box 37127, Washington, DC 20013-7127; and the Office of Management and Budget, Paperwork Reductions Project (1024-0018), Washington, DC 20503.

United States Department of the Interior
National Park Service

NATIONAL REGISTER OF HISTORIC PLACES
CONTINUATION SHEET

Vigilant Fire Company Firemen's Monument
Lehigh County, PA

Section 7 Page 1

The Vigilant Fire Company Fireman's Monument is a 16 foot high granite monument located in the Union Cemetery one half mile south of Slatington, Pennsylvania. A local stonemason, Mr. Frank Schierer, carved the monument over a four-month period in 1909. Located 30 feet off of Route 873 inside the southeast corner of the cemetery, the monument is part of a 33' X 33' burial plot. To date three firemen are buried in the plot, all buried during the 1940's. The entire monument is comprised of Barre Granite, imported from Barre, Vermont. The monument is comprised of a three-tiered base, with a 7-foot fireman statue resting atop the base. The statue is in the style of an early 20th century fireman with a handlebar moustache, wearing a pointed fire hat, fire coat and boots and holding a young girl with both arms, and standing with his feet apart and the right foot slightly in front of the left with the left foot raised slightly indicating the fireman is stepping forward. The statue/monument faces northwest, and was placed in that position so people entering and leaving nearby Slatington could see it. The statue, its accompanying base and the burial plot it sits upon remain unchanged since its erection in 1909. No changes have been made to the base or the statue, and the granite is in excellent condition showing no signs of cracking. The only visible signs of change are some minor pitting due to acid rain and weather, and some discoloration/yellowing of the granite at the top of the base and the statue also due to acid rain.

The monument sits on a concrete base. The bottom portion of the monument is comprised of three tiers, with each subsequent higher tier smaller than the previous. The corners of each square base are "cut out," giving the illusion that two sides of each tier are bigger than the other two sides. The dimensions of the three bases are as follows: first tier 9'6" x 6'10" x 1'; second tier 7' x 4'10" x 1'; third tier 6' x 3'10" x 1'. The names of the committeemen who worked on the monument erection, and the words "In Trust" are inscribed on the front of the lowest base. The next levels of the monument are much smaller than the lower three-tiered base. The second level appears as both a rectangle and a square depending on whether the observer is looking at a side or front/back view. Thus, this level is wider running left to right, and narrower running front to back. This level is more ornamental than the lower bases. An ornamental scroll with an acanthus leaves design is carved at the top of this upper section. On the front of the monument in this section are the words "Vigilant Fire Company." More ornamental scrolls are found on the very top of the base. These levels are referred to as Die A. & Die B. The dimensions of these next two levels are as follows: Die A-5 ft. 2 in. by 3 ft. by 2 ft. Die B-5 ft. 6 in. by 2 ft. 8 in. by 2 ft. The next level is the square pad/base on which the Vigilant Fire Company Firemen's Monument rests. Referred to as the cap, it is 2 ft. 7 in. by 2 ft. 4 in. by 1 ft. 6 in. The 7-foot statue composed also of granite completes the monument. The total height of the monument including the statue is 16 feet 3 inches. The statue measures 1 ft. 7 in. by 1 ft. 7 in. by 7 ft. The fireman design is from the typical fireman style depicted in other statues of its kind and in advertising and fire-related items during the early part of the 20th century (i.e. handlebar moustache, pointed fire hat and wearing a heavy fire coat). The Vigilant statue depicts a fireman with the above listed attributes in the heroic act of saving a young child. The fireman is carrying the child with both arms, with the child's small arms clinging to the fireman.

United States Department of the Interior
National Park Service

NATIONAL REGISTER OF HISTORIC PLACES
CONTINUATION SHEET

Vigilant Fire Company Firemen's Monument
Lehigh County, PA

Section 7 Page 2

The monument stands in a 19-acre cemetery on a hillside just outside of Slatington. Eighteen rectangular erect standing tombstones of varying sizes surround the 33' X 33' plot on three sides, and a paved access road runs directly in front of the monument. A wrought iron fence runs along the entire length of the eastern and northern sides of the 19-acre cemetery. The entire cemetery is grass covered, except for several access roads running throughout the property. In the Vigilant monument burial plot three firemen to date have been buried, and three small 16"-L x 8"-W x 6"-H stone markers were placed on the plot honoring these deceased firefighters who either had no family or had a hardship. The gravestones simply state the name each fireman and his year of birth and death. The firemen were buried in 1941, 1942 and 1947. The burial information was gleaned from entries made in the Vigilant Fire Company minute books, and from the three burial markers.

United States Department of the Interior
National Park Service

NATIONAL REGISTER OF HISTORIC PLACES
CONTINUATION SHEET

Vigilant Fire Company Firemen's Monument
Lehigh County, PA

Section 8 Page 1

The Vigilant Fire Company's Firemen's Monument meets Criterion C in the area of Art as an example of late 19th century and early 20th century fireman statue art. Several fire companies in the eastern United States erected statues and combination fountain-statues depicting volunteer firemen in action during the late 19th and early 20th centuries. The Vigilant statue is one of five known surviving fireman statues in the country from this time period, which all look similar. The period of historic significance is 1909, the year in which this statue was erected, and around which time these other firemen's statues-fountains were erected. Other communities in the United States erected firemen's statues/monuments in the years preceding and following the Vigilant monument's period of significance. The four other statues erected around this same time as the Vigilant statue share many of the same physical and artistic characteristics. The Vigilant statue is the only one erected during this time period that is sculpted, whereas the remaining statues are cast metal. The Vigilant monument also meets criteria F as a commemorative property, which derives its significance from its artistic design. The monument was erected to honor deceased firemen, and to provide any firemen living within the Commonwealth of Pennsylvania a place to be buried if they had a hardship or if they were without a family. The monument's design of a fireman rescuing a child, and posed in the act of saving a life symbolizes the fact that volunteer firemen are willing to sacrifice their lives for the protection of people and property, without pay. The theme of a child being rescued is found in most of the surviving fireman statues in this country, including the four other statues that were erected around the time as the Vigilant monument. This theme of a fireman holding a child is then used as a means to commemorate and symbolize the sacrifices that the fallen fireman at each particular monument have made.

Arthur Scranton was the moving force behind the erection of the Vigilant Fire Company Cemetery Monument. At the turn of the 20th century, Arthur, a native of Scranton, PA came to live in Slatington. It is unclear from fire company records or from local historians why or how Scranton came to live in Slatington. It is known that he was interested in slate quarries, and Slatington was one of two centers in the United States for slate mining and manufacturing during the 19th and early 20th centuries. Upon arriving in Slatington, Scranton became associated with the Morris Brothers, who were local quarry owners. He joined the Vigilant Fire Company in 1905, and immediately became an active member in the company, helping both morally and financially. Fire company records indicate he donated money to purchase fire fighting gear as well as paid for marching bands to accompany the Vigilant firemen in local parades. He also became active in the Pennsylvania State Firemen's Association during this time, rising through the ranks to eventually become the organization's First Vice-President.

In the early years of its existence, the Vigilant Fire Company did not have its own fire station. Scranton wanted to remedy this situation, but plans were dropped when the Borough of Slatington refused to maintain a building for the firemen. Scranton still wanted to help out his brother firemen, and show his appreciation for their efforts so he purchased a lot in the Union Cemetery, which was to be used as a burial site for firemen with financial

United States Department of the Interior
National Park Service

NATIONAL REGISTER OF HISTORIC PLACES
CONTINUATION SHEET

Vigilant Fire Company Firemen's Monument
Lehigh County, PA

Section 8 Page 2

hardship or with no family. Both fire company records and *Slatington News* articles indicated this stated purpose. A committee was formed to begin the task of erecting a monument to honor the deceased firemen who would eventually be buried in the lots surrounding the monument. Another committee was formed to solicit money from local citizens and businesses to help fund the monument's cost. On May 9, 1909 Frank A. Scheirer, a local stonemason was awarded the contract to build the monument. The monument cost \$2200 to build. A perpetual care agreement was entered into with the cemetery association, and Scranton donated \$200 to the cemetery association to cover perpetual care. Scranton made the initial donation in the monument fund. In addition donations were solicited from residents in the town's third ward, and on September 9, 1909 company records indicate a motion was passed to take \$400 from the treasury to pay whatever amount was needed to finish the monument. The company chose the present site of the monument because persons entering and leaving town could view the monument. On Thursday September 16, 1909 the monument was dedicated.

The dedication was preceded by a large parade through Slatington to the monument. Both businesses and residences were decorated in honor of the event. Newspaper accounts state that over 1500 people attended the dedication ceremony, and that visiting fire companies, bands, drum corps and council members from Slatington and the neighboring borough of Walnuport were present. Fifteen members of the Vigilant Juniors were present, and each held cords attached to the tarp covering the monument. Master J.W. Holben pulled the cord that unveiled the monument. In his presentation address Arthur Scranton extended the use of the burial plots to any member of a Pennsylvania fire department whether they be paid or volunteer.

Through the years the monument was never used for any other ceremonies. The gathering point in the community and place for firemen ceremonies was and still is at the Fireman's Drinking Fountain on Main Street in Slatington, which was erected in 1910 by members of Hose Company No. 1, Slatington.

The impetus for the erection of Hose Company No. 1's Fireman's Drinking Fountain was the company's decision to undertake the task of bringing a public drinking fountain to the borough. The fountain/statue would serve four purposes: first as a drinking fountain for people, second as a drinking area for horses, third as a drinking area for dogs, and lastly as a symbol of service, vigilance and humanity. This statue is a memorial recognizing all firemen, while most other commemorative statues of the time period were erected to honor specific firemen who died in the line of duty. It is believed by many local historians that it was also erected out of jealousy because Hose Co. 1's sister station, namely the Vigilant Fire Company, erected a fireman's monument six months earlier, which at the time was revered by many in the community. While the Vigilant statue is sculpted, the Fireman's Drinking Fountain was cast zinc, and manufactured by the J.W. Fiske Company of New York, New York. It sits atop a cast iron fountain manufactured by the E.P. Barnum Company of Detroit, Michigan.

The Vigilant Fire Company No. 2 was formed in October 1893, when a group of concerned residents of what

United States Department of the Interior
National Park Service

NATIONAL REGISTER OF HISTORIC PLACES
CONTINUATION SHEET

Vigilant Fire Company Firemen's Monument
Lehigh County, PA

Section 8 Page 3

would later become Slatington's third ward, felt their part of town needed adequate fire protection. In addition the borough of Slatington was growing, and it was felt that one fire company for the borough was not sufficient. Hose company No. 1 assisted Vigilant by donating lantern, axes and a hand drawn chemical engine, complete with hose cart. It is not known how or why the name Vigilant was chosen. The original name of the company was Vigilant Hose Company, but by December of 1893 the name was changed to Vigilant Fire Company. Company records do not indicate when the Number "2" was added to the name. On April 9, 1894 the Vigilant Fire Company was incorporated, becoming Slatington's second fire company. Early on the members of the Vigilant met in people's homes, then later in the rear of a barbershop, which was borough property. Around the turn of the century the members were looking for a new hose house, and on August 30, 1901 a new firehouse was dedicated on Main Street. Company records make no mention of it, but it was noted in the *Slatington News*.

Around 1903 the company formed the Vigilant Juniors, which were a group of children who had their own hose cart, banner and uniforms, provided by the Vigilant. They often accompanied the Vigilant firemen in parades. By the early 1920's the Vigilant acquired its first piece of motorized equipment.

Off and on for the next two decades discussions were held about acquiring a piece of land and building a brand new firehouse. In 1950 a building committee was formed, and a lot on South Walnut Street was purchased. Construction began in July of 1952, and it was at that time the fire company entered into a 50-year lease agreement with the borough of Slatington for the building. On January 7, 1954 the company held its first meeting in the new building. Members of the company built the building themselves, as there were many skilled construction workers belonging to the company during this time. In December 1984 the borough of Slatington decided to centralize its three fire companies to save money and improve and modernize the firefighting in Slatington. The borough built a new fire station, which housed all three company's fire apparatus. By the end of 1985 the building was complete, and firefighting ceased at the Vigilant. Shortly afterward problems developed at the Vigilant building when the borough wanted to break its 50-year lease and wanted the keys to the building. Borough council wanted to turn the building into a borough hall. The Vigilant Fire Company went to court, and a settlement was reached. The Vigilant members got to keep their building and the borough had to honor its 50-year lease. Since the time of centralization the Vigilant has functioned only as a social organization. The officers and members kept the building afloat by holding fundraisers and weekly bingo and renting out its hall.

In 1994 the company celebrated its centennial with a banquet and a parade through town. Since that time the building continues to be used as a meeting place for community organizations and the fire company holds several annual fundraisers in the hall.

During the late 19th and early 20th centuries a movement began where small-town volunteer fire companies erected firemen statues and monuments to honor both living and deceased firemen. Two predominant types of

United States Department of the Interior
National Park Service

NATIONAL REGISTER OF HISTORIC PLACES
CONTINUATION SHEET

Vigilant Fire Company Firemen's Monument
Lehigh County, PA

Section 8 Page 4

commemorative statue art were the cast metal statues, typically found in town squares, parks or at fire stations, and the sculpted statues most often found in cemeteries and town squares. Even though the Vigilant statue is an example of the latter type, it more closely resembles the cast metal statues of that time period. The other similar looking statues are located in Ottawa, Ohio; Owego, New York; Carlisle, PA; and Slatington, PA. They all depict firemen in period dress, i.e. wearing rubber boots, rubber fire coat, pointed hat, carrying a lantern and a child and some sporting a handlebar moustache. These statues were erected between 1908 and 1915. The statues in Slatington, Ottawa, and Owego were all manufactured by the J.W. Fiske Company of New York, New York, and were made of zinc. The Fiske Company of New York was a leading manufacturer of cast metal statues during this time period. The company also produced American Indian statues and Civil War statues. It is believed other cast zinc firemen statues were produced by Fiske and erected in the country, but were melted down during WWII, according to the President of the Cumberland Goodwill Fire Company is Carlisle, which is home to the Carlisle firemen's statue.

The Firemen statues in, Carlisle, Pennsylvania (1908), Slatington, Pennsylvania (1909), Ottawa, Ohio (1914) and Owego, New York (1915) are nearly identical in design, theme and period dress to the Vigilant monument. All four statues depict early firemen in period dress, wearing an overcoat, pointed hat, holding a lantern in the right hand and a young child/baby in the left hand. However, there are some cosmetic differences in the statues. The Carlisle fireman is clean-shaven. The statues in Ottawa, Owego, and Slatington all sport a handlebar moustache. In Carlisle and Ottawa the statues are gilded with a metallic sheen, whereas, the Slatington and Owego firemen are painted to have a blue coat and white skin. The statues in Carlisle, Owego and Slatington sit atop cast iron fountains, the fireman in Ottawa sits atop a cast iron base. Additionally, the Carlisle fireman is depicted with an open fire coat exposing a shirt underneath the coat, while the Ottawa, Owego and Slatington fireman's coats are buttoned, each with five pairs of buttons depicted. Finally the stance of the Carlisle fireman is feet apart, but side by side, whereas the stance of the other three statues has the right foot in front of the left foot as if stepping forward.

The Vigilant fireman statue is nearly identical to the cast metal statues found in Ottawa, Owego and Slatington. The Vigilant fireman is wearing a fire coat, pointed hat, and boots, and the right foot is in front of the left indicating movement, in the act of saving a child. The Vigilant statue is extremely detailed in the folds of the overcoat; many folds were sculpted in the bottom portion of the fireman overcoat where it hangs over his legs. The dress the child is wearing is equally as detailed, with numerous folds depicted at the bottom of the dress. This characteristic is also found in the four cast metal statues in the fireman's overcoat as well as in the child's clothing.

The only major differences between the cast metal statues and the Vigilant statue is that the Vigilant fireman is not carrying a lantern, he is using both arms to hold and carry the child, and he is clean-shaven like the Carlisle

United States Department of the Interior
National Park Service

NATIONAL REGISTER OF HISTORIC PLACES
CONTINUATION SHEET

Vigilant Fire Company Firemen's Monument
Lehigh County, PA

Section 8 Page 5

fireman.

Three other existing cast metal firemen statues predate the 1908-1915 statues referenced above. These are located in Austin, Texas (1896), St. Joseph, Michigan (1898) and Elmira, New York (1903). While similar in appearance to the five previously mentioned statues, these statues sit atop monuments not fountains, and predate the Vigilant's period of significance by a decade. In addition these statues are made of bronze, whereas the later referenced statues were made of zinc. Even though they also carry a lantern in one hand, hold a child in the other hand, and wear a heavy type fire coat, the fireman's appearance is slightly different from the Ohio, New York and Pennsylvania statues. This is primarily because they were made at an earlier time and by different manufacturers.

The other type of commemorative statue art, in which category the Vigilant statue belongs in, is the sculpted stone type found in cemeteries. Besides the Vigilant statue a sculpted fireman statue is known to survive in cemeteries in Charlotte, North Carolina (1883) and New Orleans, LA (1887). The theme of a fireman carrying a child to safety is not found in these statues. There is no child or lantern appearing in either one of these statues. The Charlotte fireman is standing with his arms to his side, and the New Orleans fireman is holding a hose. In addition the firemen depicted in these two cemetery statues are not wearing the heavy fire coat worn by the 1908-1915 referenced statues as well as the three statues predating the Vigilant statue.

The sculptor of the Vigilant statue, Mr. Frank A. Scherirer, was a local stone mason who had his own tombstone/monument business. No other examples of any further artwork by him are known to exist, or are credited to him.

United States Department of the Interior
National Park Service

NATIONAL REGISTER OF HISTORIC PLACES
CONTINUATION SHEET

Vigilant Fire Company Firemen's Monument
Lehigh County, PA

Section 9 Page 1

Bibliography

Brown, Beverly. "Fireman's Fountain Rededicated," *Appalachian Community Press*, August 2000.

Grissom, Carol A. "Saving Firemen Made of Zinc. Smithsonian Center for Materials research and Education website, 2001.

Hennessy, Christine. "Honoring Heroes: Another History Lesson," Smithsonian American Art Museum: Inventory of American Sculpture website, 2003.

Lang, Daryl. "New York Town's Fireman Looks Familiar," *Sentinel* September 2, 2001.

Perpetual Care Agreement, Union Cemetery-Vigilant Fire Company No. 2, July 5, 1909.

Rauch, James, Editor & Proprietor, *Slatington News*, Slatington, PA, December 16, 1908, May 9, 1909, September 4, 1909, September 11, 1909 and September 18, 1909. The News Publishing Company.

Vigilant Fire Company Minute Book (1902-1914), December 12, 1908, May 6, 1909, July 15, 1909 and September 9, 1909.

United States Department of the Interior
National Park Service

NATIONAL REGISTER OF HISTORIC PLACES
CONTINUATION SHEET

Vigilant Fire Company Firemen's Monument
Lehigh County, PA

Section 10 Page 1

Verbal Boundary Description:

The nominated are is a 33' x 33' plot located in the southeast corner of the Union Cemetery, 30' inside the cemetery border fence running parallel to PA Route 873 on the eastern end of the cemetery property, 6' south of a cemetery lane ending at the cemetery border fence. (This access road is connected to the main access road, which is approximately 150' north/northeast of the monument and is connected to PA Route 873 on the eastern end of the cemetery property.)

Verbal Boundary Justification:

The nominated property includes the statue/monument and the associated 33 x 33-foot cemetery plot, as originally purchased by Arthur Scranton on behalf of the Vigilant Fire Company and as stated in the perpetual care agreement.

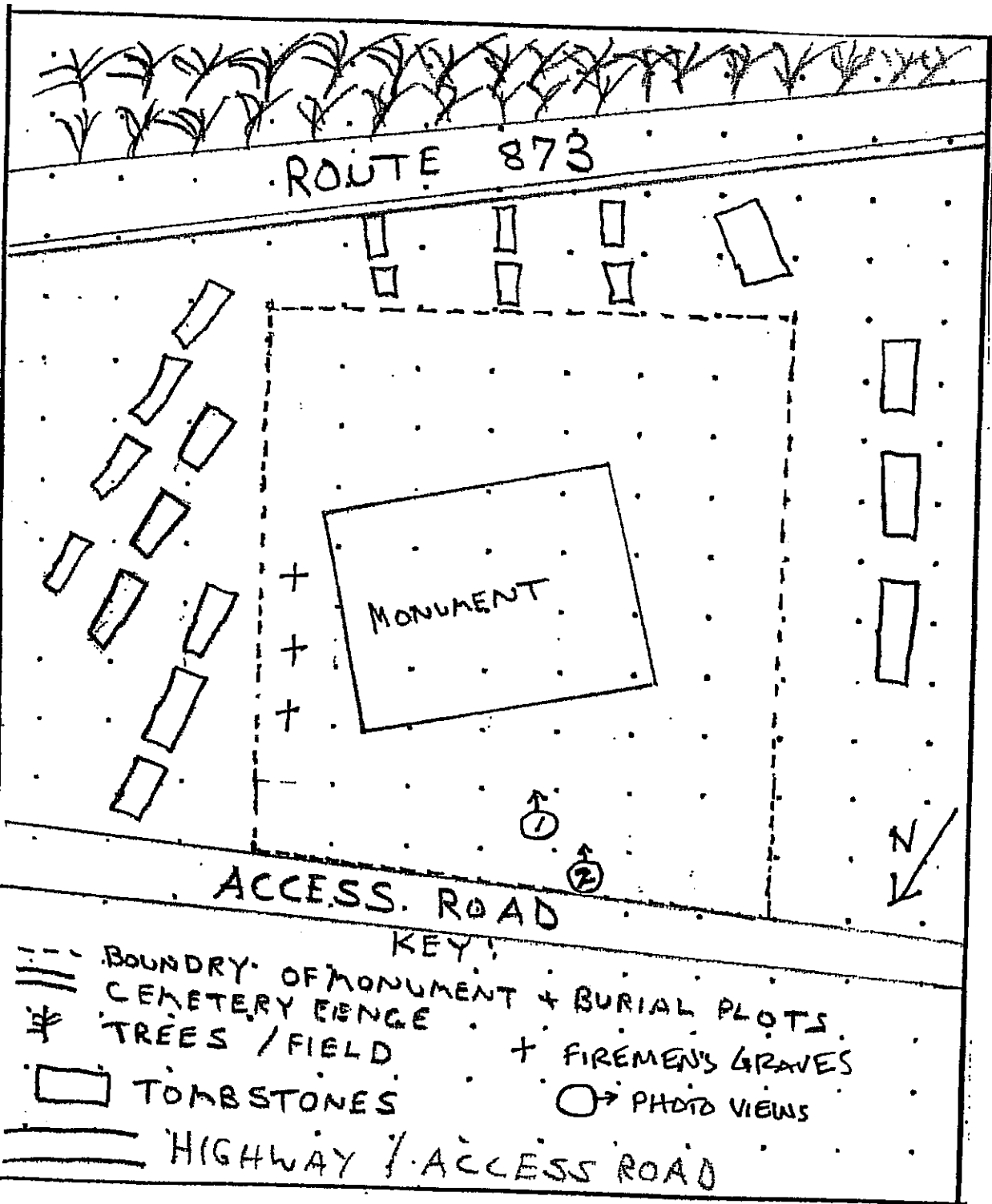

VIGILANT FIRE COMPANY FIREMEN'S MONUMENT
 LEHIGH COUNTY, PA

UNITED STATES
DEPARTMENT OF THE INTERIOR
GEOLOGICAL SURVEY

COMMONWEALTH
DEPARTMENT OF ENVIRONMENTAL
TOPOGRAPHIC



3885 1 SW
(LEHIGH TOWN)

75° 37' 30"
40° 45'

451000m N

Vigilant Fire Company
Fireman's Monument
Lehigh County, PA
Cementon, PA
NE/4

33' x 33' plot
containing Monument

R 448 200
4509825

RANTON 54 MI.
MI. TO INTERCHANGE 34