

United States Department of the Interior  
National Park Service

# National Register of Historic Places Registration Form

This form is for use in nominating or requesting determinations of eligibility for individual properties or districts. See instructions in *Guidelines for Completing National Register Forms* (National Register Bulletin 16). Complete each item by marking "x" in the appropriate box or by entering the requested information. If an item does not apply to the property being documented, enter "N/A" for "not applicable." For functions, styles, materials, and areas of significance, enter only the categories and subcategories listed in the instructions. For additional space use continuation sheets (Form 10-900a). Type all entries.

### 1. Name of Property

historic name Teller Bros./Reed Tobacco Historic District  
other names/site number N/A

### 2. Location

street & number N. Prince Street, 200 block, east side not for publication N/A  
city, town Lancaster vicinity N/A  
state Pennsylvania code PA county Lancaster code 071 zip code 17603

### 3. Classification

#### Ownership of Property

- private
- public-local
- public-State
- public-Federal

#### Category of Property

- building(s)
- district
- site
- structure
- object

#### Number of Resources within Property

Contributing	Noncontributing
<u>5</u>	<u>0</u> buildings
<u>0</u>	<u>1</u> sites
<u>    </u>	<u>    </u> structures
<u>    </u>	<u>    </u> objects
<u>5</u>	<u>1</u> Total

Name of related multiple property listing:

Tobacco Buildings in Lancaster City

Number of contributing resources previously listed in the National Register 0

### 4. State/Federal Agency Certification

As the designated authority under the National Historic Preservation Act of 1966, as amended, I hereby certify that this  nomination  request for determination of eligibility meets the documentation standards for registering properties in the National Register of Historic Places and meets the procedural and professional requirements set forth in 36 CFR Part 60. In my opinion, the property  meets  does not meet the National Register criteria.  See continuation sheet.

Signature of certifying official [Signature]

Date 7/31/90

State or Federal agency and bureau \_\_\_\_\_

In my opinion, the property  meets  does not meet the National Register criteria.  See continuation sheet.

Signature of commenting or other official \_\_\_\_\_

Date \_\_\_\_\_

State or Federal agency and bureau \_\_\_\_\_

### 5. National Park Service Certification

I, hereby, certify that this property is:

- entered in the National Register.  See continuation sheet.
- determined eligible for the National Register.  See continuation sheet.
- determined not eligible for the National Register.

removed from the National Register.

other, (explain): \_\_\_\_\_

Signature of the Keeper \_\_\_\_\_

**6. Function or Use**

Historic Functions (enter categories from instructions)

Agriculture/storageIndustry/manufacturing facility

Current Functions (enter categories from instructions)

Commerce/professionalCommerce/specialty storeCommerce/department store**7. Description**

Architectural Classification

(enter categories from instructions)

Other: tobacco warehouse

Materials (enter categories from instructions)

foundation Stonewalls Brickroof Synthetic: rubber

other \_\_\_\_\_

Describe present and historic physical appearance.

The Teller Bros./Reed Tobacco Historic District is comprised of five contributing buildings and one noncontributing site on the 200 block of North Prince Street, east side. The area surrounding the district is generally commercial and rowhouse residential: N. Prince Street is to the west; a parking lot and W. Walnut Street are to the north; buildings which are not historically associated with the cultural resources in the district are to the south; and a former railroad right-of-way and N. Market Street are to the east. Most of the district's easterly boundary and the easterly property lines of the cultural resources are coterminus with this former railroad right-of-way which ran northwest-southeast. The buildings in the district date from c. 1865-1900 and are constructed of red brick over stone foundations. They range in height from two-and-one-half to four stories and have brick corbelled cornices with dentils. The west elevations of the buildings which front on N. Prince Street (Buildings A through D) form a unified streetscape for much of the block. The east elevations of four of the buildings have an unusual angled configuration which followed the angle of the former railroad lines they abutted. Railroad sidings also lay alongside the north and south elevations of the two southernmost buildings in the district. The architecture in the district varies from the side-gabled John F. Reed & Co. Cigar Factory, c. 1865, which appears to have been an expanded late-Federal style double house with dormers, to the flat-roofed large industrial-type tobacco warehouse, c. 1885, the second of the two Teller Bros. buildings. Diversity also is found in the roof types: side-gabled, front-gabled, flat, and shed. Windows where original are generally segmental arch openings with six-over-six windows set in wooden sash with wooden sills. In January 1984 a fire damaged the two Teller Bros. tobacco warehouses, a building

United States Department of the Interior  
National Park Service

National Register of Historic Places  
Continuation Sheet

Teller Bros./Reed Tobacco Historic District, Lancaster, Lancaster Co., PA

Section number 7 Page 2

---

to the immediate south which was at 233-5 N. Prince Street, and the Lancaster Paint Works (Building E) at the rear of No. 233-5. Only the first and second stories of the east wall of No. 233-5 were able to be salvaged; its site is now a courtyard and parking area which, together with the surviving wall, is counted as the noncontributing site. After the fire, the Teller Bros. buildings were renovated and the Lancaster Paint Works building was partially repaired. Several of the buildings have been altered over time: storefront windows and new doorways have been added to the Teller Bros. North Building, the John F. Reed & Co. Cigar Factory, and the J. R. Bitner Tobacco Warehouse. The Reed & Co. Cigar Factory has a very large addition in the rear. Despite these changes, much of the original configuration of the cultural resources remains discernible, and a considerable amount of original building fabric is intact. The Teller Bros./Reed Tobacco Historic District has good integrity.

Beginning at the south end of the district and looking north the buildings are as follows:

Building A: J. R. Bitner Tobacco Warehouse, 223-5 N. Prince Street, is rectangular in plan and dates from c. 1880. The building is two-and-one-half stories in height, approximately 32 feet wide by 150 feet deep, with a moderately pitched front-gabled roof. Although the building appears in its present size on the 1886 Sanborn map, it may have originally been smaller and later extended to the east, as evidenced by an old parapeted gable projection visible on the roof, near the center. The west elevation (main facade) presents the gable end to the street; modern showroom windows and a double doorway have been added on the first story. Above the doorway is an added section of multipaned glass and a large light fixture suspended from the second story. Brickwork on the upper stories of this facade has been patched and reworked. The north elevation has a raised basement and four loading docks on the first floor. South elevation window openings have all been brick-filled, except for one at the extreme east end. The east elevation has a one-story brick addition, c. 1940, a brick chimney stack, and a wooden stairway to a second story center entrance. The building, originally Bitner's tobacco warehouse and box shop, was by 1897 a wholesale grocery business; post-1912 it was a wholesale electrical supply warehouse; presently, it houses an automotive supplies business. The building, although somewhat altered, still has much of its original building fabric intact.

United States Department of the Interior  
National Park Service

**National Register of Historic Places  
Continuation Sheet**

Teller Bros./Reed Tobacco Historic District, Lancaster, Lancaster Co., PA

Section number 7 Page 3

---

Building B: John F. Reed & Co. Cigar Factory, c. 1865, 227-31 N. Prince Street, is rectangular in plan with a north-south axis. It is three-and-one-half stories in height, has a late-Federal appearance with wooden lintels and sills, and a double row of dentils at the cornice. The building is ten bays wide by approximately thirty feet deep; it gives the appearance of originally having been a double house. The roof is moderately pitched with raised parapeted gable ends in lieu of paired chimneys. On the west slope of the roof are four pedimented dormers having fishscale-slate siding, c. 1880. The 1886 and 1912 Sanborn maps show a drive-through at the tenth bay. The first story of the west elevation (main facade) has four entrances and three storefront windows, partly due to a c. 1985 remodeling. The south elevation of the building is covered with stucco. The building has been greatly extended to the east by a two-story, two-bay, flat-roofed addition, c. 1880, of approximately seventy feet, which subsumed a small earlier ell. The east elevation of the addition has a raised rounded arch entrance at the first bay and a stepped parapet. By 1886 this addition was used by a wholesale grocery firm; a railroad sidings ran along its south side. A one-story, shed-roofed addition was made, c. 1940, at the east elevation of the main building, adjoining the southwest corner of the c. 1880 addition. The entire property is now a mall of shops; the building has fairly good overall integrity.

The noncontributing site at 235 N. Price Street originally had on its lot a three-story brick building, c. 1900, with a side-gabled roof, brick segmental arch openings, and corbelled cornices. This was the main building of the Lancaster Paint and Glass Co. property which included the Lancaster Paint Works in the rear (Building E), and, at the time of the fire in 1984, also included the two Teller Bros. tobacco warehouses. The outline of the demolished building's south elevation is visible on the wall of the adjoining building. The site is now a courtyard-parking area for the building to the north. Of the partial west wall which was salvaged, the window and door openings are as originally, except the first bay, first story opening, which was enlarged. The top edge of the wall was capped with a row of brick dentils, duplicating the original corbelling at the roof line. The wall is now a picturesque ruin.

United States Department of the Interior  
National Park Service

**National Register of Historic Places  
Continuation Sheet**

Teller Bros./Reed Tobacco Historic District, Lancaster, Lancaster Co., PA

Section number 7 Page 4

---

Building E, Lancaster Paint Works, c. 1900, 235 N. Prince Street, rear, is a three-story building, approximately thirty by fifty feet, with shed roof sloping down to the north. The east elevation has a tall brick chimney. The building was the rear building of the Lancaster Paint & Glass Co.; both appear on the 1912 Sanborn map as adjoining buildings with a common wall. The two buildings, however, may at one time been separate because on the west elevation of this building are now visible an old outside flight of wooden steps and exterior fenestration. Although Building E has no historical links to the tobacco industry, its construction follows that used for the other warehouse buildings in the study: brick exterior walls over a stone foundation, interior brick walls, and heavy post-and-beam construction having heavy wooden components and chamfered capitals. The west elevation has a painted sign between the first and second stories: "Lancaster Paint Works." As a result of damage from the fire the building is not in use. Pending restoration, the owners have replaced the roof and boarded up the windows and doors.

Building C: Teller Bros., Tobacco Warehouse, South Building, 237-9 N. Prince Street, the earlier of the two Teller Bros. warehouses, is rectangular in plan and dates from c. 1877. It is three-and-one-half stories in height over a raised basement, and is of brick laid in common bond, except the west elevation (main facade) which is in running bond. The building is three bays wide by approximately seventy-five feet deep. The roof is front-gabled and of moderate pitch with brick chimneys at the north and south corners of the west elevation, and at the gable point of the east elevation. The north slope has a c. 1890 slate-sided shed-roofed dormer. According to the 1886 Sanborn map, the westerly end of the south elevation wall was built around an adjacent dwelling (replaced by a stable; both no longer extant, but outline is visible on south elevation); therefore, this end is indented about six feet from the remainder of the south elevation (similarly, see National Register nomination, Frey, Jacob L., Tobacco Warehouse, submitted 1990). The west elevation is three bays wide on the second and third stories with brick pilasters separating the bays which are recessed. The first story has four bays with single recessed doorways having segmental arch openings at the first and fourth bays; the third bay, at center, is an old recessed receiving doorway, now boarded

United States Department of the Interior  
National Park Service

National Register of Historic Places  
Continuation Sheet

Teller Bros./Reed Tobacco Historic District, Lancaster, Lancaster Co., PA

Section number 7 Page 5

---

up. The brickwork of the first story has been reworked, probably when a window was added at the second bay; between the first and second stories is a faded painted sign: "I. Weaver Co. Leaf Tobacco." The north elevation has a modern iron fire escape added at the east end. The east elevation is the gable end of the original building, partially obscured by an angled two-story shed-roofed brick addition, c. 1885. The building's exterior features and its post-and-beam construction are largely intact. The building houses an architectural firm.

Building D, Teller Bros. Tobacco Warehouse, North Building, 241-3 N. Prince Street, is rectangular in plan, except for an angled east wall, and dates from c. 1885. It is four stories in height, has a raised basement, and an almost flat roof (there is a slight dip at the center of roof). The building is three bays wide by approximately seventy-five feet deep. The 1886 Sanborn map shows the building having its present footprint, including the angled east wall. At that time, there were two small impermanent structures adjoined on the north elevation. The walls of Building D are of brick laid in common bond, except the west elevation which is in running bond; the brick has been sandblasted. A cinder block addition, c. 1945, is at the southeast end. The building, damaged in the 1984 fire, was rehabilitated in 1985: the first story exterior was altered, so that the west elevation (originally five bays over a high basement) now has a recessed center entrance with canopy and two mullioned storefront windows; the northwest corner has a similar window; and a new shop entrance is at the easterly end of the north elevation. Although the first story fenestration has been altered, and some of the interior has had minor changes, the remainder of the building fabric is intact, including the post-and-beam construction. The building is occupied by a rug importing business.

The Teller Bros./Reed Tobacco Historic District has retained most of the structural components and building relationships which characterized the 200 block of N. Prince Street in the period c. 1877-1920.

**8. Statement of Significance**

Certifying official has considered the significance of this property in relation to other properties:

nationally  statewide  locally

Applicable National Register Criteria  A  B  C  D

Criteria Considerations (Exceptions)  A  B  C  D  E  F  G

Areas of Significance (enter categories from instructions)

Industry  
Architecture

Period of Significance  
c. 1877-1920

Significant Dates  
c. 1877

Cultural Affiliation  
N/A

Significant Person  
N/A

Architect/Builder  
Unknown

State significance of property, and justify criteria, criteria considerations, and areas and periods of significance noted above.

Four of the five buildings in the Teller Bros./Reed Tobacco Historic District are significant under criteria A and C: the J. R. Bitner Tobacco Warehouse; the John F. Reed & Co. Cigar Factory; and the two Teller Bros. Tobacco Warehouses. These buildings are members of the tobacco processing and manufacturing property type under the multiple property nomination: Tobacco Buildings in Lancaster City. Because of these buildings the district is significant as an integral part of one of Lancaster City's most important late-nineteenth- and early-twentieth-century industries, the processing and storage of cigar leaf tobacco. The J. R. Bitner building, c. 1880, was an early tobacco warehouse/box shop whose owner was a local entrepreneur; the John F. Reed building was an early cigar factory, one of the few extant cigar factories, unusual also because it appears to have originally been a dwelling; the two Teller Bros. Tobacco Warehouses, typical of new warehouse structures in Lancaster City, c. 1877-85, were owned by an out-of-town company at a time when virtually all of the tobacco business buildings were locally-owned. The fifth building in the district, the Lancaster Paint Works, c. 1900, is contributing because its architecture is related to brick warehouse construction common to Lancaster City at the turn of the century and to the property type in particular. The Teller Bros./Reed Tobacco Historic District is representative of a body of industrial buildings in Lancaster City of the period 1875-1920. As such, the district forms a streetscape presenting a variety of late-nineteenth- and early-twentieth-century industrial buildings, mostly tobacco-related, along the 200 block of N. Prince Street. The district is further notable because it is an intact concentration of brick warehouses whose sites were directly related to the adjacent railroad lines.

See continuation sheet

United States Department of the Interior  
National Park Service

**National Register of Historic Places  
Continuation Sheet**

Teller Bros./Reed Tobacco Historic District, Lancaster, Lancaster Co., PA

Section number 8 Page 2

---

The 1864 Plan of the City of Lancaster shows the Pennsylvania Railroad tracks coming from the northwest, running past the 200 block of N. Prince Street, before changing direction at the old depot on N. Chestnut Street and heading east. It also shows two railroad sidings to buildings approximately in the area of Teller Bros./Reed Tobacco Historic District, implying early development of some of the buildings.

By 1886, according to the Sanborn map of that year, the Bitner, Reed, and both Teller Bros. buildings (Buildings A through D) were built and generally had the same footprints as at present. They were all used for tobacco-related business. The Lancaster Paint & Glass Co. buildings (noncontributing site and Building E) were not yet constructed; two small dwellings were then on the site. There were also numerous tobacco warehouses in the area: to the immediate southeast of Bitner's building was the tripartite tobacco warehouse building known as Steinman's block (demolished); on N. Queen Street just north of W. Chestnut was another J. R. Bitner Tobacco Warehouse, H. C. Morse, lessee, which was combined to the west with a grain warehouse (extant, but determined not National Register eligible).

Of the known tobacco-related activity in the district, the J. R. Bitner Tobacco Warehouse, 223-5 N. Prince Street (Building A), was among the earliest. This rectangular building was irregularly divided into front and rear warehouses with a box or packing case shop in the northeast portion. The 1877-8 city directory lists the building as the tobacco warehouses of Lachenbruch & Bro. (front) and A. S. Rosenbaum & Co. (rear). The 1884 city directory listing for the building is "J. R. Bitner, President, Fulton National Bank and packing cases, 223 N. Prince St." (Bitner apparently bought the building c. 1883.) C. J. Rhodes & Co. leased the building in 1890 along with J. H. Shirk. In 1900 it was again listed as the J. R. Bitner Tobacco Case Co. The 1912 Sanborn map shows the building as the J. R. Bittner (sic) Co., Tobacco Warehouse, but the building was used primarily for boxmaking and storage of tobacco cases. The building continued to be listed in city directories under Bitner's name at least until 1938 (presumably, by that time an estate; see also references to the C. A. Bitner estate, National Register Nomination, Harrisburg Avenue Historic District, submitted 1990). By 1947 the building was an electrical supply warehouse. It is presently an automobile parts supply warehouse.



United States Department of the Interior  
National Park Service

**National Register of Historic Places  
Continuation Sheet**

Teller Bros./Reed Tobacco Historic District, Lancaster, Lancaster Co., PA

Section number 8 Page 3

---

The John F. Reed & Co. Cigar Factory, 227-31 N. Prince Street (Building B), was owned by George K. Reed, according to the 1886 Smith atlas map. The 1886 Sanborn map lists John F. Reed & Co. in the main building and a wholesale grocery (owner's name is not shown) in the large rear addition. In 1898 the owners of Reed & Co. were G. Harry Reed and Hiram Stamm. The company was listed at this address in 1890, both under cigar manufacturers and leaf tobacco dealers. By 1900 the building was the leaf tobacco warehouse of J. F. Brimmer, who also had a tobacco warehouse at 226 N. Prince Street (see National Register nomination, Brimmer, John, Tobacco Warehouse, submitted 1990). By 1919 the firm of J.P. Hollinger & Co., Wholesale Grocers, was at this address; the building continued in this use until post-1947. The John F. Reed Cigar Factory is significant because it appears to have originally been a late-Federal style double dwelling which was expanded, rather than having been constructed as a cigar factory (see, for comparison, National Register nominations for Milleysack, J. B., Cigar Factory, and Slater Cigar Co., both submitted 1990). The Reed Cigar Factory's large c. 1880 addition to the east, with its flat parapeted roof, fits well with typical warehouse architecture of the period.

The Teller Bros. Tobacco Warehouse, South Building, 237-9 No. Prince Street (Building C), c. 1877, was the first of this pair of buildings constructed for the Philadelphia firm. The Teller Bros. leaf tobacco company is listed on the 1877-8 city directory as being at 237 and 239 N. Prince Street. In 1881 the firm purchased the adjoining lot to the north from John Rees. Around 1885 they built the North Building, 241-3 N. Prince Street (Building D); the buildings are separated by about eight feet. Both are shown on the 1886 Sanborn map under the name of Teller Bros. In 1890 the South Building was occupied by M. Rosenthal, leaf tobacco; from 1886 to 1904 it was occupied by a flour firm, Eastern Milling and Exporting. According to the 1897 Sanborn map (updated to 1904) the North Building was occupied by the leaf tobacco firm of I. H. Weaver. By 1912 I. H. Weaver owned both Teller Bros. tobacco warehouses (see painted sign, South Building). The 1919 city directory lists Isaac H. Weaver, wholesale leaf tobacco, at both buildings. In 1931 the South Building was vacant and the North Building was occupied as a furniture warehouse; in 1938 Weaver was again in the leaf tobacco

**United States Department of the Interior  
National Park Service****National Register of Historic Places  
Continuation Sheet**

Teller Bros./Reed Tobacco Historic District, Lancaster, Lancaster Co., PA

Section number 8 Page 4

business in the South Building where he remained until after 1947. The North Building was vacant in 1938 and occupied by a floor covering business by 1947.

Around 1900 on the site formerly of two small dwellings at No. 223-5 N. Prince Street, the Lancaster Paint and Glass Co. constructed a building fronting on N. Prince Street and a smaller building at the rear called the Lancaster Paint Works (Building E), the latter building abutting the railroad tracks. Neither building is shown on the 1899 map. Both buildings are shown on the 1912 Sanborn map as belonging to the Lancaster Paint & Glass Co. The building fronting on N. Prince Street (the noncontributing site) was the company office and storage area; the rear building (Building E) was used for paint mixing on the first story, and storage on the second and third stories. Both buildings continued in this ownership and usage until a fire destroyed all of the building fronting on N. Prince Street except part of the west elevation (see Section 7); the Lancaster Paint Works, was saved but damaged. In 1985 the property was sold to the owners of the Teller Bros. South Building; the noncontributing site is now a courtyard and parking area; the Lancaster Paint Works building awaits restoration. Lancaster Paint Works is significant for its warehouse construction, typically found in Lancaster City in the period of significance: brick exterior walls over a stone foundation and interior post-and-beam construction with very heavy beams and brick piers. Its sloping shed roof was also becoming common at the turn of the century (see National Register nomination, Milleysack, J. B., Cigar Factory, submitted 1990).

The Teller Bros./Reed Tobacco Historic District has links to the tobacco industry in Lancaster City from c. 1877-1920, particularly through the Teller Bros. South Building and the J. R. Bitner Tobacco Warehouse. The two Teller Bros. Tobacco Warehouses strongly compliment each other architecturally: both are similar in plan and overall scale; however, the change in height and roof style of the four-story flat-roofed c. 1885 North Building, in contrast with the lower front-gabled roof of the Teller Bros. South Building, c. 1877, demonstrates the beginning of the movement in Lancaster City toward flat roofs on industrial buildings in contrast to pitched roofs (see National Register

**United States Department of the Interior  
National Park Service****National Register of Historic Places  
Continuation Sheet**

Teller Bros./Reed Tobacco Historic District, Lancaster, Lancaster Co., PA

Section number 8 Page 5

---

nominations: Slater Cigar Co.; and Harrisburg Avenue Historic District, Building A, submitted 1990). The John F. Reed & Co. Cigar Factory is a rare example of an early cigar factory. Further, the cigar factory appears to have originally been a dwelling, probably not unusual in Lancaster City in the 1880s, judging from the Sanborn maps and the numerous listings in city directories for cigar manufacturers located in residential area. The Lancaster Paint Works building, although not tobacco-related, fits well with the industrial cityscape of the district. The four tobacco-related buildings of the Teller Bros./Reed Tobacco Historic District are significant because they form an intact group of early tobacco industry buildings; and, with the Lancaster Paint Works, are examples of industrial warehouse buildings c. 1877-1920 in Lancaster City. The close proximity of the district to the railroad lines is yet another example of the importance of railroads to the industrial development of Lancaster City in this period, and to the tobacco industry in particular (see also National Register nomination, N. Shippen/Tobacco Avenue Historic District, submitted 1990).

**9. Major Bibliographical References**

Previous documentation on file (NPS):

- preliminary determination of individual listing (36 CFR 67) has been requested
- previously listed in the National Register
- previously determined eligible by the National Register
- designated a National Historic Landmark
- recorded by Historic American Buildings Survey # \_\_\_\_\_
- recorded by Historic American Engineering Record # \_\_\_\_\_

See continuation sheet

Primary location of additional data:

- State historic preservation office
- Other State agency
- Federal agency
- Local government
- University
- Other

Specify repository: \_\_\_\_\_

**10. Geographical Data**

Acreage of property Approximately one (1) acre.

UTM References

A 

1	8
---	---

3	8	9	6	3	0
---	---	---	---	---	---

4	4	3	3	1	2	0
---	---	---	---	---	---	---

  
Zone Easting Northing

C 

--	--

--	--	--	--	--	--

--	--	--	--	--	--	--	--

B 

--	--

--	--	--	--	--	--

--	--	--	--	--	--	--	--

  
Zone Easting Northing

D 

--	--

--	--	--	--	--	--

--	--	--	--	--	--	--	--

See continuation sheet

Verbal Boundary Description \_\_\_\_\_

See continuation sheet

Boundary Justification \_\_\_\_\_

See continuation sheet

**11. Form Prepared By**

name/title Gloria O. Becker, Ph.D., Preservation Director  
organization Historic Preservation Trust of L. C. date Feb. 25, 1990  
street & number 123 N. Prince Street telephone (717) 291-5861  
city or town Lancaster state PA zip code 17603

United States Department of the Interior  
National Park Service

**National Register of Historic Places  
Continuation Sheet**

Teller Bros./Reed Tobacco Historic District, Lancaster County, PA

Section number 9 Page 2

---

**Bibliography**

Graves & Steinbarger, Atlas of Surveys of the County of Lancaster, State of Pennsylvania, 1899, 13, at Lancaster County Library, Lancaster, PA.

Historic Preservation Trust of Lancaster County, Historic Site Survey Form for 233-5 N. Prince Street, c. 1983, gives a description of the building, later destroyed by fire (the noncontributing site).

Insurance Maps of Lancaster, Pennsylvania, 1886: 10; 1897 (updated to 1904):15; 1912: 24; 1912 (updated to 1947): 24; Additional Index, 1901, addendum to 1912 updated. An original Sanborn for 1897 is at the Historical Society of Lancaster County, Lancaster, PA; those for 1886, 1912, and 1912 updated are on microfilm, Reel No. 282, at the same repository.

Jansson, Amy, telephone conversations with Gloria O. Becker, 9/25/89 and 2/21/90, regarding Teller Bros. and the history of 237-9 N. Prince Street.

Lancaster County Deed Books U10: 609 (1876); R11:146 (1881); Teller, Raphael, Lancaster County Court House, Archives, Lancaster, PA.

Lancaster City Directories, 1877-8, 1886, 1889-1890, 1900, 1912-13, 1919-1920, 1931, 1937-8.

Lancaster New Era, 10 Oct. 1985, p. 40 (with photo of buildings after the fire and before restoration; 12 July 1985; 14 Feb. 1986, pp. 1 and 4; 12 July 1987, pp. A1 and A4.

Levengood, Richard, telephone conversations with Gloria O. Becker, Ph.D., 7/24/89, 2/22/90, regarding 233-5 and 237-9 N. Prince Street.

Plan of the City of Lancaster, in Bridgen's Atlas of the County of Lancaster, Pennsylvania, (H. F. Bridgen), 1864, p. 4.

Smith, J. L., Atlas of the City of Lancaster, Lancaster County, Pennsylvania, 1886, p. 5.

United States Department of the Interior  
National Park Service

**National Register of Historic Places  
Continuation Sheet**

Teller Bros./Reed Tobacco Historic District, Lancaster, Lancaster Co., PA

Section number 10 Page 2

---

**Verbal Boundary Description**

Beginning at a point, 58.8 feet south of the southeast corner of N. Prince and W. Walnut Streets and a corner of the property line of Parcel No. 2 of 241-3 N. Prince Street (Lancaster County Tax Assessor's Map No. 13K1A-1-19); thence extending in a southerly direction on N. Prince Street a distance of 259.9 feet along the west property lines of Parcel No. 2 of 241-3, No. 237-9, No. 235 (now legally combined with No. 237-9), No. 225-7, and No. 223-5 N. Prince Street to a point; thence extending in an easterly direction a distance of 247 feet along the south property line of 223-5 N. Prince Street to a point, a corner of the property line of 223-5 N. Prince Street and the west right-of-way of N. Water Street; thence following the property line of 223-5 N. Prince Street north a distance of 64.3 feet, east a distance of 41.4 feet to point, a corner of the property line of 225-7 N. Prince Street; thence extending in a northwesterly direction a distance of 232 feet along the east property lines of 225-7, 235, 237-9, and Parcel No. 2 of 241-3 N. Prince Streets to a point; thence following the north property line of the Parcel No. 2 of 241.3 N. Prince Street in a westerly direction a distance of 81.1 feet to the place of beginning. Being approximately 1 acre.

**Boundary Justification**

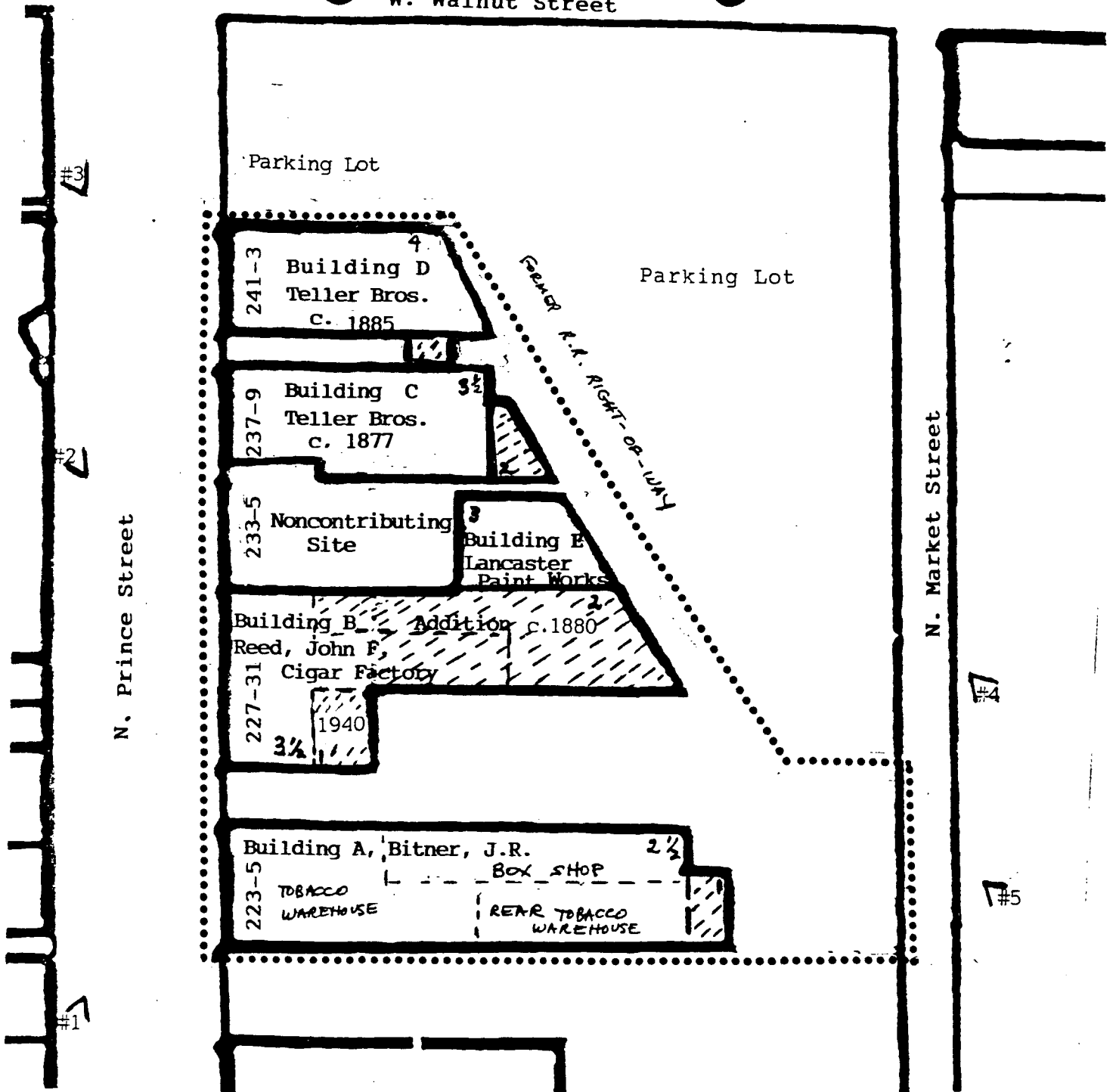

The legal boundaries which are historically associated with the cultural resources. See Lancaster County Tax Assessor's Files and Maps Nos. 13K1A-1-15 (223-5 N. Prince Street); 13K1A-1-16 (227-31 N. Prince Street); 13K1A-1-17 (233-5 N. Prince Street); 13K1A-1-18 (237-9 N. Prince Street); and 13K1A-1-19 (Parcel No. 2 of 241-3 N. Prince Street). Parcel No. 1 of 241-3 N. Prince Street, presently having the same owner as Parcel No. 2, is now a parking lot for Building D; the lot was not historically associated with the cultural resource (see Lancaster County Tax Assessor's File No. 12K13D-7-1; Lancaster County Recorder of Deeds Book, p. 779; and Sanborn Fire Insurance Map, 1886, p. 10).

W. Walnut Street



N. Prince Street

N. Market Street

-  - addition
-  - photo notation

TELLER BROS./REED TOBACCO HISTORIC DISTRICT  
 N. Prince Street, 200 block, east side  
 Lancaster  
 Lancaster County, PA