

United States Department of the Interior
National Park Service

National Register of Historic Places Registration Form

This form is for use in nominating or requesting determinations of eligibility for individual properties or districts. See instructions in *Guidelines for Completing National Register Forms* (National Register Bulletin 16). Complete each item by marking "x" in the appropriate box or by entering the requested information. If an item does not apply to the property being documented, enter "N/A" for "not applicable." For functions, styles, materials, and areas of significance, enter only the categories and subcategories listed in the instructions. For additional space use continuation sheets (Form 10-900a). Type all entries.

1. Name of Property

historic name Martin, B. B., Tobacco Warehouse
other names/site number N/A

2. Location

street & number 422-8 N. Water St. (at Arch, below W. James) not for publication N/A
city, town Lancaster vicinity N/A
state Pennsylvania code PA county Lancaster code 071 zip code 17603

3. Classification

Ownership of Property	Category of Property	Number of Resources within Property	
<input checked="" type="checkbox"/> private	<input checked="" type="checkbox"/> building(s)	Contributing	Noncontributing
<input type="checkbox"/> public-local	<input type="checkbox"/> district	<u>1</u>	<u>2</u> buildings
<input type="checkbox"/> public-State	<input type="checkbox"/> site	<u> </u>	<u> </u> sites
<input type="checkbox"/> public-Federal	<input type="checkbox"/> structure	<u> </u>	<u> </u> structures
	<input type="checkbox"/> object	<u>1</u>	<u>2</u> objects
		<u> </u>	<u> </u> Total

Name of related multiple property listing:
Tobacco Buildings in Lancaster City

Number of contributing resources previously listed in the National Register 0

4. State/Federal Agency Certification

As the designated authority under the National Historic Preservation Act of 1966, as amended, I hereby certify that this nomination request for determination of eligibility meets the documentation standards for registering properties in the National Register of Historic Places and meets the procedural and professional requirements set forth in 36 CFR Part 60. In my opinion, the property meets does not meet the National Register criteria. See continuation sheet.

Signature of certifying official [Signature] Date 7/31/98

State or Federal agency and bureau _____

In my opinion, the property meets does not meet the National Register criteria. See continuation sheet.

Signature of commenting or other official _____ Date _____

State or Federal agency and bureau _____

5. National Park Service Certification

I, hereby, certify that this property is:

- entered in the National Register. See continuation sheet.
- determined eligible for the National Register. See continuation sheet.
- determined not eligible for the National Register.
- removed from the National Register.
- other, (explain:) _____

Signature of the Keeper

Date of Action

6. Function or Use

Historic Functions (enter categories from instructions)

Agriculture/storageIndustry/manufacturing facility

Current Functions (enter categories from instructions)

Commerce/warehouse**7. Description**

Architectural Classification

(enter categories from instructions)

Other: tobacco warehouse

Materials (enter categories from instructions)

foundation Stonewalls Brickroof Slate

other _____

Describe present and historic physical appearance.

The B. B. Martin Tobacco Warehouse has a rectangular plan and dates from c. 1875. The building is of red brick laid in common bond over a stone foundation. It is two-and-one-half stories in height with a raised basement, five bays by three bays with brick pilasters separating the bays, and has brick corbelled cornices with dentils. The building has a moderately pitched side-gabled roof covered with slate, and brick chimneys on the gable ends. Window openings are brick segmental arches throughout, over rectangular wooden sash which is six-over-six on the second story of the east elevation (main facade), and one-over-one replacement on others. The building is set back from North Water Street below West James Street, near a truncated end of North Arch Street, alongside an abandoned railroad spur. The surrounding area is mixed rowhouse residential and commercial. The building has very good integrity.

The east elevation has a five-bay facade and is approached from a drive leading from North Water Street. The driveway at this elevation appears to have been raised and a ramp built to a loading dock at the fourth bay, first story, c. 1970. The basement windows at the first and second bays are boarded up; the third bay has a partially below grade enlarged entrance. The south elevation has three bays and is partially covered with vines. There is a smokestack adjacent to the southwest corner of the building. The north elevation is covered with vines. The west elevation is not accessible. A modern sign over the first-floor loading dock reads "C & J Auto Parts Warehouse...."

There are two noncontributing buildings on the property. To the southeast, separated from the B. B. Martin Tobacco Warehouse by an wedge-shaped space of from five to ten feet, is a two-story brick storage building, c. 1910, with angled wall on the west elevation which was built to parallel the railroad spur, and a

**United States Department of the Interior
National Park Service**

**National Register of Historic Places
Continuation Sheet**

Martin, B. B., Tobacco Warehouse, 422-8 N. Water St., Lancaster County, PA.

Section number 7 Page 2

garage entrance and concrete ramp at the northerly end of the east elevation. In 1912, according to the Sanborn map, the tobacco warehouse and this building had a one-story wagon shed between them. This building is noncontributing because there is no historical evidence to document its use in the tobacco business; rather, it and three other small buildings (since demolished) adjoining it in a line to the southeast and east, again following the railroad spur, were shown on the aforementioned map as being used for the storage of hay, grain, and coal. There is also a one-story cinder block four-bay garage or storage building, c. 1960, near the northwest corner of the property.

The integrity of the B. B. Martin Tobacco Warehouse is very good. Although the ramp has been added to the loading dock on the east elevation and some of the window glass has been replaced, the building's exterior retains most of its original features, including window openings and slate roof.

8. Statement of Significance

Certifying official has considered significance of this property in relation to other properties:

nationally statewide locally

Applicable National Register Criteria A B C D

Criteria Considerations (Exceptions) A B C D E F G

Areas of Significance (enter categories from instructions)

Industry
Architecture

Period of Significance

c. 1875-1912

Significant Dates

1875

Cultural Affiliation

N/A

Significant Person

N/A

Architect/Builder

Unknown

State significance of property, and justify criteria, criteria considerations, and areas and periods of significance noted above.

The B. B. Martin Tobacco Warehouse is significant under criteria A and C. It is a member of the tobacco processing and manufacturing property type under the multiple property nomination: Tobacco Buildings in Lancaster City. It is significant as an integral part of one of Lancaster City's most important late-nineteenth- and early-twentieth-century industries, the processing and storage of cigar leaf tobacco. The building is representative of a large body of industrial buildings of the period and is a very good example of the two-story side-gabled version of this property type (see also National Register nomination for Friedman, Henry B., Tobacco Warehouse, submitted 1990).

In 1886 B. B. Martin, local businessman, operated a brick works and lumber yard; this tobacco warehouse was at the northwest corner of his lumber yard tract. Martin leased this tobacco warehouse to I. Stirk, according to the Sanborn map of that year. In 1901 it was John F. Brimmer's Leaf Tobacco Warehouse. Brimmer also had a tobacco warehouse at 226 North Prince Street in Lancaster City (see National Register nomination for Brimmer, John, Tobacco Warehouse, submitted 1990). The raised basement was used for leaf stripping at that time. In 1912 the building was the tobacco warehouse of the firm of M. Levy & Sons. By 1947 the building was used as storage for auto parts; its present usage is the same.

9. Major Bibliographical Reference

Insurance Maps of Lancaster, Pennsylvania, Sanborn-Ferris Map Co., 1886: 4; 1897 (updated to 1904): 10; 1912: 18; 1912 (updated to 1947): 18; Additional Index, 1901, addendum to 1912 updated. An original Sanborn for 1897 is at the Historical Society of Lancaster County, Lancaster, PA; those for 1886, 1912, and 1912 updated are on microfilm, Reel No. 282, at the same repository.

Previous documentation on file (NPS):

- preliminary determination of individual listing (36 CFR 67) has been requested
- previously listed in the National Register
- previously determined eligible by the National Register
- designated a National Historic Landmark
- recorded by Historic American Buildings Survey # _____
- recorded by Historic American Engineering Record # _____

See continuation sheet

Primary location of additional data:

- State historic preservation office
- Other State agency
- Federal agency
- Local government
- University
- Other

Specify repository: _____

10. Geographical Data

Acres of property Less than one acre.

UTM References

A 18 388170 4433360
 Zone Easting Northing

C

B
 Zone Easting Northing

D

See continuation sheet

Verbal Boundary Description

See Lancaster County Tax Assessment Book, District No. 33, Ward No. 9, Map No. 12J16C, Block No. 3, Lot No. 15, at the Lancaster County Tax Assessor's Office, Lancaster County Court House, Lancaster, PA.

See continuation sheet

Boundary Justification

The legal boundaries which are historically associated with the property.

See continuation sheet

11. Form Prepared By

name/title Gloria O. Becker, Ph.D., Preservation Director

organization Historic Preservation Trust of L. C. date March 28, 1990

street & number 123 N. Prince Street telephone (717) 291-5861

city or town Lancaster state PA zip code 17603

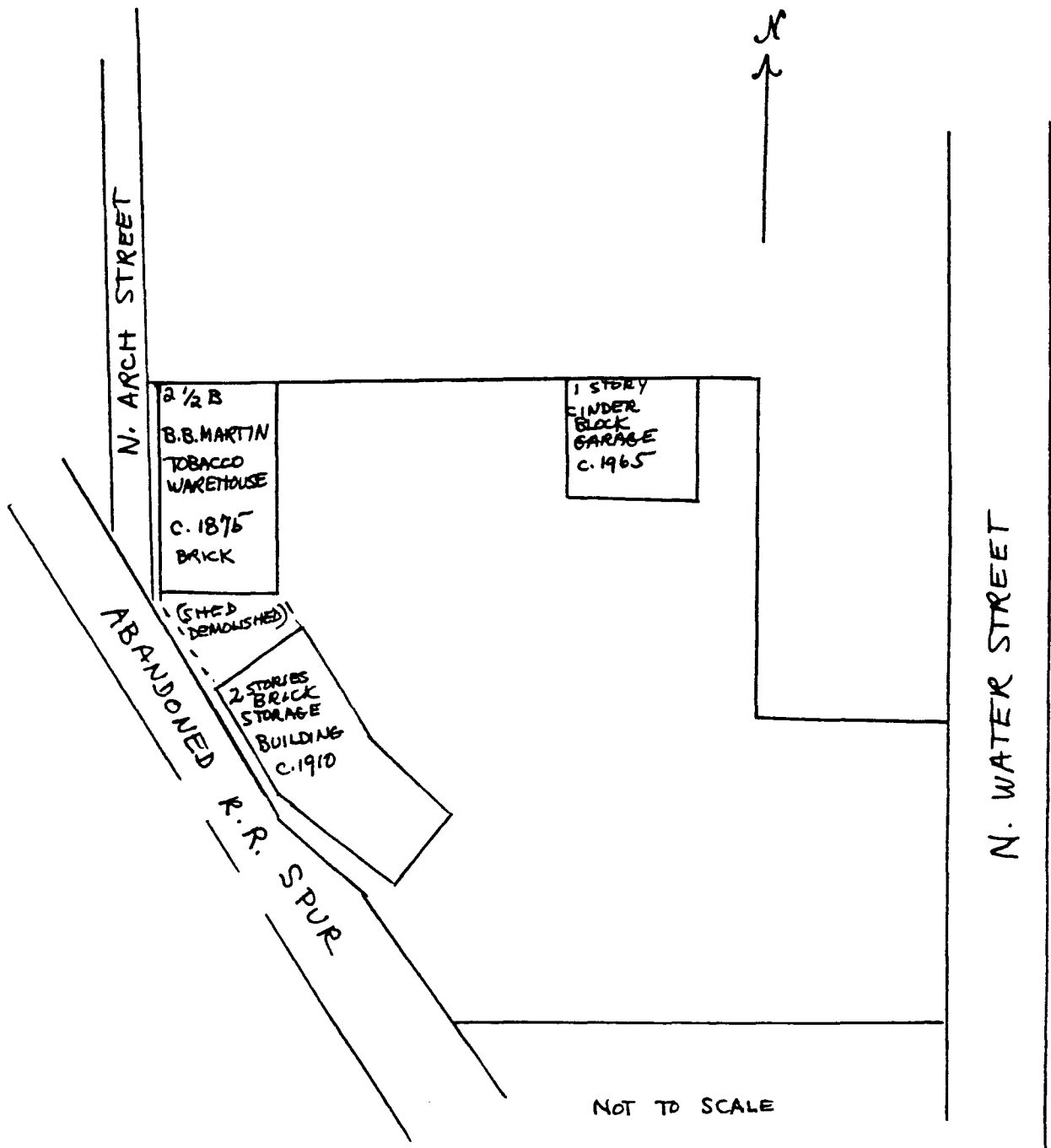

B. B. Martin Tobacco Warehouse
422-428 North Water Street (at Arch Street)
Lancaster County

Henry B. Friedman
 Tobacco Warehouse
 Lancaster Co.
 Lancaster Quad
 Zone 18
 E 358040
 N 4433670

Martin, B. B.
 Tobacco Warehouse
 Lancaster Co.
 Lancaster Quad
 Zone 18
 E 358170
 N 4433360

Schnader, R. K. Sons
 Tobacco Warehouse
 Lancaster Co.
 Lancaster Quad
 Zone 18
 E 357820
 N 4432530

