

United States Department of the Interior
National Park Service

NATIONAL REGISTER OF HISTORIC PLACES
REGISTRATION FORM

=====

1. Name of Property

=====

historic name: Bethlehem Armory

other name/site number: Floyd Simons Armory

=====

2. Location

=====

street & number: 301 Prospect Street

city/town: Bethlehem

not for publication: N/A
vicinity: N/A

state: PA county: Lehigh code: 077 zip code: 18016

=====

3. Classification

=====

Ownership of Property: public-state

Category of Property: building(s)

Number of Resources within Property:

Contributing	Noncontributing	
<u>1</u>	<u>0</u>	buildings
<u> </u>	<u> </u>	sites
<u> </u>	<u> </u>	structures
<u> </u>	<u> </u>	objects
<u>1</u>	<u>0</u>	Total

Number of contributing resources previously listed in the National Register: 0

Name of related multiple property listing: Pennsylvania

National Guard Armories

=====
4. State/Federal Agency Certification
=====

As the designated authority under the National Historic Preservation Act of 1966, as amended, I hereby certify that this ___ nomination ___ request for determination of eligibility meets the documentation standards for registering properties in the National Register of Historic Places and meets the procedural and professional requirements set forth in 36 CFR Part 60. In my opinion, the property ___ meets ___ does not meet the National Register criteria. ___ See continuation sheet.

Signature of certifying official

Date

State or Federal agency and bureau

In my opinion, the property ___ meets ___ does not meet the National Register criteria. ___ See continuation sheet.

Signature of commenting or other official

Date

State or Federal agency and bureau

=====
5. National Park Service Certification
=====

I, hereby, certify that this property is:

___ entered in the National Register.

___ See continuation sheet.

___ determined eligible for the National Register.

___ See continuation sheet.

___ determined not eligible for the National Register.

___ removed from the National Register.

___ other (explain): _____

Signature of Keeper

Date of Action

=====
6. Function or Use
=====

Historic: Defense

Sub: Arms Storage

Current: Defense

Sub: Arms Storage

=====
7. Description
=====

Architectural Classification:

Art Deco

Materials:

foundation concrete

walls brick

roof unknown/not visible

other _____

Describe present and historic physical appearance.

X See continuation sheet.

=====
8. Statement of Significance
=====

Certifying official has considered the significance of this property in relation to other properties: statewide

Applicable National Register Criteria: A, C

Criteria Considerations (Exceptions): _____

Areas of Significance: Military
Architecture

Period of Significance: 1930-1939

Significant Dates: 1930 1938

Cultural Affiliation: N/A

Significant Person: N/A

Architect/Builder: Lovelace and Spillman/Yundt, George E. --
architects
Stoneback and Nase -- builder

State significance of property, and justify criteria, criteria considerations, and areas and periods of significance noted above.

Y. See continuation sheet

=====

9. Major Bibliographical References

=====

See continuation sheet.

Previous documentation on file (NPS):

- preliminary determination of individual listing (36 CFR 67) has been requested.
- previously listed in the National Register.
- previously determined eligible by the National Register.
- designated a National Historic Landmark.
- recorded by Historic American Buildings Survey # _____.
- recorded by Historic American Engineering Record # _____.

Primary Location of Additional Data:

- State historic preservation office.
- Other state agency.
- Federal agency.
- Local government.
- University.
- Other -- Specify Repository: _____.

=====

10. Geographical Data

=====

Acreage of Property: 1.7

UTM References:

A	<u>18</u>	<u>467200</u>	<u>4496340</u>	B	_____	_____	_____
	Zone	Easting	Northing		Zone	Easting	Northing
C	_____	_____	_____	D	_____	_____	_____
	Zone	Easting	Northing		Zone	Easting	Northing

Verbal Boundary Description:

See continuation sheet.

Boundary Justification:

The legal boundaries which are historically associated with the property.

See continuation sheet.

=====

11. Form Prepared By

=====

Name/Title: Kristine Wilson/Joseph Burke, III -- Interns

Organization: PHMC -- BHP Date: 7/9/90

Street & Number: Box 1026 Telephone: (717) 783-8946

City or Town: Harrisburg State: PA Zip Code: 171018-1026

United States Department of the Interior
National Park Service

NATIONAL REGISTER OF HISTORIC PLACES
CONTINUATION SHEET

Section number: 7 Bethlehem Armory Page 2

=====

7. Description.

Located in the City of Bethlehem, on a sloping, corner lot fronted by a narrow lawn, the Bethlehem Armory consists of a brick building constructed in three sections. The main, front section was built in 1930 in the Art Deco style. Laid out on an I plan, this section has the drill hall located between a front, administrative area and a rear, kitchen/locker room area. It has a two-story facade (including exposed basement). In 1938, a one-story maintenance addition was attached to the right rear of the first section. In 1968 a second maintenance section was added to the left side of the first maintenance addition. Despite these additions, the armory retains good integrity.

The 1930 section has a concrete foundation and a hip roof. Flat roofs cover the maintenance sections. Measuring an estimated 85 x 102 feet, the 1930 section features narrow vertical casement windows in pairs or triplets, brick sills and lintels, a parapet with stone coping, and a brick chimney, rising above the left side elevation.

The main (north) elevation of the 1930 section is divided into thirds, with the middle portion slightly recessed and having a higher parapet than the outer portions. The center third of the facade contains two, slightly recessed, glass double door entrances and transoms at basement level, beneath an entrance-long, stone plaque, inscribed: "ARMORY." The plaque forms the sills of three recessed strips of first-story windows surmounted by patterned brick work. At ground level, a sidewalk leads from the entrance out to Prospect Street. To each side of the entrance, two recessed strips of windows on the basement and first stories are separated by brick piers with stone caps. The outer thirds of the facade have two recessed strips of windows on the basement and first stories with patterned brick work above.

The left (east) side elevation of the 1930 section has recessed strips of elongated twelve-light casement windows on the first story. The middle, drill hall section consists of four groups of three strips, with shorter strips of smaller, six-light casement windows piercing the concrete basement. The ends of the elevation project slightly from the wall, and have two recessed strips of windows on the main story and a parapet above. Two overhead garage doors open the basement toward the rear of the elevation.

United States Department of the Interior
National Park Service

NATIONAL REGISTER OF HISTORIC PLACES
CONTINUATION SHEET

Section number: 7

Bethlehem Armory

Page 3

=====
The right (west) side elevation of the 1930 section is a mirror image of the first story of the left side, except for the exclusion of the chimney.

On the rear elevation of the 1930 section, the attached 1938 maintenance section obscures most of the basement wall. The first story of the rear elevation has five alternating panels of two eight-light casement windows and two twelve-light casement windows, separated by projecting brick wall surfaces that suggest wide pilasters. The center of the elevation rises in a parapet, with three narrow, rectangular vents located at the top of the center panels. Two sets of double door entrances, opening on to the roof of the maintenance section provide access to the first floor, rear locker room. To the left of the rear elevation, a walkway runs along the right (west) side elevation, affording access to Prospect Street.

Measuring an estimated 63 x 68 feet, the 1938 maintenance section has exterior walls of mostly concrete. The rear elevation supports a brick parapet with coping, and contains a door in the right-hand corner and a window at the brick parapet line.

Slightly lighter in color, the 1968 addition rises higher than the 1938 maintenance section, and contains recessed strips of casement windows. Measuring approximately 63 x 53 feet, it is slightly shorter in length than the 1938 section, leaving a space between its front wall and the rear of the original building. A garage door and entrance pierce the front wall.

In the interior, the armory basement has an assortment of rooms including a rifle range, boiler room, day room, men's room, and recreation room. All of the rooms have concrete walls and floors. On this level, interior doors provide access to the maintenance additions. The first floor consists of offices and a lobby at the front of the building and a kitchen and a long locker room behind the drill hall. The drill hall covers an area of 7,822 square feet and has a wood floor and a roof that is supported by riveted, steel Fink trusses. The 1938 addition is divided into small and large maintenance areas. The 1968 section contains a large open space.

In addition to the 1938 and 1968 sections, the armory has undergone other alterations, such as the second-floor balcony in the drill hall being closed off and partitioned into offices, and the basement showers and toilets being rehabilitated. The armory retains many of the original doors and windows.

United States Department of the Interior
National Park Service

NATIONAL REGISTER OF HISTORIC PLACES
CONTINUATION SHEET

Section number: 8, 9, 10 Bethlehem Armory Page 2

=====

8. Significance.

The Bethlehem Armory is significant under criteria A and C. It is a member of the State Armory Building Property type under the multiple property nomination: Pennsylvania National Guard Armories. It was built in 1930 for Battery D, 213th Coast Artillery of the Pennsylvania National Guard, with a rear, one-story, maintenance section added later, in 1938, and a garage extension to the addition, constructed in 1968. Designed by Lovelace and Spillman of Bethlehem, the Bethlehem armory is one of at least nine armories built in Pennsylvania, between 1912 and 1938, having an I plan. In addition to the maintenance area and the garage, typical spaces of the armory include the drill hall, rifle range, kitchen, boiler room, locker room, rest rooms, and offices. The 1938 addition was a W.P.A. project designed by Allentown architect George E. Yundt. The Bethlehem Armory represents the common function of armories to serve the Pennsylvania National Guard for storage, meeting, and training. As such it is significant in the context of Pennsylvania's military history as well as representing a distinctive building type.

9. Bibliography.

Refer to section H in Multiple Resource Nomination: Pennsylvania National Guard Armories.

10. Verbal Boundary Description.

The boundaries as described in Lehigh County Deed Book, Volume 463, page 117, and Volume 1056, page 31.

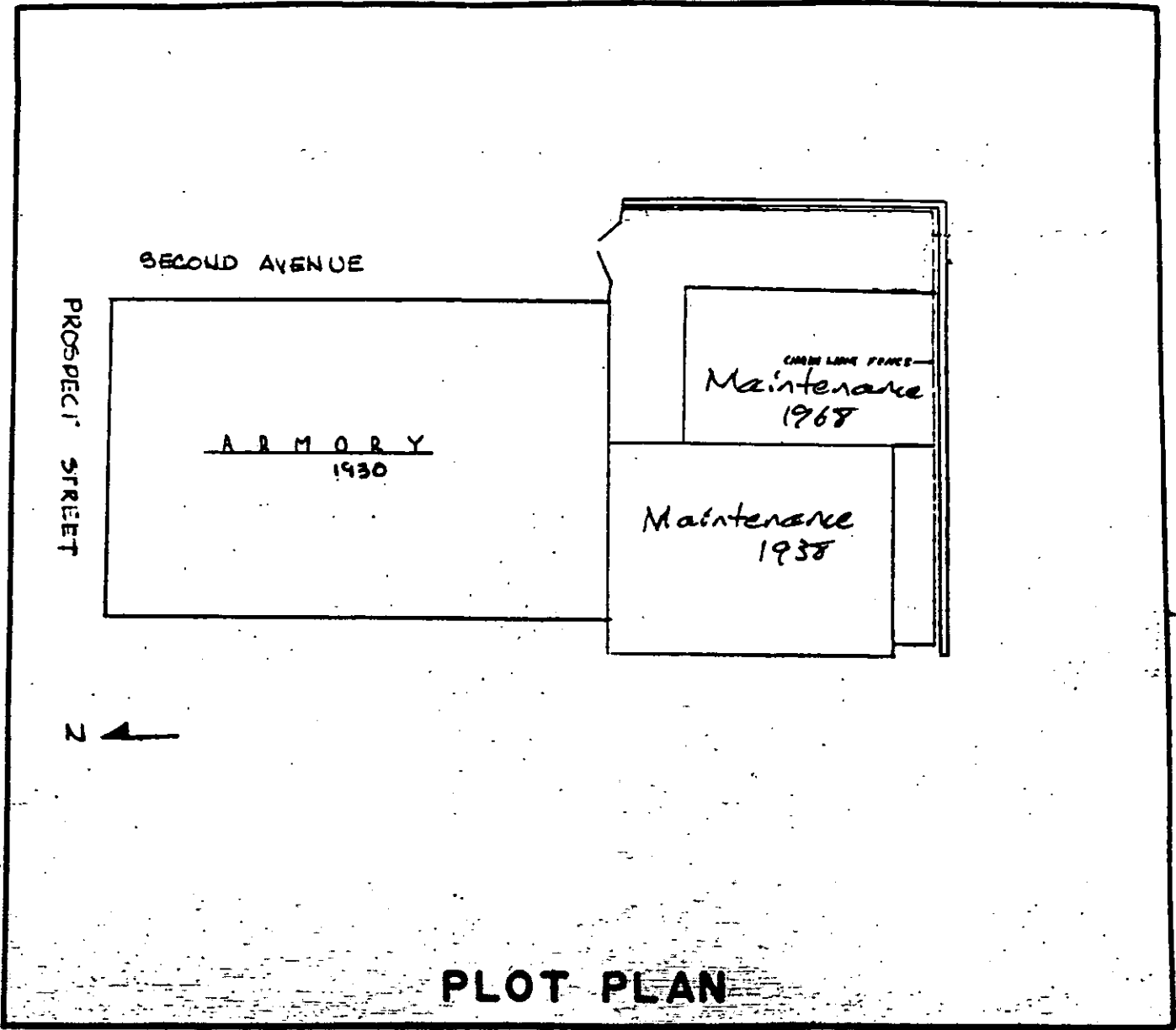

Bethlehem Armory
Lehigh County

ALLENTOWN EAST QUADRANGLE
PENNSYLVANIA
7.5 MINUTE SERIES (TOPOGRAPHIC)
SW/4 ALLENTOWN 15' QUADRANGLE

5965 III NE
INAZARETHI

25' 465 2 650 000 FEET 466 1.6 MI. TO INTERSTATE 78 468 75° 22' 30" 40° 37' 30"

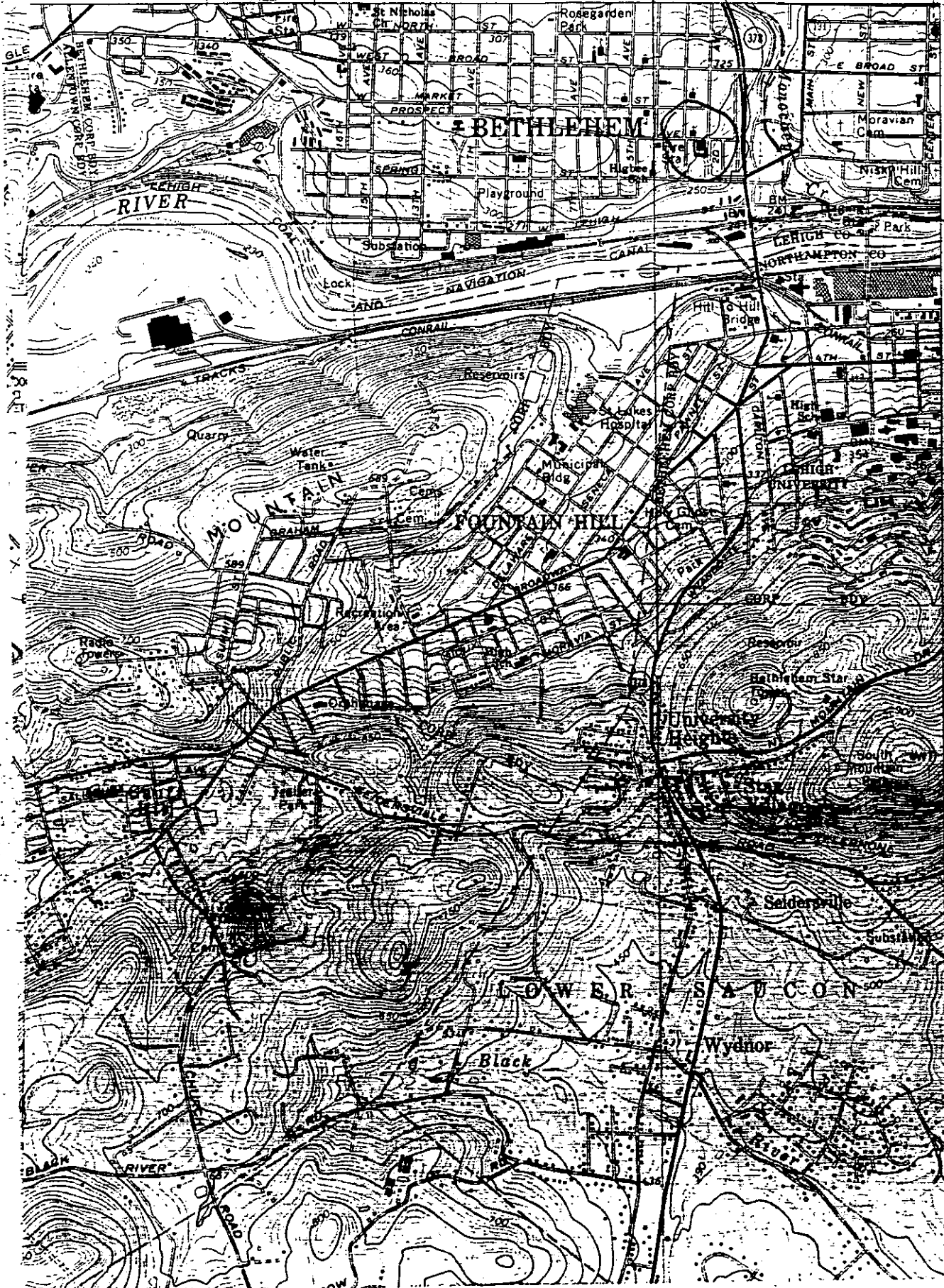

BETHLEHEM
ARMOZY
ALLENTOWN
QUAD
ZONE 18
E 467200
N 4496340
*Lehigh
County*

4496
4494
4492

470 000
FEET

35

4492