

PENNSYLVANIA HISTORIC RESOURCE SURVEY FORM
 BUREAU FOR HISTORIC PRESERVATION Box 1026
 PA HISTORICAL & MUSEUM COMMISSION Harrisburg, PA 17120

7. Local survey organization
 Philadelphia Historical Commission

8. property owners name and address
 School District of Philadelphia
 230 N. 21st Street
 Philadelphia, Pennsylvania 19103

9. tax parcel number / other number
 886154500

10. U.T.M. zone **18** easting **4871010**
 1.9 acres
 northing **4432340**

11. status (other surveys, lists etc.)

usgs sheet: **Germantown**

12. classification
 site () structure () object ()
 building () Thematic
 in N.R. district yes () no ()

13. date(s) (how determined)
 1926-1927

14. period
 1926-1927

15. style, design or folk type
 Late Gothic Revival

19. original use
 School

20. present use
 School

16. architect or engineer
 Irwin T. Catharine

17. contractor or bullder
 Unknown

18. primary building mat./construction
 Brick with stone trim

21. condition
 Good

22. integrity
 Fair

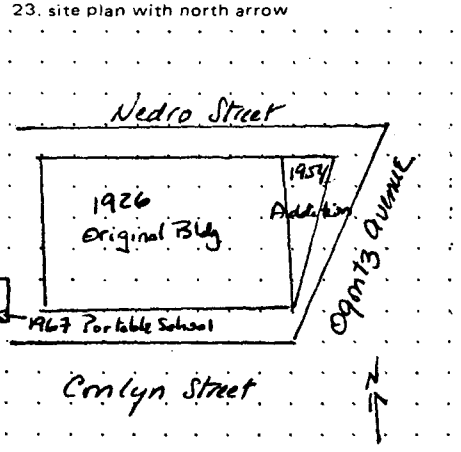

BLACK AND WHITE PRINT(S)
 3 1/2" x 5" enlargement or medium format contact
 note location of negative in block 24.

24. photo notation

25. file/location

26. brief description (note unusual features, integrity, environment, threats and associated buildings)

See reverse side

(continue on back if necessary)

27. history, significance and/or background

See reverse side

(continue on back if necessary)

28. sources of information

See reverse side

(continue on back if necessary)

29. prepared by:
 Jefferson M. Moak

30. date
 6-20-87

revision(s)

1. County
 Philadelphia

2. Municipality
 Philadelphia

3. street address or specific location
 1800-1856 Nedro Street

4. survey code

5. present name
 Joseph Pennell School

6. other name (historic name if any)
 N/A

3. ADDRESS: Nedro Street, 1800-1856

5. NAME: Pennell, Joseph, School

6. FORMER NAME:

13. DATES: 1926-1927

ADDITIONS: 1954, 1967

DESCRIPTION: A 3-story, 9-register, brick school building with projecting end registers, a central door openings with stone trim, 2-story stone bay fronting the second and third floors in the central registers, a 1-3-1 window pattern in the 2nd, 4th, 6th and 8th registers and two narrow openings in the 3rd and 7th registers. A flat roof tops the building fronted by a low parapet with stone coping. The openings on the end pavilions contain carved panels below the windows as part of their design. A one-story brick addition exists on the east side constructed in 1954. A portable school sits to the west. It was constructed in 1967.

HISTORY/SIGN.: The Pennell School is identical in plan and design to the Andrew Jackson School, the Eleanor Cope Emlen School and the Belmont School. The first mentioned school is already on the National Register, and the other two appear in the current multiple resource nomination. All are excellent examples of Catharine's use of the Late Gothic Revival style in his 1920's school designs.

Boundary Justification: The nominated property contains the contributing building, one non-contributing building, and all historically associated land.

National Register Criteria: C, Architecture

There is one contributing and one noncontributing building on the nominated property.

Verbal boundary: the nominated property is tax parcel #886154500.

28. SOURCES: School Board, "New Buildings Under Contract"
Edmunds, Chronological List of Philadelphia School Buildings
Sanborn Map Company, "Insurance Maps of Philadelphia"

EVALUATION: Catherine's work retains integrity of design despite the 1954 addition. This school meets the criteria for entry on the National Register.

EVALUATION

EVALUATOR(S)

Philadelphia County
Zone 18
UTM 18/485050/4432900

Philadelphia Public Schools
Thematic Nomination
Charles Wolcott Henry School
Zone 18
UTM 18/483200/4432650

Philadelphia Public Schools
Thematic Nomination
Joseph Pennell School
Philadelphia County
Zone 18
UTM 18/487100/4472340

Philadelphia Public Schools
Thematic Nomination
James Dobson School
Philadelphia County
Zone 18
UTM 18/480320/4431030

Philadelphia Public Schools
Thematic Nomination
William Levering School
Philadelphia County
Zone 18
UTM 18/481790/4430980

Philadelphia Public Schools
Thematic Nomination
Thomas Meehan School
Philadelphia County
Zone 18
UTM 18/485000/4430620

Termantown Quad

