

PENNSYLVANIA HISTORIC RESOURCE SURVEY FORM
BUREAU FOR HISTORIC PRESERVATION Box 1026
PA HISTORICAL & MUSEUM COMMISSION Harrisburg, PA 17120

7. Local survey organization

8. property owners name and address
 School District of Philadelphia
 21st & Winter Streets
 Philadelphia, Pennsylvania 19103

9. tax parcel number / other number
 #886133000

10. U.T.M. zone **18** easting **483360**

11. status (other surveys, lists etc.)

northing **44341010**

usgs sheet:

12. classification
 site () structure () object ()
 building () Thematic
 in N.R. district yes () no ()

13. date(s) (how determined)
 1926-1927

15. style, design or folk type
 Late Gothic Revival

19. original use
 School

14. period
 1926-1927

20. present use
 School

16. architect or engineer
 Irwin T. Catharine

17. contractor or bullder
 Unknown

18. primary building mat./construction
 Brick with stone trimmings

21. condition Good

22. integrity Fair

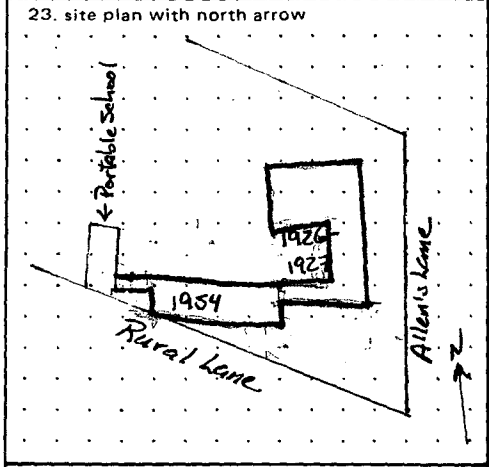

6. other name (historic name if any)
 N/A

2. municipality
 Philadelphia

3. street address or specific location
 135 W. Allen's Lane

BLACK AND WHITE PRINT(S)
 3 1/2" x 5" enlargement or medium format contact
 note location of negative in block 24.

24. photo notation

25. file/location

26. brief description (note unusual features, integrity, environment, threats and associated buildings)

See reverse side

(continue on back if necessary)

27. history, significance and/or background

See reverse side

(continue on back if necessary)

28. sources of information

See reverse side

29. prepared by:
 Jefferson M. Moak

30. date
 5-29-87

revision(s)

(continue on back if necessary)

1. County
 Philadelphia

5. present name
 Henry H. Houston School

4. survey code

3. ADDRESS: Allen's Lane, 135 W.
5. NAME: Houston, Henry H., School
6. FORMER NAME:

13. DATES: 1926-1927

ADDITIONS: 1954

DESCRIPTION: A 3-story, 9-register brick building set upon a raised basement, with each register containing three windows within a stone opening on each floor, a stone dripcourse, small stone beltcourse/cornice above the first and third floors, and a stone coping atop the crenellated parapet. The central register contains a projecting stone entryway with a Tudor-arched opening and the name of the school carved over this opening. A pair of small openings with stone surrounds pierces the parapet above the third floor in the central register. The side elevation stretches seven registers with a blank wall filling the register closest to the front, a slightly projecting second register with 1-2-1 openings highlighted by stone surrounds and stone panels beneath the openings, triple sash within the third to sixth registers and a single opening within the far register.

HISTORY/SIGN.: The Henry H. Houston School is one of five erected from the plans of School Board Type Number 153. It is not as flamboyant as some of Catharine's other designs of this period. The other schools of this type, and their dates of construction, are the Avery Harrington School (1926-1927), the William H. Harrison School (1928-1929), the Franklin Smedley School (1927-1928) and the Richmond School (1928-1929).

There is one contributing building on the nominated property.

Verbal boundary: the nominated property is tax parcel #886133000.

28. SOURCES: Edmunds, Chronological List of School Buildings, 1818-1934
School Board, "New Buildings Under Contract"

EVALUATION: This building warrants listing on the National Register for its place in the history of education and of school architecture in Philadelphia.

EVALUATION

EVALUATOR(S)

*Germantown
Lead*

Philadelphia Public Schools
Thematic Nomination
John Story Jenks School
Philadelphia County
Zone 18
UTM 18/482630/4435840

Philadelphia Public Schools
Thematic Nomination
Henry H. Houston School
Philadelphia County
Zone 18
UTM 18/483360/4434100

