

PENNSYLVANIA HISTORIC RESOURCE SURVEY FORM
 BUREAU FOR HISTORIC PRESERVATION Box 1026
 PA HISTORICAL & MUSEUM COMMISSION Harrisburg, PA 17120

7. Local survey organization

8. property owners name and address

School District of Philadelphia
 21st & Winter Streets
 Philadelphia, Pennsylvania 19103

9. tax parcel number / other number

10. U.T.M. zone 18 easting 4850810

11. status (other surveys, lists etc.)

northing 4421491010

usgs sheet:

12. classification
 site () structure () object ()
 building () Thematic
 in N.R. district yes () no ()

13. date(s) (how determined)
1936-1938

15. style, design or folk type

Art Deco/Art Moderne

19. original use

School

20. present use

School

16. architect or engineer
 Irwin T. Catharine

17. contractor or builder

unknown

18. primary building mat./construction
 Brick with stone and
 terra cotta trimmings

21. condition

Excellent

22. integrity

Excellent

23. site plan with north arrow

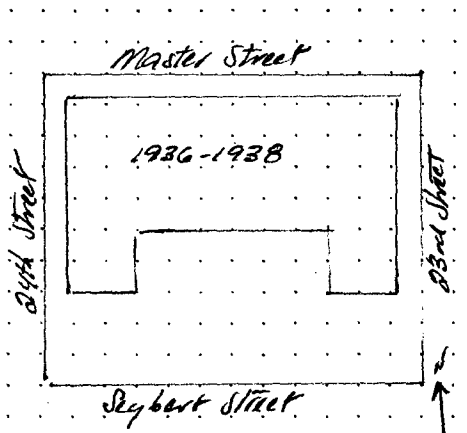

BLACK AND WHITE PRINT(S)
 3 1/2" x 5" enlargement or medium format contact
 note location of negative in block 24.

24. photo notation

25. file/location

26. brief description (note unusual features, integrity, environment, threats and associated buildings)

See reverse side

(continue on back if necessary)

27. history, significance and/or background

See reverse side

(continue on back if necessary)

28. sources of information

See reverse side

29. prepared by:

Jefferson M. Moak

30. date

5-20-87

revision(s)

(continue on back if necessary)

1. County Philadelphia
 5. present name
 Roberts Vaux Junior High School

2. municipality Philadelphia
 6. other name (historic name if any)
 N/A

3. street address or specific location
 2300-2344 W. Master Street

4. survey code

3. ADDRESS: Master Street, 2300-2344 W.

5. NAME: Vaux, Roberts, Junior High School

6. FORMER NAME:

13. DATES: 1936-1937

ADDITIONS:

DESCRIPTION: A 4-story, 23-register, yellow brick school building. The end two registers on each end are contained within a projected pavilion, separated from each other by brick piers. Paired sash sit within the openings on each floor. The main facade contains seven major registers and one small register on either side of the entrance block. Each register contains three openings, with diapered brick panels beneath the openings, small brick pilasters separating the various sash and large brick piers the registers. The small register, located on either side of the entrance block, contains only a single opening on each floor. The entrance block has a large 2-story Tudor-arched entrance opening at the base, three openings on each floor above and exquisitely carved panels above the fourth floor openings. Carved terra cotta adorns the tops of the various piers throughout the building.

HISTORY/SIGN.: The Roberts Vaux Junior High School is the last of the junior high school designs (School Board Type No. JHS-11) executed by Catharine during his tenure as School Board Architect. Unlike many of the early designs, i.e. JHS-4, this is the only school constructed from this design.

28. SOURCES: School Board, "New School Buildings Under Contract"

EVALUATION: This building warrants inclusion onto the National Register as part of the Philadelphia Public School Thematic District.

EVALUATION

EVALUATOR(S)



Philadelphia Public Schools
 Thematic Nomination
 Robert Vaux School
 Philadelphia Co.
 Zone 18
 E - 485080
 N - 4424900

Philadelphia Public Schools
 Thematic Nomination
 George Chandler School
 Philadelphia County
 Zone 18
 UTM 18/489150/4424200

Philadelphia Public Schools
 Thematic Nomination
 Thomas Jefferson School
 Philadelphia County
 Zone 18
 UTM 18/487740/4424000

Philadelphia Public Schools
 Thematic Nomination
 Mary Channing Wister School
 Philadelphia County
 Zone 18
 UTM 18/487120/4423880

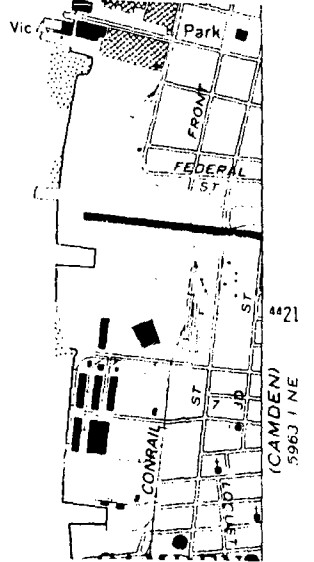

4421
 (CAMDEN)
 3963 7 NE