

PENNSYLVANIA HISTORIC RESOURCE SURVEY FORM
BUREAU FOR HISTORIC PRESERVATION Box 1026
PA HISTORICAL & MUSEUM COMMISSION Harrisburg, PA 17120

7. Local survey organization

8. property owners name and address
 School District of Philadelphia
 21st & Winter Streets
 Philadelphia, Pennsylvania 19103

9. tax parcel number / other number
 11. status (other surveys, lists etc.)

10. U.T.M. zone **18** easting **4171914810**
 northing **41411951210**
 usgs sheet:

12. classification
 site () structure () object ()
 building () Thematic
 in N.R. district yes () no ()

13. date(s) (how determined)
1937-1938
 14. period **1921-1940**

15. style, design or folk type
Art Moderne

19. original use **School**
 20. present use **School**

16. architect or engineer
Irwin T. Catharine

17. contractor or builder
McCloskey & Company

18. primary building mat./construction
Yellow brick with limestone trimmings

21. condition **Excellent**
 22. integrity **Excellent**

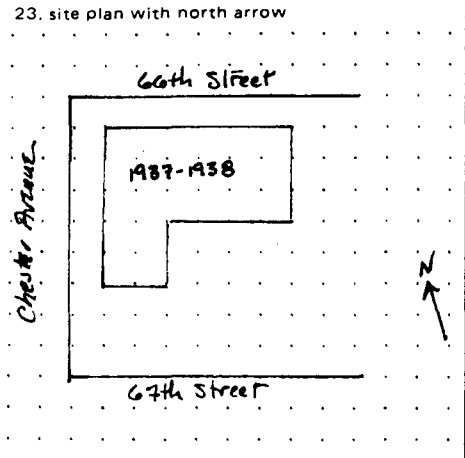

USE THIS COPY FOR DUPLICATING

BLACK AND WHITE PRINT(S)
 3 1/2" x 5" enlargement or medium format contact
 note location of negative in block 24.

24. photo notation

25. file/location

26. brief description (note unusual features, integrity, environment, threats and associated buildings)

See reverse side

27. history, significance and/or background (continue on back if necessary)

See reverse side

28. sources of information

See reverse side

29. prepared by:

Jefferson M. Moak

30. date **5-28-87** revision(s)

(continue on back if necessary)

1. County **Philadelphia**
 5. present name **Joseph W. Catharine School**

2. municipality **Philadelphia**
 6. other name (historic name if any) **N/A**

3. street address or specific location
6600 Chester Avenue

4. survey code

3. ADDRESS: Chester Avenue, 6600
5. NAME: Catharine, Joseph W., School
6. FORMER NAME:

13. DATES: 1937-1938

ADDITIONS:

DESCRIPTION: A 3-story, 6-register, yellow brick school building. The main entrance is located in the second register on the left with a stone surround. The openings above are framed in stone. The window arrangements of the upper floors in this register are two narrow openings flanking a large opening. The four registers to the right are identical; each separated by a brick pilaster and containing window arrangements of 1-3-1 within. Stone sills appear beneath all openings. A stone and brick beltcourse runs above the third floor openings. A stone coping tops the building. The left register stands only two stories high with a single opening at the ground level. A vertical limestone band appears above this door opening. The remainder of the register consists of brick set in several planes.

HISTORY/SIGN.: This building represents one of the last and most dynamic of Irwin T. Catharine's elementary school designs. The building is named for Catharine's father, a long-time member and former president of the Philadelphia Board of Education. Constructed from the plans of School Board Type Number 171, it is the only building strictly of this design. A variant design was used for the Joseph H. Brown School on Frankford Avenue above Rhawn Street. Both of them contain many of the same design elements used for the large Bartram and Central High Schools, also erected in 1937-1938.

28. SOURCES: Edmonds, Chronological List of Public School Buildings, 1818-1934
School Board, "New School Buildings Under Contract"
Building Permit 1937 # 2611

EVALUATION: The Catharine School's architectural merits would appear to be enough to recommend its inclusion onto the National Register as part of the Philadelphia Public Schools Thematic District.

EVALUATION

EVALUATOR(S)

James Alcorn
Philadelphia County
Zone 18
UTM 18/483050/4420360

Philadelphia Public Schools
Thematic Nomination
Joseph Catherine School
Philadelphia County
Zone 18
UTM 18/479480/4419520

Philadelphia Public Schools
Thematic Nomination
Charles Audenried School
Philadelphia County
Zone 18
UTM 18/482960/4420210

Philadelphia Public Schools
Thematic Nomination
Patterson/Tilden School
Philadelphia County
Zone 18
UTM 18/479730/4418260

Philadelphia Quad

Philadelphia Public Schools
Thematic Nomination
Edwin Vare School
Philadelphia County
Zone 18
UTM 18/484100/4419320

Philadelphia Public Schools
Thematic Nomination
George Wolf School
Philadelphia County
Zone 18
UTM 18/479980/4416300

