

PENNSYLVANIA HISTORIC RESOURCE SURVEY FORM
BUREAU FOR HISTORIC PRESERVATION Box 1026
PA HISTORICAL & MUSEUM COMMISSION Harrisburg, PA 17120

7. Local survey organization
Philadelphia Historical Commission

8. property owners name and address
 School District of Philadelphia
 21st & Winter Streets
 Philadelphia, Pennsylvania 19103

9. tax parcel number / other number
 886221500

10. U.T.M. zone **18** easting **4785810**
 1.9 acres
 4424800 northing

11. status (other surveys, lists etc.)
 PHRS

usgs sheet: **Lansdowne**

12. classification
 site () structure () object ()
 building () Thematic
 in N.R. district yes () no ()

13. date(s) (how determined)
1922-1924

14. period
1922-1924

15. style, design or folk type
Colonial Revival

19. original use
School

20. present use
School

16. architect or engineer
Irwin T. Catharine

17. contractor or builder
Sinclair & Grigg

18. primary building mat./construction
Brick with stone trimmings

21. condition
Good

22. integrity
Good

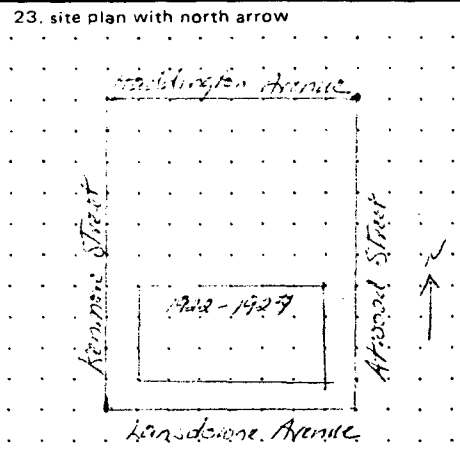

BLACK AND WHITE PRINT(S)
 3 1/2" x 5" enlargement or medium format contact
 note location of negative in block 24.

USE THIS COPY FOR DUPLICATING

24. photo notation

25. file/location

26. brief description (note unusual features, integrity, environment, threats and associated buildings)

See reverse side

(continue on back if necessary)

27. history, significance and/or background

See reverse side

(continue on back if necessary)

28. sources of information

See reverse side

(continue on back if necessary)

29. prepared by:
Jefferson M. Moak

30. date **5-28-87** revision(s)

5. present name
Lewis C. Cassidy School

2. municipality
Philadelphia

6. other name (historic name if any)
N/A

3. street address or specific location
6523-6543 Lansdowne Avenue

4. survey code

3. ADDRESS: Lansdowne Avenue, 6523-6543

5. NAME: Cassidy, Lewis C., School

6. FORMER NAME:

13. DATES: 1922-1924

ADDITIONS:

DESCRIPTION: A 3-story, 9-register, brick building set upon a raised brick basement. The left and right registers are recessed with narrow horizontal openings on each floor. The interior registers are set within a shallow U in a 1-5-1 pattern. Large stone arched surrounds appear on the first level, which is between floors, masking the auditorium space within. A double stone cornice sits above these arches. Square openings pierce the third floor. Another stone cornice appears above the third floor openings. A brick parapet capped by stone coping sits above this cornice. The name of the school is carved on a stone set within this parapet. The side elevations measure five registers with a projecting 1-story entrance pavilion in the second register from the front on both elevations. These entrances are framed with double pilasters and an entablature. A large arched opening appears above the entryway. The remaining registers have bands of windows in a 1-3-1 pattern. A stone dripcourse appears above the basement; stone cornices above the second and third floors.

HISTORY/SIGN.: The School District of Philadelphia engaged in an ambitious building program in the early 1920s. Eight junior high schools and 13 elementary schools were authorized between September 1921 and December 1923, along with numerous additions to existing schools. Of the 13 elementary schools, eight were constructed from the same set of plans, School Board Type Number 137. The first was the Ferguson School, awarded in September 1921. The second was the Cassidy School in 1922. The other six, all begun during 1923, are the Edmonds, Hamilton Disston, Logan, Mann, Bregy and Blankenburg Schools, respectively. The design is another which adhered to many of the standards set up by H. deCourcy Richards while he was Chief Designer between 1906 and 1918 and is similar to that employed for the Patterson, Thomas and Fell Schools in 1920-1922. The windows were replaced during the School Board's current system-wide conversion.

National Register Criteria: C, Architecture

28. SOURCES: Edmonds, Chronological List of Public School Buildings, 1818-1934
School Board, "New Buildings Under Contract"
Building Permit 1922 # 4210

EVALUATION: This building warrants inclusion to the National Register as part of the Philadelphia Public Schools Thematic District, despite the recent window alterations.

Boundary Justification: The nominated property contains the contributing building and all historically associated land.

There is one contributing building on the nominated property.

EVALUATION

Verbal boundary: the nominated property is tax parcel #886221500.

EVALUATOR(S)

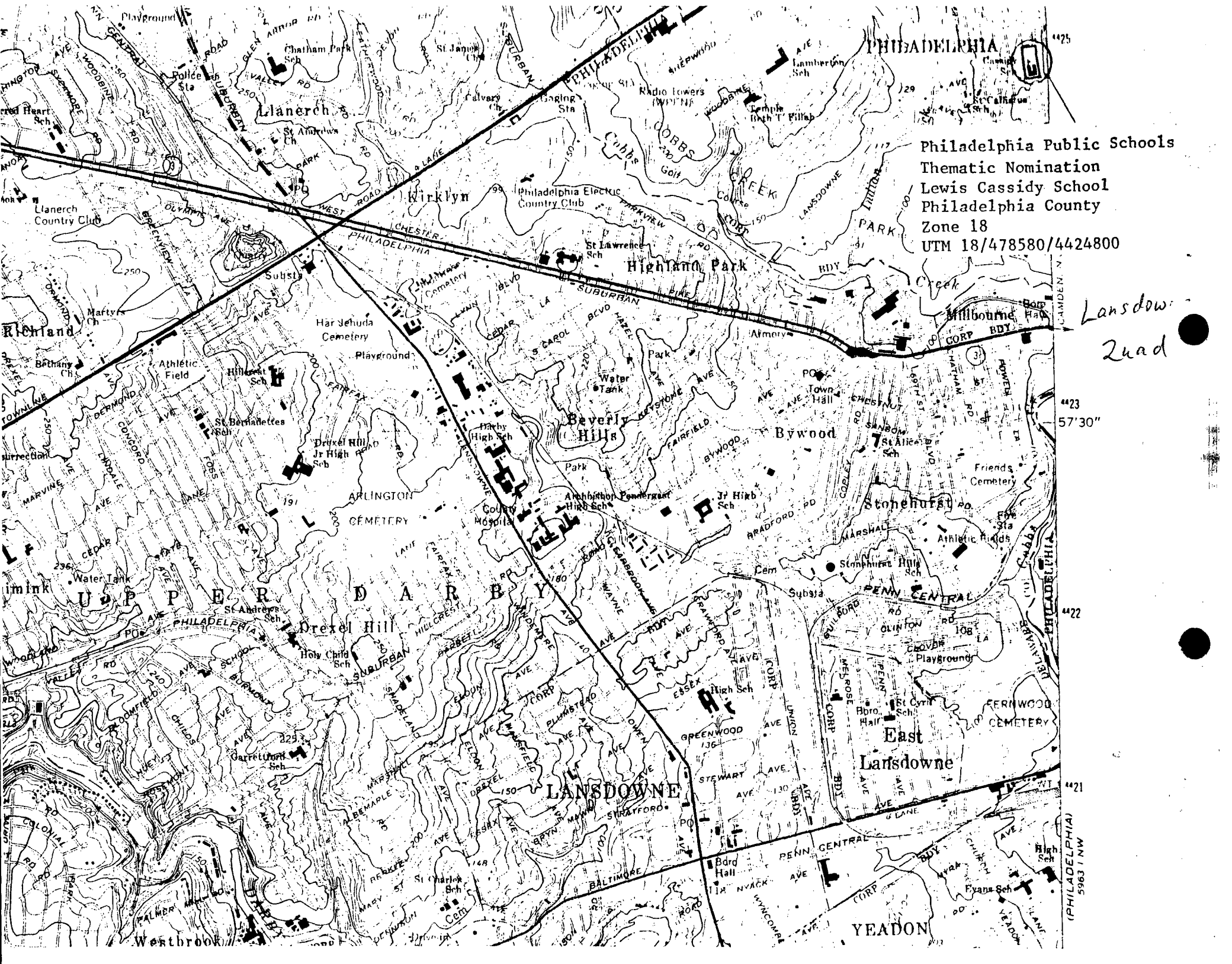

Philadelphia Public Schools
Thematic Nomination
Lewis Cassidy School
Philadelphia County
Zone 18
UTM 18/478580/4424800

Lansdowne
Zuad

423
57'30"

422

421

(PHILADELPHIA)
5963 1 NW