

PENNSYLVANIA HISTORIC RESOURCE SURVEY FORM  
 BUREAU FOR HISTORIC PRESERVATION Box 1026  
 PA HISTORICAL & MUSEUM COMMISSION Harrisburg, PA 17120

7. Local survey organization

8. property owners name and address

Constantine Bohachevsky  
 932 N. Franklin Street  
 Philadelphia, Pennsylvania

9. tax parcel number / other number

10. U.T.M. zone 18 easting 49192110

11. status (other surveys, lists etc.)

northing 44306810

usgs sheet:

12. classification  
 site ( ) structure ( ) object ( )  
 building ( ) Thematic  
 in N.R. district yes ( ) no ( )

13. date(s) (how determined)

1900-1901

14. period

15. style, design or folk type

Colonial Revival

19. original use

Public School

20. present use

Parochial School

16. architect or engineer

Andrew Sauer

17. contractor or builder

Harry Kuemmerle

18. primary building mat./construction

Stone

21. condition Good

22. integrity Good

23. site plan with north arrow

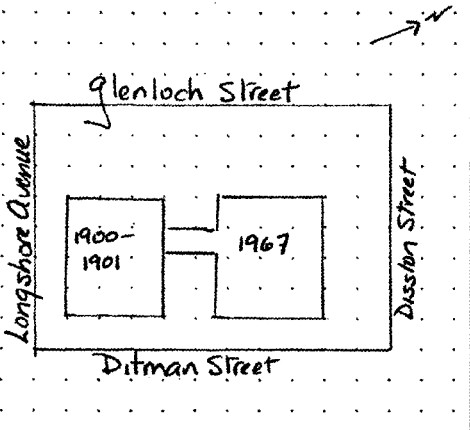

BLACK AND WHITE PRINT(S)  
 3 1/2" x 5" enlargement or medium format contact  
 note location of negative in block 24.

24. photo notation

25. file/location

26. brief description (note unusual features, integrity, environment, threats and associated buildings)

See reverse side

27. history, significance and/or background

See reverse side

28. sources of information

See reverse side

29. prepared by:

Jefferson M. Moak

30. date

6-20-87

revision(s)

(continue on back if necessary)

1. County Philadelphia

2. municipality Philadelphia

3. street address or specific location  
 4521 Longshore Avenue

4. survey code

5. present name  
 St. Josephat's Catholic School

6. other name (historic name if any)  
 Mary Disston Public School

3. ADDRESS: Longshore Avenue, 4521  
5. NAME: St. Josaphat's Catholic School  
6. FORMER NAME: Disston, Mary, School

13. DATES: 1900-1901                      ADDITIONS: 1967

DESCRIPTION: A 2-story, 3-register, stone school building. It is set in a U-plan with a recessed center. The three openings on the first floor of the wings are arched; the second floor openings are rectangular. Stone sills appear under all openings. The recessed central part is one of the more ornate details found on a public school building. The first floor possesses a columnaded porch with arched openings fronting the central arched doorway. This porch supports a second floor balcony. The name of the school appears above the openings of the porch. The second floor has a central Palladian window flanked by single narrow rectangular openings. The hipped roof is pierced by a single broken pedimented dormer over the central register. A rear addition constructed in 1967 is connected to the main building by a corridor wing; it does not seriously affect the original design.

HISTORY/SIGN.: The Mary Disston School, now St. Josaphat's Catholic School, is one of the few surviving designs of Andrew Sauer while he worked for the Philadelphia School Board. Its design is unique and the building stands as a landmark within its particular neighborhood.

28. SOURCES: Edmunds, The Public School Buildings of Philadelphia  
Edmunds, Chronological List of Philadelphia School Buildings  
Sanborn Map Company, "Insurance Maps of Philadelphia"

EVALUATION: Despite the rear addition, the unique design of the Mary Disston School makes it a candidate for inclusion onto the National Register as part of the Philadelphia Public Schools Thematic District.

EVALUATION

EVALUATOR(S)

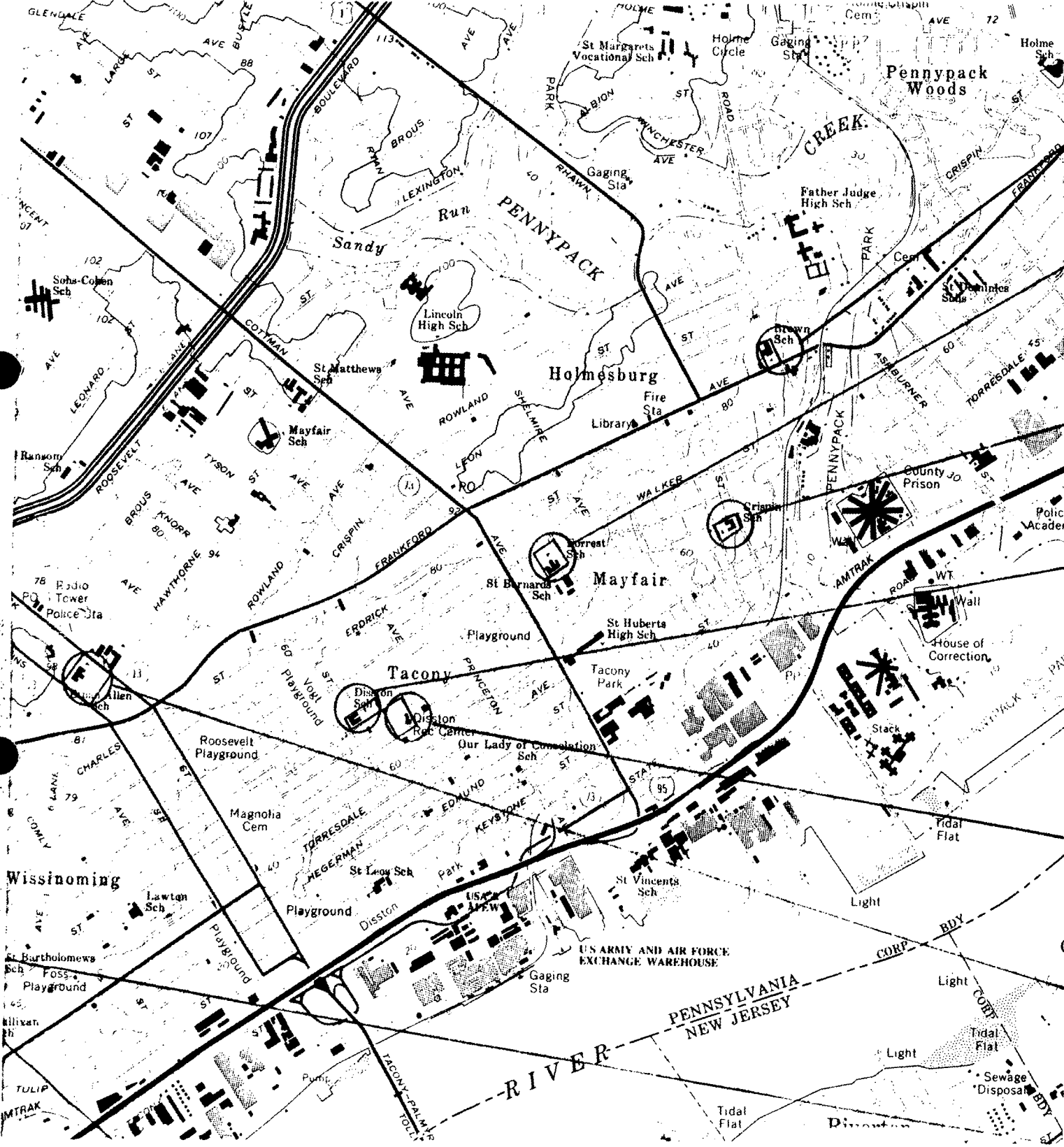

Torresdale  
 Philadelphia Public Schools  
 Thematic Nomination  
 Joseph Brown School  
 Philadelphia County  
 Zone 18  
 UTM 18/497860/4432360

Philadelphia Public Schools  
 Thematic Nomination  
 Edwin Forrest School  
 Philadelphia County  
 Zone 18  
 UTM 18/496890/4431380

Philadelphia Public Schools  
 Thematic Nomination  
 Benjamin Crispin School  
 Philadelphia County  
 Zone 18  
 UTM 18/497700/4431570

Philadelphia Public Schools  
 Thematic Nomination  
 Hamilton Disston School  
 Philadelphia County  
 Zone 18  
 UTM 18/495970/4430680

Philadelphia Public Schools  
 Thematic Nomination  
 Mary Disston School  
 Philadelphia County  
 Zone 18  
 UTM 18/496210/4430680

Philadelphia Public Schools  
 Thematic Nomination  
 Ethan Allen School  
 Philadelphia County  
 Zone 18  
 UTM 18/494680/4430840

Philadelphia Public Schools  
 Thematic Nomination

*Frankford Quad*

4431

PHILADELPHIA CO  
 PENN CO

PENNSYLVANIA  
 NEW JERSEY

DELaware RIVER