

PENNSYLVANIA HISTORIC RESOURCE SURVEY FORM
 BUREAU FOR HISTORIC PRESERVATION Box 1026
 PA HISTORICAL & MUSEUM COMMISSION Harrisburg, PA 17120

7. Local survey organization

Philadelphia Historical Commission

8. property owners name and address

School District of Philadelphia
 21st & Winter Streets
 Philadelphia, Pennsylvania 19103

9. tax parcel number / other number

886208500

10.

U.T.M. zone 18 easting 4850810
 less than one acre
 northing 442510610

11. status (other surveys, lists etc.)

usgs sheet: Philadelphia

12. classification
 site () structure () object ()
 building () Thematic
 in N.R. district yes () no ()

13. date(s) (how determined)

1925-1926

14. period

1925-1926

15. style, design or folk type

Art Deco

19. original use

School

20. present use

School

16. architect or engineer

Irwin T. Catharine

17. contractor or builder

Unknown

18. primary building mat./construction

Brick with terra-cotta & limestone trim

21. condition

Excellent

22. integrity

Good

23. site plan with north arrow

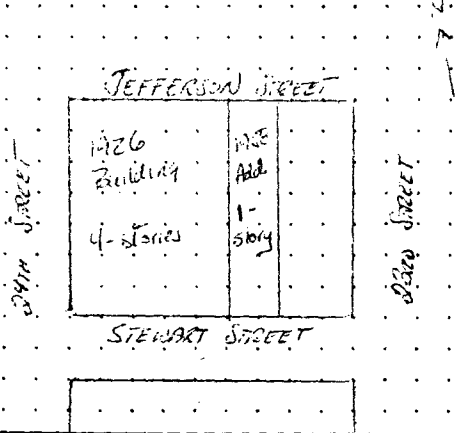

BLACK AND WHITE PRINT(S)
 3 1/2" x 5" enlargement or medium format contact
 note location of negative in block 24.

24. photo notation

25. file/location

26. brief description (note unusual features, integrity, environment, threats and associated buildings)

See reverse side

27. history, significance and/or background

See reverse side

28. sources of information

See reverse side

29. prepared by:

Jefferson M. Moak

30. date

5-22-87

revision(s)

1. County Philadelphia
 2. municipality Philadelphia
 3. street address or specific location 2300 Jefferson Street
 4. survey code
 5. present name General John F. Reynolds School
 6. other name (historic name if any) N/A

(continue on back if necessary)

(continue on back if necessary)

(continue on back if necessary)

Philadelphia Quad

Philadelphia Public Schools
Thematic Nomination
General John Reynolds School
Philadelphia County
Zone 18

UTM 18/485080/442560

Philadelphia Public Schools
Thematic Nomination
Muhlenburg School
Philadelphia County

Zone 18

UTM 18/486030/4424750

Philadelphia Public
Thematic Nomination
Thomas Fitzsimmons J
Philadelphia County

Zone 18

UTM 18/485040/4426860

Philadelphia Public School Philadelphia
Thematic Nomination Thematic Nomi

H/S Murrell Dobbins School
Philadelphia County
Zone 18

UTM 18/485720/4427040

William Harri
Philadelphia
Zone 18

UTM 18/486860

