

PENNSYLVANIA HISTORIC RESOURCE SURVEY FORM
 Bureau for Historic Preservation
 PA Historical & Museum Commission

Box 1026
 Harrisburg, PA 17120

9. HISTORICAL DATA

8. USGS QUAD. Norristown 18

UTM's: Zone 18

E | 4 | 7 | 0 | 6 | 2 | 0 |

N | 4 | 4 | 2 | 8 | 8 | 6 | 0 |

E | | | | | | |

N | | | | | | |

Designer/Engineer: Unknown

Builder/Contractor: Unknown

Bridge Company: Unknown

Date(s): 1905 ; basis Plaque on bridge

_____ ; basis

_____ ; basis

_____ ; basis

Use: Vehicular present; Vehicular original.

10. SITE PLAN

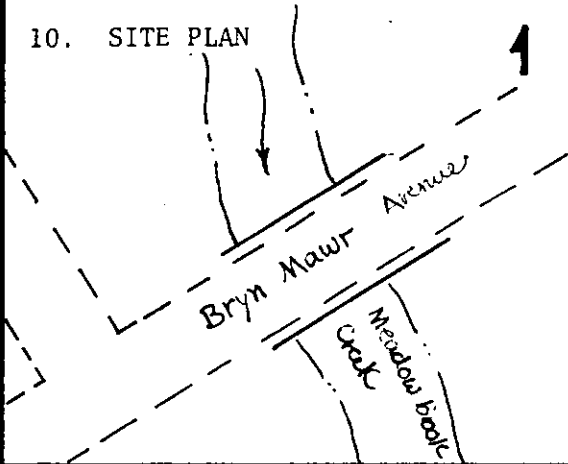

11. INTEGRITY

altered; _____

X unaltered; _____

moved; _____

Explain:

concrete work on structure
 extensive

12. VIEW

no.

PHOTO

13. COMMENTS

Unusual features:

Donated by George W.C.
 Drexel. Ornate parapet
 cap

Locale/environment: Suburban; near private
 school

Machinery (describe/identify type/
 equipment):

14. DIMENSIONS

spans: _____ no., 75 ft. O/A

main: 1 no., 10 ft.

secondary: _____ no., _____ ft.

approach: _____ no., _____ ft.

piers: _____ no.

towers: _____ no., _____ ft.

1. County Delaware	2. Municipality Raddor Twp.	3. Structure No. 2 3 2 0 0 0 3 5 0 0 1 8 3 1 1 2	4. Survey Code 811 S-28
5. Present Name Bridge in Raddor Township #2	6. Other name (historic name if any) n/a	7. Crossing Bryn Mawr Avenue over Meadow Brook Creek	

15. TYPE

CHARACTERISTICS

Truss: continuous/cantilever:

- webbing: _____
- anchor span: _____
- cantilever span: _____
- suspended span: _____
- thru/deck/low (pony): full-slope/half-hip.
- connections: pin/riveted.
- eyebars: loop welded/die forged.
- railing: _____
- columns: _____

Arch: masonry/metal:
brick

- thru/deck/1/2-thru.
- fixed (hingeless) /1/2/3-hinged.
- ribs: solid/braced; crescent/parallel.
- spandrels: open/solid/braced.
- intrados/vault; ribbed/solid.
- shape: semi-circular/elliptical/segmental; stilted.
- skew

Suspension:

- stiffening: braced-chain (1/2/3-hinged) /suspended truss.
- wire cable: twisted/parallel.
- eyebar chain.
- back-stay: straight/curved.

Bascule:

- single/double leaf.
- rolling lift: Schertzer.
- trunnion: simple (Chicago) /multiple (Strauss).
- counterweights: heel/overhead.
- Page/Rail.
- semi-lift/direct lift.

Swing:

- bearing: center/rim/combination.
- (see Truss above).

Vertical Lift:

- (see Truss above).

Other:

- other: _____

16. MATERIALS (primary)

Superstructure	type	treatment/finish	source
main span:	<u>brick</u>	_____	_____
towers:	_____	_____	_____
railings:	<u>brick</u>	_____	_____
Substructure			
piers:	_____	_____	_____
abutments:	_____	_____	_____
wings:	<u>brick</u>	_____	_____
intrados/ribs:	_____	_____	_____
vousoirs:	<u>brick</u>	_____	_____

17. PHOTO NO's.
06-7 (24-31)

18. PREPARED BY:
AGENCY/ORGANIZATION: District 6-0
; DATE: December 20, 1982

Survey Number: S-28

Bridge Name and Address: Bridge in Radnor Township #2
L.R. 23035
Delaware County

Owner: Commonwealth of Pennsylvania
Department of Transportation
Transportation & Safety Building
Harrisburg, Pennsylvania 17120

Statement of Significance: Bridge #2 in Radnor Township is an unusual brick and concrete bridge constructed in 1905. The arch is unusually small, spanning only ten feet, and the vault is skewed. Its parapet ornamentation is of a scale typical of larger monumental structures built in the Gothic-Revival style, molded concrete and details and were built into sculptural parapet walls which harmonized with the bridge's early twentieth century suburban setting. This handsome bridge was built as a gift to Radnor Township. A commemorative bridge stone, set in the ornate parapet, reads: "Presented to Radnor Township by George W. C. Drexel, 1905". This bridge is a singular example among the nominated bridges in terms of its combination of small span, brick construction, and Gothic Revival ornamentation.

Area of Significance: Engineering.

Boundary Description: The nominated property consists of a 75 feet long by 25 feet wide rectangle whose vertices coincide with the outside corners of the bridge's wing walls, and includes only bridge superstructure and substructure.

Acreage of Nominated Property: Less than one acre.

Pennsylvania D.O.T. Owned Highway Bridges
 Bridge in Radnor Township #1 S-27

Delaware County
 Zone 18 *Newristown Quad*
 E 468250 N 4428000

(MEDIA)
 5963 IV NW

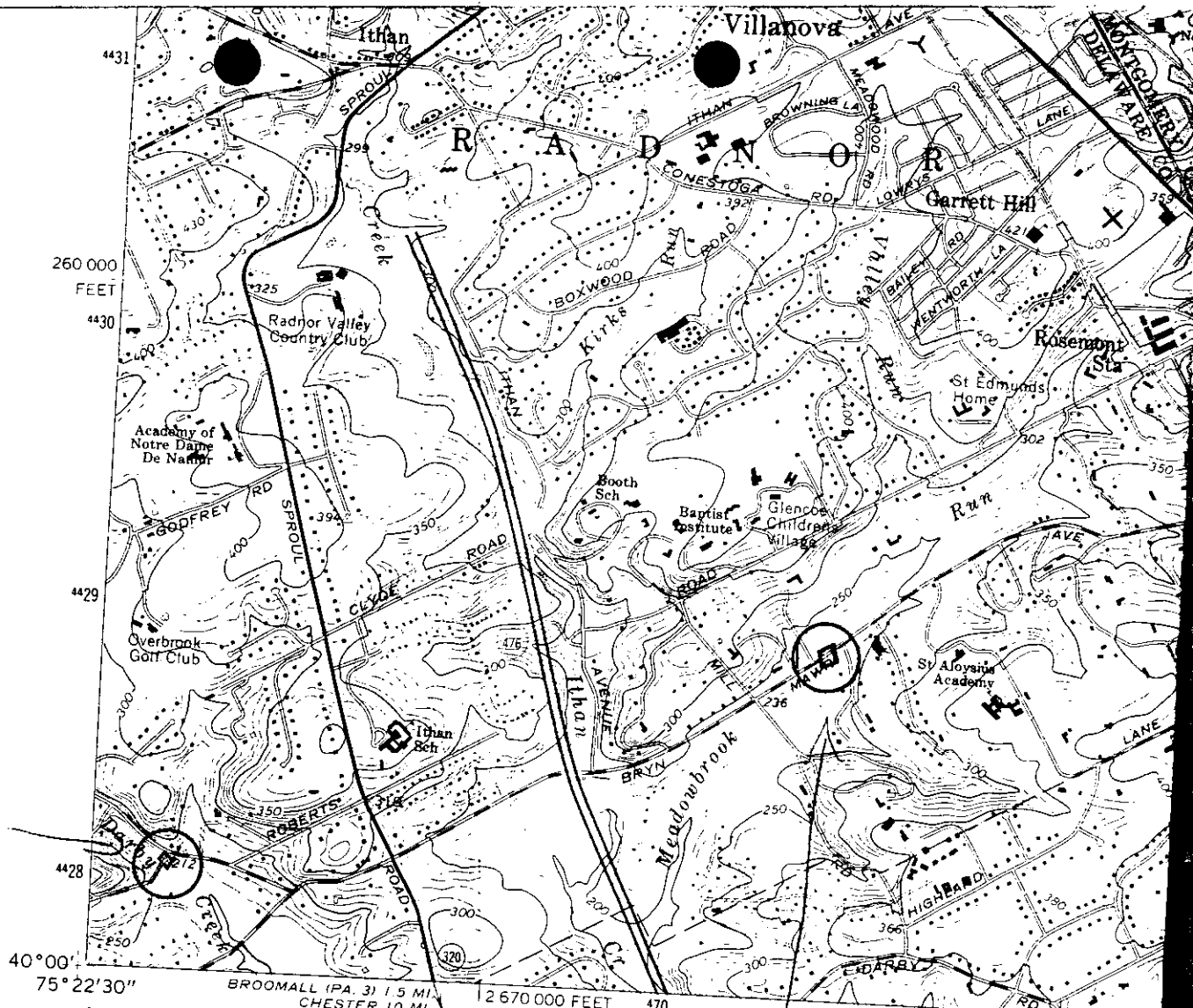

40°00' 75°22'30" BROOMALL (PA. 31) 1.5 MI. CHESTER 10 MI. 2 670 000 FEET 470

Mapped, edited, and published by the Geological Survey
 in cooperation with Pennsylvania Department of
 Internal Affairs, Topographic and Geologic Survey
 Control by USGS, NOS/NOAA, and USCE

Topography by photogrammetric methods from aerial
 photographs taken 1950. Field checked 1952. Revised
 from aerial photographs taken 1965. Field checked 1966

Polyconic projection. 10,000-foot grid ticks based on Pennsylvania
 coordinate system, south zone. 1000-meter Universal Transverse
 Mercator grid ticks, zone 18, shown in blue
 1927 North American Datum

To place on the predicted North American Datum 1983 mc
 the projection lines 6 meters south and 31 meters west as
 shown by dashed corner ticks

Red tint indicates areas in which only landmark buildings

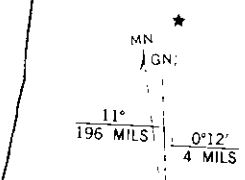

UTM GRID AND 1983 MAGNETIC NORTH
 DECLINATION AT CENTER OF SHEET

Pennsylvania D.O.T. Owned Highway Bridges
 Bridge in Radnor Township # 2 S-28

Delaware County
 Zone 18 *Newristown Quad*
 E 470620 N 4442860