

PENNSYLVANIA HISTORIC RESOURCE SURVEY FORM
BUREAU FOR HISTORIC PRESERVATION Box 1026
PA HISTORICAL & MUSEUM COMMISSION Harrisburg, PA 17120

7. Local survey organization

8. property owners name and address

School District of Philadelphia
 21st & Winter Streets
 Philadelphia, Pennsylvania 19103

9. tax parcel number / other number

10.

U.T.M. zone

18 | 4 | 92 | 5 | 2 | 0

4 | 42 | 9 | 1 | 80

northing

11. status (other surveys, lists etc.)

usgs sheet:

12. classification
 site () structure () object ()
 building () Thematic
 in N.R. district yes () no ()

13. date(s) (how determined)
 1909-1910

14. period
 1901-1920

15. style, design or folk type

Colonial Revival

19. original use

School

20. present use

School

16. architect or engineer

H. deCourcy Richards

17. contractor or builder

David Peoples

18. primary building mat./construction

Brick with limestone
 trimmings

21. condition

Good

22. integrity

Good

23. site plan with north arrow

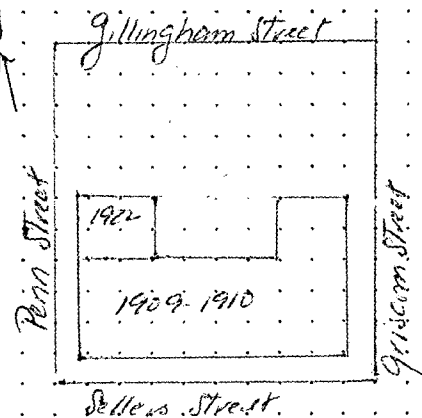

BLACK AND WHITE PRINT(S)
 3 1/2" x 5" enlargement or medium format contact
 note location of negative in block 24.

24. photo notation

25. file/location

26. brief description (note unusual features, integrity, environment, threats and associated buildings)

See reverse side

(continue on back if necessary)

27. history, significance and/or background

See reverse side

(continue on back if necessary)

28. sources of information

See reverse side

29. prepared by:

Jefferson M. Moak

30. date
 5-28-87

revision(s)

(continue on back if necessary)

1. County
 Philadelphia
 5. present name
 John Marshall School

2. municipality
 Philadelphia
 6. other name (historic name if any)
 N/A

3. street address or specific location
 1501-1527 Sellers Street

4. survey code

3. ADDRESS: Sellers Street, 1501-1527

5. NAME: Marshall, John, School

6. FORMER NAME:

13. DATES: 1909-1910

ADDITIONS: 1922

DESCRIPTION: Similar to the Barry and Peirce Schools, the Marshall School stands three stories high on a raised brick basement with five registers along its southern elevation and three along its north and south elevations. Each of the registers on the south contain bands of five windows on each major floor. Stone beltcourses run above the basement, first and third floors. A pedimented cornice runs above the third floor and a brick parapet appears above. On the east elevation, the left register features a brick diapered panel stretching the entire height of the second and third floors. The central register projects with a stone frontispiece surrounding the ground floor entrance. A two-story arched opening above contain the windows lighting the landings. A pediment tops this register and a porthole appears within the pediment. The right register contains three separate openings on each floor. A 3-story addition matching the original design of the building was designed by Irwin Catharine in 1922

HISTORY/SIGN.: The only building designed from School Board Type Number 122, the Marshall School has retained almost all of its original integrity. The addition of 1922, an early work of Catharine's after he assumed the mantle of Architect of the School District, matches Richards' original design, a characteristic missing from later additions designed by Catharine to other early buildings.

28. SOURCES: Edmunds, Public School Buildings of Philadelphia, 1908-1918
School Board, "New Buildings Under Contract"

EVALUATION: The survival of the original integrity of the design of this building and its unique design prompts a recommendation that it be included in the Philadelphia Public Schools Thematic District.

EVALUATION

EVALUATOR(S)

Philadelphia County
 Zone 18
 UTM 18/492780/4431850
 Philadelphia Public Schools
 Thematic Nomination
 Thomas Creighton School
 Philadelphia County
 Zone 18
 UTM 18/491000/4430340
 Philadelphia Public Schools
 Thematic Nomination
 Feltonville School
 Philadelphia County
 Zone 18
 UTM 13/489500/4430280
 Philadelphia Public Schools
 Thematic Nomination
 Clara Barton School
 Philadelphia County
 Zone 18
 UTM 489750/4429800
 Philadelphia Public Schools
 Thematic Nomination
 Henry Edmunds School
 Philadelphia County
 Zone 18
 UTM 18/492540/4430330
 Philadelphia Public Schools
 Thematic Nomination
 John Marshall School
 Philadelphia County
 Zone 18
 UTM 18/492520/4429180
 Philadelphia Public Schools
 Thematic Nomination

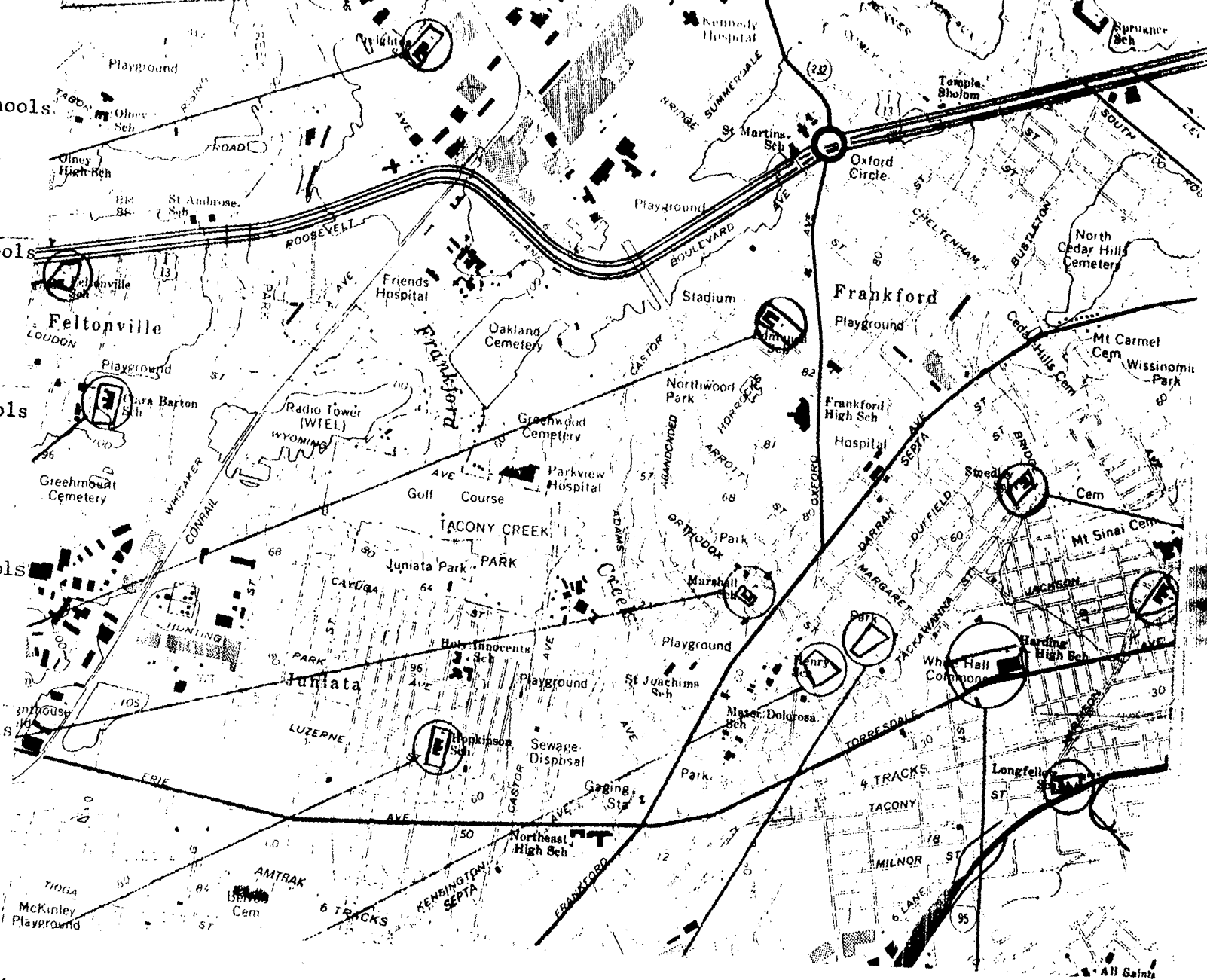

Frankford Quad