

C A L N

U.S. VETERANS HOSPITAL

Run Towns
Thorndale

Valley

Caln

Drive-in Theater
HIGHWAY

PENN CENTRAL

ABANDONED

Scott High Sch

SOUTH

VALLEY

HILLS

134

Goosetown

B R A D F O R D
W E S T

Modena

BRANDYWINE
READING

Mortonville

Hephzibah

Doe Run Ch

STRASBURG

PIPELINE

L B

5120

5120

443

PENNSYLVANIA HISTORIC RESOURCE SURVEY FORM
 OFFICE OF HISTORIC PRESERVATION Box 1026
 PA HISTORICAL & MUSEUM COMMISSION Harrisburg, PA 17120

7. Local survey organization
 East Fallowfield Township

8. property owners name and address
 Meyer, Emil J and Jo Ann
 Mortonville Hotel
 Coatesville, PA 19320

9. tax parcel number / other number
 47-9-9

10. U.T.M. zone 18 43 35 26
 easting
44 2 1 93 5
 northing
 usgs sheet: Coatesville

11. status (other surveys, lists, etc.)
 Chester County Historic Site Survey

12. classification
 site () structure (X) object ()
 building ()
 in N.R. district yes () no ()

13. date(s) (how determined)
 1849 (1796)

14. period
 1780 - 1860

15. style, design or folk type
 Federal

19. original use
 hotel, residence

20. present use
 residence

16. architect or engineer

17. contractor or builder

18. primary building mat./construction
 stone

21. condition average

22. integrity average

23. site plan with north arrow

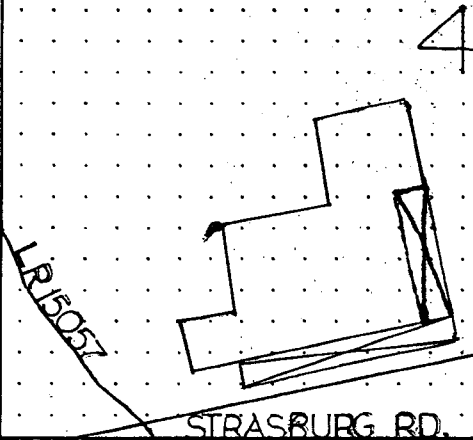

24. photo notation
 P: Young
 PD: 1980
 PV: Southwest elevation

25. file/location
 Historic Research Assoc.

26. brief description (note unusual features, integrity, environment, threats and associated buildings)

Seven bay wide, three story, stucco over stone structure with an asphalt shingled, shallow gable roof. The large building has the following features: plain stack chimneys at the gable ends, vertical rectangle windows, box cornice, several entrances on the front facade, transom lights, shutters, and broad surrounds with some shutters on the apertures. A veranda exists on the south and east elevations on both floors. The second floor veranda has a balustrade, while the support posts on both levels have Queen Anne and Eastlake support brackets. The basement of the building is carved directly into the stone of the hillside.

(continue on back if necessary)

27. history, significance and/or background - Commerce

Originally constructed as a home for Thomas Worth in 1796, the imposing structure was converted to a hotel in 1849 by Crosby P. Morton. Morton also made additions to the original Federal structure. It is historically significant to East Fallowfield Township and the Strasburg Road thematic area as a component in the importance of transportation needs to the drovers and the area residents.

(continue on back if necessary)

28. sources of information
 1. West Chester. Chester County Courthouse. Recorder of Deeds.
 2. West Chester. Chester County Historical Socie-

29. prepared by:
 Historic Research Associates

30. date 1981
 revision(s)

(continue on back if necessary)

1. County CHESTER

2. municipality
 EAST FALLOWFIELD TOWNSHIP
 MORTONVILLE HOTEL (THOMAS WORTH HOUSE)

3. street address or specific location
 STRASBURG ROAD

4. survey code
 SRTH-35

5. present name

27. Significance continued:

The inn diagonally across from the grist mill and located just east of the bridge over the Brandywine Creek, at the western end of Mortonville hamlet catered to the drover trade. The clipping file at the Chester County Historical Society contains several newspaper accounts on activities at the hotel during the nineteenth century whether it be tavern license applications, report of a fire, improvements to the premises, public sales of personal possessions and exchanges of innkeepers. Besides Morton, other innkeepers between 1849 and 1879 include: Isaac Parsons, Robert Smith, Washington Nickols, Joshua N. Peirce, Morris Pyle, Robert Darlington, Edward G. Yetter and Charles Yetter.

28. Sources of information continued:

ty. Clipping File.

3. West Chester. Chester County Historical Society. Microfilm collection. Chester County tax records.

4. West Chester. Chester County Historical Society. Tavern papers.

VERBAL BOUNDARY DESCRIPTION:

STARTING at a point on the north side of Route 604, Strasburg Road, where the property line of parcel 47-9-9 meets Strasburg Road, then north for two hundred seventy (270) feet, then southwest for two hundred feet (200), then south to east side of LR15057 for one hundred eighty-four and eight tenths feet, then southeast to north side of Route 604 for twenty-five (25) feet, then along north side of Route 604, for one hundred ninety (190) feet to the place of beginning.

CONTAINING 1 acre.

Chester County Historic Site Survey Code Number: 029-07-47-54

Miscellaneous Information:

1. Deed recorded in Chester County Courthouse, Recorder of Deeds, Deed Book D52, page 1.

2. Plotted on the following maps:

- a. 1860 - hotel
- b. 1873 - Mortonville Hotel
- c. 1883 - hotel

EVALUATOR(S)
Jane L. S. Davidson
Historic Research Associates

EAST FALLOWFIELD TOWNSHIP MRA, CHESTER COUNTY
STRASBURG ROAD THEMATIC GROUP
MORTONVILLE HOTEL (THOMAS WORTH HOUSE) (SRTH-35)
SUMMARY STATEMENT OF SIGNIFICANCE

For over one hundred fifty years the Strasburg Road contributed to the development and expansion of the agricultural economy in East Fallowfield Township. The road was an important east-west transportation and commercial corridor through the township and had its greatest impact on the development of the township during the third historic period, 1811-1865.

The significance of the property in its relationship to the Strasburg Road was initially a reaction to the road's accessibility. Later, it functioned as a service facility for travellers on the road.