

UNITED STATES
DEPARTMENT OF THE INTERIOR
GEOLOGICAL SURVEY

75°52'30" 426000m.E. 427 428 50' 429 430
30'

PENNSYLVANIA TURNPIKE (MORGANTOWN INTERCHANGE) 7 MI
BRANDYWINE MANOR 4.5 MI

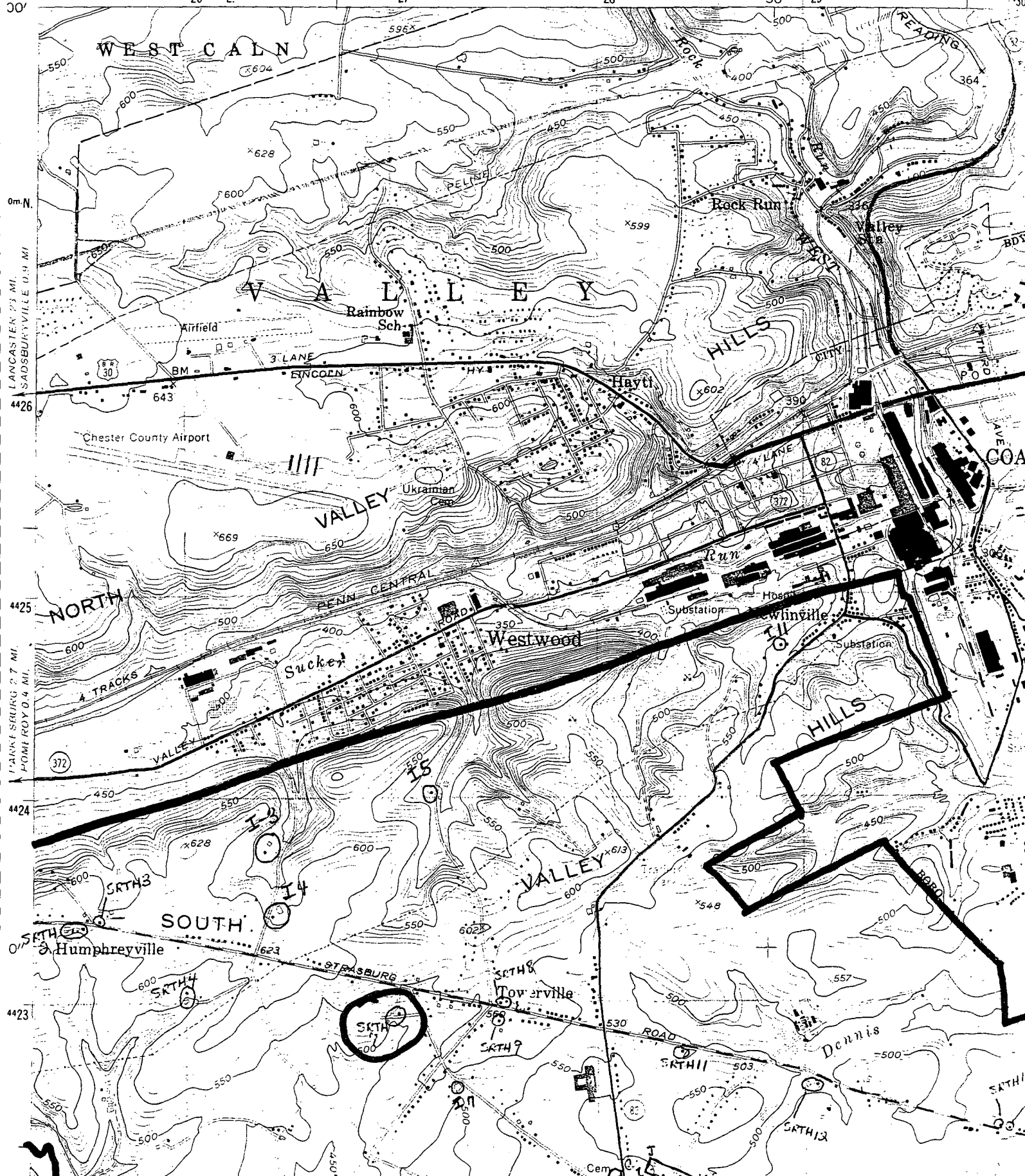

LANCASTER 2.3 MI.
SADSBURYVILLE 0.9 MI
0m N
PANKSBRUNG 2.7 MI.
HOME ROY 0.4 MI
4426
4425
4424
4423

PENNSYLVANIA HISTORIC RESOURCE SURVEY FORM
 OFFICE OF HISTORIC PRESERVATION Box 1026
 PA HISTORICAL & MUSEUM COMMISSION Harrisburg, PA 17120

7. Local survey organization
 East Fallowfield Township

8. property owners name and address
 Sokso, Andrew and M. Louise
 Box 134, R. D. #5
 Coatesville, PA 19320

9. tax parcel number / other number
 47-4-99.11

10. U.T.M. zone 18 easting 427020
 northing 4422950
 usgs sheet: Coatesville

12. classification
 site () structure () object ()
 building
 in N.R. district yes () no ()

13. date(s) (how determined)
c1810, research
 14. period
1780 - 1820

15. style, design or folk type
 Queen Anne Revival

19. original use farm
 20. present use residence

16. architect or engineer

17. contractor or builder

18. primary building mat./construction
 brick over stone

21. condition fair
 22. integrity average

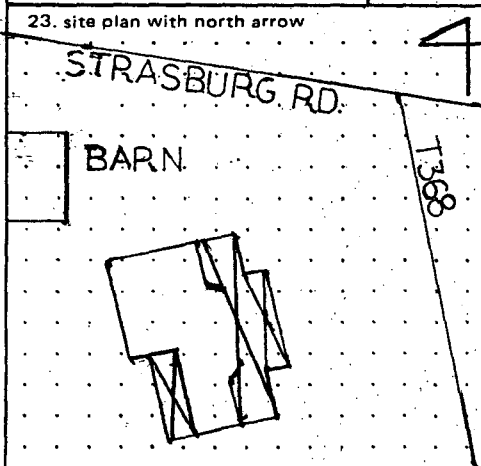

24. photo notation
 PC: M. S. Young
 PD: 1980
 PV: Northeast Elevation

25. file/location
 Historic Research Assoc.

26. brief description (note unusual features, integrity, environment, threats and associated buildings)

Seven bay wide, two and one-half story Queen Anne Revival structure with a slate multi-gabled roof. Other components of this farmhouse that was originally built about 1810 and changed to Queen Anne at the turn of the century include: one over one light windows, full width veranda with ornate balustrade and brackets, hipped dormers, stucco facades, massive conical turret on the front facade, and narrow surrounds. The single main entrance is on the first floor of the three story turret which projects into the veranda. The veranda also has a full gable facing the road and centered in front of the turret, with a projection. The barn is located in back of the house and to the west.

(continue on back if necessary)

27. history, significance and/or background Architecture

The Walton family built this farmhouse as the center of their farming operations in the first half of the nineteenth century. However the most significant historical aspects of the building is its extensive renovations conducted by the DeHaven brothers from a Pennsylvania farmhouse to a Queen Anne Revival showcase at the turn of the century. William and Harry DeHaven wanted to build a town of

(continue on back if necessary)

28. sources of information

- West Chester, Chester County Courthouse. Recorder of Deeds.
- West Chester, Chester County Historical

(continue on back if necessary)

29. prepared by:
 Historic Research Associates
 30. 1981 revision(s)

1. County
CHESTER

2. municipality
EAST FALLOWFIELD TOWNSHIP

3. street address or specific location
STRASBURG ROAD AND OLD WILMINGTON ROAD

4. survey code
SR1H-7

5. represent name
ASA WALTON HOUSE

6. other name (historic name, if any)

27. Significance continued:
towered houses in this section of East Fallowfield Township where a few roads intersected with the Strasburg Road. The confluence of the smaller north and south routes with the main Strasburg Road was an ideal location for such a town. In order to create the effect of a completed towered town, they took this farmhouse and converted it into one of their towered houses. It is an example of staying with the current architectural vogue without losing the pastoral setting.

28. Sources of information continued:
Society. Clipping File.

VERBAL BOUNDARY DESCRIPTION:

STARTING at a point three hundred seventy-five (375) feet southeast of where Strasburg Road intersects with T368, then southwest for four hundred twenty (420) feet, then northeast for one hundred seventy-five (175) feet, then southeast for one hundred thirty (130) feet, then northeast to the west side of T368 for two hundred (200) feet, then southeast along the west side of T368 for one hundred (100) feet to the place of beginning.

CONTAINING 1 acre.

Chester County Historic Site Survey Code Number: 029-07-47-80

Miscellaneous Information:

1. Deed recorded in Chester County Courthouse, Recorder of Deeds, Deed Book H41, page 410.
2. Plotted on the following maps:
 - a. 1860 - J. and W. McCorkle
 - b. 1873 - J. and W. McCorkle (McCorkle)
 - c. 1883 - William McCorkle

EVALUATION

EVALUATOR(S)

Jane L. S. Davidson
Historic Research Associates

EAST FALLOWFIELD TOWNSHIP MRA, CHESTER COUNTY
STRASBURG ROAD THE MATIC GROUP
ASA WALTON HOUSE (SRTH-7)
SUMMARY STATEMENT OF SIGNIFICANCE

NATIONAL REGISTER

For over one hundred fifty years the Strasburg Road contributed to the development and expansion of the agricultural economy in East Fallowfield Township. The road was an important east-west transportation and commercial corridor through the township and had its greatest impact on the development of the township during the third historic period, 1811-1865.

The significance of this property is in the relationship to the Strasburg Road as a local reaction to the accessibility of the road. In addition, this structure served as a site for the adoption of outside architectural influences made possible by the road.