

DEPARTMENT OF THE INTERIOR
GEOLOGICAL SURVEY

PENNSYLVANIA TURNPIKE (MORGANTOWN INTERCHANGE)
BRANDYWINE MANOR 4.5 MI

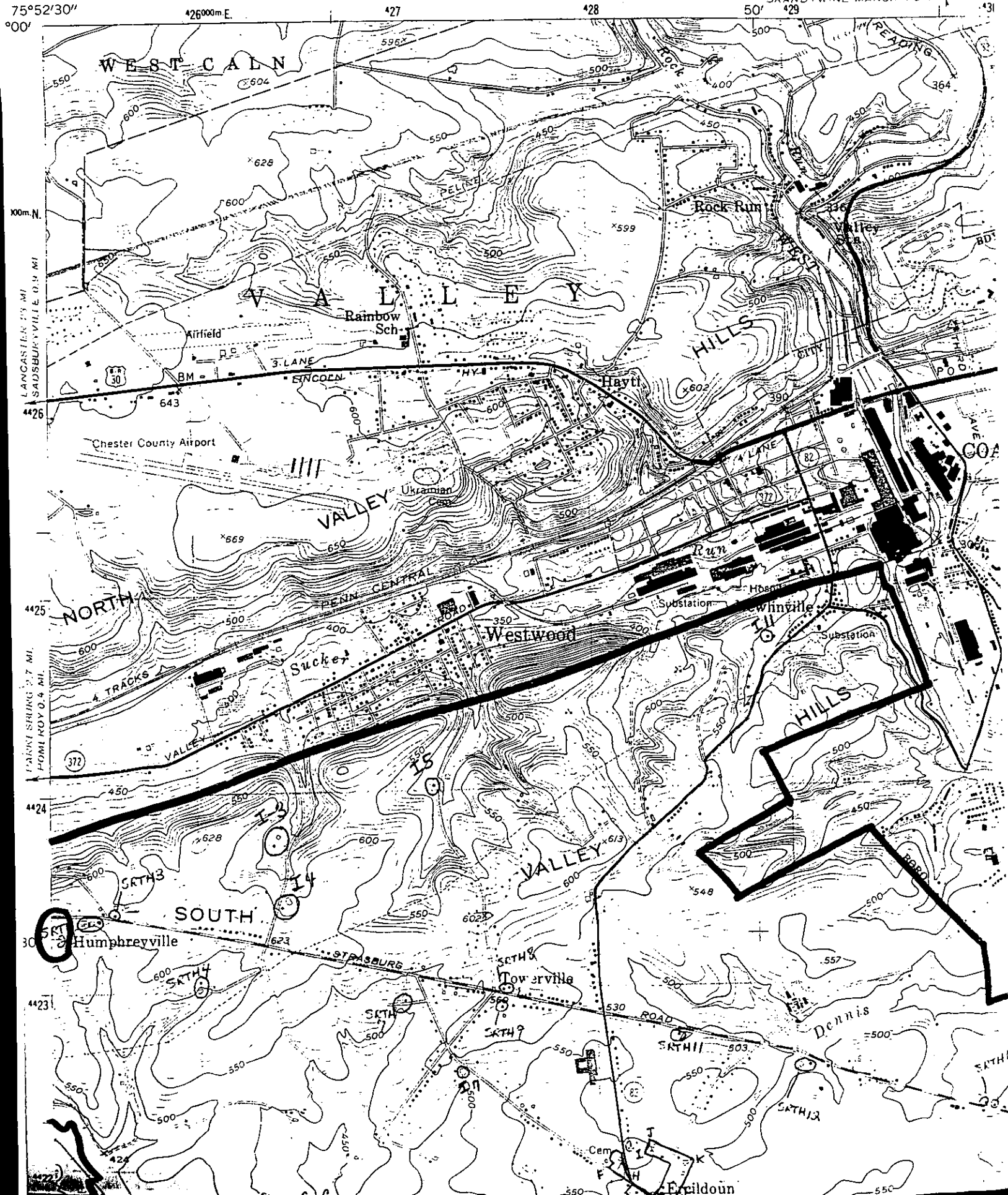

75°52'30"
00'

426000m.E.

427

428

50'

429

431

100m.N.
LANCASTER 2.5 MI
SADSBURYVILLE 0.9 MI

4426

4425

PARKY SPRING 2.7 MI
POMEROY 0.4 MI

4424

30

4423

424

PENNSYLVANIA HISTORIC RESOURCE SURVEY FORM
 OFFICE OF HISTORIC PRESERVATION Box 1026
 PA HISTORICAL & MUSEUM COMMISSION Harrisburg, PA 17120

7. Local survey organization
 East Fallowfield Township

8. property owners name and address
 Oberholtzer, Irwin and Edith H.
 R. D. #3
 Coatesville, PA 19320

9. tax parcel number / other number
 47-4-93

10. U.T.M. zone 18 easting 41265110

11. status (other surveys, lists etc.)
 Chester County Historic Site Survey

northing 4,423,360

usgs sheet: Coatesville

12. classification
 site () structure () object ()
 building ()
 in N.R. district yes () no ()

13. date(s) (how determined)
c1774, research
141920 - 1780

15. style, design or folk type
 Federal

19. original use farm

20. present use farm

16. architect or engineer

17. contractor or builder

18. primary building mat./construction
 stone

21. condition excellent

22. integrity
average

23. site plan with north arrow

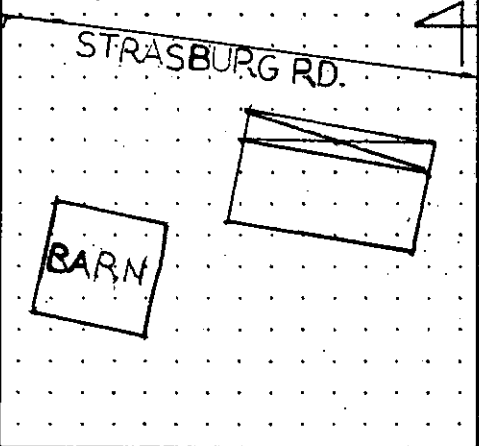

24. photo notation
 PC: M. S. Young
 PD: 1980
 PV: North Elevation

25. file/location
 Historic Research Assoc.

26. brief description (note unusual features, integrity, environment, threats and associated buildings)

Four bay wide, two story, stucco over stone Federal farmhouse with aterne tin gable roof. Other components of the building are one over one windows, dboule unbalanced main entrances, chimneys at both gable ends, box cornice with dentil work, recessed doorways and square windows in the gables. The full width porch has a shallow hipped roof and narrow support posts. The massive bank barn is located to the west of the farmhouse. The machine shop and milkhouse between the house and barn are twentieth century additions.

(continue on back if necessary)

27. history, significance and/or background

Commerce

Philip Dougherty who built the tavern diagonally across the road, utilized his entrepreneur abilities by "laying out" a farm near his tavern. The produce from the farm could supply the tavern and at the same time the excess could easily be shipped to the markets in the eastern part of Chester County and Philadelphia,

(continue on back if necessary)

28. sources of information

1. Washington, D. C. National Archives. Micro-copy Collection, T1138. "Agricultural Schedules, Pennsylvania, Federal Decennial

(continue on back if necessary)

29. prepared by:

Historic Research Associates

30. date

1981

revision(s)

1. County
 CHESTER

2. Municipality
 EAST FALLOWFIELD TOWNSHIP
 6. other name (historic name if any)
 PHILIP DOUGHERTY HOUSE

3. street address or specific location
 STRASBURG ROAD

4. survey code

SRTH-2

27. Significance continued:
on the relatively new drovers' road. Dougherty took time from his responsibilities to serve in the Third Company, Eighth Battalion of the Chester County Militia during the Revolutionary War. In the nineteenth century, Joshua Stroud doubled the value of the farm between 1850 and 1860 and Newton Philips changed the farm from grains to a large dairy farm which produced 4000 gallons of milk in 1869 and increased it to 5800 gallons by 1879. The property is significant in agriculture because it has been a continuous working farm from the original construction of the farmhouse to and including the present owners. It also supports the importance of Strasburg Road as a transportation artery because the farmer had easy accessibility to the markets.

28. Sources of information continued:
Census, 1850-1880."

2. West Chester. Chester County Courthouse. Recorder of Deeds.
3. West Chester. Chester County Historical Society. Manuscript Collection.

VERBAL BOUNDARY DESCRIPTION:

STARTING at a point on the south side of Strasburg Road where it intersects parcel 47-4-93, then southwest for one hundred fifty (150) feet, then northwest for four hundred twenty-five (425) feet, then northeast to the south side of Strasburg Road for one hundred fifty (150) feet, then southeast along the south side of Strasburg Road for four hundred twenty-five (425) feet to the place of beginning.
CONTAINING 1.5 acres.

Chester County Historic Site Survey Code Number: 029-07-47-86

Miscellaneous Information:

1. Deed recorded in Chester County Courthouse, Recorder of Deeds, Deed Book N40, page 259.
2. Plotted on the following maps:
 - a. 1860 - J. Stroud
 - b. 1870 - Phillips
 - c. 1883 - Newton Phillips

EVALUATION

EVALUATOR(S)
Jane L. S. Davidson
Historic Research Associates

EAST FALLOWFIELD TOWNSHIP MRA, CHESTER COUNTY
STRASBURG ROAD THEMATIC GROUP
PHILIP DOUGHERTY HOUSE (SRTH-2)
SUMMARY STATEMENT OF SIGNIFICANCE

For over one hundred fifty years the Strasburg Road contributed to the development and expansion of the agricultural economy in East Fallowfield Township. The road was an important east-west transportation and commercial corridor through the township and had its greatest impact on the development of the township during the third historic period, 1811-1865.

The significance of this property is in the relationship to the Strasburg Road as a local reaction to the accessibility of the road. The farmer located his buildings close to the road in order to be more accessible to the marketplace. In addition, the barn, because of its agricultural significance, can be considered a contributing part of the farmstead.