

PENNSYLVANIA HISTORIC RESOURCE SURVEY FORM
 OFFICE OF HISTORIC PRESERVATION Box 1026
 PA HISTORICAL & MUSEUM COMMISSION Harrisburg, PA 17120

7. Local survey organization
 East Fallowfield Township

8. property owners name and address

Goebert, Donald F. V.
 Margolis, Edward H.
 604 East Main Street
 Coatesville, PA 19320

9. tax parcel number / other number
 47-5-112

10. U.T.M. zone 18 easting 432420

northing 4425620

11. status (other surveys, lists etc.)
 Chester County Historic Site Survey

usgs sheet: Coatesville

12. classification
 site () structure () object ()
 building
 in N.R. district yes () no ()

13. date(s) (how determined)
 c1800, research

14. period
 1780 - 1820

15. style, design or folk type
 Penn Plan

19. original use
 farm

20. present use
 farm

16. architect or engineer

17. contractor or builder

18. primary building mat./construction
 stone

21. condition
 average

22. integrity
 average

23. site plan with north arrow

LR 15073

HOUSE

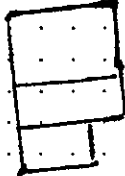

BARN



24. photo notation

PC: M. S. Young
 PD: 1980
 PV: North Elevation

25. file/location

Historic Research Assoc.

26. brief description (note unusual features, integrity, environment, threats and associated buildings)

Two bay wide, two story, Penn Plan building with aterne tin roof. Other features of this unique building are six over six light windows, lipped chimney flush on the gable end, rough stone foundation, stucco over stone facades, plain box cornice, square windows in the gable ends, a main entrance that is offcentered to the right and narrow architrave trim on the apertures. Two separate additions were built to the rear of the structure.

(continue on back if necessary)

27. history, significance and/or background

ARCHITECTURE

The Quaker way of life influenced many facets in the community including architecture as can be found in this Penn Plan structure. The original floor plan was designed by William Penn and adopted by the Quakers for their own structures. Because East Fallowfield Township was the center of a Quaker community it is not surprising to find an example of their handiwork. Built about 1800 for Jos-

(continue on back if necessary)

28. sources of information

1. American Republican. October 22, 1816.
2. Village Record. June 9, 1819.

(continue on back if necessary)

29. prepared by:

Historic Research Associates

30. date

revision(s)

1981

1. County

CHESTER

2. municipality
 EAST FALLOWFIELD TOWNSHIP

3. other name (historic name if any)
 JOSEPH GLADDEN HOUSE

3. street address or specific location
 WEST CHESTER ROAD

4. survey code

I-24

27. Significance continued:
eph Gladden, it is one of two Penn Plan homes that have survived almost two hundred years. Gladden developed his 155 acres and when he tried to sell his property in 1816, the buildings were advertised in the following manner: " a good stone dwelling house - barn and other convenient buildings." His well maintained farm was in a state of high cultivation with some sections divided into meadows, woodland and fields. Today the farm is still 116.6 acres which substantiates the fact it is the only Penn Plan farmhouse for East Fallowfield Township in an agrarian environment.

28. Sources of information continued:
3. West Chester. Chester County Courthouse. Recorder of Deeds.

VERBAL BOUNDARY DESCRIPTION:

STARTING at a point on the south side of LR15073, eight hundred fifty-five (855) feet northwest of parcel 47-5-111, then southeast for four hundred (400) feet, then northeast for three hundred (300) feet, then northwest for four hundred (400) feet, then southwest along the south side of LR15073 for three hundred (300) feet to the place of beginning.

CONTAINING 2.8 acres.

Chester County Historic Site Survey Code Number: 029-07-47-178

Miscellaneous Information:

1. Deed recorded in the Chester County Courthouse, Recorder of Deeds, Deed Book U36, page 52.
2. Plotted on the following maps:
 - a. 1860 - C. B. Lilly
 - b. 1873 - C. D. Lillie
 - c. 1883 - Hamilton Graham

27. Significance continued:

The Joseph Gladden House is also historically significant in local architecture because it symbolizes the influence of William Penn several decades after his death. It is unique because the style is being used at the same time the property owners in the area had already adopted the usage of the Georgian and Federal architecture styles.

VALUATION

EVALUATOR(S)
Jane L. S. Davidson
Historic Research Associates

EAST FALLOWFIELD TOWNSHIP MRA, CHESTER COUNTY
JOSEPH GLADDEN HOUSE (I-24)
SUMMARY STATEMENT OF SIGNIFICANCE

The Penn Plan, also known as the Quaker Plan, was devised by William Penn and was first used as a house plan by settlers in the Philadelphia area. This style moved with the settlers to the more remote areas west of Philadelphia during the eighteenth century. The characteristics include a small rectangular configuration, a two room plan, two bays, two or two and one-half stories, and usually a flush gable chimney. However, the Joseph Gladden House, like all other interpretations in East Fallowfield is restrained and delayed.

The Joseph Gladden House is one of two Penn Plans remaining in the township; the other example being the David Scott House (I-4). Of the two, the Gladden property, while in poor condition, probably retains the most original architectural elements. Both are significant structures in the township because they represent a form once prevalent in the township, but replaced early because of their limited size.