

Westwood

South Coatesville

Goosetown

VALLEY

BRANCH

Modena

BRANDYWINE

Spruces

Hephzibah

Youngsburg

Doe Run Ch

Mortonville

Laurel

EAST FALLOWFIELD

WEST BRADFORD

CREEK

PENNSYLVANIA HISTORIC RESOURCE SURVEY FORM
 OFFICE OF HISTORIC PRESERVATION Box 1026
 PA HISTORICAL & MUSEUM COMMISSION Harrisburg, PA 17120

7. Local survey organization

East Fallowfield Township

8. property owners name and address

Latta, John and Hazel S.
 Fairview Road
 R. D. #4
 Coatesville, PA 19320

9. tax parcel number / other number
 47-8-29

10. U.T.M. zone 18 43 20 8 0
 easting
 4 4 20 8 0 5
 northing

11. status (other surveys, lists etc.)
 Chester County Historic Site Survey

usgs sheet: Coatesville

12. classification
 site () structure () object ()
 building (x)
 in N.R. district yes () no ()

13. date(s) (how determined)
 1819, datestone

15. style, design or folk type
 Federal

19. original use farm

14. period
 1680 - 1820

20. present use farm

16. architect or engineer

17. contractor or builder

18. primary building mat./construction
 stone

21. condition excellent

22. integrity excellent

23. site plan with north arrow

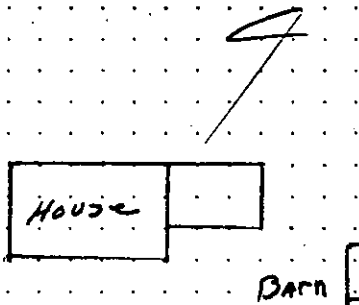

FAIRVIEW Rd.

24. photo notation

PC: J. E. S. Davidson
 PD: 1981
 PV: Southeast Elevation

25. file/location

Historic Research Assoc.

26. brief description (note unusual features, integrity, environment, threats and associated buildings)

Five bays wide, two story, Federal fieldstone rectangular building with a formal centered main entrance that possesses a pediment, pilasters, fluted trim, keystone, and an elliptical fanlight. Other features include a box cornice, nine over six and six over six lights vertical rectangle windows in the gables and double width stone chimneys at each gable end. A wing is on the north side of the residence. There is also a barn on the property.

The continued agricultural significance in East Fallowfield is evident in the 20th century alterations to the 19th century Hanna barn. Because of its agricultural significance, this barn can be considered a contributing part of the farmstead.

(continue on back if necessary)

27. history, significance and/or background ARCHITECTURE

In the 1796 tax list John Hanna is assessed for a one story, old stone house 22 x 33 feet, a stone milk house, 12 X 16 feet, and an old log barn, 15 X 35 feet, with a bad roof. His family had occupied this parcel of ground since the middle of the eighteenth century. By 1819 after the expenses associated with the war of 1812 were paid and for the first time since the Revolution, monetary

(continue on back if necessary)

28. sources of information

- West Chester. Chester County Courthouse. Recorder of Deeds.
- West Chester. Chester County Historical

29. prepared by:

Historic Research Associates

30. date: 1981

revision(s)

1. County CHESTER
 2. municipality EAST FALLOWFIELD TOWNSHIP
 6. other name (historic name if any) JOHN HANNA FARM

3. street address or specific location FAIRVIEW ROAD

4. survey code I-21

27. Significance continued:

values had stabilized, the economy opened and people began to improve their properties. John Hanna's contribution to the history of East Fallowfield Township during this period is his interpretation of the Federal architectural style generally synonymous with more developed areas rather than a farm in a very rural early nineteenth century setting. Influence from the city is evidenced in the structure proportions, pitch of the roof, the nine over six windows, broad chimney stacks, box cornice and the formal centered main entrance. It is a stunning attribute to the importance of good Federal architecture in the local area.

28. Sources of information continued:

Society. Clipping File.

VERBAL BOUNDARY DESCRIPTION:

STARTING at a point seven hundred (700) feet northeast of where T377 intersects with T373, then northwest for two hundred (200) feet, then northeast for three hundred (300) feet, then southeast for one hundred seventy-five (175) feet, then southwest along the west side of T373 for three hundred twenty-five (325) feet to the place of beginning.

CONTAINING .9 acre.

Chester County Historic Site Survey Code Number: 029-07-47- 59

Miscellaneous Information:

1. Deed recorded in the Chester County Courthouse, Recorder of Deeds, Deed Book T27, page 281.
2. Plotted on the following maps:
 - a. 1860 - J. Hanna
 - b. 1873 - J. B. Shoemaker
 - c. 1883 - E. Palmer

27. Significance continued:

It is also historically significant in local architecture because the structure is similar to the Robert Wilson House on Strasburg Road and yet this building is in a more rural area away from any major transportation artery. The location of this building proves that even though the Federal style was not introduced into the township until the latter part of the period when it did arrive the style was used throughout the area away from major arteries.

EVALUATION

EVALUATOR(S)

Jane L. S. Davidson

Historic Research Associates

EAST FALLOWFIELD TOWNSHIP MRA, CHESTER COUNTY
JOHN HANNA FARM (I-21)
SUMMARY STATEMENT OF SIGNIFICANCE

In the evolution of agriculture in East Fallowfield there were two distinct growth periods; one beginning in 1770 and ending about 1820 and the other flourishing in the post Civil War period. The first period emphasized the construction of utilitarian buildings, while the post Civil War expansion concentrated on land use changes.

In the first agricultural phase the success of the agrarian economy resulted in the erection of more substantial farmsteads. At no other time in East Fallowfield's history is there evidence of such a prolific construction period in agrarian buildings.

Despite the growth of the agricultural economy and the increase in construction, the interpretation of both the Georgian and Federal styles continued to be vernacular.

The significance of this property is its association with a local collection of farmsteads that have in common a vernacular form of architecture and a relationship to a specific agricultural era, 1770-1820.

While this property is apart of the local group of farmsteads built between 1770 and 1820, and associated with a period of agricultural expansion, it differs architecturally from this group.

This structure as well as the Pennock Mansion built at Rokeby represents a more formal type of architecture than the usual vernacular interpretations found in East Fallowfield. The Hanna family, like the Pennock family, were part of the more affluent

EAST FALLOWFIELD TOWNSHIP MRA, CHESTER COUNTY
JOHN HANNA FARM (I-21)
SUMMARY STATEMENT OF SIGNIFICANCE continued

level of society more interested in style than utilitarian function.
While more conservative than the Pennock mansion, it is by far
more stylized than the Powell farmhouses (I-16, I17).