

PENNSYLVANIA HISTORIC RESOURCE SURVEY FORM
 OFFICE OF HISTORIC PRESERVATION Box 1026
 PA HISTORICAL & MUSEUM COMMISSION Harrisburg, PA 17120

7. Local survey organization
 East Fallowfield Township

8. property owners name and address
 Wheelahan, Edward
 R.D. #5
 Coatesville, Pa. 19320

9. tax parcel number / other number
 47-7-149.1

10. U.T.M. zone 18 easting 428860

11. status (other surveys, lists etc.)
 Chester County Historic Site Survey

usgs sheet: Coatesville
 northing 442104315

12. classification
 site () structure () object ()
 building (X)
 in N.R. district yes () no ()

13. date(s) (how determined)
 #1-1825-#2-c.1840

15. style, design or folk type
 Federal

19. original use
 residence

14. period
 1820-1860

20. present use
 residence

16. architect or engineer

17. contractor or builder

18. primary building mat./construction
 stone

21. condition average

22. integrity excellent

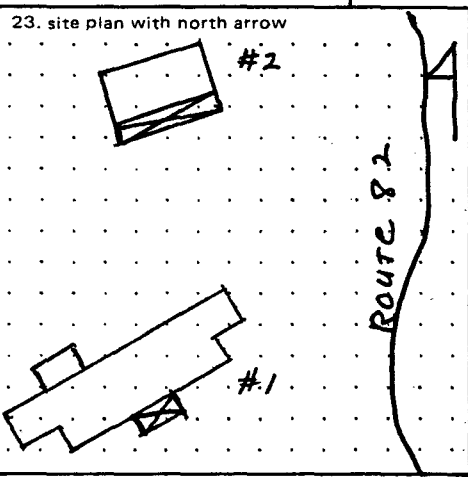

24. photo notation
 PC: M.S. Young
 PD: 1980
 PV: East Elevation

25. file/location
 Historic Research Assoc

26. brief description (note unusual features, integrity, environment, threats and associated buildings)

#1
 Five bays wide, two story rectangular structure with lipped chimneys at both gable ends. Other features of this attractive Federal house are an asphalt shingled gable roof, stucco facades, pedimented Federal gable dormers, box cornice, partial front porch on the front facade, shutters, single centered main entrance, transom light, and a French door aperture on the second floor above the main entrance.

#2
 The second building (c. 1840) is a four bay wide conservative Greek Revival structure. It has a gable roof, stucco facades, " lie on your stomach windows," six over six lights, double main entrances and a full width veranda with square support posts.

(continue on back if necessary)

27. history, significance and/or background
Industry
 In 1793 Isaac Pennock operated the Federal Slitting Mill spanning the Buck Run. When he died in 1824 his widow, Martha Pennock, rebuilt the mill and added the Ironmaster's mansion (#1) for her son Isaac. He operated the mill, now renamed the Rokeby Iron Works until his death.

(continue on back if necessary)

28. sources of information
 1. Lukens Steel Company. Lukens Stell Company, 1810-1960. Coatesville

29. prepared by:
 Historic Research Associates

30. date 1981 revision(s)

(continue on back if necessary)

1. County CHESTER
 2. municipality EAST FALLOWFIELD TWP.
 3. street address or specific location ROUTE 82
 4. survey code I-14
 5. present name
 6. other name (historic name if any) MARTHA PENNOCK HOUSE

27. Significance continued:

The mill complex was also the home of Charles and Rebecca Lukens for a short time after their marriage. Rebecca Lukens, the daughter of Isaac Pennock, is known as Chester County's "Woman of Iron" because of her prominent roll in the development of the Lukens Steel Mill in Coatesville.

In 1866 Joshua Bromell converted the mill complex to a paper mill which was destroyed by fire in August 1901. The Ironmaster's mansion and the tenant house are significant in the industrial development of the township because of their association with the industrial complex at Rokeby.

28. Sources of information continued:

2. West Chester. Chester County Courthouse. Recorder of Deeds.

3. West Chester. Chester County Historical Society. Clipping File.

VERBAL BOUNDARY DESCRIPTION:

STARTING at a point one hundred fifty (150) feet northwest of where the township line on the Buck Run crosses Route 82, then southwest four hundred twenty-five (425) feet, then northwest for four hundred fifty (450) feet, then northeast for two hundred seventy-five (275) feet, then southeast to the second marked line for four hundred fifty (450) feet to the place of beginning.
CONTAINING 2.8 acres.

Chester County Historic Site Survey Code Number: 029-07-47-96,98

Miscellaneous information:

1. Deed recorded in West Chester, Chester County Courthouse, Recorder of Deeds, Deed Book R34, page 421.

2. Plotted on the following maps:

- a. 1860 - Mrs. A. Fisler Rolling Mill
- b. 1873 - J.B. Broomell's Paper Mill
- c. 1883 - W.L. Elkins Paper Mill



#2

EVALUATOR(S)
Jane L.S. Davidson
Historic Research Assoc.

EAST FALLOWFIELD TOWNSHIP MRA, CHESTER COUNTY
MARTHA PENNOCK HOUSE (I-14)
SUMMARY STATEMENT OF SIGNIFICANCE

Although East Fallowfield is principally an agrarian community, there was a brief period in the nineteenth century when the iron and paper industries flourished along its waterways. This mansion and tenant house are important in their association with the industrial period and the mansion is also the township's earliest and best surviving component of an industrial complex.

The architecture of this mansion represents a departure from the vernacular style predominant in the township because it was built by the Pennock family, one of the wealthiest local families of the period. The Broomall family who converted the iron complex to a paper mill, plus subsequent owners, have maintained the structure's architectural integrity. The refinements of this Federal mansion are similar to and compatible with those erected at the same time along the Philadelphia and Lancaster Turnpike (present Route #30) in other Chester County areas.