

PENNSYLVANIA HISTORIC RESOURCE SURVEY FORM
 OFFICE OF HISTORIC PRESERVATION Box 1026
 PA HISTORICAL & MUSEUM COMMISSION Harrisburg, PA 17120

7. Local survey organization

East Fallowfield Township

1. County
CHESTER

2. Municipality
EAST FALLOWFIELD TOWNSHIP
6. Other name (historic name, if any)
NELSON P. BOYER BARN

3. Street address or specific location
OLD WILMINGTON ROAD

4. Survey code
1 - 7

8. Property owners name and address
Martin, Robert L. and Eugenia T.
Box 153
R.D.#3
Coatesville, PA 19320

9. tax parcel number / other number
47-4-118

10. U.T.M. 18 4 2 7 3 0 0
 missing
 4 4 2 2 5 8 0
 missing

11. status (other surveys, lists etc.)
Chester County Historic Site Survey

USGS sheet: Coatesville

12. classification
 site structure object building in N.R. district yes no

13. date(s) (how determined)
1894 research
14. period
1860 - 1900

15. style, design or folk type
Gothic Revival

19. original use
farm
20. present use

16. architect or engineer

17. contractor or builder
Samuel Steele

18. primary building mat./construction
frame

21. condition
good
22. integrity
excellent

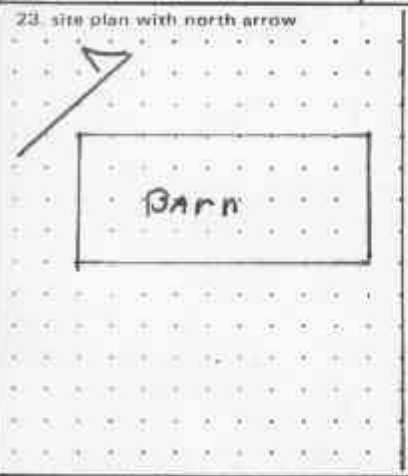

24. photo notation
 PC: M. S. Young
 PD: 1980
 PV: Southeast elevation

25. file/location
Historical Research Assoc.

26. brief description (note unusual features, integrity, environment, threats and associated buildings)

The Gothic Revival barn located on the very edge of Old Wilmington Road is 126' x 70' and was built to stable 100 head of stock at a cost of \$5,000. The barn floor measures 60' x 70' and the distance from the barn floor to the rafter comb is 47 feet. Components of the immense barn include walled in stockyard, asphalt shingled gabled roof, pointed arched apertures in the gables, centered frame cupola on the apex of the roof, frame roofing over the stable openings, vertical board of acades, and multi-eight windows.

(continue on back if necessary)

27. history, significance and/or background

Architecture

N. P. Boyer, breeder, cattle dealer and proprietor of the Ercildown Stock Farm, who specialized in raising Shetland ponies, had a disasterous barn fire in 1894. He immediately planned to erect an even better structure and awarded the contract to Samuel Steele in August of the same year. The barn raising was recorded in detail by area newspapers. By October, 1894 thirteen carloads of lumber were hauled to the property and on November 20, 1894, 50 men assisted the raising of the barn. Locally

(continue on back if necessary)

28. sources of information
 1. West Chester, Chester County Courthouse,
 Recorder of Deeds.

29. prepared by:
Historic Research Associates
 30. date
1981
 revision(s)

(continue on back if necessary)

27. Significance continued:

declared as one of the largest barns in the state it is historically significant as an excellent example of Gothic Revival architecture in barn construction. Despite the immense size, the quality of architectural perspective is not lost and the ratio of individual components to the over-all structure is in good taste. Known at the turn of the century, "Showplace of Chester County," it still gives the passerby a feeling of awe today. Buffalo Bill also used the barn for winter quarters and practiced his routine on the large barn floor.

VERBAL BOUNDARY DESCRIPTION:

Starting at a point approximately two thousand three hundred and seventy-five (2,375) feet from where the T368 intersects with Park Avenue then southeast along the south side of T368 for two hundred (200) feet, the southwest for two hundred (200) feet, then northwest for two hundred (200) feet, then northeast for two hundred (200) feet to the place of beginning.

CONTAINING - .5 acres

Chester County Historic Site Survey Code Number: 029-07-47-33

Miscellaneous Information:

1. Deed recorded in the Chester County Court House, Recorder of Deeds, Deed Book N36, page 18

28. Sources of information continued:

2. West Chester. Chester County Historical Society. Clipping File.

EVALUATION

EVALUATOR(S)

Jane L. S. Davidson

Historic Research Associates

EAST FALLOWFIELD TOWNSHIP MRA, CHESTER COUNTY
NELSON P. BOYER BARN (I-7)
SUMMARY STATEMENT OF SIGNIFICANCE

After the Civil War agriculture in Chester County became more diversified as a result of advancements in scientific farming techniques.

The Boyer barn, as an example of this period, is important in the evolution of the agricultural history of East Fallowfield. This Gothic Revival barn is different from most Chester County barns because it was erected at a later period and built for a specialized use, stock breeding. The style itself is reminiscent of those barns found in southwestern Pennsylvania which were also built during the late nineteenth century.