

PENNSYLVANIA HISTORIC RESOURCE SURVEY FORM
 OFFICE OF HISTORIC PRESERVATION Box 1026
 PA HISTORICAL & MUSEUM COMMISSION Harrisburg, PA 17120

7. Local survey organization

Brandywine Conservancy, Inc.

8. property owners name and address

Timothy E. & Flossie L. Mast
 Box 416
 RD 4
 Coatesville, PA 19320

9. tax parcel number / other number

49-2-1

10.

U.T.M. zone 18 41317131310
 easting

11. status (other surveys, lists etc.)

CCHSS

41421111010
 northing

usgs
 sheet:

Unionville

12. classification
 site () structure () object ()
 building (X)
 in N.R. district yes () no ()

13. date(s) (how determined)

14. period
 1751-1800 (04)

15. style, design or folk type

40-Colonial English

19. original use

010200P 131207A

20. present use

010200 Residence

16. architect or engineer

17. contractor or builder

18. primary building mat./construction

02-Stone

21. condition

good

22. integrity

good

23. site plan with north arrow

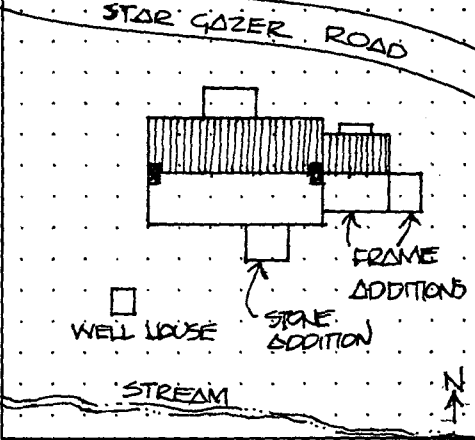

24. photo notation

PC: Emily Hart
 PD: 1984
 PV: Northwest elevation

25. file/location

Brandywine Conservancy

26. brief description (note unusual features, integrity, environment, threats and associated buildings)

This small house is situated on Star Gazer Road nearly opposite the famous Star Gazer Stone on an adjoining property (49-3). Facing east, the house sits quite close to the narrow winding road.

Although saddled with various additions, the Hayes Mill House has an arresting appearance. Its stone core which dates to c.1780 is easily discerned and appreciated. It is two stories, single pile, three bays wide with a plain gable roof. Although rather narrow in width, it features two large stone chimneys on either gable end. Unlike most other houses in the West Branch Brandywine Scenic River Corridor, the chimneys of the Hayes Mill House are formed from the stone end walls and interrupt the peak of the roof. Six-over-six windows are set in plain, pegged frames.

(continue on back if necessary)

27. history, significance and/or background

The Hayes Mill House is significant for its architecture and for its association with an unusual quarry and mill operated for nearly a century by a local family.

Architecturally, the core of the house is a strong example of vernacular Colonial architecture based on the popular English hall/parlor plan. Its

(continue on back if necessary)

28. sources of information

"Annals of An Old House Near Embreeville," 1916, J. Carroll Hayes; Chester County Historical Society - Clipping File; "The Old Hayes Whetstone Mill: (ms., no author. (continue on back if necessary)

29. prepared by:

M. L. Wolf

30. date

11/84

revision(s)

1. County 029-Chester
 2. municipality Newlin Township
 3. street address or specific location Star Gazer Road
 4. survey code MAP 49-4
 5. present name Hayes Mill House
 6. other name (historic name if any)



House uses a standard English hall/parlor plan. Its most notable feature is corbeled stone cornice which is seldom seen in this area of Chester County, but which is present in two other buildings in the Scenic River corridor, the Spruce Grove Schoolhouse (49-8) and the Young House (49-7). Cornice, like the rest of the core, appears to be remarkably preserved as evidence of its original "overbuilt" construction.

Subsequent additions were made to the house by its current owners, now elderly, refusing an inside inspection. There is a two-story wing off the east side, an enclosed front porch, and a small room off the back.

The 27-acre tract on which the house sits has many outbuildings, all of which are considered non-contributing. Because the property is over 10 acres, a boundary line has been drawn to include the house and approximately one acre around it.

Out buildings

well house: INTRUSION

Acres: .75

Area of significance
architecture
industry

Period

x 1700-1799

x 1800-1899

CHESTER COUNTY ARCHITECTURAL INVENTORY FORM

I. Site Information

068411 Wool 1980
 Form No. Recorded by Date
 027 04 49 014 UNTENVUE
 County Region Municipality Site # USGS Quad Street # Street Name

UTM West East
 Reference South North
Is stone cornice original?
 Photographic Log Roll No. 04-97 Frame(s) 6A
 Photographer Bonrog

Owner/Contact Timothy West Phone _____

II. Classification (Select the category which best describes the present and original use)

- | | | | |
|---------------------------------------|-------------------------|-------------------|----------------------------|
| <input type="checkbox"/> Present Use | A. Residence - Non-Farm | G. Industrial | M. Park/Cemetery |
| | B. Residence-Farm | H. Museum | N. Row House |
| <input type="checkbox"/> Original Use | C. Commerical | I. Military | O. End Row House |
| | D. Educational | J. Religious | P. Semi-Detached or Duplex |
| | E. Entertainment | K. Scientific | Q. Can't Determine |
| | F. Government | L. Transportation | R. Other |

III. Date of Construction

- Core Major Wing
 A. 1680-1730 C. 1780-1820 E. 1860-1900
 B. 1730-1780 D. 1820-1860 F. 1900-1930

Source of Date
 Estimate Datestone Hearsay
 Deed, Tax list, etc. Other

Sketch Datestone (Optional)

Architect/Builder (if known) _____

IV. Historical Significance (if known)

V. Map References: If the site appears on any historic maps, mark X in the appropriate box(es) and indicate property owner if possible.

- 1873 Witmar's Farm Atlas _____
 1883 Breou Farm Atlas Mary Hayes
 Sanborn Maps _____
 Franklin Maps _____

Additional Maps/Information:

VI. Associated Buildings: Mark X in the box(es) which indicate any buildings presently associated with the site.

- | | |
|--|---|
| <input type="checkbox"/> Barn(s) | <input type="checkbox"/> Carriage House |
| <input type="checkbox"/> Springhouse | <input type="checkbox"/> Kiln |
| <input type="checkbox"/> Smokehouse | <input type="checkbox"/> Outhouse |
| <input type="checkbox"/> Ice house | <input type="checkbox"/> Corn Crib |
| <input type="checkbox"/> Root Cellar | <input type="checkbox"/> Cemetery |
| <input checked="" type="checkbox"/> Shed | <input type="checkbox"/> Windmill |
| <input type="checkbox"/> Stable | <input type="checkbox"/> Tenant house |
| <input type="checkbox"/> Other _____ | |

PLAN SKETCH: In the space provided sketch the site, including location of associated buildings, roads, major vegetation, streams, stone walls, etc. Sketch plan of main structure, showing placement of wings, porches, etc.

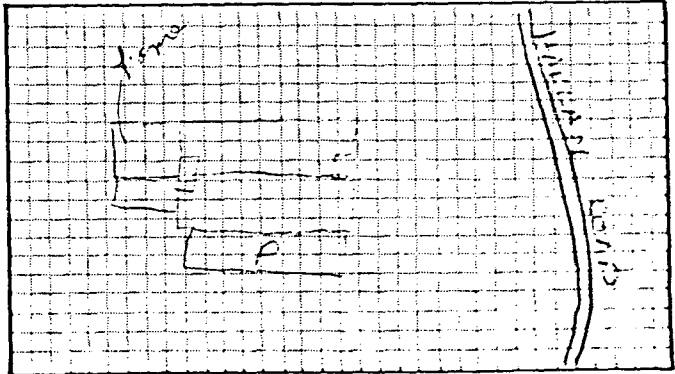

es Mill House (49-4)

al Boundary Description:

inning at a point on Star Gazer Road approximately 900 feet north of its
ersection with Brandywine Creek Road;

n proceeding in a southwesterly direction approximately 150 feet to an unnamed
eam;

n proceeding in a northwesterly direction along the stream approximately 200
c to a point;

n proceeding in a northeasterly direction approximately 150 feet to a point in
r Gazer Road;

n proceeding in a southeasterly direction 200 feet along Star Gazer Road to the
ce of beginning.

taining 3/4 acres, more or less.

27.

rare corbeled stone cornice sets it apart from most other buildings in the West Branch Brandywine Scenic River Corridor and within the region. That there are two other buildings in relative proximity featuring similar stone cornices gives it added significance as a subject for further research and study to uncover possible connections or influences.

The Hayes Mill House is of additional significance for its association with the Hayes Whetstone Mill and Quarry. The quarry was opened by Mordecai Hayes about 1780 to supply the neighborhood with stones for whetting scythes, grain cradles, and sickles. According to the 1932 U.S. Geographical Survey in the Coatesville - West Chester Folio, No. 223, the stone was a quartzitic gneiss of the Setters formation (Glenarn Series). The stone here was of an unusually soft, fine texture "without the least trace of grit, producing a keen blade with but little effort."

Initially Mordecai Hayes fashioned the whetstones by hand, dressing the chiseled rock to a proper size. Given its size and location, the Hayes Mill House was no doubt built by Mordecai Hayes as a tenant house for this operation. Mordecai deeded the quarry tract to his son Eli Hayes in 1808. Eli built a stone house on the tract, but by 1905 it had fallen to ruin.

The Whetstone business was acquired by Eli's nephew, Jacob Hayes, in 1850. He erected a stone and frame mill to supply water power for cutting and dressing the stones. According to an historical account of the operation,

" The blocks from the quarry were split into thin slabs, then cut into proper size, and dressed by being held in a two-hand frame and pressed down upon a large revolving mill-stone set horizontally, the latter sprinkled with sand kept constantly wet. The stones were thus ground to shape and smoothly rounded, somewhat on the principle of the potter's wheel."

Whetstones were packed in boxes of 100 and retailed from 12 to 15 cents a piece. A local newspaper reported, "The Brandywine whetstone has a wide-spread reputation, being regarded as superior to any other stone in the market."

Jacob Hayes sold the whetstones in Philadelphia, Wilmington (Delaware), and West Chester. According to the 1860 U.S. Census Schedule of Manufacturing, his annual sales were 6,000 whetstones at a cost of \$550.00.

With the advent of mowing machines, reapers, and combines, whetstones were no longer essential to local farming operations, and the business was abandoned some time in the 1870s-80s.

The whetstone mill was located to the west of the Hayes Mill House on a small stream feeding into the West Branch Brandywine. A photograph of the mill in the family's possession shows it had a first story of stone, banked into a hill, and a frame second story. The quarry was located upstream and now is on a separate parcel. A new house has been constructed partially within the confines of the old quarry. Today, all that remains of this milling operation so indigenous to the Brandywine corridor, is the Hayes Mill House and faint evidence of a millrace to the west of it.