

PENNSYLVANIA HISTORIC RESOURCE SURVEY FORM
 BUREAU FOR HISTORIC PRESERVATION Box 1026
 PA HISTORICAL & MUSEUM COMMISSION Harrisburg, PA 17120

7. Local survey organization

Philadelphia Historical Commission

8. property owners name and address

City of Philadelphia
 1040 Municipal Services Building
 Philadelphia, PA 19102

9. tax parcel number / other number

886220000

10.

U.T.M. Zone 118 Easting 4791010

11. status (other surveys, lists etc.)

PHRS (8-8-82)

2.5 acres Northing 25540

usgs sheet: Philadelphia

12. classification
 site () structure () object ()
 building Thematic
 in N.R. district yes () no ()

13. date(s) (how determined)
 1905-1907

14. period
 1905-1907

15. style, design or folk type
 Colonial Revival

19. original use
 Public School

20. present use
 Private Sch.

16. architect or engineer
 Lloyd Titus

17. contractor or builder
 William J. Smith

18. primary building mat./construction
 brick with granite
 fronts

21. condition
 Good

22. integrity
 Good

23. site plan with north arrow

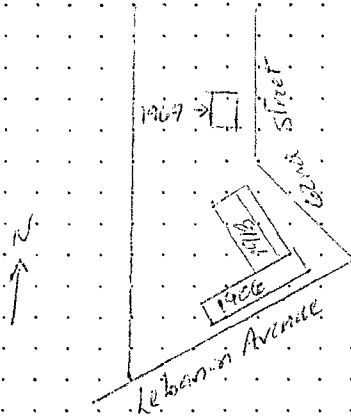

BLACK AND WHITE PRINT(S)
 3 1/2" x 5" enlargement or medium format contact
 note location of negative in block 24.

24. photo notation

25. file/location

26. brief description (note unusual features, integrity, environment, threats and associated buildings)

See reverse side

(continue on back if necessary)

27. history, significance and/or background

See reverse side

(continue on back if necessary)

28. sources of information

See reverse side

29. prepared by:

Jefferson M. Moak

30. date
 5-27-87

revision(s)

(continue on back if necessary)

1. County
 Philadelphia

2. municipality
 Philadelphia

6. other name (historic name if any)
 Overbrook School

3. street address or specific location
 6201-6231 Lebanon Avenue

4. survey code

5. present name

PHA

3. ADDRESS: Lebanon Avenue, 6201-6231

5. NAME:

6. FORMER NAME: Overbrook School

13. DATES: 1905-1907

ADDITIONS: 1913-1914

DESCRIPTION: A 2 story, 7-register, granite faced brick school on a raised basement. The left and right three registers have arched openings on the first floor and rectangular openings with large stone lintels on the second floor. The center three registers are in a 1-3-1 pattern of rectangular openings with heavy stone lintels. A front gable surmounts these registers, which project slightly from the remainder of the building. Within the gable is a small arched opening. The east and west elevations each contain four registers with an entranceway with stone frontispiece and entablature located in the northern register. The overhanging roof has been trimmed back to the facade line. In 1913-1914, an eight register addition, designed by H. deCourcsey Richards to match the original, was constructed with an entrance in the left register and a central pedimented section. All of the openings are rectangular, generally with paired sash and stone lintels and sills.

HISTORY/SIGN.: The Overbrook School continues the trend started by Joseph W. Anschutz in designing granite-clad buildings, using a Colonial Revival motif. Lloyd Titus was the major designer at the School District in the interim period between the departure of Anschutz and the employment of H. deCourcsey Richards as Chief Designer. Titus designed 22 of the 37 buildings erected between 1900 and 1905, including the monumental Northeast Manual Training School, now Thomas A. Edison High School. The Overbrook School, like the Crispin School at 4500 Rhawn Street in Northeast Philadelphia, stands as one of the last non-fireproof buildings erected by the School District. Richards' addition matches the use of materials of the original Titus structure and follows the general lines of the earlier building but incorporates some of Richards' trademarks including large arched registers in the center of his addition and at the north end over the rear entrance. The building is now enjoying a second life as a private school.

28. SOURCES: Edmunds, Public School Buildings of Philadelphia, 1900-1907

EVALUATION: The Overbrook School should be placed upon the National Register as part of the Philadelphia Public Schools Thematic District.

National Register Criteria: C, Architecture

Boundary Justification: The nominated property contains the contributing building, one non-contributing building, and all the historically associated land.

There is one contributing and one noncontributing building on the nominated property.

EVALUATION

Verbal boundary: the nominated property is tax parcel #886220000.

EVALUATOR(S)

