

PENNSYLVANIA HISTORIC RESOURCE SURVEY FORM
 BUREAU FOR HISTORIC PRESERVATION Box 1026
 PA HISTORICAL & MUSEUM COMMISSION Harrisburg, PA 17120

7. Local survey organization
 Philadelphia Historical Commission

8. property owners name and address
 School District of Philadelphia
 21st & Winter Streets
 Philadelphia, Pennsylvania 19103

9. tax parcel number / other number
 886209500

10. U.T.M. zone **18** easting **485380**
 less than one acre
 northing **4421019210**

11. status (other surveys, lists etc.)
 PHRS (5-20-1981)

usgs sheet: Philadelphia

12. classification
 site () structure () object ()
 building () Thematic
 in N.R. district yes () no ()

13. date(s) (how determined)
 1925-1926

15. style, design or folk type
 Art Deco

19. original use
 School

14. period
 1925-1926

20. present use
 School

16. architect or engineer
 Irwin T. Catharine

17. contractor or builder
 McCloskey & Company

18. primary building mat./construction
 Brick with stone and
 terra cotta trim

21. condition
 Good

22. integrity
 Excellent

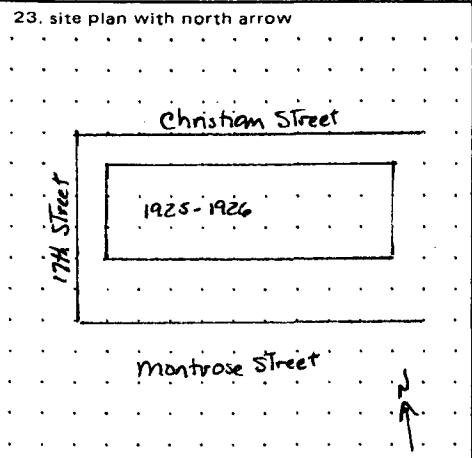

BLACK AND WHITE PRINT(S)
 3 1/2" x 5" enlargement or medium format contact
 note location of negative in block 24.

24. photo notation

25. file/location

26. brief description (note unusual features, integrity, environment, threats and associated buildings)
 See reverse side

27. history, significance and/or background
 See reverse side

28. sources of information
 See reverse side

29. prepared by:
 Jefferson M. Moak

30. date
 5-27-87

(continue on back if necessary)

1. County
 Philadelphia

2. municipality
 Philadelphia

3. street address or specific location
 1616-1644 Christian Street
 (a.k.a. 901-911 S. 17th Street)

4. survey code

5. present name
 Edwin M. Stanton School

6. other name (historic name if any)
 N/A

3. ADDRESS: Christian Street, 1616-1644

5. NAME: Stanton, Edwin M., School

6. FORMER NAME:

13. DATES: 1925-1926

ADDITIONS: None

DESCRIPTION: The Edwin M. Stanton School is a 3-story brick building set upon a raised basement. Rectangular in shape, it measures three registers upon its east and west elevations and ten along its north and south elevations. The front entrance is located on the west elevation. It consists of a free-standing Greek Doric portico highlighted by colored tiles. The center register of the west elevation projects slightly and contains three openings at the second/third floor landing. A single vertical row of openings cuts the outside registers. The registers on the side elevations each contain three openings. The east elevation's left register contains the same window arrangement as found on the sides. The central register contains three widely separated openings. No openings pierce the right register. A stone dripcourse runs along the raised basement and a band of colored tiles sits beneath the stone cornice and brick parapet.

HISTORY/SIGN.: Between 1925 and 1929, the School Board erected five buildings using Type Number 146. The first three of these were triplets in every way: the Mary C. Wister School (1925-1926), the Edwin M. Stanton School (1925-1926) and the Lydia Darrah School (1926-1927). The other two were later variations of the original design: the Spring Garden School (1927-1928) and the Edward M. Paxson School (1928-1929). The Paxson School has been demolished. The Darrah and Spring Garden Schools were included as part of the Philadelphia Public Schools Thematic Nomination in 1986. The Wister and Stanton Schools were omitted, even though they were actually the first ones constructed and today retain most, if not all, of their original appearances. Both of these schools were also built by the same contractor, McCloskey & Company, which obtained the building permits for their construction at the same time. This school, from the plans of Irwin T. Catharine in the Art Deco style, reflects a marked break in architecture from the traditional forms, e.g., Georgian Revival and Collegiate Gothic, for schools and stresses modernity. It is identical with the Darrah and Wister Schools.

28. SOURCES: School Board, "List of Buildings Under Contract"
Building Permit 1925 # 9844

EVALUATION: This building should be entered onto the National Register as part of the Philadelphia Public Schools Thematic Nomination.

National Register Criteria: C, Architecture

Boundary Justification: The nominated property contains the contributing building and all historically associated land.

There is one contributing building on the nominated property.

Verbal boundary: the nominated property is tax parcel #886209500.

EVALUATION

EVALUATOR(S)



Philadelphia County
 Zone 18
 UTM 18/489100/4424500

Philadelphia Public Schools
 Thematic Nomination
 James Ludlow School
 Philadelphia County
 Zone 18
 UTM 18/487500/4424480

Philadelphia Quad
 Philadelphia Public Schools
 Thematic Nomination
 Thomas Durham School
 Philadelphia County
 Zone 18
 UTM 18/485520/4421420

Philadelphia Public Schools
 Thematic Nomination
 Edwin Stanton School
 Philadelphia County
 Zone 18
 UTM 18/485380/4420920

Philadelphia Public Schools
 Thematic Nomination
 Norris S. Barrat School
 Philadelphia County
 Zone 18
 UTM 18/485380/4421320

Philadelphia Public Schools
 Thematic Nomination
 George Nebinger School
 Philadelphia County
 Zone 18
 UTM 18/486820/4420520

Philadelphia Public Schools
 Thematic Nomination
 James Wilson School
 Philadelphia County