

<b>PENNSYLVANIA HISTORIC RESOURCE SURVEY FORM</b> OFFICE OF HISTORIC PRESERVATION Box 1026 PA HISTORICAL & MUSEUM COMMISSION Harrisburg, PA 17120		7. Local survey organization	
8. property owners name and address  School District of Philadelphia 21st & Parkway Phila., PA 19103		9. tax parcel number other number  012383900	10. U.T.M. zone easting northing 18 486280 4419300
12. classification site ( ) structure ( ) object ( ) building (X) in N.R. district yes ( ) no (X)		13. date(s) (how determined) 1909 14. period 1900-1910	15. style, design or folk type  Academic Gothic
16. architect or engineer  J. Horace Cook		17. contractor or builder	18. primary building material construction  Granite w. granite trim
		19. original use School	20. present use School
		21. condition Above Average	22. integrity Excellent

1. County Philadelphia  
 2. municipality Philadelphia  
 3. street address or specific location  
 4. survey code 061-87980-01821

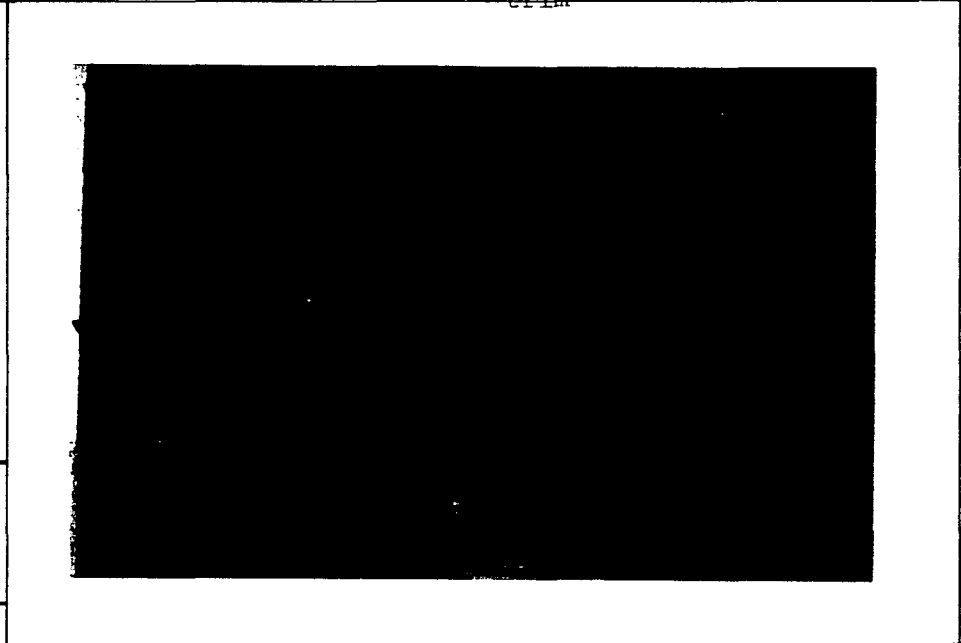
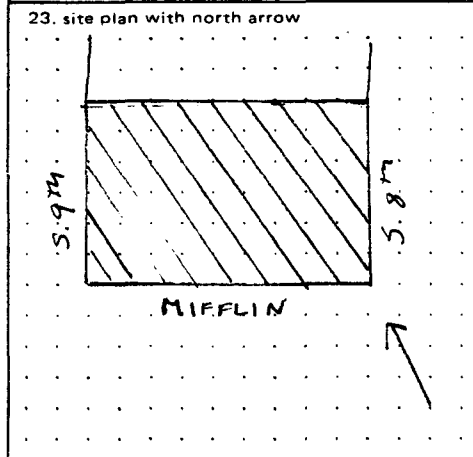

24. photo notation  
 GT/MSB-22

25. file/location

26. brief description (note unusual features, integrity, environment, threats and associated buildings)

The Southwark School marks Cook's transformation from Georgian toward the parapeted medieval which is his bridge to modern design. The end walls are of particular note, with central doors, responding to the centered double loaded corridor, with flanking stair towers that break through the roofline. Broad groups of windows on either side are continued on the long front.

**USE THIS COPY FOR DUPLICATING**

(continue on back if necessary)

27. history, significance and/or background

Another handsome product of Cook's office, for the school board, bringing the scale of the city to small residential block.

(continue on back if necessary)

28. sources of information  
 Clio Index 0028766

29. prepared by:  
 G. Thomas

30. date 8/19/80  
 revision 51

(continue on back if necessary)

5. present name Southwark School  
 6. other name (historic name if any)

ADDITIONAL DATA/PHOTOS  
number all continuations from front

4. survey code  
061-87980-01821

EVALUATION

Would contribute to a district.

EVALUATOR(S)

G. Thomas

7. Local survey organization

8. property owners name and address

9. tax parcel number/other number

11. status (other surveys, lists etc.)

SPHSS

10. U.T.M. Zone easting

usgs sheet: northing

12. classification site ( ) structure ( ) object ( ) building ( ) district ( )

Thematic

13. date(s) (how determined)

14. period 1911

15. style, design or folk type

Anglo/Gothic

19. original use School

20. present use School

16. architect or engineer

H. deC. Richards

17. contractor or builder

David Peoples

18. primary building mat./construc.

Reinforced Concr.  
Granite

21. condition Good

22. integrity Excel.

23. site plan with north arrow



24. photo notation

25. file/location

26. brief description (note unusual features, integrity, etc.)

(continue on back if necessary)

27. history, significance and/or background

(continue on back if necessary)

28. sources of information

(continue on back if necessary)

29. prepared by:

30. date revision(s)

Computer Coding (BHP Survey Grantees Must Complete)

31. county \_\_\_\_\_ 32. style \_\_\_\_\_; \_\_\_\_\_; \_\_\_\_\_; \_\_\_\_\_

33. construction material \_\_\_\_\_; \_\_\_\_\_; \_\_\_\_\_; \_\_\_\_\_ 34. roof \_\_\_\_\_; \_\_\_\_\_

35. design type \_\_\_\_\_; \_\_\_\_\_; \_\_\_\_\_

36. historic function \_\_\_\_\_; \_\_\_\_\_; \_\_\_\_\_; \_\_\_\_\_

37. construction feature \_\_\_\_\_; \_\_\_\_\_; \_\_\_\_\_; \_\_\_\_\_ 38. ext. walls \_\_\_\_\_ 39. plan \_\_\_\_\_

40. facade width \_\_\_\_\_ 41. roof material \_\_\_\_\_ 42. stories \_\_\_\_\_ 43. depth \_\_\_\_\_

44. ext. design \_\_\_\_\_; \_\_\_\_\_; \_\_\_\_\_; \_\_\_\_\_

45. int. design \_\_\_\_\_; \_\_\_\_\_; \_\_\_\_\_; \_\_\_\_\_

1. County Phila

2. municipality Phila

3. street address or specific location 1821 S. 9th St

4. survey code

5. present name Southwark School

6. other name (historic name if any)

Southwark School

Physical Description

Three story granite structure with ground level basement. An immense stone pile designed in the Anglo-Saxon castle mode. Rectangular in plan with a projecting, central tower. The building is entered through a segmented, compound arched opening. The building face is penetrated by grouped window sash with thin lintels and exaggerated panels. The basement sash are all punctuated by straight lintels. A molded cornice, running around the building, rests at the second and third floor levels. An unusual, large granite square, resembling tiling, rests along the side elevation. Above the third floor the attic story is pierced by small windows. The parapet wall has decorative, stepped stone panels.

Statement of Significance

Completed in 1911, the Southwark School stands as a handsome, exceptionally intact example of school design by Henry deCoursey Richards, Chief Draftsman under J. Horace Cook, Superintendent. The building marks a turning point in the Building Department's stylistic direction, moving away from Georgian Revival toward the medieval, or Jacobean modes. In this transition, the Superintendent's office fell in tune with 20th century philosophy which adopted the historical, Jacobethan Revival design as the quintessential style for institutional buildings.

EVALUATION

EVALUATOR(S)

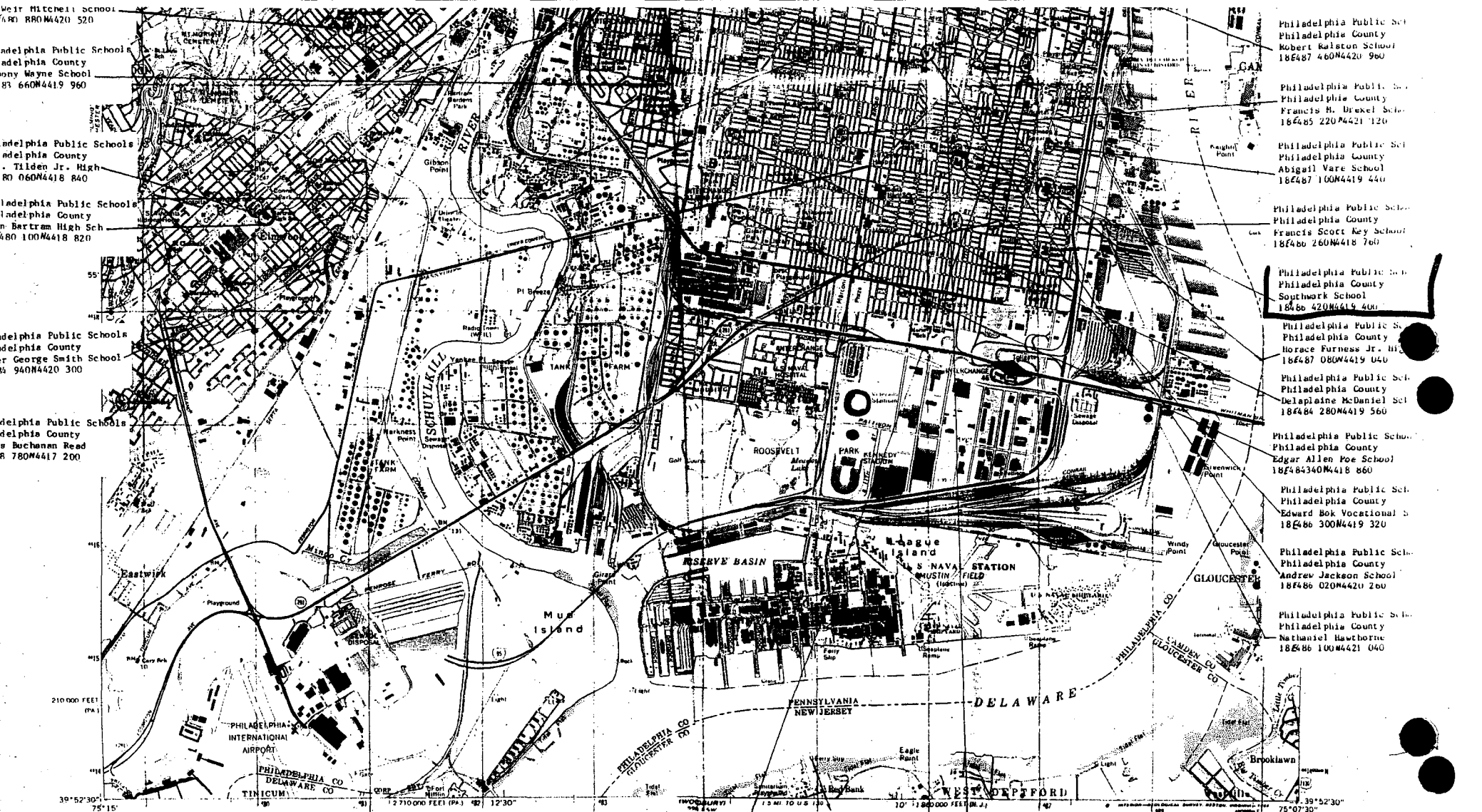

Philadelphia Public Schools  
Philadelphia County  
Tony Wayne School  
RD 83 660N4419 960

Philadelphia Public Schools  
Philadelphia County  
Tilden Jr. High  
RD 060N4418 840

Philadelphia Public Schools  
Philadelphia County  
Bertram High Sch  
RD 60 100N4418 820

Philadelphia Public Schools  
Philadelphia County  
George Smith School  
RD 940N4420 300

Philadelphia Public Schools  
Philadelphia County  
Buchanan Read  
RD 780N4417 200

Philadelphia Public Sch  
Philadelphia County  
Robert Galston School  
186487 460N4420 960

Philadelphia Public Sch  
Philadelphia County  
Francis M. Brekel Sch  
186485 220N4421 120

Philadelphia Public Sch  
Philadelphia County  
Abigail Vane School  
186487 160N4419 440

Philadelphia Public Sch  
Philadelphia County  
Francis Scott Key School  
186486 260N4418 760

Philadelphia Public Sch  
Philadelphia County  
Southwork School  
186486 420N4419 400

Philadelphia Public Sch  
Philadelphia County  
Horace Furness Jr. H.S.  
186487 080N4419 060

Philadelphia Public Sch  
Philadelphia County  
Delaplane McDaniel Sch  
186484 280N4419 560

Philadelphia Public Sch  
Philadelphia County  
Edgar Allen Poe School  
186484340N4418 860

Philadelphia Public Sch  
Philadelphia County  
Edward Bok Vocational S  
186486 300N4419 320

Philadelphia Public Sch  
Philadelphia County  
Andrew Jackson School  
186486 020N4420 260

Philadelphia Public Sch  
Philadelphia County  
Nathaniel Hawthorne  
186486 100N4421 040

Mapped by the U. S. Coast & Geodetic Survey  
Edited and published by the Geological Survey  
Control by USGS, NOS/NOAA, and USCE  
Planimetry by photogrammetric methods from aerial photographs  
taken 1946. Topography by planimetric surveys taken 1965.  
Field checked 1967.  
Selected hydrographic data compiled from NOS chart 280 (1967).  
This information is not intended for navigational purposes.  
Polyconic projection. 10,000-foot grid ticks based on the Pennsylvania  
coordinate system, south zone, and New Jersey coordinate system  
1000-meter Universal Transverse Mercator grid ticks,  
zone 18, shown in blue.  
1927 North American Datum  
To place on the predicted North American Datum 1983  
move the projection lines 6 meters south and  
31 meters west as shown by dashed corner ticks.  
Red tint indicates areas in which only landmark buildings are shown.  
There may be private intrusions within the boundaries of the  
National or State reservations shown on this map.

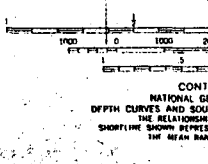
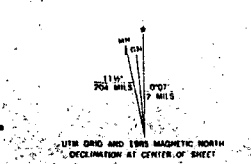

Philadelphia Public Schools  
Philadelphia County  
George Washington Sch.  
186486 920N4420 160

Philadelphia Public Schools  
Philadelphia County  
Frank C. Palumbo School  
186486 180N4420 880

ROAD CLASSIFICATION  
Heavy-duty Light-duty  
Medium-duty Unimproved dirt  
Interstate Route U.S. Route State Route

PHILADELPHIA, PA. - N. J.  
39075-H2-1F-024  
1967  
PHOTOCHEMICAL 1986  
1MA 0603 / NW BLINDS 983

THIS MAP COMPLIES WITH MATERIAL MAY ALTERNATE STANDARDS  
FOR SALE BY U.S. GEOLOGICAL SURVEY, RESTON, VIRGINIA 22092  
A FOLDER DESCRIBING TOPOGRAPHIC MAPS AND SYMBOLS IS AVAILABLE ON REQUEST