

Refer Hunt Hill
Cecil County

- N4428750
- N4428480
- N4428670
- N442860
- A 3339420
- B 3339460
- C 3339100
- P 3339160

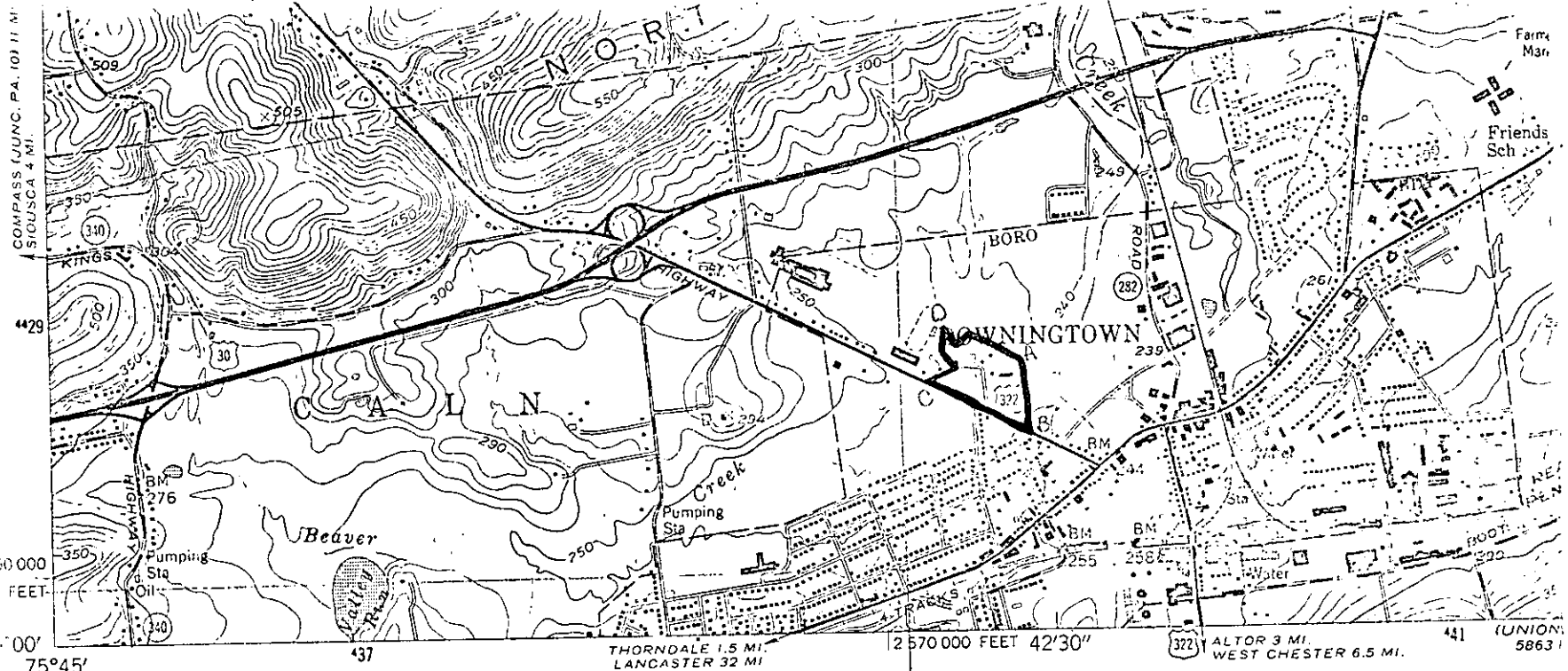

COMPASS (JUNC. PA. 10) 11 M.
SILOUSCA 4 MI.

429
250 000
FEET

75°45' 437 2 570 000 FEET 42'30" 441 (UNION) 58631
THORNDALE 1.5 MI. LANCASTER 32 MI. ALTOR 3 MI. WEST CHESTER 6.5 MI.

Mapped, edited, and published by the Geological Survey
Control by USGS and USC&GS

Topography from aerial photographs by Wild A-8
Aerial photographs taken 1951. Field check 1956
Polyconic projection. 1927 North American datum
10,000-foot grid based on Pennsylvania coordinate system,
south zone. 1000 meter Universal Transverse Mercator
grid ticks, zone 18, shown in blue

Revisions shown in purple compiled in cooperation with
State of Pennsylvania agencies, from aerial photographs
taken 1968 and 1973. This information not field checked

Purple hatching indicates area to be submerged
at elevation 359 feet

(COATESVILLE)
5863 11 NE

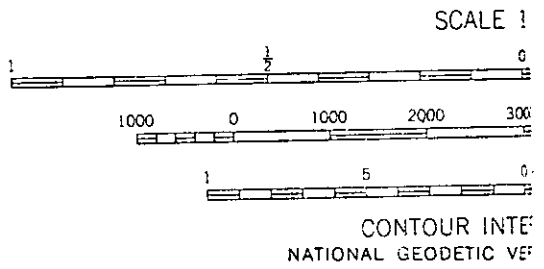
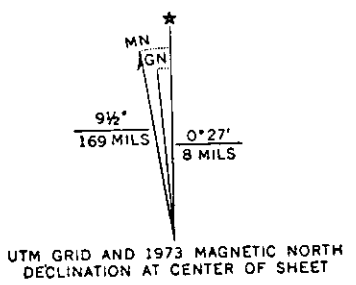

THIS MAP COMPLIES WITH NATIONAL
FOR SALE BY U. S. GEOLOGICAL SURVEY
A FOLDER DESCRIBING TOPOGRAPHIC MAPS

UNITED STATES DEPARTMENT OF THE INTERIOR
NATIONAL PARK SERVICE

FOR THIS USE ONLY
RECEIVED
DATE ENTERED

NATIONAL REGISTER OF HISTORIC PLACES INVENTORY -- NOMINATION FORM

SEE INSTRUCTIONS IN HOW TO COMPLETE NATIONAL REGISTER FORMS
TYPE ALL ENTRIES -- COMPLETE APPLICABLE SECTIONS

1 NAME

HISTORIC
ROGER HUNT MILL
AND/OR COMMON

2 LOCATION

STREET & NUMBER
Race Street -- NOT FOR PUBLICATION

CITY, TOWN CONGRESSIONAL DISTRICT
Downingtown **16**

STATE VICINITY OF CODE COUNTY CODE
Pennsylvania **42** **Chester** **029**

3 CLASSIFICATION

CATEGORY	OWNERSHIP	STATUS	PRESENT USE
<input type="checkbox"/> DISTRICT	<input type="checkbox"/> PUBLIC	<input checked="" type="checkbox"/> OCCUPIED	<input type="checkbox"/> AGRICULTURE <input type="checkbox"/> MUSEUM
<input checked="" type="checkbox"/> BUILDING(S)	<input checked="" type="checkbox"/> PRIVATE	<input type="checkbox"/> UNOCCUPIED	<input type="checkbox"/> COMMERCIAL <input type="checkbox"/> PARK
<input type="checkbox"/> STRUCTURE	<input type="checkbox"/> BOTH	<input type="checkbox"/> WORK IN PROGRESS	<input type="checkbox"/> EDUCATIONAL <input checked="" type="checkbox"/> PRIVATE RESIDENCE
<input type="checkbox"/> SITE	<input type="checkbox"/> PUBLIC ACQUISITION	<input type="checkbox"/> ACCESSIBLE	<input type="checkbox"/> ENTERTAINMENT <input type="checkbox"/> RELIGIOUS
<input type="checkbox"/> OBJECT	<input type="checkbox"/> IN PROCESS	<input type="checkbox"/> YES: RESTRICTED	<input type="checkbox"/> GOVERNMENT <input type="checkbox"/> SCIENTIFIC
	<input type="checkbox"/> BEING CONSIDERED	<input type="checkbox"/> YES: UNRESTRICTED	<input type="checkbox"/> INDUSTRIAL <input type="checkbox"/> TRANSPORTATION
		<input checked="" type="checkbox"/> NO	<input type="checkbox"/> MILITARY <input type="checkbox"/> OTHER:

4 OWNER OF PROPERTY

NAME
Charles L. and Daniel M. Tabas

STREET & NUMBER
915 North Delaware Avenue

CITY, TOWN STATE
Philadelphia **Pennsylvania**

VICINITY OF

5 LOCATION OF LEGAL DESCRIPTION

COURTHOUSE,
REGISTRY OF DEEDS, ETC. **Chester County Courthouse**

STREET & NUMBER
Market and High Street

CITY, TOWN STATE
West Chester **Pennsylvania**

6 REPRESENTATION IN EXISTING SURVEYS

TITLE **Pennsylvania Inventory of Historic Places**

DATE **6-18-79** -- FEDERAL STATE COUNTY LOCAL

DEPOSITORY FOR SURVEY RECORDS **Pennsylvania Historical and Museum Commission**

CITY, TOWN STATE
Harrisburg **Pennsylvania**

7 DESCRIPTION**CONDITION**

EXCELLENT
 GOOD
 FAIR

DETERIORATED
 RUINS
 UNEXPOSED

CHECK ONE

UNALTERED
 ALTERED

CHECK ONE

ORIGINAL SITE
 MOVED DATE _____

DESCRIBE THE PRESENT AND ORIGINAL (IF KNOWN) PHYSICAL APPEARANCE

STRUCTURE #1

A two story stone grist mill, approximately 30'6" x 48' with a one story frame addition, 11' x 45', on the northern elevation. The rubble coursed fieldstone walls are dotted with small to medium sized apertures. The Swedish gabrel shingled roof and flat cornice matches the roof of the Downing homestead in nearby East Caln Township, which was constructed within the same decade, circa 1740. The mill minus its stone chimney and frame addition has deteriorated rapidly within the past two or three years. Since it is the largest and earliest mill complex in central Chester County it should be saved. The walls will probably collapse during the next very hard winter.

STRUCTURE #2

The main house is a five bay wide, two story stone structure approximately 53' x 23'. The fieldstone walls are now covered with stucco. The double hung sash windows have conservative beaded trim, sills and headers. Both front facade entrances have recessed doorways, transom lights, and similar beaded trim to compliment the Georgian cornice with a large return. The shingled roof is enhanced by 3 brick interior chimneys mounted at the peak and flanked on the slopes by pedimented dormers. The 1798 Direct Tax List describes it as a 35' x 23' stone, two stories and windows as follows: 2-24 lights, 3-20 lights, - 2-18 lights, 2-15 lights, 4-6 lights with a stone kitchen 18' x 23'. The total size coincides with the combination of both parts in the 1798 direct tax list. The date of construction is c. 1740. After Samuel Ringwalt purchased the mill complex in 1846 he retained panel shutters on the first floor and louvered ones on the second floor, but modernized the structure by changing most of the window glass from small to large panes.

STRUCTURE #2 Part B

The rear north stone extension, 26'x20' is 2½ stories with a tin roof and a double flush brick chimney. The northeast facade is continuous with the same elevation of Part A. Samuel Ringwalt probably built this section, c. 1850, with windows to match Part A. An unusual feature for this geographical area are the squared Egyptian pillars mounted on brick bases that line the attached, 8' x 41', one story veranda with flat roof.

STRUCTURE # 2 Part C

A minor extension, of one story is attached to the north facade of Part B. Its dimensions are 8' x 22'.

STRUCTURE #2 Part D

Another minor one story extension is attached to the northwest corner of Part A on the north elevation. Its measurements are 8' x 12'.

STRUCTURE #3

A two story carriage house and apartment, 24' x 40', three bays wide possesses stucco exterior walls over stone. The only clue to an architectural style is the large gable on the southeast elevation which could be interpreted as Queen Anne. The first story has a double set of sliding garage doors,

**NATIONAL REGISTER OF HISTORIC PLACES
INVENTORY -- NOMINATION FORM**

ROGER HUNT MILL

CONTINUATION SHEET

ITEM NUMBER 7 PAGE 2

one panelled and one vertical beaded boards. The windows are double hung sash, six over six lights, extended lintels, and contrasting plain trim. A small rounded arch, which was probably a window that has now been filled with stucco is near the apex of the front facade gable. The three gables are asphalt shingled with medium overhangs and plain cornices.

STRUCTURE #4

Two and one half story, Greek Revival tenant house, c. 1850, is 3 bays wide. The structure has stone foundation, and asbestos siding shingles over frame on the facades. The narrow double hung sash windows have slightly extended sashes, six over six lights and contrasting simple trim. The small windows have 3 lights. The moderately steep slate roof has an overhang on the north and south elevations with a plain cornice. A small porch with shed roof protrudes from the centrally located main entrance. The front portion of the house measures 24' x 16' while the rear of the structure is divided into 2 sections, 16' x 16' and 16' x 7' respectively.

STRUCTURE #5

The 1½ story stone structure, 18' x 18', with the one story frame addition, 12' x 18', is known as the "millers house". Whoever was hired for the daily efficient running of the mill rented this house from the owner. It is in very poor condition and unphotographable because of the dense overgrown foliage surrounding the structure.

8 SIGNIFICANCE

PERIOD	AREAS OF SIGNIFICANCE -- CHECK AND JUSTIFY BELOW			
<input type="checkbox"/> PREHISTORIC	<input type="checkbox"/> ARCHEOLOGY-PREHISTORIC	<input type="checkbox"/> COMMUNITY PLANNING	<input type="checkbox"/> LANDSCAPE ARCHITECTURE	<input type="checkbox"/> RELIGION
<input type="checkbox"/> 1400-1499	<input type="checkbox"/> ARCHEOLOGY-HISTORIC	<input type="checkbox"/> CONSERVATION	<input type="checkbox"/> LAW	<input type="checkbox"/> SCIENCE
<input type="checkbox"/> 1500-1599	<input type="checkbox"/> AGRICULTURE	<input type="checkbox"/> ECONOMICS	<input type="checkbox"/> LITERATURE	<input type="checkbox"/> SCULPTURE
<input type="checkbox"/> 1600-1699	<input type="checkbox"/> ARCHITECTURE	<input type="checkbox"/> EDUCATION	<input type="checkbox"/> MILITARY	<input type="checkbox"/> SOCIAL/HUMANITARIAN
<input checked="" type="checkbox"/> 1700-1799	<input type="checkbox"/> ART	<input type="checkbox"/> ENGINEERING	<input type="checkbox"/> MUSIC	<input type="checkbox"/> THEATER
<input checked="" type="checkbox"/> 1800-1899	<input checked="" type="checkbox"/> COMMERCE	<input type="checkbox"/> EXPLORATION/SETTLEMENT	<input type="checkbox"/> PHILOSOPHY	<input type="checkbox"/> TRANSPORTATION
<input type="checkbox"/> 1900-	<input type="checkbox"/> COMMUNICATIONS	<input type="checkbox"/> INDUSTRY	<input type="checkbox"/> POLITICS/GOVERNMENT	<input type="checkbox"/> OTHER (SPECIFY)
		<input type="checkbox"/> INVENTION		

SPECIFIC DATES

BUILDER/ARCHITECT

STATEMENT OF SIGNIFICANCE

The gambrel roof mill with its support buildings is the only surviving 18th century mill complex in the Downingtown valley. Constructed in 1759 by Roger Hunt, primary source documentation has been found on its continued use as a grist mill into the 20th century. During the 1700's there were so many mills in the area that the growing village was called Milltown. The Roger Hunt Mill is the only survivor from this era. Frequently, it was used as a reference point in Penn patents and road docket surveys in both Chester and Lancaster Counties.

Each proprietor of the mill was also involved in community affairs. Roger Hunt was coordinator of supplies from a section of Chester County during the French and Indian War and elected to the Pennsylvania Province Assembly seven times between 1749 and 1761. Samuel Ringwalt, proprietor of the mill in 1800's, was one of the leaders in the movement to incorporate Downingtown Borough. He also led the call to support the Union when the Civil War began by calling a meeting which resulted in enlisting almost 17% of the town's population for the cause.

9 MAJOR BIBLIOGRAPHICAL REFERENCES

SEE CONTINUATION SHEET

10 GEOGRAPHICAL DATA

ACREAGE OF NOMINATED PROPERTY 9.55

UTM REFERENCES Downingtown, PA

1:24,000

A 118 | 339 | 4210 | 4428 | 750
 ZONE EASTING NORTHING
 C 118 | 339 | 1010 | 4428 | 6710

B [] | [] | [] | [] | [] | []
 ZONE EASTING NORTHING
 D [] | [] | [] | [] | [] | []

VERBAL BOUNDARY DESCRIPTION

SEE CONTINUATION SHEET

LIST ALL STATES AND COUNTIES FOR PROPERTIES OVERLAPPING STATE OR COUNTY BOUNDARIES

STATE	CODE	COUNTY	CODE

11 FORM PREPARED BY

NAME / TITLE

Jane L.S. Davidson

ORGANIZATION

DATE

Borough of Downingtown

STREET & NUMBER

TELEPHONE

Four West Lancaster Avenue

CITY OR TOWN

STATE

215-269-0344

Downingtown

Pennsylvania

12 STATE HISTORIC PRESERVATION OFFICER CERTIFICATION

THE EVALUATED SIGNIFICANCE OF THIS PROPERTY WITHIN THE STATE IS:

NATIONAL

STATE

LOCAL x

As the designated State Historic Preservation Officer for the National Historic Preservation Act of 1966 (Public Law 89-665), I hereby nominate this property for inclusion in the National Register and certify that it has been evaluated according to the criteria and procedures set forth by the National Park Service.

STATE HISTORIC PRESERVATION OFFICER SIGNATURE

TITLE ED WEINTRAUB

DATE

FOR NPS USE ONLY

I HEREBY CERTIFY THAT THIS PROPERTY IS INCLUDED IN THE NATIONAL REGISTER

DATE

DIRECTOR, OFFICE OF ARCHEOLOGY AND HISTORIC PRESERVATION

ATTEST:

DATE

KEEPER OF THE NATIONAL REGISTER

