

United States Department of the Interior
National Park Service

For NPS use only

National Register of Historic Places
Inventory—Nomination Form

received

date entered

See instructions in *How to Complete National Register Forms*
Type all entries—complete applicable sections

1. Name

historic Indiana Borough 1912 Municipal Building

and/or common None

2. Location

street & number 39 Seventh Street

N/A not for publication

city, town Indiana N/A vicinity of

state Pennsylvania code 42 county Indiana code 063

3. Classification

Category	Ownership	Status	Present Use
<input type="checkbox"/> district	<input type="checkbox"/> public	<input checked="" type="checkbox"/> occupied	<input type="checkbox"/> agriculture
<input checked="" type="checkbox"/> building(s)	<input checked="" type="checkbox"/> private	<input type="checkbox"/> unoccupied	<input checked="" type="checkbox"/> commercial
<input type="checkbox"/> structure	<input type="checkbox"/> both	<input type="checkbox"/> work in progress	<input type="checkbox"/> educational
<input type="checkbox"/> site	Public Acquisition	Accessible	<input type="checkbox"/> entertainment
<input type="checkbox"/> object	<input type="checkbox"/> in process	<input checked="" type="checkbox"/> yes: restricted	<input type="checkbox"/> government
	<input checked="" type="checkbox"/> being considered	<input type="checkbox"/> yes: unrestricted	<input type="checkbox"/> industrial
		<input type="checkbox"/> no	<input type="checkbox"/> military
			<input type="checkbox"/> museum
			<input type="checkbox"/> park
			<input type="checkbox"/> private residence
			<input type="checkbox"/> religious
			<input type="checkbox"/> scientific
			<input type="checkbox"/> transportation
			<input type="checkbox"/> other:

4. Owner of Property

name Owen Kugel; OK Properties

street & number Suite 504; 8 North Queen Street

city, town Lancaster N/A vicinity of state Pennsylvania, 17603

5. Location of Legal Description

courthouse, registry of deeds, etc. Indiana County Courthouse

street & number Philadelphia Street

city, town Indiana state Pennsylvania

6. Representation in Existing Surveys

title Indiana County Historic Sites Survey has this property been determined eligible? yes no

date 1981 federal state county local

depository for survey records Indiana County Historical Society; 6th at Wayne Street

city, town Indiana state Pennsylvania

7. Description

Condition		Check one	Check one
<input checked="" type="checkbox"/> excellent	<input type="checkbox"/> deteriorated	<input type="checkbox"/> unaltered	<input checked="" type="checkbox"/> original site
<input type="checkbox"/> good	<input type="checkbox"/> ruins	<input checked="" type="checkbox"/> altered	<input type="checkbox"/> moved
<input type="checkbox"/> fair	<input type="checkbox"/> unexposed		date <u>N/A</u>

Describe the present and original (if known) physical appearance

The 1912 Indiana Borough Municipal Building is a 2 1/2 story, 3 x 5 bay rectangular brick structure dominated by a large shaped parapet and elongated arcaded window arrangement on its west facade. It is located in a mixed use area containing residential and commercial structures one block N of Indiana's main street. The building is grander than the modest Colonial Revival houses N of it as befits the Borough's former governmental center and it acts as a transitional element between them and the low rise commercial structures to the south.

The Municipal Building's gabled roof is covered with green barrel-tiles. Two pent roof segments simulating returning eaves wrap around both sides of the gable ends. Their green color adds drama to the facade. Modillions line the eaves on all elevations.

The facade (facing 7th Street) is dominated by a uniquely shaped, stepped and arced parapet reminiscent of ornament on 17th century Dutch Town Halls. Stone coping lines the parapet. A blind oculus below it crowns a triad of round arched windows on the second story. Today all three of these windows are filled with glass block with central vents, and their original fanlights have been painted. This is the only major alteration to the building's exterior in 70 years. Foliated stone hood molds decorate the arcade.

A shelf remains in front of the windows showing scars of the original balustrade. Stone bands further define the facade as single quoins on the second story, a belt course, a sill course and water table below.

The Municipal Building is constructed of brown raked brick highlighted with vitrified Cleveland limestone. The first story facade has a central entry flanked by two (8/1) windows. The double doored entry and the windows have stone foliated lintels and stone sills. The shaped lintels echo the shape of the Flemish parapet above. The doors are panelled, have multiple lights, and are sheltered by a hip roof hood of green tile supported by large paired brackets.

The five bay side elevations (N and S) have two more elaborate bays close to Seventh Street and three bays of simpler windows to the east. The Nixon Alley elevation (S) reveals a slight downward slope from W to E; exposed basement and a full size garage bay in the eastern most bay take advantage of the slope. The d/s (6/1) and (4/1) windows of the side elevations are grouped in two's and three's but have individual lintels and sills. Those in the first two (W) bays of the first story are similar to the first story windows on the facade. Those on the second story are paired elongated d/s (9/1) windows with 9 pane transoms above.

The third bay of the S side elevation contains a single entry with transom above opening into the central stairwell with access to the sub-basement and the garage to the E. The large wooden garage doors at the eastern bay of the south elevation are original plank and cross beam style with six lights in each. A modern panelled door is found in the east elevation at the south end. The water table which crowns the ashlar foundation on the facade acts as a sill course for the windows flanking the central entry bay on the S elevation and a belt course at the oversized garage doors.

The N elevation is dissimilar from the south in that it contains the chimney-like hose tower needed by the fire department. The tower resembles a massive brick chimney and contains a metal ladder construction still visible on the roof.

**United States Department of the Interior
National Park Service**

**National Register of Historic Places
Inventory—Nomination Form**

Indiana Borough 1912 Municipal Building

For NPS use only

received

date entered

Continuation sheet

Description

Item number 7

Page 2

The rear elevation (E) has even fenestration on the first and second stories [d/s (6/1) windows] and a masonry four car garage addition to the basement level.

Several interior features such as the hose tower, fire call box, and Mosler safe graphically illustrate the multitude of Municipal services once housed in the structure.

The garage doors on the S and E elevations lend access to a single oversized garage designed to house one large fire engine diagonally with smaller trucks flanking it. (Although an ingenious storage system, it was less than efficient in emergencies!)

8. Significance

Period	Areas of Significance—Check and justify below			
<input type="checkbox"/> prehistoric	<input type="checkbox"/> archeology-prehistoric	<input type="checkbox"/> community planning	<input type="checkbox"/> landscape architecture	<input type="checkbox"/> religion
<input type="checkbox"/> 1400-1499	<input type="checkbox"/> archeology-historic	<input type="checkbox"/> conservation	<input type="checkbox"/> law	<input type="checkbox"/> science
<input type="checkbox"/> 1500-1599	<input type="checkbox"/> agriculture	<input type="checkbox"/> economics	<input type="checkbox"/> literature	<input type="checkbox"/> sculpture
<input type="checkbox"/> 1600-1699	<input checked="" type="checkbox"/> architecture	<input type="checkbox"/> education	<input type="checkbox"/> military	<input type="checkbox"/> social/
<input type="checkbox"/> 1700-1799	<input type="checkbox"/> art	<input type="checkbox"/> engineering	<input type="checkbox"/> music	<input type="checkbox"/> humanitarian
<input type="checkbox"/> 1800-1899	<input type="checkbox"/> commerce	<input type="checkbox"/> exploration/settlement	<input type="checkbox"/> philosophy	<input type="checkbox"/> theater
<input checked="" type="checkbox"/> 1900-	<input type="checkbox"/> communications	<input type="checkbox"/> industry	<input type="checkbox"/> politics/government	<input type="checkbox"/> transportation
		<input type="checkbox"/> invention		<input type="checkbox"/> other (specify)

Specific dates 1912 **Builder/Architect** Herbert King Conklin/Fred Herlinger

Statement of Significance (in one paragraph)

The 1912 Municipal Building of Indiana Borough was part of a local effort, possibly inspired by the City Beautiful Movement, to enhance the appearance of the borough. Local newspapers of the time reflect a renewed interest in the city's physical appearance by exhorting their readers to clean up Indiana by painting their alley fences and disposing of refuse properly. In these small ways and on this small scale the Borough participated in the larger national consciousness of how a city's appearance can affect a city's "image" and ultimately reflect its prosperity.

The fact that a city the size of Indiana (1916 population of 7000) held an architectural contest for the design of their new Municipal Building, a contest which attracted architects from neighboring states, indicates the seriousness of the Borough Council's purpose.

Herbert King Conklin (1877-1918), their choice, was a rather obscure architect nationally. His obituary in the NY Times of Wednesday, October 23, 1918 (p. 13, column 2) lists him as a graduate of MIT but says little else. Two possible architectural influences in the architect's work are illustrated in the Indiana Municipal Building: the prevalence of Dutch Colonial "Revival" architecture in his home state of New Jersey during the late Victorian era; and an interest reflected in the International Journals of the era in Town Halls.

The "Flemish" gable ends of the building harken back to an image of Holland as the epitome of well-run middle-class states.

The 1912 Municipal Building is unique in Indiana Borough, although it complements its location in size and scale. Other nearby governmental buildings such as the 1877 Second Empire County Courthouse [Philadelphia at Sixth (NW)] and the preceding Borough Building at 6th and Nixon Alley (SE) are illustrations of an earlier era. The 1913 Municipal Building reflects its age and the optimism of the local Council due to the County's turn of the century coal boom.

The choice of materials: brown raked brick in common bond; green clay barrel tiles for the roof, and white "vitrified" Cleveland limestone for the ornament indicates the architect's desire to build well and to last. The interior, while not elaborate, is sturdy and functional; very "no-nonsense" as befits the seat of the local authorities. But here too, the architect's hand was needed. It was a tall order to house several diverse functions in one building. The fire call box, hose tower, the truck scale (to weigh the citizen's coal shipments, truck and all), and the jail cells are extant artifacts of the building's original use.

The Indiana Borough 1912 Municipal Building is an important local structure as it illustrates the aspirations of its era and Edwardian style and craftsmanship which enliven a strictly functional building.

9. Major Bibliographical Reference

See continuation sheet.

10. Geographical Data

Acreeage of nominated property .09 acres

Quadrangle name Indiana

Quadrangle scale 1:24000

UTM References

A	<u>17</u>	<u>656220</u>	<u>4498080</u>
	Zone	Easting	Northing

B			
	Zone	Easting	Northing

C			
	Zone	Easting	Northing

D			
	Zone	Easting	Northing

E			
	Zone	Easting	Northing

F			
	Zone	Easting	Northing

G			
	Zone	Easting	Northing

H			
	Zone	Easting	Northing

Verbal boundary description and justification

See continuation sheet.

List all states and counties for properties overlapping state or county boundaries

state	<u>NA</u>	code	<u>NA</u>	county	<u>NA</u>	code	<u>NA</u>
-------	-----------	------	-----------	--------	-----------	------	-----------

state	<u>NA</u>	code	<u>NA</u>	county	<u>NA</u>	code	<u>NA</u>
-------	-----------	------	-----------	--------	-----------	------	-----------

11. Form Prepared By

name/title Lu Donnelly, Architectural Historian

organization U.S. City Corporation

date 5/23/83

street & number 500 The Landmarks Office Building
One Station Square

telephone NA

city or town Pittsburgh

state Pennsylvania

12. State Historic Preservation Officer Certification

The evaluated significance of this property within the state is:

national state local

As the designated State Historic Preservation Officer for the National Historic Preservation Act of 1966 (Public Law 89-665), I hereby nominate this property for inclusion in the National Register and certify that it has been evaluated according to the criteria and procedures set forth by the National Park Service.

State Historic Preservation Officer signature

title Larry E. Tise, State Historic Preservation Officer date 7/18/83

For NPS use only

I hereby certify that this property is included in the National Register

date

Keeper of the National Register

Attest:

date

Chief of Registration

National Register of Historic Places Inventory—Nomination Form

Indiana Borough 1912 Municipal Building
Continuation sheet Bibliography

Item number 9

Page 1

1. Lewis Mumford, The Culture of Cities, Harcourt, Brace & Co., NY 1938.
2. Jane Jacobs, The Death & Life of Great American Cities, Random House, NY 1961.
3. Alan Gowans, Architecture in New Jersey. Vol. 6, the New Jersey Historical Series, 1964. (Chap. III)
4. Jakob Rosenberg/Seymour Slive/E. H. ter Kuile. Dutch Art and Architecture 1600-1800 (Baltimore, Maryland: Penguin Books, Inc, 1966) pp. 182 and 186.
5. 1907 articles on Town Halls of France in: Royal Institute of British Architects, Journal of Proceedings. Series 3, volume 14, 1907, illustrated.
6. History of Indiana County, pub. J.A. Caldwell (Newark, Ohio 1880)
7. The Western PA Historical Mag., Vol. 18, 1935. p. 267.
"The Early Settlement of Indiana County, PA", Cortlandt W.W. Elkin.
8. "The Founding of Indiana, Pennsylvania" by Clarence D. Stephenson. Mahoning Mimeograph & Pamphlet Service; Box 183, Marion Center, PA 15759.
9. "Sesqui--Centennial 1816-1966 Indiana Echoes".
10. Indiana County Gazette. Volume 22, #13, 11/8/1911 (p. 3, col. 4); #30, 3/6/1912 (p. 1, col. 5); #34, 4/3/1912 (p. 1, col. 2-4) illus.
11. The Indiana Times. Volume 35: #27, 2/19/1913 (p. 1); #31, 3/19/1913 (p. 1).
12. The American Renaissance 1876-1917, pub. by The Brooklyn Museum, New York, 1979.

**United States Department of the Interior
National Park Service**

**National Register of Historic Places
Inventory—Nomination Form**

Indiana Borough 1912 Municipal Building

Continuation sheet Boundary Description

Item number 10

Page 1

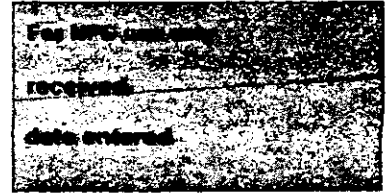

Beginning on the east side of North 7th Street on the east line of said 7th Street and at the junction of the said street with Nixon Avenue; thence along the east line of 7th Street, North 45 feet to a post; thence in a line parallel to Nixon Avenue and at right angles with North 7th Street in an easterly direction 75 feet; thence North in a line parallel to North 7 Street 5 feet to lot of William C. Vernocy;*thence along said alley in a southerly direction 50 feet to Nixon Avenue; thence along the northern line of Nixon Avenue 145 feet to the eastern line of North 7th Street, the place of beginning. Said lot fronting 45 feet on North 7th Street and extending in an easterly direction 45 feet in width for a distance of 75 feet, and 50 feet in width the remaining distance of 70 feet to the said private alley, being 145 feet in depth and having thereon erected a three-story brick building. Said premises bearing Tax Assessment Map No. 22-01-115.

*thence east along lot of Vernocy 70 feet to a private alley;

*Indiana Borough
1912 Municipal Building*

INDIANA QUADRANGLE
PENNSYLVANIA-INDIANA CO.
7.5 MINUTE SERIES (TOPOGRAPHIC)

5165 II NE
(CLYMER)

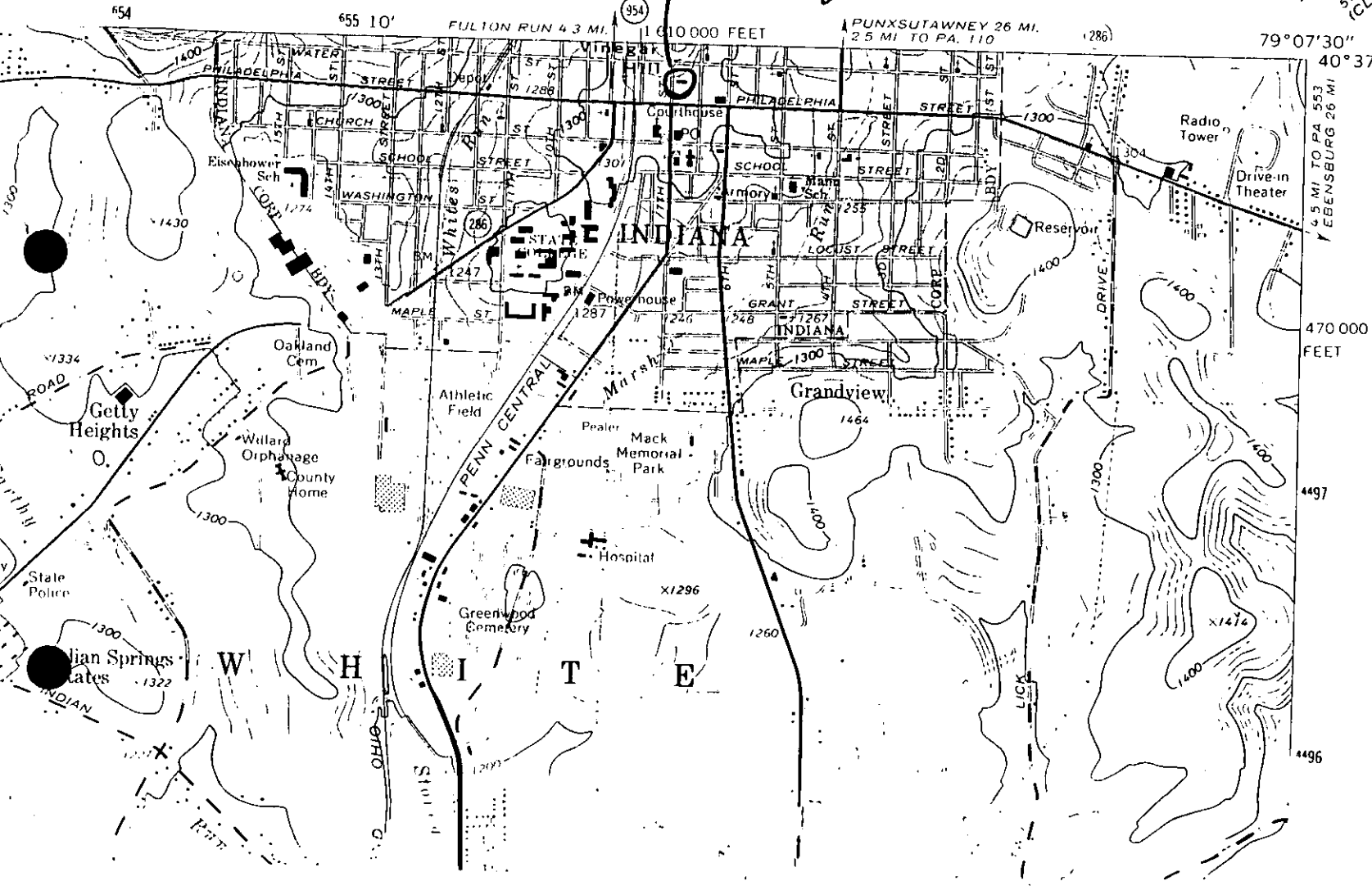

Indiana Borough 1912 Municipal
Building
Indiana County
Zone 17 E656220 N4498080

79°07'30"

40°37'3"

4.5 MI TO PA 553
Ebensburg 26 MI

470 000
FEET

4497

4496