

Part of  
**Covered Bridges of Erie County TR**

Available at the National Park Service website  
<http://www.nr.nps.gov/nrcover.htm>

# 38-25-02 Name: Harrington  
Location: T338 off 25088 southwest of Albion  
UTM: Zone 17 N 46 35 150 E 5 47 375 Acreage: .05  
Owner: Conneaut Township

$$(12420') \times (14'410') =$$

$$121 \times 141 = 22081 \div 100 = .05$$

Stream: West branch Conneaut Creek  
Truss Type: Multiple Kingpost  
Builder: William Sherman  
Year: Circa 1870

*Beaver Country  
is*

End Post to  
End Post Length: 72'  
Clearance: 12'

Road Surface Paved  
Width: 14'  
Load: 4 ton

Distinguishing  
Features: Thoroughly rebuilt in 1962 under supervision of state  
highway department

Condition: Good

**United States Department of the Interior  
Heritage Conservation and Recreation Service**

For HCRS use only  
received \_\_\_\_\_  
date entered \_\_\_\_\_

**National Register of Historic Places  
Inventory—Nomination Form**

See instructions in *How to Complete National Register Forms*  
Type all entries—complete applicable sections

**1. Name**

historic Covered Bridges of Erie County Thematic Resource

and/or common \_\_\_\_\_

**2. Location**

street & number \_\_\_\_\_ not for publication

city, town \_\_\_\_\_ vicinity of \_\_\_\_\_ congressional district 24

state Pennsylvania code 42 county Erie code 049

**3. Classification**

<b>Category</b>	<b>Ownership</b>	<b>Status</b>	<b>Present Use</b>	
<input type="checkbox"/> district	<input checked="" type="checkbox"/> public	<input checked="" type="checkbox"/> occupied	<input type="checkbox"/> agriculture	<input type="checkbox"/> museum
<input type="checkbox"/> building(s)	<input type="checkbox"/> private	<input type="checkbox"/> unoccupied	<input type="checkbox"/> commercial	<input type="checkbox"/> park
<input type="checkbox"/> structure	<input type="checkbox"/> both	<input type="checkbox"/> work in progress	<input type="checkbox"/> educational	<input type="checkbox"/> private residence
<input type="checkbox"/> site	<b>Public Acquisition</b>	<b>Accessible</b>	<input type="checkbox"/> entertainment	<input type="checkbox"/> religious
<input type="checkbox"/> object	<input type="checkbox"/> in process	<input type="checkbox"/> yes: restricted	<input type="checkbox"/> government	<input checked="" type="checkbox"/> scientific
<input checked="" type="checkbox"/> Thematic	<input type="checkbox"/> being considered	<input checked="" type="checkbox"/> yes: unrestricted	<input type="checkbox"/> industrial	<input type="checkbox"/> transportation
		<input type="checkbox"/> no	<input type="checkbox"/> military	<input type="checkbox"/> other:

**4. Owner of Property**

name Multiple

street & number \_\_\_\_\_

city, town \_\_\_\_\_ vicinity of \_\_\_\_\_ state \_\_\_\_\_

**5. Location of Legal Description**

courthouse, registry of deeds, etc. Erie County Courthouse

street & number West Sixth Street

city, town Erie state Penna

**6. Representation in Existing Surveys**

title Erie County Historical & Architectural Preservation Plan  
has this property been determined eligible?  yes  no

date June 1976  federal  state  county  local

depository for survey records Erie County Planning Department

city, town Erie state Pennsylvania

# 9. Major Bibliographical Reference

Shank, William H., Historic Bridges of Pennsylvania. York: Bucharthorn, 1966 p. 3-27  
Alton, Richard Sanders, Covered Bridges of the Middle Atlantic States Battleboro Vermont: Stephen Greene Press, 1959 PP 73,105,106,110

# 10. Geographical Data

Acreage of nominated property .02

Quadrangle name \_\_\_\_\_ See Continuation Sheet Quadrangle scale \_\_\_\_\_

### UMT References

A 

--	--	--	--	--	--	--	--	--	--

  
Zone Easting Northing

B 

--	--	--	--	--	--	--	--	--	--

  
Zone Easting Northing

C 

--	--	--	--	--	--	--	--	--	--

D 

--	--	--	--	--	--	--	--	--	--

E 

--	--	--	--	--	--	--	--	--	--

F 

--	--	--	--	--	--	--	--	--	--

G 

--	--	--	--	--	--	--	--	--	--

H 

--	--	--	--	--	--	--	--	--	--

### Verbal boundary description and justification

See Continuation Sheet

### List all states and counties for properties overlapping state or county boundaries

state	code	county	code
-------	------	--------	------

state	code	county	code
-------	------	--------	------

# 11. Form Prepared By

name/title John R. Claridge/Executive Director

organization Erie County Historical Society date December 27, 1979

street & number 417 State Society telephone (814) 454-1813

city or town Erie state Penna

# 12. State Historic Preservation Officer Certification

The evaluated significance of this property within the state is:

national  state  local

As the designated State Historic Preservation Officer for the National Historic Preservation Act of 1966 (Public Law 89-665), I hereby nominate this property for inclusion in the National Register and certify that it has been evaluated according to the criteria and procedures set forth by the Heritage Conservation and Recreation Service.

### State Historic Preservation Officer signature

ED WEINTRAUB, State Historic  
title Preservation Officer date \_\_\_\_\_

For HCRS use only  
I hereby certify that this property is included in the National Register  
date \_\_\_\_\_

Keeper of the National Register  
Attest: \_\_\_\_\_ date \_\_\_\_\_  
Chief of Registration

## 9. Major Bibliographical Reference

Shank, William H., Historic Bridges of Pennsylvania. York: Bucharthorn, 1966 p. 3-27  
Allen, Richard Sanders, Covered Bridges of the Middle Atlantic States Battleboro Vermont: Stephen Greene Press, 1959 PP 73,105,106,110

## 10. Geographical Data

Acree of nominated property .02

Quadrangle name \_\_\_\_\_ See Continuation Sheet Quadrangle scale \_\_\_\_\_

### UMT References

A 

Zone	Easting								

B 

Zone	Easting								

C 

--	--	--	--	--	--	--	--	--	--

D 

--	--	--	--	--	--	--	--	--	--

E 

--	--	--	--	--	--	--	--	--	--

F 

--	--	--	--	--	--	--	--	--	--

G 

--	--	--	--	--	--	--	--	--	--

H 

--	--	--	--	--	--	--	--	--	--

### Verbal boundary description and justification

See Continuation Sheet

### List all states and counties for properties overlapping state or county boundaries

state	code	county	code

state	code	county	code

## 11. Form Prepared By

name/title John R. Claridge/Executive Director

organization Erie County Historical Society date December 27, 1979

street & number 417 State Society telephone (814) 454-1813

city or town Erie state Penna

## 12. State Historic Preservation Officer Certification

The evaluated significance of this property within the state is:

\_\_\_ national     state    \_\_\_ local

As the designated State Historic Preservation Officer for the National Historic Preservation Act of 1966 (Public Law 89-665), I hereby nominate this property for inclusion in the National Register and certify that it has been evaluated according to the criteria and procedures set forth by the Heritage Conservation and Recreation Service.

State Historic Preservation Officer signature

ED WEINTRAUB, State Historic  
title Preservation Officer

date 6/24/80

For HCRS use only  
I hereby certify that this property is included in the National Register  
date

Keeper of the National Register  
Attest: \_\_\_\_\_ date  
Chief of Registration

DEPARTMENT OF ENVIRONMENTAL RESOURCES  
BUREAU OF TOPOGRAPHIC AND GEOLOGIC SURVEY

BEAVER CENTER QUADRANGLE  
PENNSYLVANIA  
7.5 MINUTE SERIES (TOPOGRAPHIC)

4967 IV NE  
(ALBION)

4967 IV NW  
(EAST SPRINGFIELD)

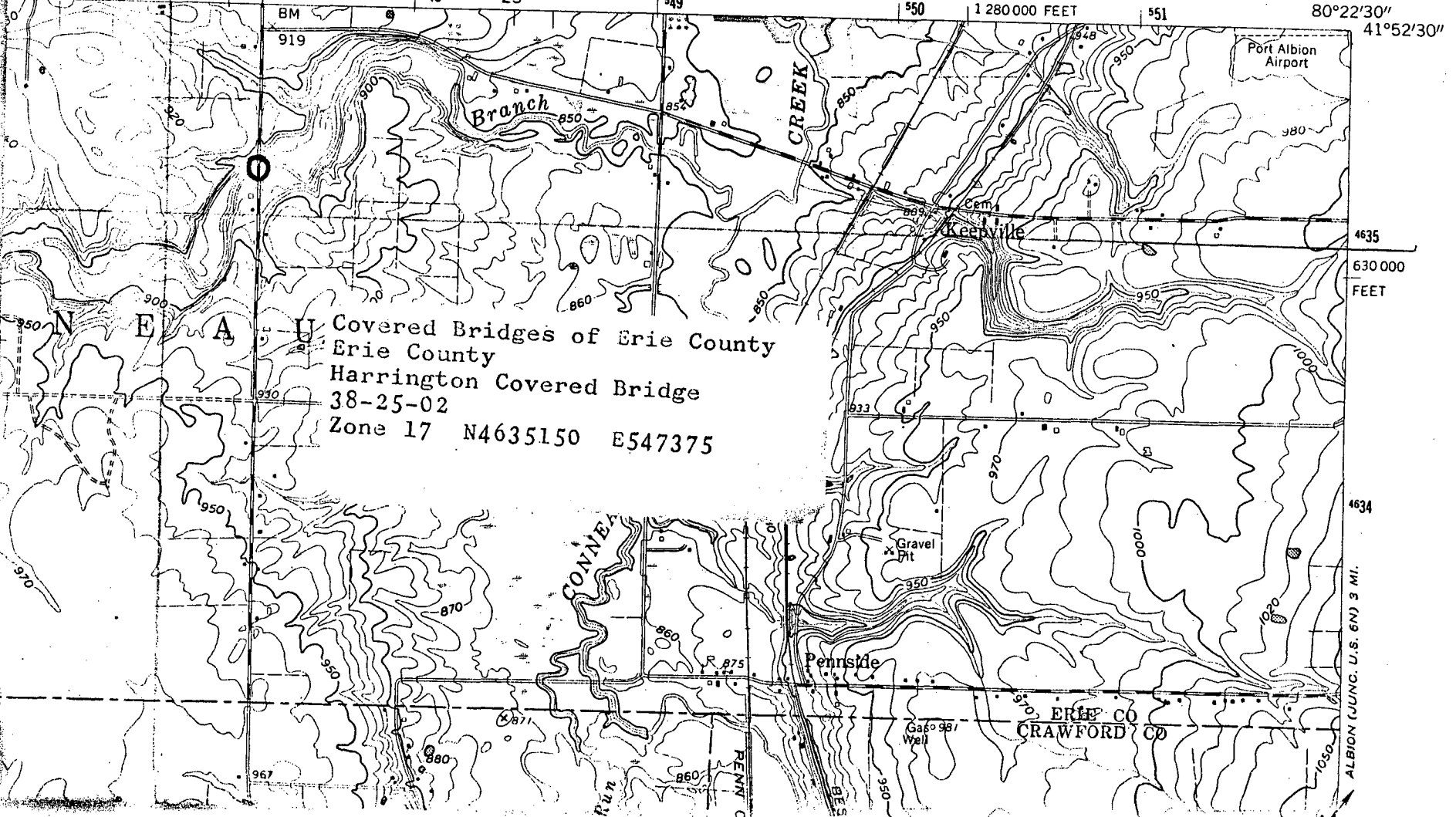

U Covered Bridges of Erie County  
Erie County  
Harrington Covered Bridge  
38-25-02  
Zone 17 N4635150 E547375

ERIE CO  
CRAWFORD CO

ALBION (JUNC. U.S. 6N) 3 MI.