

Downingtown Quad

Downingtown Industrial Site

Downingtown Industrial Site

Downingtown Industrial Site

Downingtown Industrial Site

Downingtown Industrial Site

Downingtown Industrial Site

Downingtown Industrial Site

Downingtown Industrial Site

Downingtown Industrial Site

Downingtown Industrial Site

Downingtown Industrial Site

Downingtown Industrial Site

Downingtown Industrial Site

Downingtown Industrial Site

Downingtown Industrial Site

Downingtown Industrial Site

Downingtown Industrial Site

Downingtown Industrial Site

Downingtown Industrial Site

Downingtown Industrial Site

Downingtown Industrial Site

Downingtown Industrial Site

Downingtown Industrial Site

Downingtown Industrial Site

Downingtown Industrial Site

Downingtown Industrial Site

Downingtown Industrial Site

Zone 18

A N 4428520 E 439840

B N 4428500 E 439848

C N 4428440 E 439800

D N 4428460 E 439740

Lincoln

Lincoln

Lincoln

Lincoln

Lincoln

Lincoln

Lincoln

Lincoln

Lincoln

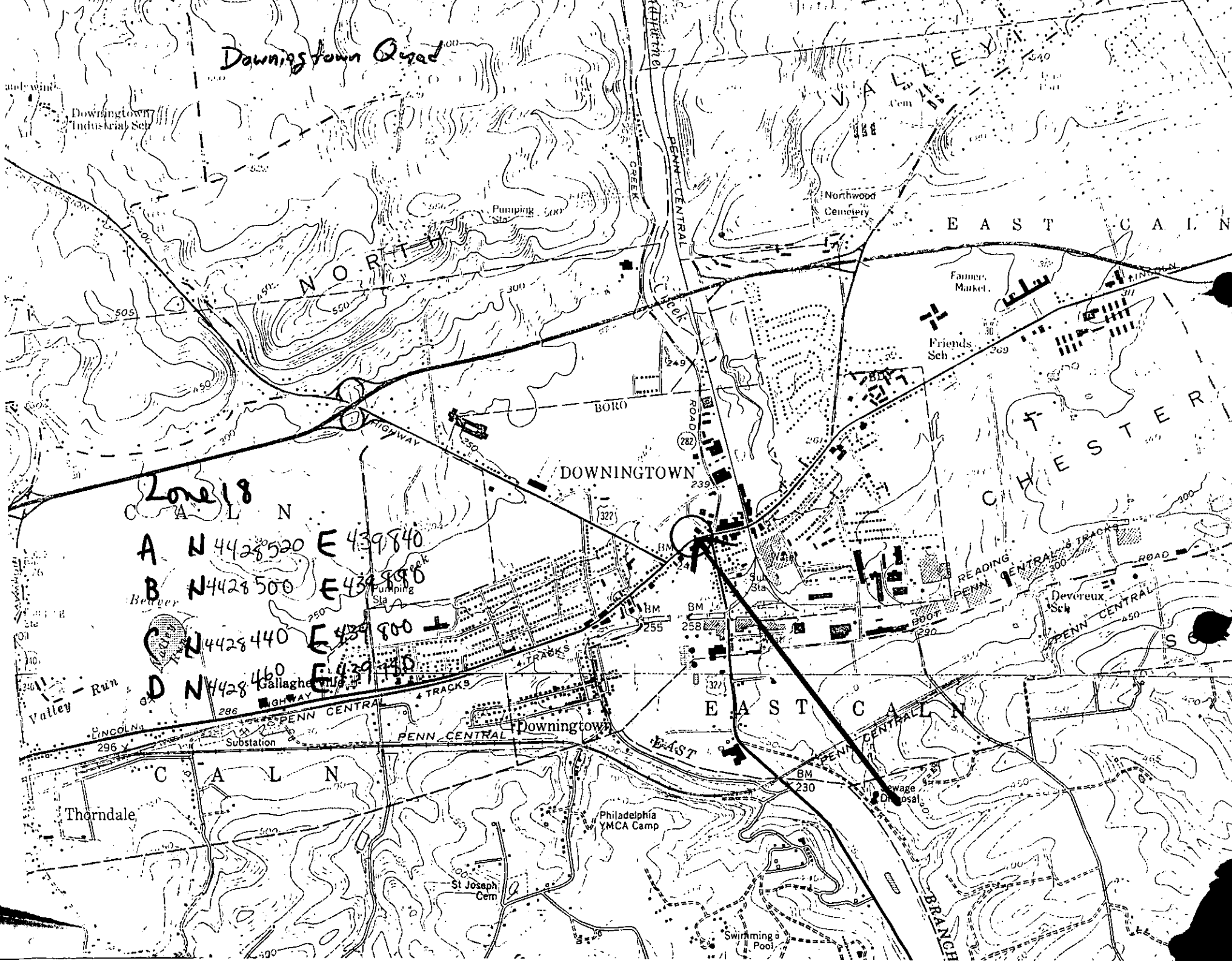

UNITED STATES DEPARTMENT OF THE INTERIOR
NATIONAL PARK SERVICE

FOR NPS USE ONLY

RECEIVED

DATE ENTERED

**NATIONAL REGISTER OF HISTORIC PLACES
INVENTORY -- NOMINATION FORM**

SEE INSTRUCTIONS IN *HOW TO COMPLETE NATIONAL REGISTER FORMS*
TYPE ALL ENTRIES -- COMPLETE APPLICABLE SECTIONS

1 NAME

HISTORIC

DOWNINGTOWN LOG HOUSE

AND/OR COMMON

2 LOCATION

STREET & NUMBER

15 East Lancaster Avenue

NOT FOR PUBLICATION

CITY, TOWN

Downingtown

CONGRESSIONAL DISTRICT

16

VICINITY OF

STATE

Pennsylvania

CODE

42

COUNTY

Chester

CODE

029

3 CLASSIFICATION

CATEGORY	OWNERSHIP	STATUS	PRESENT USE
<input type="checkbox"/> DISTRICT	<input checked="" type="checkbox"/> PUBLIC	<input checked="" type="checkbox"/> OCCUPIED	<input type="checkbox"/> AGRICULTURE <input checked="" type="checkbox"/> MUSEUM
<input checked="" type="checkbox"/> BUILDING(S)	<input type="checkbox"/> PRIVATE	<input type="checkbox"/> UNOCCUPIED	<input type="checkbox"/> COMMERCIAL <input type="checkbox"/> PARK
<input type="checkbox"/> STRUCTURE	<input type="checkbox"/> BOTH	<input type="checkbox"/> WORK IN PROGRESS	<input type="checkbox"/> EDUCATIONAL <input type="checkbox"/> PRIVATE RESIDENCE
<input type="checkbox"/> SITE	PUBLIC ACQUISITION	ACCESSIBLE	<input type="checkbox"/> ENTERTAINMENT <input type="checkbox"/> RELIGIOUS
<input type="checkbox"/> OBJECT	<input type="checkbox"/> IN PROCESS	<input type="checkbox"/> YES: RESTRICTED	<input type="checkbox"/> GOVERNMENT <input type="checkbox"/> SCIENTIFIC
	<input type="checkbox"/> BEING CONSIDERED	<input checked="" type="checkbox"/> YES: UNRESTRICTED	<input type="checkbox"/> INDUSTRIAL <input type="checkbox"/> TRANSPORTATION
		<input type="checkbox"/> NO	<input type="checkbox"/> MILITARY <input type="checkbox"/> OTHER:

4 OWNER OF PROPERTY

NAME

Borough of Downingtown

STREET & NUMBER

4 West Lancaster Avenue

CITY, TOWN

Downingtown

VICINITY OF

STATE

Pennsylvania

5 LOCATION OF LEGAL DESCRIPTION

COURTHOUSE,
REGISTRY OF DEEDS, ETC.

Chester County Courthouse

STREET & NUMBER

High and Market Streets

CITY, TOWN

West Chester

STATE

Pennsylvania

6 REPRESENTATION IN EXISTING SURVEYS

TITLE

Pennsylvania Inventory of Historic Places

DATE

1973

FEDERAL STATE COUNTY LOCAL

DEPOSITORY FOR
SURVEY RECORDS

Pennsylvania Historical & Museum Commission

CITY, TOWN

Harrisburg

STATE

Pennsylvania

7 DESCRIPTION

CONDITION		CHECK ONE	CHECK ONE
<input type="checkbox"/> EXCELLENT	<input type="checkbox"/> DETERIORATED	<input type="checkbox"/> UNALTERED	<input checked="" type="checkbox"/> ORIGINAL SITE
<input type="checkbox"/> GOOD	<input type="checkbox"/> RUINS	<input checked="" type="checkbox"/> ALTERED	<input type="checkbox"/> MOVED DATE _____
<input checked="" type="checkbox"/> FAIR	<input type="checkbox"/> UNEXPOSED		

DESCRIBE THE PRESENT AND ORIGINAL (IF KNOWN) PHYSICAL APPEARANCE

The round log, 1½ story house was constructed circa 1700, by either Jeremiah Collett, Jr., or by Joseph Hickman, later in the same decade. The structure measures twenty-one feet, nine inches by twenty-five feet with the narrow portion facing south on East Lancaster Avenue. This elevation has an aperture frequently used by the Swedes and known as a slide-board. The main entrance is off center, with a low doorway, a paneled door, and a lift-latch. A six over six double hung sash window is located to the right of the main door. All trim is simple and plain.

No windows exist on the east elevation; two four-light windows are on the gable end of the west elevation; one nine-light window is near the west corner on the north elevation. The medium pitched roof is shingled, with a massive stone and plaster interior chimney on the east wall. It is topped with a flat hood.

The bark is worn from most of the logs; however, the chinking has been replaced frequently to help preserve it. The corners of the exterior logs are shallow saddle notched, indicative of English rather than Swedish settlers. The gable ends on the east and west walls contain horizontal planking above the logs as on the Lower Swedish Log Cabin, Upper Darby, c. 1654.

The interior is divided almost in half with an English fireplace perpendicular to the east wall. The back of the fireplace helps to warm the north or back portion of the log house.

The original probably was one large room with a notched log ladder to the loft on the north half. The floor boards in this section are wider. After the Downing family obtained it in 1739, they made the following changes: An excellent Georgian mantel was placed on the fireplace; partitions were added to form two large rooms on the first floor, a serpentine staircase was built on the west wall to the second floor which was enclosed and divided into three rooms.

A front porch was added during the early part of the 20th century but removed in the 1940's. After the log house was deeded to the Borough of Downingtown in 1940, restoration was conducted by Theodore B. White, a Philadelphia architect in 1947. He said, "The Downingtown cabin contains complete, round logs, They're remarkable well-preserved.

The current condition of the structure is less secure. It is located contiguous to heavily traveled Business Route #30 (Lincoln Highway) or East Lancaster Avenue and is approximately three feet below the street level. In addition, it is approximately 175 feet from the banks of the Brandywine Creek, which floods frequently. (See attached flood map)

UNITED STATES DEPARTMENT OF THE INTERIOR
NATIONAL PARK SERVICE

FOR NPS USE ONLY

RECEIVED

DATE ENTERED

**NATIONAL REGISTER OF HISTORIC PLACES
INVENTORY -- NOMINATION FORM**

DOWNINGTOWN LOG HOUSE, Chester County

CONTINUATION SHEET

ITEM NUMBER 7

PAGE

2

The vibrations from the heavy street traffic, coupled with the high water table in this area and the frequency of flooding have caused numerous problems to the log house. The second floor is unsafe on the east side due to excessive settlement of six inches more than the west side. An inspection in the spring of 1978 also revealed that underpinning definitely is needed on the south wall, floor joists need either fixing or replacing, current flue is unworkable and the upper part of the fireplace needs masonry work done on it.

The location also hinders using the house as a museum due to the total lack of parking, and necessary heat and humidity control. The relocation of this structure is being considered.

187 SIGNIFICANCE

PERIOD		AREAS OF SIGNIFICANCE -- CHECK AND JUSTIFY BELOW				
<input type="checkbox"/> PREHISTORIC	<input type="checkbox"/> ARCHEOLOGY-PREHISTORIC	<input type="checkbox"/> COMMUNITY PLANNING	<input type="checkbox"/> LANDSCAPE ARCHITECTURE	<input type="checkbox"/> RELIGION		
<input type="checkbox"/> 1400-1499	<input type="checkbox"/> ARCHEOLOGY-HISTORIC	<input type="checkbox"/> CONSERVATION	<input type="checkbox"/> LAW	<input type="checkbox"/> SCIENCE		
<input type="checkbox"/> 1500-1599	<input type="checkbox"/> AGRICULTURE	<input type="checkbox"/> ECONOMICS	<input type="checkbox"/> LITERATURE	<input type="checkbox"/> SCULPTURE		
<input type="checkbox"/> 1600-1699	<input checked="" type="checkbox"/> ARCHITECTURE	<input type="checkbox"/> EDUCATION	<input type="checkbox"/> MILITARY	<input type="checkbox"/> SOCIAL/HUMANITARIAN		
<input checked="" type="checkbox"/> 1700-1799	<input type="checkbox"/> ART	<input type="checkbox"/> ENGINEERING	<input type="checkbox"/> MUSIC	<input type="checkbox"/> THEATER		
<input type="checkbox"/> 1800-1899	<input type="checkbox"/> COMMERCE	<input checked="" type="checkbox"/> EXPLORATION/SETTLEMENT	<input type="checkbox"/> PHILOSOPHY	<input type="checkbox"/> TRANSPORTATION		
<input type="checkbox"/> 1900-	<input type="checkbox"/> COMMUNICATIONS	<input type="checkbox"/> INDUSTRY	<input type="checkbox"/> POLITICS/GOVERNMENT	<input type="checkbox"/> OTHER (SPECIFY)		
		<input type="checkbox"/> INVENTION				

SPECIFIC DATES c. 1700

BUILDER/ARCHITECT Jeremiah Collett/or/ Joseph

Hickman

STATEMENT OF SIGNIFICANCE

The Downing Log House is the only surviving example of very early settlement by Europeans in central Chester County. Traditionally, it has become the symbol associated with the Borough of Downingtown.

Secondly, it is the oldest documented structure in the vicinity. The majority of the interior and exterior is from the original construction with a replacement of less than 8%.

This round log structure combines a few components of early Swedish construction and adaptations by the English Quakers in the Pennsylvania colony. The Swedish derivatives are: the slideboard on the south wall, the horizontal planking on the gable ends, the low doorway of the main entrance. The English touch can be found in the larger windows, placement of fireplace and its mantel, serpentine staircase, shallow notching of exterior log corners, partitions to form rooms. Mr. and Mrs. Carl Lindborg, locally known log construction experts, made an inspection recently and made the following comments:

The weathering of the exterior logs and their general condition would indicate that the cabin was constructed early in the 18th century, well within the first decade. This log structure is in its entirety a rare, unique example still extant of one of the homes of pioneers who opened your region to civilization. Its preservation and maintenance are altogether most desirable.

9 MAJOR BIBLIOGRAPHICAL REFERENCES

(See Continuation Sheet)

10 GEOGRAPHICAL DATA

ACREAGE OF NOMINATED PROPERTY 1.15

QUADRANGLE NAME _____

QUADRANGLE SCALE _____

UTM REFERENCES

A

B

ZONE EASTING NORTHING

ZONE EASTING NORTHING

C

D

E

F

G

H

VERBAL BOUNDARY DESCRIPTION

(See Continuation Sheet)

LIST ALL STATES AND COUNTIES FOR PROPERTIES OVERLAPPING STATE OR COUNTY BOUNDARIES

STATE	CODE	COUNTY	CODE
STATE	CODE	COUNTY	CODE

11 FORM PREPARED BY

NAME / TITLE

Jane L. S. Davidson

ORGANIZATION

Borough of Downingtown

DATE

STREET & NUMBER

4 West Lancaster Avenue

TELEPHONE

215-269-0344

CITY OR TOWN

Downingtown

STATE

Pennsylvania

12 STATE HISTORIC PRESERVATION OFFICER CERTIFICATION

THE EVALUATED SIGNIFICANCE OF THIS PROPERTY WITHIN THE STATE IS:

NATIONAL

STATE

LOCAL

As the designated State Historic Preservation Officer for the National Historic Preservation Act of 1966 (Public Law 89-665), I hereby nominate this property for inclusion in the National Register and certify that it has been evaluated according to the criteria and procedures set forth by the National Park Service.

STATE HISTORIC PRESERVATION OFFICER SIGNATURE

TITLE

ED WEINTRAUB, Director
Office of Historic Preservation

DATE

FOR NPS USE ONLY

I HEREBY CERTIFY THAT THIS PROPERTY IS INCLUDED IN THE NATIONAL REGISTER

DATE

KEEPER OF THE NATIONAL REGISTER

ATTEST:

DATE

CHIEF OF REGISTRATION

UNITED STATES DEPARTMENT OF THE INTERIOR
NATIONAL PARK SERVICE

FOR NPS USE ONLY

RECEIVED

DATE ENTERED

**NATIONAL REGISTER OF HISTORIC PLACES
INVENTORY -- NOMINATION FORM**

DOWNINGTOWN LOG HOUSE, Chester County

CONTINUATION SHEET

ITEM NUMBER 9 PAGE 1

Borough of Downingtown. Downingtown, PA. File

Bureau of Land Records. Dept. of Community Affairs. Warrant, Survey, Patent issued to Jeremiah Collett, Jr., Oct. 12, 1703 Patent Book A, p. 588.

Chester Co. Historical Society. West Chester, PA. Clipping File

Corps of Engineers, US Army. Philadelphia District. Flood Plain Information: East Branch Brandywine Creek (Downingtown to the Junction of East and West Branches), Chester County, PA. December, 1970

Direct Tax List of 1798. The Townships of East Caln and West Whiteland, Chester County, Pa. National Archives, Washington D. C.

Carl and Alice Lindborg, Interview, inspection and analysis of Downingtown Log House October, 1978.

US Department of Housing and Urban Development. Flood Boundary and Floodway Map, Borough of Downingtown, Chester County. Panel 01F, effective date: April 15, 1977.

(See Continuation Sheet)

10 GEOGRAPHICAL DATA

ACREAGE OF NOMINATED PROPERTY 1.15

QUADRANGLE NAME _____			QUADRANGLE SCALE _____		
UTM REFERENCES					
A	ZONE	EASTING	NORTHING	B	ZONE EASTING NORTHING
C	ZONE	EASTING	NORTHING	D	ZONE EASTING NORTHING
E	ZONE	EASTING	NORTHING	F	ZONE EASTING NORTHING
G	ZONE	EASTING	NORTHING	H	ZONE EASTING NORTHING

VERBAL BOUNDARY DESCRIPTION
 (See Continuation Sheet)

LIST ALL STATES AND COUNTIES FOR PROPERTIES OVERLAPPING STATE OR COUNTY BOUNDARIES

STATE	CODE	COUNTY	CODE
STATE	CODE	COUNTY	CODE

11 FORM PREPARED BY

NAME / TITLE Jane L. S. Davidson	DATE
ORGANIZATION Borough of Downingtown	TELEPHONE 215-269-0344
STREET & NUMBER 4 West Lancaster Avenue	CITY OR TOWN Downingtown
CITY OR TOWN Downingtown	STATE Pennsylvania

12 STATE HISTORIC PRESERVATION OFFICER CERTIFICATION

THE EVALUATED SIGNIFICANCE OF THIS PROPERTY WITHIN THE STATE IS:
 NATIONAL ___ STATE ___ LOCAL X

As the designated State Historic Preservation Officer for the National Historic Preservation Act of 1966 (Public Law 89-665), I hereby nominate this property for inclusion in the National Register and certify that it has been evaluated according to the criteria and procedures set forth by the National Park Service.

STATE HISTORIC PRESERVATION OFFICER SIGNATURE *[Signature]*

TITLE ED WEINTRAUB, Director DATE 4-19-79
Office of Historic Preservation

FOR NPS USE ONLY

I HEREBY CERTIFY THAT THIS PROPERTY IS INCLUDED IN THE NATIONAL REGISTER

ATTEST: KEEPER OF THE NATIONAL REGISTER DATE _____

CHIEF OF REGISTRATION DATE _____