

PENNSYLVANIA HISTORICAL RESOURCE SURVEY FORM
BUREAU FOR HISTORICAL PRESERVATION Box 1026
PA HISTORICAL & MUSEUM COMMISSION Harrisburg, PA 17120

7. Local Survey Organization
Birmingham Township
Brandywine Battlefield NHL Study

1. County
Chester
2. Municipality
Birmingham Township
3. Street Address or Specific Location
1175 Birmingham Road
4. Survey Code
029-03-65-014

8. Property Owner's Name and Address
Charles and Nancy Wojciehowski
1175 Birmingham Road
West Chester, PA 19382

9. Tax Parcel Number/Other Number
65-4-4.3
10. U.T.M. zone: 18, easting: 448750, northing: 4418010
11. Status (Other Surveys, Lists, Etc.)
CCHSS, National Register
Birm. Historic District
West Chester

12. Resource Count
buildings (5) district ()
sites () structures ()
objects () intrusions ()

15. Style, Design or Folk Type
Additive PA Farmhouse
19. Original Use
Residence-farm
20. Present Use
Residence-farm

13. Date(s) (how determined)
1740 d.s.
14. Period

18. Primary Building Mat./Construction
Stone (green serpentine)
21. Condition
Above average
22. Integrity
Above average

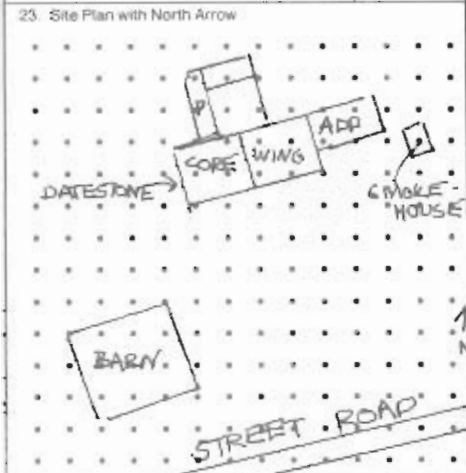

24. Photo Notation
PV: Looking at SE elevation
PC: M. Wolf
PD: 5/89

25. File/Location
NL: Birmingham Township

26. Brief Description (note unusual features, integrity, environment, threats and associated buildings)
Farm complex retaining house, barn, smokehouse, and corn crib
Core of additive serpentine stone house bears datestone "D D 1740) in west gable end; presently two and a half stories, double pile, with gable roof, three bays wide with off center entrance. Joists end mark locations of pent roof and original roofline. Major wing extends off the east, three bays wide, two and a half stories, with gable roof. Frame addition to the east built 1935.
Barn-serpentine stone, banked, double-decker, originally all stone, south wall collapsed in 1980s and rebuilt in frame, walled stockyard, bridge ramp
Smokehouse-serpentine stone, gable roof

27. History, Significance and/or Background
Core of house built by Daniel Davis in 1740 on 166-acre tract devised to him by his father John Davis c.1719-20. Major wing constructed by Daniel's grandson Aaron c.1802.
House occupied by ^{Mary}widow of James Davis (Daniel's son) during battle. Mentioned in battle accounts and located on McFaden (1778) and Bowen and Futhey (1846) maps of the battle.
Reportedly, there was an encampment of Hessian mercenaries across Birmingham Road following the battle.

28. Sources of Information
PHMC Register of Historic Sites and Landmarks form, 1970

29. Prepared By
M.L. Wolf
30. Date
7/89
Revision(s)

(continue on back if necessary)

(continue on back if necessary)

(continue on back if necessary)

Computer Coding (BHP Survey Grantees Must Complete)

31. County

32. Total Structures

33. Style

34. Construction

35. Roof

36. Survey Date (Year)

37. Area of Significance

38. Primary Use P; P; P; P

39. Secondary Use S; S; S

40. Associated With A; A; A

41. Event 1

Event 2

42. Individual 1

Individual 2

43. Status: 101 Potential NR; 102 Part of Potential district;

44. Design Type: 01 High Style; 02 Style Elements; 03 Popular Vernacular; 04 Traditional (Folk); 05 Utilitarian;

45. Ext. Walls

46. Roof Material

47. Plan

48. Stories

49. Facade Width

50. Construction Feature

51. Ext. Design Feature

52. Int. Design Feature

53. Comment _____

EVALUATION

The core of the house stood during the battle, is shown on the McFaden (1778) and Bowen and Futhey (1846) maps, and is named in the original National Register form for the Brandywine Battlefield.

Contributes to Brandywine Battlefield

For archeological potential see A-1

EVALUATOR(S)
mlw