

# NATIONAL REGISTER OF HISTORIC PLACES INVENTORY -- NOMINATION FORM

SEE INSTRUCTIONS IN HOW TO COMPLETE NATIONAL REGISTER FORMS  
TYPE ALL ENTRIES -- COMPLETE APPLICABLE SECTIONS

## 1 NAME

HISTORIC

*B.F. Jones Memorial Library*

AND/OR COMMON

## 2 LOCATION

STREET & NUMBER

*663 Franklin Avenue*

NOT FOR PUBLICATION

CITY, TOWN

*Aliquippa*

CONGRESSIONAL DISTRICT

*25*

VICINITY OF

STATE

*Pennsylvania*

CODE

*42*

COUNTY

*Beaver*

CODE

*007*

## 3 CLASSIFICATION

### CATEGORY

- DISTRICT
- BUILDING(S)
- STRUCTURE
- SITE
- OBJECT

### OWNERSHIP

- PUBLIC
- PRIVATE
- BOTH
- PUBLIC ACQUISITION
- IN PROCESS
- BEING CONSIDERED

### STATUS

- OCCUPIED
- UNOCCUPIED
- WORK IN PROGRESS
- ACCESSIBLE
- YES: RESTRICTED
- YES: UNRESTRICTED
- NO

### PRESENT USE

- AGRICULTURE
- MUSEUM
- COMMERCIAL
- PARK
- EDUCATIONAL
- PRIVATE RESIDENCE
- ENTERTAINMENT
- RELIGIOUS
- GOVERNMENT
- SCIENTIFIC
- INDUSTRIAL
- TRANSPORTATION
- MILITARY
- OTHER:

## 4 OWNER OF PROPERTY

NAME

*Borough of Aliquippa*

STREET & NUMBER

*300 Franklin Avenue*

CITY, TOWN

*Aliquippa*

VICINITY OF

STATE

*Pennsylvania 15001*

## 5 LOCATION OF LEGAL DESCRIPTION

COURTHOUSE,  
REGISTRY OF DEEDS, ETC.

*Beaver County Courthouse*

STREET & NUMBER

*800 Third Avenue*

CITY, TOWN

*Beaver*

STATE

*Pennsylvania*

## 6 REPRESENTATION IN EXISTING SURVEYS

TITLE

*Pennsylvania Inventory of Historic Places*

DATE

*6/15/78*

FEDERAL  STATE  COUNTY  LOCAL

DEPOSITORY FOR  
SURVEY RECORDS

*Pennsylvania Historic and Museum Commission*

CITY, TOWN

*Harrisburg*

STATE

*Pennsylvania*

## CONDITION

 EXCELLENT GOOD FAIR DETERIORATED RUINS UNEXPOSED

## CHECK ONE

 UNALTERED ALTERED

## CHECK ONE

 ORIGINAL SITE MOVED

DATE \_\_\_\_\_

DESCRIBE THE PRESENT AND ORIGINAL (IF KNOWN) PHYSICAL APPEARANCE

The B.F. Jones Memorial Library is a one story stone structure measuring 132'2" by 71'11". Built of Indiana limestone, the library is basically a T-shape. Four Ionic Columns support recessed colonnades located on front facades of the two side wings. Their entablatures are decorated with elaborate spiral carvings. Three large 30 light windows are set behind the recessed columns. Flanking each set of windows are carved stone medallions. The main doorway has a carved entablature. Above the bronze doorway is a nine light transom. The main door is approached by two flights of stone steps. The name B.F. Jones Memorial Library is carved above the doorway and is flanked by carved fasces and drape.

The side elevations each have three windows of 30 lights. A carved rectangular section is set above each window.

The roof line is decorated with an elaborate cast bronze cheneau. Carved in the wall face below the cheneau are the words; Philosophy, Biology, Astronomy, Fiction, History, Science, Painting, Music, Sculpture, Drama, Poetry and Romance.

The interior has been little altered although some rooms are no longer used for the purposes for which they were designed.

Details of the rooms are as follows:

#### Entrance Foyer

General design - restrained Italian Renaissance.

Ceiling - Reproduction of Italian ceiling.

Walls - Kasota stone, a Minnesota marble which had not been used heretofore for inside finish in this district.

Floor - Travertine, a volcanic rock imported from Italy. Hardest floor product known but easiest to walk upon.

Statue of B.F. Jones - Bronze, set on base of green Vermont marble. Work of Robert Aiken, N.A. celebrated sculptor of New York City.

Stairway - To Exhibition Room Lobby on lower floor. Center panels of bronze stair-rail modeled some time ago by the president of the General Bronze Company furnishing the bronze work. He had never used these, and asked permission to incorporate something of his own into the building, just for reasons of sentiment.

Door frames - Bronze. Motives in design - birds, flowers, torch and book, same inside and out.

#### Lobby (Now Pre-School Room) 31' X23'

Screens - to the right and left, made of hand wrought iron with bronze medallions, by Oscar Bach, one of the two leading wrought iron craftsmen in this country. Medallions on left depict iron and steel industry, those on right, child-life.

Ceiling - Ornamental plaster. Color planned by Miss Norah Thorpe, color architect of New York City, and executed by workmen from Joseph Horne Company.

See Continuation Sheet

UNITED STATES DEPARTMENT OF THE INTERIOR  
NATIONAL PARK SERVICE

**NATIONAL REGISTER OF HISTORIC PLACES  
INVENTORY -- NOMINATION FORM**

FOR NPS USE ONLY

RECEIVED

DATE ENTERED

CONTINUATION SHEET

ITEM NUMBER 7 PAGE 2

*Wall Medallions - Imported Italian marble.  
Lighting - Through skylight (six 750 watt lights).*

*Adult Reading Room - 43' X 28'*

*Ceiling- - outstanding architectural feature. It is plaster, Renaissance in style, and colored under the direction of Miss Thorpe.*

*Floor - Travertine.*

*Walls - Stone made in Pittsburgh to conform with floor. Its porous quality absorbs sound and gives excellent acoustic properties. Plaster medallions with insets of Italian marble and an ornate frieze the only decoration.*

*Ventilated through gratings in ceiling and openings at floor.*

*Heated by concealed radiators in the side walls under the windows.*

*Reference Room (Now Periodical/Reading Room) 31' X 19'*

*Doorway - cast stone called Crètan, carved after it is cast - Norman Renaissance.*

*Floor - Rubber tile.*

*Junior Reading Room (Now District Library Center Office) 46' X 28'*

*Ceiling - plaster made to simulate beams and painted to represent gum wood by Joseph Horne Company.*

*Wall Medallions - Polychrome terra cotta copies of the famous Andrea della Robbia Bambini on porch or loggia of the Foundling Hospital in Florence, Italy.*

*Fountain - Polychrome terra cotta made by the Chicago firm where the medallions were made.*

*Plaster frieze above wrought iron screen exemplifies music, tragedy and comedy.*

*Mrs. Horne's portrait, by Alfred Hoen, a Dutch portrait painter who has brought to us the spirit of Mrs. Horne in his sympathetic treatment.*

*Doorway to Story Hour Room - Reproduction of a Florentine doorway to which was added the frieze of the children.*

*Story Hour Room (Now District Library Center Office) 20' X 16'*

*Medallions in leaded glass windows designed by Henry Hunt of Pittsburgh, one of the two or three outstanding church window designers in this country. Illustrate familiar nursery rhymes.*

*Fireplace - Norman architecture, built of Crètan, a cast stone.*

*Floor - Tile with insets of antique design.*

See Continuation Sheet

UNITED STATES DEPARTMENT OF THE INTERIOR  
NATIONAL PARK SERVICE

FOR NPS USE ONLY

RECEIVED

DATE ENTERED

**NATIONAL REGISTER OF HISTORIC PLACES  
INVENTORY -- NOMINATION FORM**

CONTINUATION SHEET

ITEM NUMBER 7 PAGE 2

*Lobby To Exhibition Room*

*Frieze - Vivid polychrome Doric decoration in primary colors, such as was used in Rome, furnishing sharp contrasts.*

*Walls - Glazed terra cotta. Niches in wall for statuary.*

*Floor - Terrazzo (marble chips laid in cement).*

*Doors - Gum wood. The only wood in the building except of course, the furniture, is in the doors. The doors for the entire building cost \$600.00.*

*Exhibition Room*

*Now used as the Children's Room.*

# 8 SIGNIFICANCE

## PERIOD

PREHISTORIC  
 1400-1499  
 1500-1599  
 1600-1699  
 1700-1799  
 1800-1899  
 1900-

ARCHEOLOGY-PREHISTORIC  
 ARCHEOLOGY-HISTORIC  
 AGRICULTURE  
 ARCHITECTURE  
 ART  
 COMMERCE  
 COMMUNICATIONS

## AREAS OF SIGNIFICANCE -- CHECK AND JUSTIFY BELOW

COMMUNITY PLANNING  
 CONSERVATION  
 ECONOMICS  
 EDUCATION  
 ENGINEERING  
 EXPLORATION/SETTLEMENT  
 INDUSTRY  
 INVENTION

LANDSCAPE ARCHITECTURE  
 LAW  
 LITERATURE  
 MILITARY  
 MUSIC  
 PHILOSOPHY  
 POLITICS/GOVERNMENT

RELIGION  
 SCIENCE  
 SCULPTURE  
 SOCIAL/HUMANITARIAN  
 THEATER  
 TRANSPORTATION  
 OTHER (SPECIFY)

SPECIFIC DATES 1927 - 29

BUILDER/ARCHITECT A. & S. Wilson Co. Pgh. Pa./  
Brandon Smith, R.A.

## STATEMENT OF SIGNIFICANCE

The B.F. Jones Memorial Library is remarkable not only for its architectural beauty, which adheres to the classic lines of the Renaissance while also reflecting a sufficiently modern treatment of freshness, but because it illustrates the thoroughness with which the building was planned before its erection.

Some of the outstanding items relating to the building's design and significance are the ornamental plaster ceilings of Renaissance style planned by Miss Norah Thorpe; medallions in leaded glass windows designed by Henry Hunt of Pittsburgh; special hand wrought iron screens with bronze medallions by Oscar Bach; and the statue of B.F. Jones done by the celebrated New York City sculptor Robert Aiken.

In addition to its architectural significance which reflects some of the best craftsmanship available in the United States at the time, the library serves as a fitting memorial for one of the industrial giants and cofounders of Jones & Laughlin Steel Corporation, Benjamin Franklin Jones, Sr. His contributions, along with those of his family and associates, are part of the history of steel making and the socio-economic impact which resulted from J&L's growth. His daughter, Mrs. Elisabeth McMasters (Jones) Horne, recognizing the importance of individual development, offered to erect a library more responsive to the needs of the public. Her generous gift to the community has probably had as much effect on the growth and development of the community as did the steel plant several blocks away.

The library's educational, recreational and social significance is as remarkable as its architectural Beauty. Its presence, which has witnessed periods of growth and decay, stands out as a milestone reflecting the struggles which occurred during the past fifty years.

SEE CONTINUATION SHEET

10 GEOGRAPHICAL DATA

ACREAGE OF NOMINATED PROPERTY .6

QUADRANGLE NAME

QUADRANGLE SCALE

UTM REFERENCES

A 1 7 5 63 3 00 4 4 95 90 0

B ZONE EASTING NORTHING

C ZONE EASTING NORTHING

D ZONE EASTING NORTHING

E ZONE EASTING NORTHING

F ZONE EASTING NORTHING

G ZONE EASTING NORTHING

H ZONE EASTING NORTHING

VERBAL BOUNDARY DESCRIPTION

SEE CONTINUATION SHEET

LIST ALL STATES AND COUNTIES FOR PROPERTIES OVERLAPPING STATE OR COUNTY BOUNDARIES

Table with columns: STATE, CODE, COUNTY, CODE. Two rows for listing overlapping boundaries.

11 FORM PREPARED BY

NAME / TITLE Frank E. Virostek

ORGANIZATION B.F. Jones Memorial Library

DATE

STREET & NUMBER 663 Franklin Avenue

TELEPHONE

CITY OR TOWN Aliquippa

STATE

Pennsylvania

12 STATE HISTORIC PRESERVATION OFFICER CERTIFICATION

THE EVALUATED SIGNIFICANCE OF THIS PROPERTY WITHIN THE STATE IS:

NATIONAL STATE LOCAL

As the designated State Historic Preservation Officer for the National Historic Preservation Act of 1966 (Public Law 89-665), I hereby nominate this property for inclusion in the National Register and certify that it has been evaluated according to the criteria and procedures set forth by the National Park Service.

STATE HISTORIC PRESERVATION OFFICER SIGNATURE

TITLE

DATE

FOR NPS USE ONLY

I HEREBY CERTIFY THAT THIS PROPERTY IS INCLUDED IN THE NATIONAL REGISTER

DATE

ATTEST: KEEPER OF THE NATIONAL REGISTER

DATE

CHIEF OF REGISTRATION

ORIGINAL FLOOR PLANS

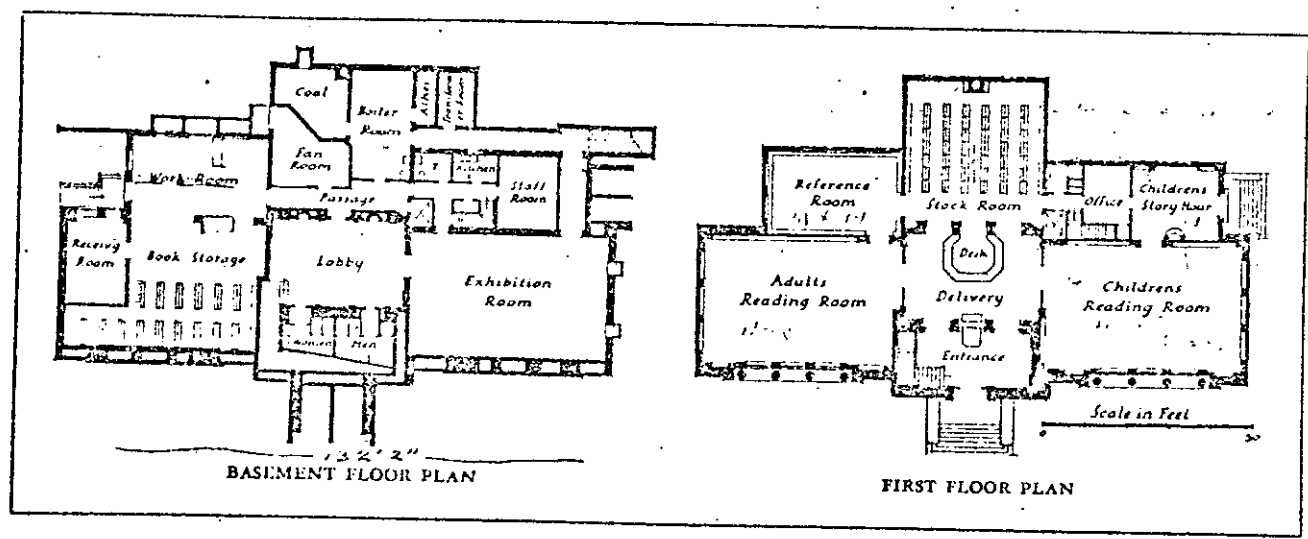

B. F. JONES MEMORIAL LIBRARY  
ALIQUIPPA, PENNSYLVANIA  
BRANDON SMITH, ARCHITECT

# ALIQUIPPA QUADRANGLE

PENNSYLVANIA

7.5 MINUTE SERIES (TOPOGRAPHIC)

SE/4 BEAVER 15' QUADRANGLE

4965 11 NW  
(BADENI)

4965 11 NE (BEAVER)      ROCHESTER 6.7 MI.      17°30' 560      561      1 300 000 FEET 562      563      80°15'      40°37'30"

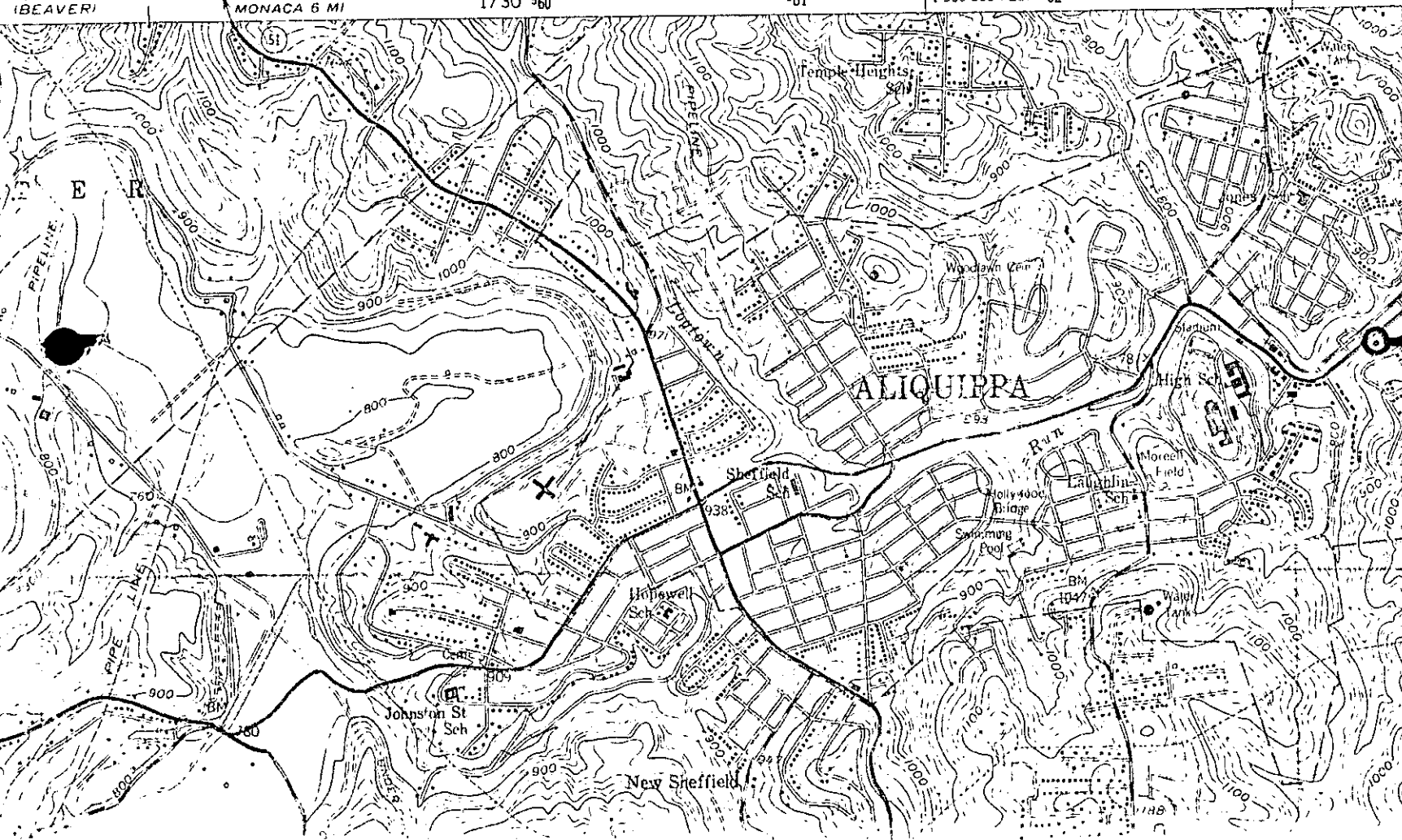

AMBRIDGE 3 MI.  
PITTSBURGH (GOLDEN TRIANGLE) 20 MI.

B.F. Jones Memorial Library  
Beaver County  
Zone 17 E563300 N4495900

170 000  
117