

NATIONAL REGISTER OF HISTORIC PLACES
INVENTORY - NOMINATION FORM

(Type all entries - complete applicable sections)

STATE: Pennsylvania	
COUNTY: Luzerne	
FOR NPS USE ONLY	
ENTRY NUMBER	DATE

1. NAME

COMMON:
Catlin (George) Hall

AND/OR HISTORIC:
Reynolds House

2. LOCATION

STREET AND NUMBER:
92 South River Street

CITY OR TOWN:
Wilkes-Barre

STATE Pennsylvania	CODE 42	COUNTY: Luzerne	CODE 079
-----------------------	------------	--------------------	-------------

3. CLASSIFICATION

CATEGORY (Check One)	OWNERSHIP	STATUS	ACCESSIBLE TO THE PUBLIC
<input type="checkbox"/> District <input type="checkbox"/> Site <input type="checkbox"/> Object <input checked="" type="checkbox"/> Building <input type="checkbox"/> Structure 	<input type="checkbox"/> Public <input checked="" type="checkbox"/> Private <input type="checkbox"/> Both 	<input checked="" type="checkbox"/> Occupied <input type="checkbox"/> Unoccupied <input type="checkbox"/> Preservation work in progress <input type="checkbox"/> In Process <input type="checkbox"/> Being Considered 	Yes: <input checked="" type="checkbox"/> Restricted <input type="checkbox"/> Unrestricted <input type="checkbox"/> No
PRESENT USE (Check One or More as Appropriate)			
<input type="checkbox"/> Agricultural <input type="checkbox"/> Commercial <input checked="" type="checkbox"/> Educational <input type="checkbox"/> Entertainment 	<input type="checkbox"/> Government <input type="checkbox"/> Industrial <input type="checkbox"/> Military <input type="checkbox"/> Museum 	<input type="checkbox"/> Park <input type="checkbox"/> Private Residence <input type="checkbox"/> Religious <input type="checkbox"/> Scientific 	<input type="checkbox"/> Transportation <input type="checkbox"/> Other (Specify) residence Hall, Wilkes College

4. OWNER OF PROPERTY

OWNER'S NAME:
Wilkes College

STREET AND NUMBER:

CITY OR TOWN: Wilkes Barre	STATE: Pennsylvania	CODE 42
-------------------------------	------------------------	------------

5. LOCATION OF LEGAL DESCRIPTION

COURTHOUSE, REGISTRY OF DEEDS, ETC.:
Luzerne County Courthouse

STREET AND NUMBER:
North River Street

CITY OR TOWN: Wilkes-Barre	STATE: Pennsylvania	CODE 42
-------------------------------	------------------------	------------

6. REPRESENTATION IN EXISTING SURVEYS

TITLE OF SURVEY:
Pennsylvania Register of Historic Sites and Landmarks

DATE OF SURVEY: 1970 Federal State County Local

DEPOSITORY FOR SURVEY RECORDS:
Pennsylvania Historical and Museum Commission

STREET AND NUMBER:
Box 1026

CITY OR TOWN: Harrisburg	STATE: Pennsylvania	CODE 42
-----------------------------	------------------------	------------

SEE INSTRUCTIONS

STATE:
Pennsylvania

COUNTY:
Luzerne

ENTRY NUMBER

DATE

FOR NPS USE ONLY

7. DESCRIPTION

CONDITION

(Check One)

Excellent Good Fair Deteriorated Ruins Unexposed

(Check One)

Altered Unaltered

(Check One)

Moved Original Site

DESCRIBE THE PRESENT AND ORIGINAL (if known) PHYSICAL APPEARANCE

A two and one-half story brick structure with a wide, but plain wooden cornice, Catlin Hall has five bays across, six over six sashes, and a recessed front entrance. The entrance porch has four supports; the outer two flush to the wall (pilasters) are plain and rectangular in shape, the two inner columns are tapered and fluted with a leaf design capital which, however is not Corinthian. The north side had a projection with two sets of French doors leading on to a terrace with a handsome cement railing. Two A-frame Victorian dormers are on the back side of the roof. A smaller two-story wing projects to the rear.

The interior of Catlin Hall features large but simple woodwork, a handsome stairway with some recent repairs, marble fireplace mantels, and a stairway open to the third floor. A pair of false walls give the indication that passways were closed some years ago, probably the result of renovations. The woodwork of what appears to be the untouched rooms is large but plain with large entablatures. On the exterior of the house there is an interesting drain pipe connection giving the initials and date on the front of the house.

According to the maintenance crew at Wilkes College this building is constructed very solidly. The exterior walls are about two feet thick with interior walls being about one foot thick, mostly brick. The chandeliers of the main lounge are sterling silver and the front door knob, which is now under lock, is silver.

SEE INSTRUCTIONS

5. SIGNIFICANCE

PERIOD (Check One or More as Appropriate)

- Pre-Columbian; 16th Century 18th Century 20th Century
 15th Century 17th Century 19th Century

SPECIFIC DATE(S) (If Applicable and Known) 1843

AREAS OF SIGNIFICANCE (Check One or More as Appropriate)

- | | | | |
|--|--------------------------------------|---|--|
| <input type="checkbox"/> Aboriginal | <input type="checkbox"/> Education | <input type="checkbox"/> Political | <input type="checkbox"/> Urban Planning |
| <input type="checkbox"/> Prehistoric | <input type="checkbox"/> Engineering | <input type="checkbox"/> Religion/Phi- | <input type="checkbox"/> Other (Specify) |
| <input type="checkbox"/> Historic | <input type="checkbox"/> Industry | losophy | _____ |
| <input type="checkbox"/> Agriculture | <input type="checkbox"/> Invention | <input type="checkbox"/> Science | _____ |
| <input checked="" type="checkbox"/> Architecture | <input type="checkbox"/> Landscape | <input type="checkbox"/> Sculpture | _____ |
| <input type="checkbox"/> Art | Architecture | <input type="checkbox"/> Social/Human- | _____ |
| <input type="checkbox"/> Commerce | <input type="checkbox"/> Literature | itarian | _____ |
| <input type="checkbox"/> Communications | <input type="checkbox"/> Military | <input type="checkbox"/> Theater | _____ |
| <input type="checkbox"/> Conservation | <input type="checkbox"/> Music | <input type="checkbox"/> Transportation | _____ |

STATEMENT OF SIGNIFICANCE

SEE INSTRUCTIONS

This house is a fine example of Greek Revival architecture of the first half of the nineteenth century. It was built in 1843 by William C. Reynolds and was in the Reynolds family until sold to Wilkes College to be used as a women's residence hall. It is one of the few examples of this style to be found in Luzerne County in good condition. The college made few structural changes when it was acquired. The building was named in honor of George Catlin, the painter, who came from Wilkes-Barre, by the college.

William C. Reynolds was a prominent citizen of Wilkes-Barre. The house is notable for it represents the home of a prosperous northeastern Pennsylvania family who lavished their wealth on their home. The structure has changed little since it was built with a few Victorian alterations to the rear. It was the home of the Reynolds family till the 1950s.

Addressed sheet

*sent to
N. R. 4/12/72*

NATIONAL REGISTER OF HISTORIC PLACES
INVENTORY - NOMINATION FORM

STATE	Pennsylvania	
COUNTY	Luzerne	
FOR NPS USE ONLY		
ENTRY NUMBER		DATE

(Continuation Sheet)

(Number all entries)

George Catlin Hall
Wilkes College
92 South River Street
Wilkes-Barre, Luzerne County, Pennsylvania

8. Significance

Catlin Hall was built in 1843 by Elizah Reynolds, a merchant. The bricks were brought from Philadelphia. About 1859 Judge William Champion Reynolds, Associate Judge of Luzerne County, purchased the house from his brother. Judge Reynolds served as representative from Luzerne County in the Pennsylvania Legislature in 1836 and 1837.

The house was acquired about 1874 by Edward Sheldon Reynolds from his father. Sheldon Reynolds was a lawyer and local historian. The Yale Alumni Society for Northeastern Pennsylvania was organized in this house under his leadership.

Sometime during the late nineteenth century, probably in the 1880s, the house was updated with Victorian features. The roof overhang was extended and the cornice was removed. The gables were decorated with ornate panels and the recessed entrance porch was enclosed with wooden doors. No major structural changes were made except for the addition of two A-frame dormers on the east side. When Colonel Dorrance Reynolds acquired the family home about 1905 he began renovation procedures restoring many of the original features. The wide cornice was replaced, the six panel front door was salvaged from the stable, and the roof overhang was narrowed. The Colonel added the metal doors on the porch, a bay window on the second floor of the south side, a terrane and French doors to the north side on the first floor, and a two story porch to the rear.

Wilkes College purchased the house in 1957 ending four generations of ownership by one family. Presently Catlin is used as a women's residence hall. By reusing an old building Wilkes is maintaining the flavor of the neighborhood as well as saving a piece of architecture from our past history.

George Catlin Hall honors the great American painter, George Catlin, who was born in Wilkes-Barre.

9. MAJOR BIBLIOGRAPHICAL REFERENCES

Wyoming Historical and Geological Society, Wilkes-Barre, Pa. files
 Sturdevant, W.H. Atlas of the City of Wilkes-Barre, Pa. Philadelphia: J.L. Smith, 1894.
 Harvey, Oscar & Ernest Smith. A History of Wilkes-Barre, 1930.

10. GEOGRAPHICAL DATA

LATITUDE AND LONGITUDE COORDINATES DEFINING A RECTANGLE LOCATING THE PROPERTY			LATITUDE AND LONGITUDE COORDINATES DEFINING THE CENTER POINT OF A PROPERTY OF LESS THAN TEN ACRES		
CORNER	LATITUDE	LONGITUDE	LATITUDE		LONGITUDE
	Degrees Minutes Seconds	Degrees Minutes Seconds	Degrees	Minutes Seconds	Degrees Minutes Seconds
NW	0 0 0	0 0 0	41°	14' 50"	75° 53' 12"
NE	0 0 0	0 0 0			
SE	0 0 0	0 0 0			
SW	0 0 0	0 0 0			

APPROXIMATE ACREAGE OF NOMINATED PROPERTY: Less than one acre

LIST ALL STATES AND COUNTIES FOR PROPERTIES OVERLAPPING STATE OR COUNTY BOUNDARIES

STATE:	CODE	COUNTY:	CODE

SEE INSTRUCTIONS

11. FORM PREPARED BY

NAME AND TITLE:
Pennsylvania Register of Historic Sites and Landmarks
 ORGANIZATION: Pennsylvania Historical and Museum Commission DATE: August, 1971
 STREET AND NUMBER:
Box 1026
 CITY OR TOWN: Harrisburg STATE: Pennsylvania CODE: 42

12. STATE LIAISON OFFICER CERTIFICATION

<p>As the designated State Liaison Officer for the National Historic Preservation Act of 1966 (Public Law 89-665), I hereby nominate this property for inclusion in the National Register and certify that it has been evaluated according to the criteria and procedures set forth by the National Park Service. The recommended level of significance of this nomination is:</p> <p>National <input type="checkbox"/> State <input checked="" type="checkbox"/> Local <input type="checkbox"/></p> <p>Name <u>S. K. Steiner</u> State Liaison Officer</p> <p>Title <u>Executive Director, Pennsylvania Historical and Museum Commission</u></p> <p>Date <u>August 30, 1971</u></p>	<p style="text-align: center;">NATIONAL REGISTER VERIFICATION</p> <p>I hereby certify that this property is included in the National Register.</p> <p style="text-align: center;">_____ Chief, Office of Archeology and Historic Preservation</p> <p>Date _____</p> <p>ATTEST:</p> <p style="text-align: center;">_____ Keeper of The National Register</p> <p>Date _____</p>
---	---

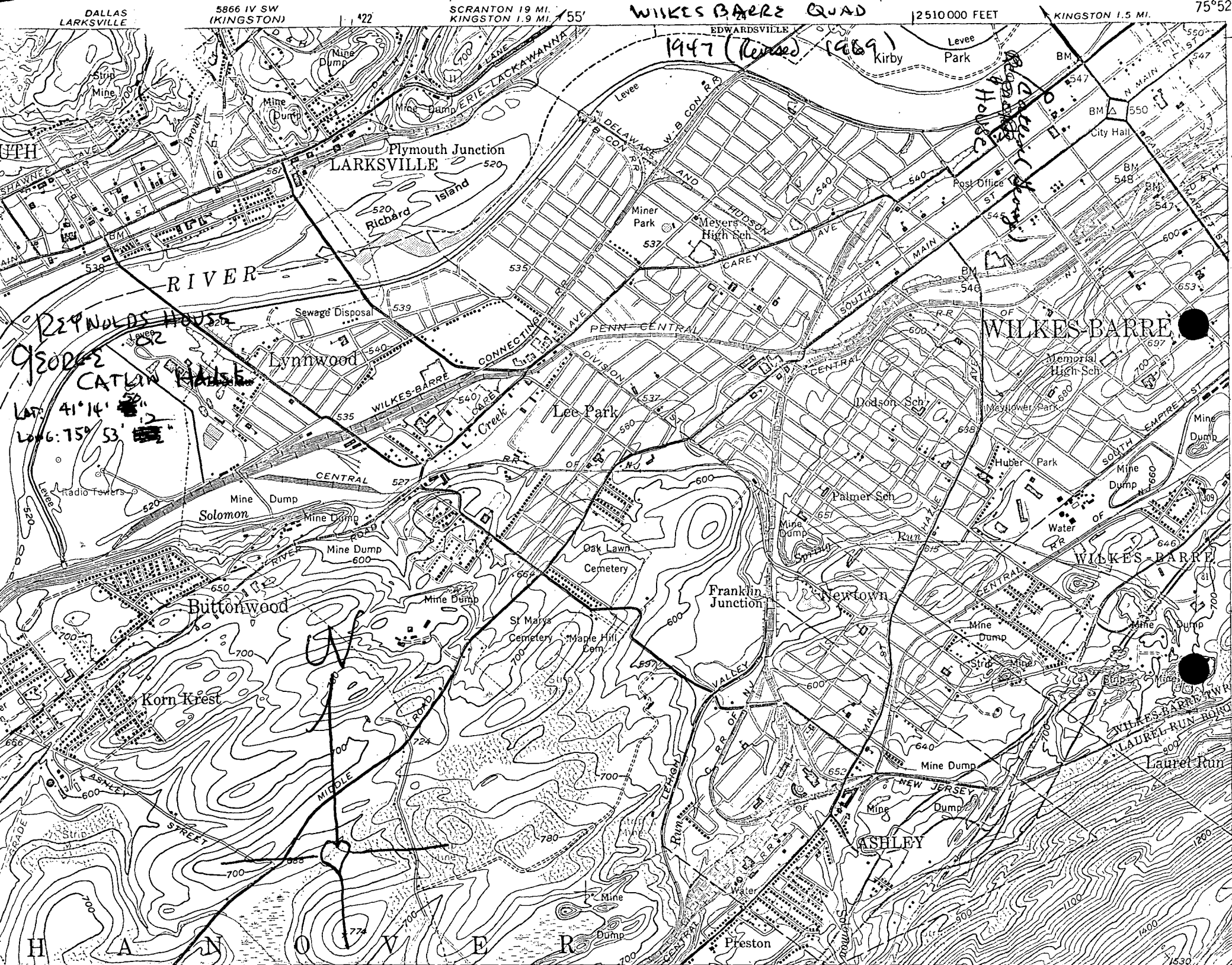

REYNOLDS HOUSE
GEORGE CATLIN HOUSE

LAT: 41° 14' 12"
LONG: 75° 53' 12"

1947 (Revised) 1989

Kirby
Levee Park

H A N O V E R

1530

Wilkes-Barre, West, Pa.

NW 1/4 Wilkes-Barre 15' Quadrangle

N 4107.5 - W 7552.5 / 715

1947

Photorevised 1969

AMS 5866 III NW - Series V831