

UNITED STATES DEPARTMENT OF THE INTERIOR
 NATIONAL PARK SERVICE

25

**NATIONAL REGISTER OF HISTORIC PLACES
 INVENTORY -- NOMINATION FORM**

FOR NPS USE ONLY

RECEIVED

DATE ENTERED

 SEE INSTRUCTIONS IN *HOW TO COMPLETE NATIONAL REGISTER FORMS*
 TYPE ALL ENTRIES -- COMPLETE APPLICABLE SECTIONS
1 NAME

HISTORIC

ALLGATES

AND/OR COMMON

2 LOCATION

STREET & NUMBER

West side of Coopertown Road, .3 mile north of Darby & Coopertown Rds.

CITY, TOWN

Haverford

VICINITY OF

STATE

Pennsylvania

CODE
42

COUNTY

Delaware

CODE

045

3 CLASSIFICATION

CATEGORY	OWNERSHIP	STATUS	PRESENT USE	
<input type="checkbox"/> DISTRICT	<input checked="" type="checkbox"/> PUBLIC	<input checked="" type="checkbox"/> OCCUPIED	<input type="checkbox"/> AGRICULTURE	<input type="checkbox"/> MUSEUM
<input checked="" type="checkbox"/> BUILDING(S)	<input type="checkbox"/> PRIVATE	<input type="checkbox"/> UNOCCUPIED	<input type="checkbox"/> COMMERCIAL	<input type="checkbox"/> PARK
<input type="checkbox"/> STRUCTURE	<input type="checkbox"/> BOTH	<input type="checkbox"/> WORK IN PROGRESS	<input checked="" type="checkbox"/> EDUCATIONAL	<input type="checkbox"/> PRIVATE RESIDENCE
<input type="checkbox"/> SITE	<input type="checkbox"/> PUBLIC ACQUISITION	<input type="checkbox"/> ACCESSIBLE	<input type="checkbox"/> ENTERTAINMENT	<input type="checkbox"/> RELIGIOUS
<input type="checkbox"/> OBJECT	<input type="checkbox"/> IN PROCESS	<input checked="" type="checkbox"/> YES: RESTRICTED	<input type="checkbox"/> GOVERNMENT	<input type="checkbox"/> SCIENTIFIC
	<input type="checkbox"/> BEING CONSIDERED	<input type="checkbox"/> YES: UNRESTRICTED	<input type="checkbox"/> INDUSTRIAL	<input type="checkbox"/> TRANSPORTATION
		<input type="checkbox"/> NO	<input type="checkbox"/> MILITARY	<input type="checkbox"/> OTHER:

4 OWNER OF PROPERTY

NAME

Haverford Township School District

STREET & NUMBER

1801 Darby Road

CITY, TOWN

Havertown

VICINITY OF

STATE

Pennsylvania 19083

5 LOCATION OF LEGAL DESCRIPTIONCOURTHOUSE,
REGISTRY OF DEEDS, ETC.

Delaware County Courthouse

STREET & NUMBER

Front & South Avenue

CITY, TOWN

Media

STATE

Pennsylvania

6 REPRESENTATION IN EXISTING SURVEYS

TITLE

Pennsylvania Inventory of Historic Places

DATE

8/1/77

 FEDERAL STATE COUNTY LOCALDEPOSITORY FOR
SURVEY RECORDS

Pennsylvania Historical & Museum Commission

CITY, TOWN

Harrisburg

STATE

Pennsylvania

7 DESCRIPTION

CONDITION

—EXCELLENT

GOOD

—FAIR

—DETERIORATED

—RUINS

—UNEXPOSED

CHECK ONE

—UNALTERED

ALTERED

CHECK ONE

ORIGINAL SITE

—MOVED DATE _____

DESCRIBE THE PRESENT AND ORIGINAL (IF KNOWN) PHYSICAL APPEARANCE

The Allgates estate comprises an area of 26.6 acres and is bounded by Darby and Coopertown Roads. This large estate encompasses nineteen structures as well as formal gardens. The use of natural building materials give Allgates a rustic and parklike atmosphere.

Building Inventory

1. Mansion House

This large structure is constructed of New Jersey sandstone and was completed in 1912. Its irregular plan varies in height from one to three stories with numerous gable roofs. The main entrance is through a triple-arched portico. Windows are of various sizes and locations, both single and in pairs. The main house was designed by Wilson Eyre. A circular drive and lily pond is located at the front of the house. Significant interior features include oak paneling and hand carved fireplaces with hearths of Mercer Tiles. The main house is approximately 200 feet by 70 feet.

2. Garage c. 1922

Garage - 2 car. Stone and stucco Length - 21'4" Width 21' 4"
Main elevation - East. Two garage doors, seperated by pillar.
Volumns on all corners 1'7" square, extending above roof line and capped with slate/Slate cove around roof.
North Wall - east end - doublbe hung window - 6 over 6. Garden wall same height as garage, attached at middle of wall.
West Wall - no openings.
South Wall - two 3 over 3 windows.
This garage was built when H. Gates Lloyd Jr. was in college and driving.

3. Mrs. Lloyd's Tool House - c. 1920

Tool House - Stone and stucco building with slate hip roof.
Principal elevation - (south) Width 11'9" Length 12'
South Wall - arched solid door height 8'6" width 4'
East Wall - 1 window - stationary half circle - 8 panes - above casement windows 2 over 2. Stone sill - Height 5'3" Width 4'4"
Stone keystone above window.
North & West Walls - recessed arces - Height 6' Width 4'8" deep.
Flight of 6 shallow stone steps to upper terrace on North Wall

UNITED STATES DEPARTMENT OF THE INTERIOR
NATIONAL PARK SERVICE

FOR NPS USE ONLY

RECEIVED

DATE ENTERED

**NATIONAL REGISTER OF HISTORIC PLACES
INVENTORY -- NOMINATION FORM**

ALLGATES, Delaware County

CONTINUATION SHEET

ITEM NUMBER 7

PAGE 2

4. Tennis Court Gazebo c. 1920

Stone and stucco with slate hip roof. Length 11'12" Width 11' 7"
Two story structure built on side of terrace. Lower level -
South facade- stone - solid arched door, 4' x 8'6" centered in
wall - opening into storage area for garden or court roller, tools,
tennis nets etc. Cement floor.
Flagstone steps on East side to upper level.
Entrance on North. Stucco columns 2 feet. Square on each corner -
Stone wall 2' high - 18" wide, topped with slate. Oak square posts,
3'6" in from columns, with open arch at top, on three sides.

5. Iris Bowl Gazebo

Octagonal Stone structure with slate roof, copper cap and flying
goose wood weather vane.
Diameter - 13". Entrance on the East. Walls 2' 2" high, 18" wide.
Supporting 8 oak posts. Slate floor. Stone steps on left to
lower terrace

6. Bath House

One story rectangular stone and stucco structure. Length 42' Width 20'
Principal elevation - North - Slate hip roof broken by a triangular
pediment over a triple archway, giving access to a central porch.
On either side narrow arched windows centered in 10' high, 3'9" wide
arched recesses, with stone keystone exposed and a wide stone sill.
East and West Wall - Arched double casement windows, 6 panes each.
South Wall - single archway into porch - 7' wide with pediment above.
2 arched windows on either side - those adjacent to porch - top
section louvered (for lavatory) 4 panes glass below - other windows
6 pane.

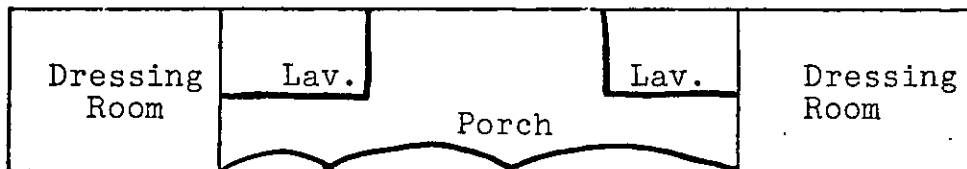

Floor Plan

UNITED STATES DEPARTMENT OF THE INTERIOR
NATIONAL PARK SERVICE

FOR NPS USE ONLY

RECEIVED

DATE ENTERED

**NATIONAL REGISTER OF HISTORIC PLACES
INVENTORY -- NOMINATION FORM**

ALLGATES, Delaware County

CONTINUATION SHEET

ITEM NUMBER 7 PAGE 3

7. Pump House

A one story rubble stone structure with jerkin - head and hipped roofs. A central round arch opening enters from the north. Its shingle roof as well as stone walls give this structure a rugged appearance.

8. Greenhouse

Greenhouse - workshop area - stone and stucco $1\frac{1}{2}$ story building with slate pitch roof. Principal elevation - 3 bay - center door with pitch roof slate hood and plain brackets, flanked by triple casement windows. Small circular window above door (north)
West wall - 2 bay - casement windows.
East wall - 2 bay casement windows. Exterior cellar door.
Length 30' Width 18'
Basement, with exterior door. Chimney-square-stucco-just below ridge southeast corner of roof. Curved brick chimney cap.
Greenhouse proper - one door from work area. 2 doors in south end.
Length 75' Width 20'

Numbers 9, 10, 11, 12 Complex of Buildings

This complex was designed by Wilson Eyre. This is roughly an "L" shaped complex of buildings, added to an old farmhouse, circa 1820. The buildings are unified by a slate roof and similar architectural features. Additions - 1910.

9. Stable - Garage

Originally housed 3 automobiles, with a pit so the chauffer could make repairs, on the north side. Stalls for 4 horses, and apace for carriages and a sleigh on the other end. (H. Gates Lloyd Sr. never thought the automobile would replace horses entirely.)

Stone and stucco 2 story building with pitched roof - slate - ridge running north and south. Length 82' Width 29'5" (garage area 32', Stable 50')

Principal elevation - (east) Double cross gables - north gable double hung window, 6 over 6. South gable extended to shelter hoisting beam - arched doors into hay loft with 6 panes of glass in

UNITED STATES DEPARTMENT OF THE INTERIOR
NATIONAL PARK SERVICE

FOR NPS USE ONLY

RECEIVED

DATE ENTERED

**NATIONAL REGISTER OF HISTORIC PLACES
INVENTORY -- NOMINATION FORM**

ALLGATES, Delaware County

CONTINUATION SHEET

ITEM NUMBER 7 PAGE 4

top half of each door. Hair of sliding stable doors under each gable, and beyond them on north end 3 pairs arched doors - hinged - for garage.

North Wall - 2 windows, double hung, 6 over 6. Solid arched double door in gable to second floor hay loft, with hoisting beam above.

West Wall - bisected by wing - on the north end, first floor - 3 triple windows. South side of the wing, 3 triple windows on first floor, single windows. South side of the wing, 3 triple windows on first floor, single windows. South side of the wing, 3 triple windows on first floor, single slate dormer with double hung 6 over 6 windows. Stucco chimney with curved Brick cap.

Presently the garage will hold seven cars, with additional storage space. Above the garage there is now an apartment with large living room, bedroom, study, kitchen and bath. Access to the apartment - outside entrance and stairway at south end between garages and tenant house #10. These extend 3' beyond adjacent house.

10. 3265 Darby Road

Stone and stucco 2½ story residence with pitched roof - slate - ridge running north and south Length 36' Width 22'

Principal elevation (east) kitchen door on right-window 8 over 8 then main entrance, with pitched roof slate hood similar to greenhouse and Tenant house #13 - window to left of door. 6 over 6

Second floor - 3 windows. All windows double hung 6 over 6

South Wall - exterior stone chimney, flanked by windows on first and second floor.

West Wall - first floor from north end - double window and door onto porch.

Second Floor from north end - double window, 2 single windows. All windows double hung, 6 over 6

First floor - Entrance hall, living room with fireplace, dining room, kitchen, laundry, screened porch.

Second floor - 3 bedrooms, 1 bath.

Third floor - closed stairway to floored attic. Basement.

UNITED STATES DEPARTMENT OF THE INTERIOR
NATIONAL PARK SERVICE

FOR NPS USE ONLY

RECEIVED

DATE ENTERED

**NATIONAL REGISTER OF HISTORIC PLACES
INVENTORY -- NOMINATION FORM**

ALLGATES, Delaware County

CONTINUATION SHEET

ITEM NUMBER 7 PAGE 5

11. 3269 Darby Road

Stone and stucco 2½ story residence with slate pitch roof, ridge running E - W. Length 38' Width 20'
Principal elevation (N) from eastside - first floor - double window, door with cantilevered slate hood, small window, another door. Second floor - 2 windows, 4 over 4.
East side - connected to stable. Westside - connected by small addition to original farmhouse.
South elevation - first floor - door and 2 windows - enclosed porch and open porch.
Second floor - 3 windows. All 4 over 4
Stucco chimney straddling the ridge at both ends of this section.

First floor - center hall, living room, dining room, kitchen, pantry
Second floor - 3 bedrooms, 1 bath
Third floor - attic storage
Basement

12. 3267 Darby Road - circa 1850

Stone 3 story residence with stucco el addition. Slate pitch roof, ridge running N-S Length 35' Width - original stone section 20'
Principal elevation - (W) Center door, windows on either side - double hung, 2 over 2. Open porch with cement floor, Plain square pillars and brackets. Porch the length of the house, grade level.
Second floor - 5 windows.
Third floor - double dormer window S of center
Interior chimney on N end is stucco above roof line and straddles the ridge. 2 windows in third floor gable.
South - first floor - double windows 4 over 2
Third floor - small double window 4 panes each.
East side - small window on first and second floor, on S end.
1 window on East side, N end
The el addition is 3 story, but steps back on the N end to a short 2½ story section, when it affjoins #11.

First floor N side - small shed in angle with old building, protecting back door. 1 window to left of shed, 1 window on seconf floor above it, 1 window on third floor.

UNITED STATES DEPARTMENT OF THE INTERIOR
NATIONAL PARK SERVICE

FOR NPS USE ONLY

RECEIVED

DATE ENTERED

**NATIONAL REGISTER OF HISTORIC PLACES
INVENTORY -- NOMINATION FORM**

ALLGATES, Delaware County

CONTINUATION SHEET

ITEM NUMBER 7 PAGE 6

Extension steps back - 1 window on E side third floor.
Section at right angle - 1 window first floor, 1 on second.
South side of this addition - 1 door, 1 window on first floor,
2 windows on second floor.

First floor - center hall, living room with fireplace, dining room,
kitchen, lavatory
Second floor - 3 bedrooms, 1 bath - bedroom above livingroom has
fireplace.
Third floor - 1 bedroom, 1 bath
Basement.

13. Tenant House - 3301 Darby Road

Circa 1922. Stone and stucco 2 story dwelling with pitch roof, slate
Length 30' Width 38' overall Short el with slate roof

Principal elevation (S) Center door with simple pitch roof (slate)
hood and plain brackets. Window on either side, 8 over 8. Second
floor - two windows above those below 6 over 6.

West wall - exterior stone chimney flanked by windows 6 over 6 on
on first and second floor.

North wall - short el on E end with 2 windows on second floor, 4
over 4; 1 window on first floor, 8 over 8. Screened porch on
NW end extends beyond el 1 window on second floor 6 over 6
door to porch.

East - Gable end. 1 window on first floor, 6 over 6, above cellar
doors. 2 windows on second floor, 6 over 6 with ventlator slit in
attic. 1 window in E wall of el 4 over 4.
Small 1 story shed, stucco with slate roof, on S end of East wall.
Door on S side, parallel with main entrance. 1 window E wall 6 over 6

All windows double hung. Panelled shutters on first floor, louvered
shutters on second.

Floor plan - Center hall - living room with fireplace west side -
Dining room, kitchen, mud room, screened porch

UNITED STATES DEPARTMENT OF THE INTERIOR
NATIONAL PARK SERVICE

FOR NPS USE ONLY

RECEIVED

DATE ENTERED

**NATIONAL REGISTER OF HISTORIC PLACES
INVENTORY -- NOMINATION FORM**

ALLGATES, Delaware County

CONTINUATION SHEET

ITEM NUMBER 7 PAGE 7

Second floor - 3 bedrooms and bath
Floored attic storage
Full basement - outside exit.

14. Stable

Stable - Main elevation - S. Stone and stucco building with slate roof. Length 58'5" Width 23'5"
Stall section - west end 4 bay - stable doors 7'5" x 3'9" - solid 4 pane window to right of each. 4" roof extension.
Cross gable centered over this section with arched door, 6 panes glasto hay loft. Hoisting beam above. Octagonal ventilator cupola.

West end - 6 foot set back for tack room - with covered porch 6" x 13"

First floor - door on right - 6 panes glass. 1 double hung 6 over 6 window on left.

Second floor - dormer - 1 window - double hung 6 over 6

West wall - gable end - first floor - 2 double hung 6 over 6 windows 1 small casement window 4 panes (in lavatory)
Second floor - 1 window 6 over 6

North wall - west end - first floor - 1 window 6 over 6
Second floor - dormer window 6 over 6

Stucco interior chimney with curved brick cap below roof ridge on North side, west end.

North wall stall section - set back. Three 6 paned windows 3 over 3

East wall-first floor-louvered door on right 4 paned window on left.
Second floor - Arched single door in gable hoisting beam above.

15. Frog Tavern

Griffith Evans applied for a Tavern license in 1731. The Frog Tavern is a rectangular fieldstone and stucco 2½ story residence, length 28' width 21' with mid-20th century one story clapboard addition on east side. Length 15', width 21'

UNITED STATES DEPARTMENT OF THE INTERIOR
NATIONAL PARK SERVICE

FOR NPS USE ONLY

RECEIVED

DATE ENTERED

**NATIONAL REGISTER OF HISTORIC PLACES
INVENTORY -- NOMINATION FORM**

ALLGATES, Delaware County

CONTINUATION SHEET

ITEM NUMBER 7 PAGE 8

North elevation - front of house - 3 bay - center door flanked by windows 6 over 6
Second floor - 3 windows 6 over 6. Small porch-later addition, extending to inner edge of windows hip roof, asphalt shingles, supported by two plain corner columns. Length 12' Width 10'8"
West wall - Gable end 2 bay 2 windows in gable, outside cellar door on NW end, cellar window.
South wall - 2 bay
East - clapboard addition, hip roof. Door in east side 1 full size window in north wall, small window in south.
Pitch roof - asphalt shingles.
Windows double hung 6 panes in each sash. Panelled shutters on the first floor, north and west walls, louvered shutters on remainder of windows
Chimneys confined within wall on both gable ends-stone above roof line.
Chimney on E end quite large approx. 2'4' serves large basement fireplace.

First floor of house - livingroom with fireplace, diningroom, kitchen, pantry.
Second floor - 3 bedrooms, bath
Third floor attic through trap door
Basement - large fireplace on East end.

16. Brooder Shed

Main elevation - S 20'2" long, 12' 4" wide - cement with asphalt shingle shed roof.
Panel of 5 windows on east end of South wall.
Door - 4 panes - East wall
Door - 2 windows West Wall
North wall - no openings

17. Stable circa 1920

Two story stone and stucco stable with slate gable roof.
Main elevation - S. Length 59'8" Width 11' plus 9' roof overhang

UNITED STATES DEPARTMENT OF THE INTERIOR
NATIONAL PARK SERVICE

FOR NPS USE ONLY

RECEIVED

DATE ENTERED

**NATIONAL REGISTER OF HISTORIC PLACES
INVENTORY -- NOMINATION FORM**

ALLGATES, Delaware County

CONTINUATION SHEET

ITEM NUMBER 7 PAGE 9

4 bay, stalls with top half of door 3 over 3 panes of glass. Window to left of each door - 4 panes. East end - door to tack room - window in top half 3 over 3.

Belgian block extends width of overhang.

Cross gable in center of roof with door to hay loft - window in top half of door - 4 panes. Hoisting beam missing. Square ventilator straddling the ridge above cross gable.

East and West walls - two 4 pane windows.
North wall - 4 windows.

18. Sheep barn circa 1920

Sheep Barn - stone foundations, cinder block and stucco - slate roof. 2 story, 4 bay. Main elevation - East
Length - 38' width 22'7"
Lower half of doors hinged - top half hinged at top to swing in.
North wall - first floor - 2 stationary windows - 12 pane - 4 over 4.
Second floor - door to hayloft - hoisting beam at top of gable.

South wall - first floor - 2 stationery windows - 12 pane - 4 over 4
Second floor - door and hoisting beam above.

West Wall - North and south walls have cinder block extensions 13'6" long, with double windows, ten panes, 2 over 2 in each. There had been a shed roof, which is almost all gone - rafters still in place and four supporting beams. This structure is dirt floored and was open to the west.
2 windows, 6 over 6, in west wall.

19. Federal School

A one story rubble structure with gable roof, interior end chimney, and a gable-end datestone. Served as a school from 1797-1872 and is the oldest school in Haverford Township. Listed on National Register of Historic Places.

8 SIGNIFICANCE

PERIOD	AREAS OF SIGNIFICANCE -- CHECK AND JUSTIFY BELOW					
<input type="checkbox"/> PREHISTORIC	<input type="checkbox"/> ARCHEOLOGY-PREHISTORIC	<input type="checkbox"/> COMMUNITY PLANNING	<input checked="" type="checkbox"/> LANDSCAPE ARCHITECTURE	<input type="checkbox"/> RELIGION		
1400-1499	<input type="checkbox"/> ARCHEOLOGY-HISTORIC	<input type="checkbox"/> CONSERVATION	<input type="checkbox"/> LAW	<input type="checkbox"/> SCIENCE		
1500-1599	<input type="checkbox"/> AGRICULTURE	<input type="checkbox"/> ECONOMICS	<input type="checkbox"/> LITERATURE	<input type="checkbox"/> SCULPTURE		
1600-1699	<input checked="" type="checkbox"/> ARCHITECTURE	<input checked="" type="checkbox"/> EDUCATION	<input type="checkbox"/> MILITARY	<input type="checkbox"/> SOCIAL/HUMANITARIAN		
<input checked="" type="checkbox"/> 1700-1799	<input type="checkbox"/> ART	<input type="checkbox"/> ENGINEERING	<input type="checkbox"/> MUSIC	<input type="checkbox"/> THEATER		
<input checked="" type="checkbox"/> 1800-1899	<input checked="" type="checkbox"/> COMMERCE	<input type="checkbox"/> EXPLORATION/SETTLEMENT	<input type="checkbox"/> PHILOSOPHY	<input type="checkbox"/> TRANSPORTATION		
<input checked="" type="checkbox"/> 1900-	<input type="checkbox"/> COMMUNICATIONS	<input type="checkbox"/> INDUSTRY	<input type="checkbox"/> POLITICS/GOVERNMENT	<input type="checkbox"/> OTHER (SPECIFY)		
		<input type="checkbox"/> INVENTION				

SPECIFIC DATES 1731, 1797, 1850, 1912, c. 1920 BUILDER/ARCHITECT Wilson Eyre

STATEMENT OF SIGNIFICANCE

The Allgates complex is a fine example of early twentieth century estate. Incorporated in this complex is a school, the Federal School. This is the earliest remaining school in Haverford Township and was operated as a school from 1797 to 1872. Also on the estate is an early tavern, The Frog Tavern, c. 1731. An early farmhouse, c. 1850 is also an earlier structure incorporated into Allgates. However the majority of structures of Allgates date from 1912 to 1922. The mansion house and building complex were designed by Wilson Eyre, a noted Philadelphia architect. Allgates is his only surviving work in Haverford Township. Allgates, through its composition of natural materials and asymmetrical facade typifies a Eyre design.

The gardens of Allgates are extremely formal.

The gardens are extremely formal. Horace W. Sellers was their principal designer. Since Mrs. Lloyd, wife of the original owner and builder, was extremely knowledgeable in the field of horticulture, the gardens were probably some of the best in the country. Indeed, it has been said that the gardens at Allgates were Mrs. Lloyd's, "brief for immortality," Mrs. Lloyd's garden club, "The Gardners," was one of the founding clubs of the Garden Club of America. In 1920 and again from 1925-31, Mrs. Lloyd was director of the GCA. She was also very active in the Pennsylvania Horticultural Society, entering many shows and serving on the library committee. Mrs. Lloyd's private library at Allgates included many books on horticulture from the 15th, 16th and 17th centuries. Mrs. Lloyd was so knowledgeable about horticulture that in the Bulletin of the Garden Club of America, issued in her memory, it is stated, "in recognition of her outstanding knowledge, The Gardners have renamed their horticultural committee The Mary Helen Windgate Lloyd Horticultural Committee with the citation: "to bring to our members such information as it was her pleasure to give us, and help to keep alive the inspiration we received from her."

Mr. Lloyd was very active in the field of Finance. He was president of the Commercial Trust Co, Philadelphia, in 1910. Later, he became a partner in both Drexel and Co. and J. P. Morgan and Co. Being a partner of such financial institutions, Mr. Lloyd was a director of many companies.

UNITED STATES DEPARTMENT OF THE INTERIOR
NATIONAL PARK SERVICE

FOR NPS USE ONLY

RECEIVED

DATE ENTERED

**NATIONAL REGISTER OF HISTORIC PLACES
INVENTORY -- NOMINATION FORM**

ALLGATES, Delaware County

CONTINUATION SHEET

ITEM NUMBER 8

PAGE 2

Some of which included the Philadelphia Electric Co., Bell Telephone Co, and General Asphalt Co. In addition, Mr. Lloyd devoted much of his time to the public sphere serving as president of the Haverford Township Board of Commissioners from 1912-1922 and in World War I as chairman of the War Chest Campaign Committee. During the Depression, Mr. Lloyd was chairman of the Committee for Unemployment Relief, later the Bureau of Unemployment Relief of the Department of Public Welfare in Philadelphia.

The Allgates property with its fine collection stone and stucco buildings and formal gardens represents a period of estate building with flourished in the early 1900's. Wilson Eyre, architect for Allgates, was noted for his fine domestic architecture. He designed many private estates in the suburbs of Philadelphia, in Maryland, Michigan, New York, Maine and Rhode Island and Allgates is a representative example of Eyre's domestic work.

19 MAJOR BIBLIOGRAPHICAL REFERENCES

(See Continuation Sheet)

10 GEOGRAPHICAL DATA

ACREAGE OF NOMINATED PROPERTY 26.6

QUADRANGLE NAME Norristown & Lansdowne

QUADRANGLE SCALE 1:24000

UTM REFERENCES

A 18 472160 4427640

B 18 472180 4427600

C 18 472300 4427200

D 18 472300 4427120

E 18 471860 4427440

F 18 471980 4427600

G

H

VERBAL BOUNDARY DESCRIPTION

LIST ALL STATES AND COUNTIES FOR PROPERTIES OVERLAPPING STATE OR COUNTY BOUNDARIES

STATE	CODE	COUNTY	CODE
-------	------	--------	------

STATE	CODE	COUNTY	CODE
-------	------	--------	------

11 FORM PREPARED BY

NAME / TITLE

Howard Greenberg / Margaret E. Johnson

ORGANIZATION

/ Haverford Township Historical Society

DATE

STREET & NUMBER

1730 Hawthorne Avenue / 805 Lawson Avenue

TELEPHONE

215-446-6550/215-446-1026

CITY OR TOWN

Havertown

STATE

Pennsylvania

12 STATE HISTORIC PRESERVATION OFFICER CERTIFICATION

THE EVALUATED SIGNIFICANCE OF THIS PROPERTY WITHIN THE STATE IS:

NATIONAL

STATE

LOCAL

As the designated State Historic Preservation Officer for the National Historic Preservation Act of 1966 (Public Law 89-665), I hereby nominate this property for inclusion in the National Register and certify that it has been evaluated according to the criteria and procedures set forth by the National Park Service.

STATE HISTORIC PRESERVATION OFFICER SIGNATURE

TITLE

ED WEINTRAUB, Director
Office of Historic Preservation

DATE

FOR NPS USE ONLY

I HEREBY CERTIFY THAT THIS PROPERTY IS INCLUDED IN THE NATIONAL REGISTER

DATE

ATTEST:

KEEPER OF THE NATIONAL REGISTER

DATE

CHIEF OF REGISTRATION

MAJOR BIBLIOGRAPHICAL REFERENCES

(See Continuation Sheet)

10 GEOGRAPHICAL DATA

ACREAGE OF NOMINATED PROPERTY 26.6

QUADRANGLE NAME Norristown & Lansdowne QUADRANGLE SCALE 1:24000

UTM REFERENCES

A	1,8	47,216,0	44,276,4,0	B	1,8	47,218,0	44,276,0,0
	ZONE	EASTING	NORTHING		ZONE	EASTING	NORTHING
C	1,8	47,230,0	44,272,0,0	D	1,8	47,230,0	44,271,2,0
E	1,8	47,18,6,0	44,274,4,0	F	1,8	47,19,8,0	44,276,0,0
G				H			

VERBAL BOUNDARY DESCRIPTION

LIST ALL STATES AND COUNTIES FOR PROPERTIES OVERLAPPING STATE OR COUNTY BOUNDARIES

STATE	CODE	COUNTY	CODE
STATE	CODE	COUNTY	CODE

11 FORM PREPARED BY

NAME / TITLE
Howard Greenberg / Margaret E. Johnson

ORGANIZATION / Haverford Township Historical Society DATE _____

STREET & NUMBER / 1730 Hawthorne Avenue / 805 Lawson Avenue TELEPHONE 215-446-6550/215-446-1026

CITY OR TOWN / Havertown STATE Pennsylvania

12 STATE HISTORIC PRESERVATION OFFICER CERTIFICATION

THE EVALUATED SIGNIFICANCE OF THIS PROPERTY WITHIN THE STATE IS:

NATIONAL _____ STATE _____ LOCAL XX

As the designated State Historic Preservation Officer for the National Historic Preservation Act of 1966 (Public Law 89-665), I hereby nominate this property for inclusion in the National Register and certify that it has been evaluated according to the criteria and procedures set forth by the National Park Service.

STATE HISTORIC PRESERVATION OFFICER SIGNATURE

TITLE ED WEINTRAUB, Director
Office of Historic Preservation

DATE

FOR NPS USE ONLY

I HEREBY CERTIFY THAT THIS PROPERTY IS INCLUDED IN THE NATIONAL REGISTER

DATE

ATTEST: KEEPER OF THE NATIONAL REGISTER

DATE

CHIEF OF REGISTRATION

OR

Allgates

Allgates
Delaware County
Zone 18

A	E472160	N4427640
B	E472180	N4427600
C	E472300	N4427200
D	E472300	N4427120
E	E471860	N4427440
F	E471980	N4427600

0 000 FEET 476

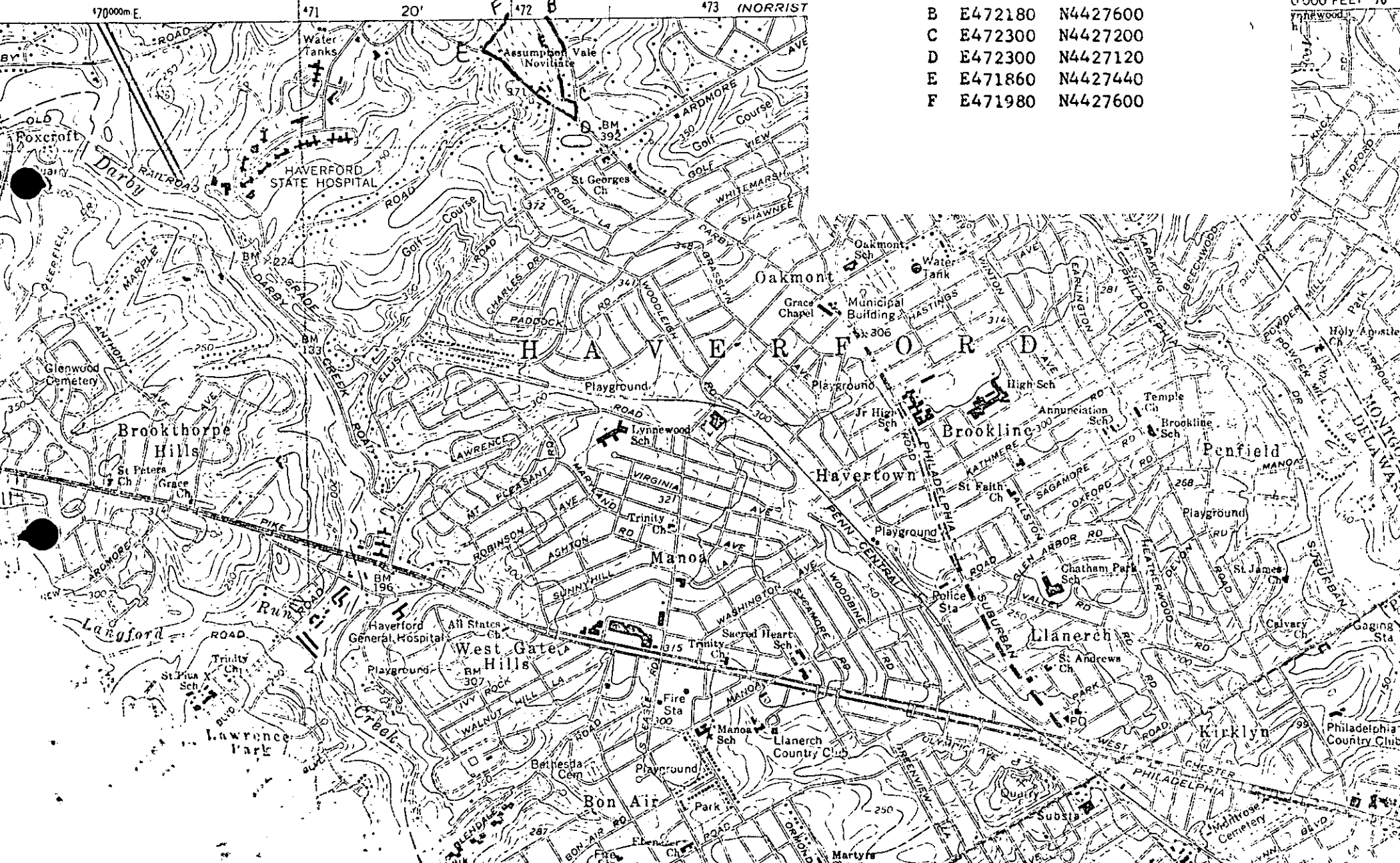

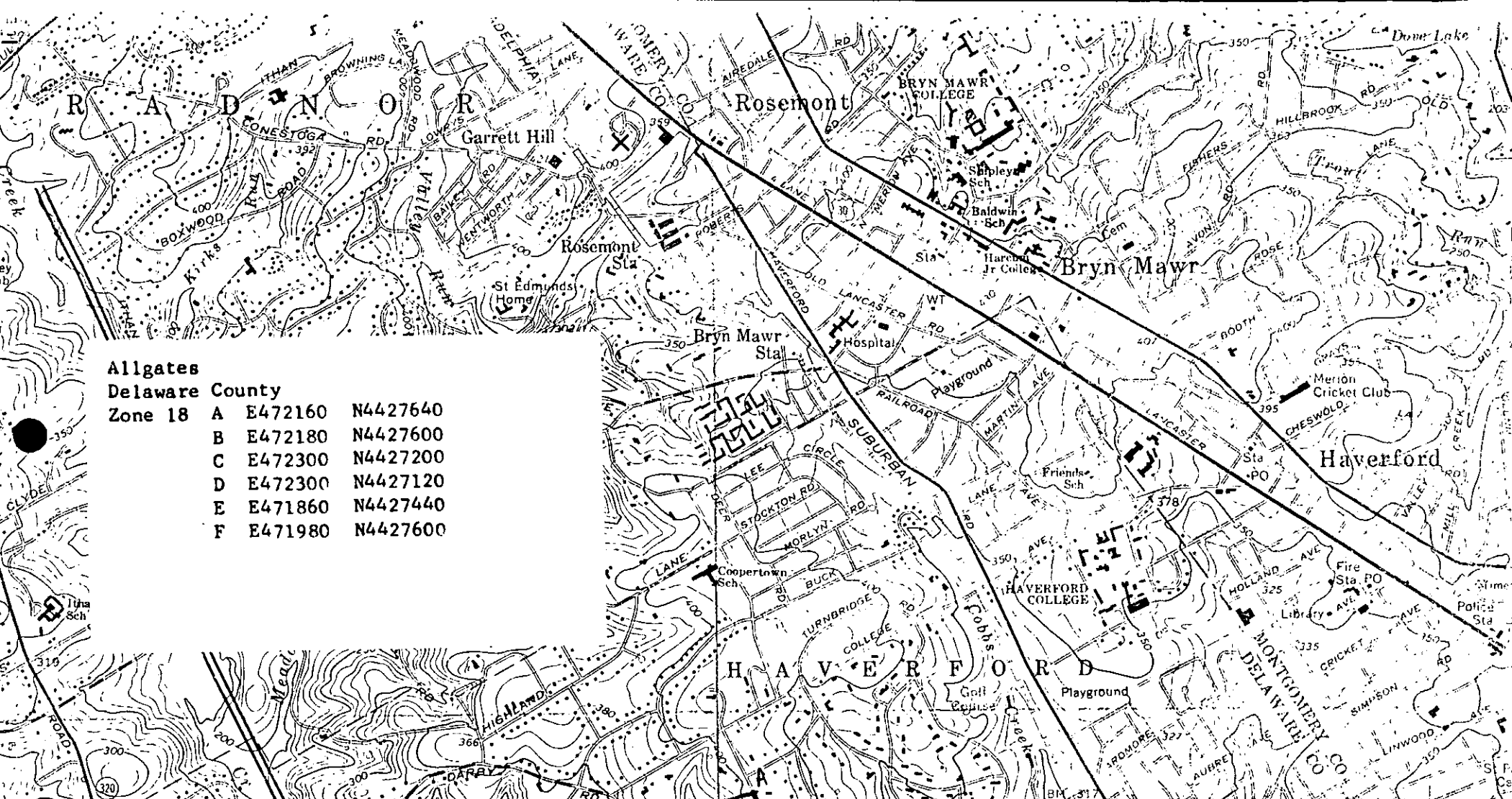

**Allgates
Delaware County
Zone 18**

A	E472160	N4427640
B	E472180	N4427600
C	E472300	N4427200
D	E472300	N4427120
E	E471860	N4427440
F	E471980	N4427600

Published by the Geological Survey
 Pennsylvania Department
 Topographic and Geologic Survey
 USGS, and USCE
 Photogrammetric methods from aerial photographs
 used 1952. Revised from aerial
 field checked 1966
 1827 North American datum
 on Pennsylvania coordinate system, south zone
 transverse Mercator grid ticks,
 collected fence and field lines where
 photographs. This information is unchecked
 (6) landmark buildings are shown

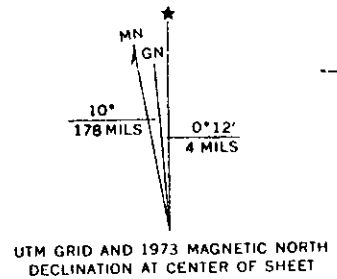

UTM GRID AND 1973 MAGNETIC NORTH
 DECLINATION AT CENTER OF SHEET

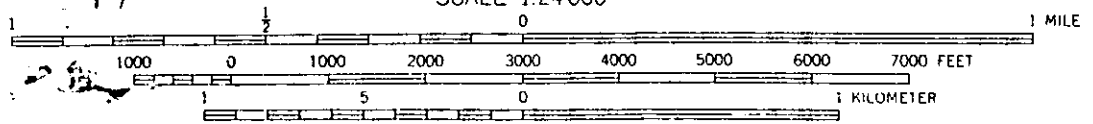

SCALE 1:24 000
 (LANSDOWNE)
 5963 IV NE

THIS MAP COMPLIES WITH NATIONAL MAP ACCURACY STANDARDS
 FOR SALE BY U. S. GEOLOGICAL SURVEY, WASHINGTON, D. C. 20242
 A FOLDER DESCRIBING TOPOGRAPHIC MAPS AND SYMBOLS IS AVAILABLE ON REQUEST