

9. HISTORICAL DATA

8. USGS QUAD. Sayre

UTM's: Zone 18

E	3	7	4	5	0	0
N	4	6	4	6	0	0
E						
N						

Designer/Engineer: David Keefe

Builder/Contractor: Unknown

Bridge Company: Penn Bridge Co. (small span)
 Bethlehem Steel Bridge Corp. (main span)

Date(s): 1916; basis Bridge Log

1913; basis plaque

1916; basis plaque on main span

_____ ; basis _____

Use: Vehicular present; Vehicular original.

10. SITE PLAN

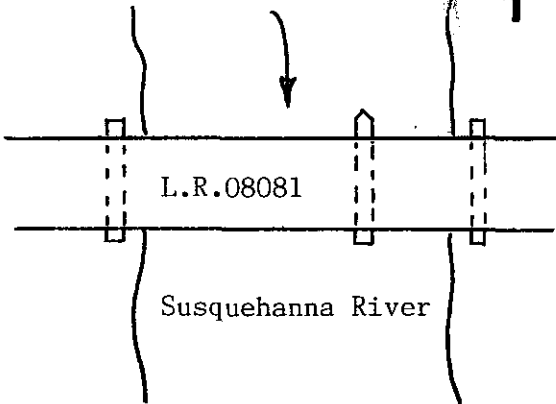

12. VIEW

no.

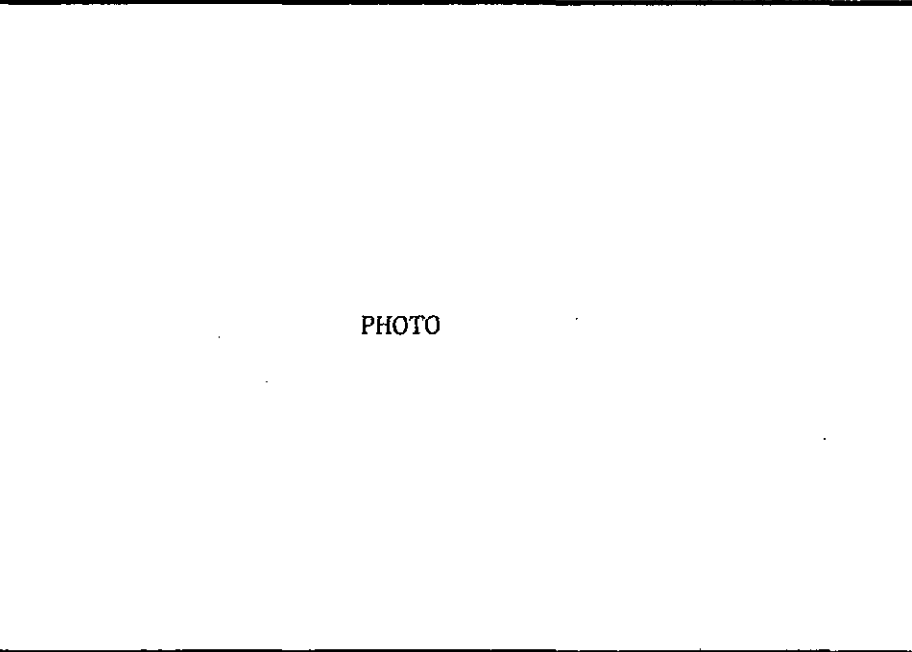

11. INTEGRITY

Xaltered; _____
 unaltered; _____
 moved; _____

Explain:
 Rebuilt 1953

13. COMMENTS

Unusual features:

Steel grid deck
 sidewalk both sides

Locale/environment:
 business district

Machinery (describe/identify type/
 equipment):

N/A

14. DIMENSIONS

1 @ 287'
 1 @ 253'
 spans: 2 no., 540 ft. O/A
 main: no., ft.
 secondary: no., ft.
 approach: no., ft.
 piers: no.
 towers: no., ft.

1. County: Bradford
 2. Municipality: Athens Twp. + Sayre
 3. Structure No.: 08120808101991095
 4. Survey Code: 43-110 T-5
 5. Present Name: Bridge in Athens Township
 6. Other name (historic name if any): N/A
 7. Crossing: I.R. 08081 over Susquehanna River

15. TYPE

CHARACTERISTICS

Truss: continuous/cantilever:
#2 small span



~~XXXXX~~ masonry/metal ~~XXXXX~~

#1 large span



Suspension:

Bascule:

Swing:

Vertical Lift:

Other:

- webbing: _____
- anchor span: _____
- cantilever span: _____
- suspended span: _____
- thru/deck/low (pony): full-slope/half-hip.
- connections: pin/riveted.
- eyebars: loop welded/die forged.
- railing: steel
- columns: _____

- thru/deck/1/2-thru.
- fixed (hingeless) /1/2/3-hinged.
- ribs: solid/braced; crescent/parallel.
- spandrels: open/solid/braced.
- intrados/vault; ribbed/solid.
- shape: semi-circular/elliptical/segmental; stilted.
- skew

- stiffening: braced-chain (1/2/3-hinged) /suspended truss.
- wire cable: twisted/parallel.
- eyebar chain.
- back-stay: straight/curved.

- single/double leaf.
- rolling lift: Schertzer.
- trunnion: simple (Chicago) /multiple (Strauss).
- counterweights: heel/overhead.
- Page/Rail.
- semi-lift/direct lift.

- bearing: center/rim/combination.
- (see Truss above)..
- (see Truss above).
- other: _____

16. MATERIALS (primary)

Superstructure	type	treatment/finish	source
main span:	<u>steel</u>	<u>smooth/painted</u>	<u>Phoenix/Bethlehem</u>
towers:	_____	_____	_____
railings:	<u>steel</u>	<u>smooth/painted</u>	<u>Phoenix</u>
Substructure			
piers:	<u>concrete</u>	<u>smooth</u>	_____
abutments:	<u>concrete</u>	<u>smooth</u>	_____
wings:	_____	_____	_____
intrados/ribs:	_____	_____	_____
voussoirs:	_____	_____	_____

17. PHOTO NO's. Roll#10
27 thru 36 incl.
Roll #11
1 thru 4 (incl.)

18. PREPARED BY: Edward P. Osnick
AGENCY/ORGANIZATION: Pa. Dept. of Transportation
DATE: 8/12/82

Survey Number: T-5

Bridge Name and Address: Bridge in Athens Township
L.R. 08081 over Susquehanna River
Bradford County

Owner: Commonwealth of Pennsylvania
Department of Transportation
Transportation & Safety Building
Harrisburg, Pennsylvania 17120

Statement of Significance: The bridge in Athens Township is an unusual example of a multiple span Pennsylvania (Petit) bridge. The main span is an oddly configured truss; it was altered by the addition of several camelback panels which connect it to the smaller span. Thus, the main span of this bridge appears to function as an asymmetrical continuous truss. This bridge is also unusual for its location. Most exemplary truss bridges included in this nomination were built in the north central, northwestern and southwestern sections of the state. This truss bridge is located in the northeastern portion of the state. One of eight Pennsylvania (Petit) bridges in the nomination, this bridge was built in 1913 and 1916 by the Penn Bridge Company and Bethlehem Steel Bridge Corporation.

Area of Significance: Engineering.

Boundary Description: The nominated property consists of a 540 feet long by 29 feet wide rectangle whose vertices correspond to the outside corners of the bridge's abutments, and includes only superstructure and substructure.

Acreage of Nominated Property: Less than one acre.

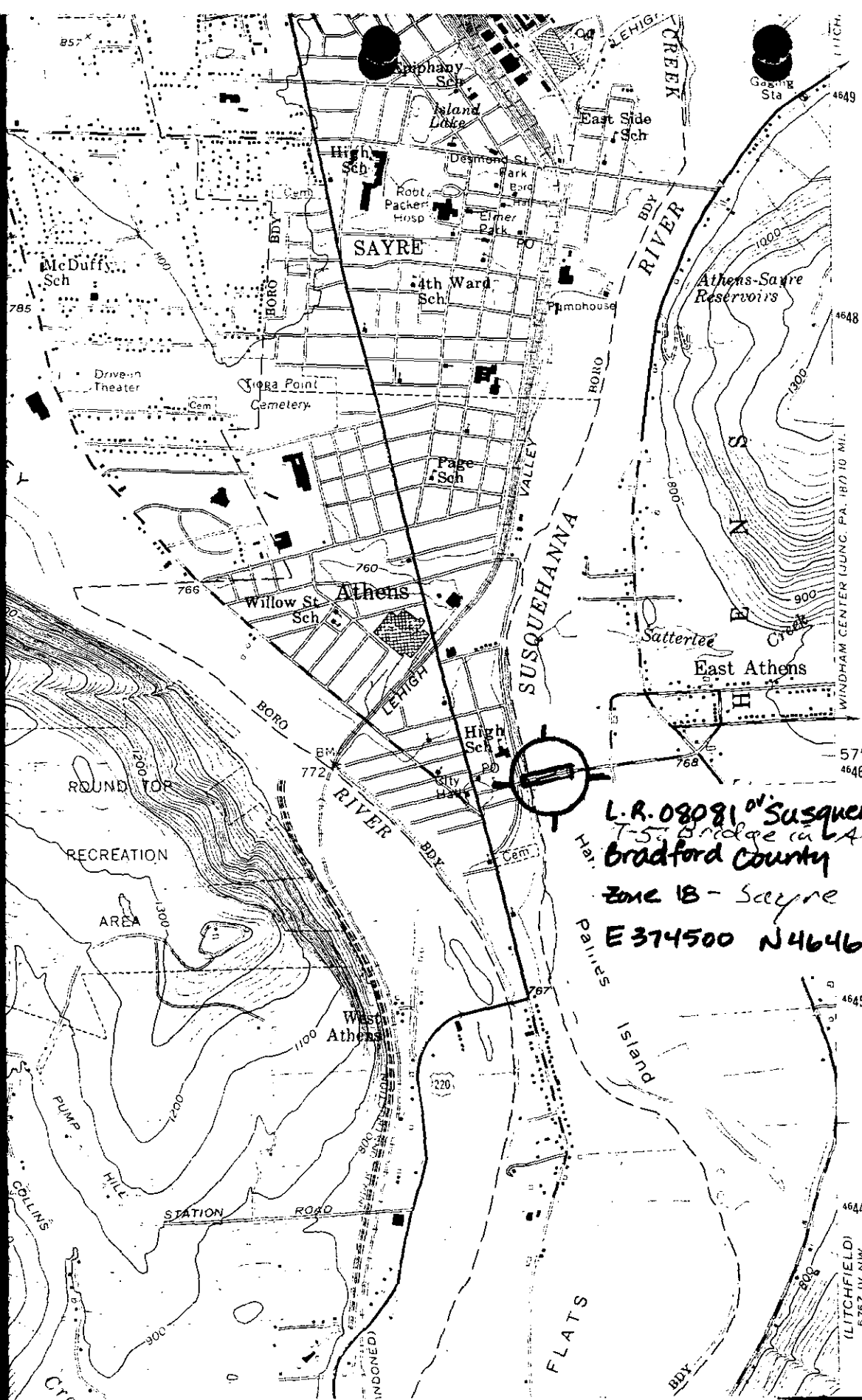

L.R. 08081 of Susquehanna River
 T-5 Bridge in Athens Twp.
 Bradford County
 Zone 18 - Sayre Quad
 E 374500 N 4646000

Bridge in Athens Township

T-5