

9. HISTORICAL DATA

8. USGS QUAD. Lititz

UTM's: Zone 18

E	3	9	1	1	2	0
N	4	4	5	0	1	6
E						
N						

Designer/Engineer:

Unknown

Builder/Contractor:

Ferro Construction Co.

Bridge Company:

Unknown

Date(s): 1908 ; basis Ozalide *

1908 ; basis Bridge plaque Hammer Creek Bridge built 1908. S. Millotterr, Silas E. Bard, L. R. Reist - Commissioners: M.N. Brubaker C.E.; ; basis Ferro Concrete Co., Builders, Harrisburg, Pa.

; basis

Use: Vehicular present; Vehicular original.

10. SITE PLAN

L.R.36153

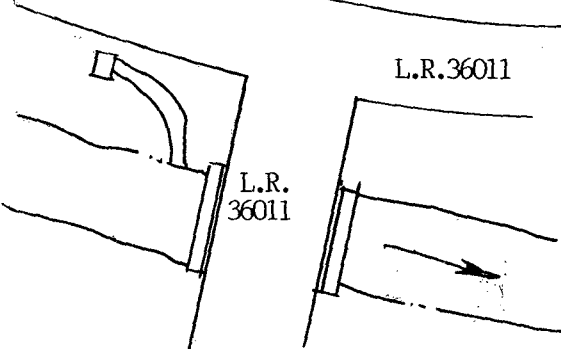

L.R.36011

L.R. 36011

12. VIEW

no.

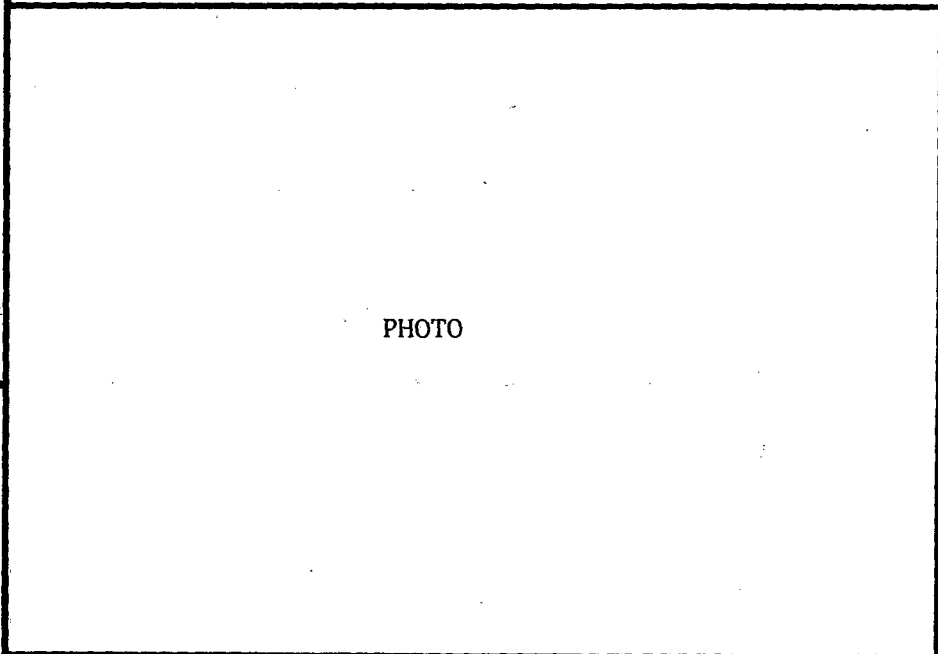

11. INTEGRITY

altered; _____
 x unaltered; _____
 moved; _____

Explain:

Upstream parapet wall leaning; rebars exposed in voussoirs, plate on down stream spandrels.

13. COMMENTS

Unusual features:
 Old Mill (excellent condition - residential NW of bridge road - Snavelly Mill Road)

Locale/environment:

Rural; residential

Machinery (describe/identify type/equipment):

N/A

14. DIMENSIONS

spans: 1 no., 75 ft. 0/A
 main: 1 no., 72 ft.
 secondary: no., ft.
 approach: no., ft.
 piers: no.
 towers: no., ft.

1. County Lancaster	2. Municipality Marwick & Elizabeth Twp.	3. Structure No. 562000110140824	4. Survey Code C-20
5. Present Name Hammer Creek Bridge	6. Other name (historic name if any) Hammer Creek Bridge	7. Crossing L.R. 36011 over Hammer Creek	

15. TYPE

CHARACTERISTICS

Truss: continuous/cantilever:

- webbing: _____
- anchor span: _____
- cantilever span: _____
- suspended span: _____
- thru/deck/low (pony): full-slope/half-hip.
- connections: pin/riveted.
- eyebars: loop welded/die forged.
- railing: Concrete parapet; incised rectangle
- columns: _____

Arch: masonry/metal:

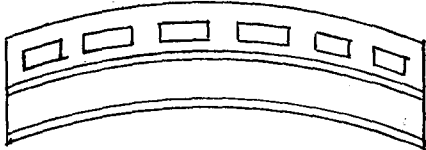

- thru/deck/1/2-thru.
- fixed (hingeless) /1/2/3-hinged.
- ribs: solid/braced; crescent/parallel.
- spandrels: open/solid/braced.
- intrados/vault; ribbed/solid.
- shape: semi-circular/elliptical/segmental; stilted.
- skew

Suspension:

- stiffening: braced-chain (1/2/3-hinged) /suspended truss.
- wire cable: twisted/parallel.
- eyebar chain.
- back-stay: straight/curved.

Bascule:

- single/double leaf.
- rolling lift: Schertzer.
- trunnion: simple (Chicago) /multiple (Strauss).
- counterweights: heel/overhead.
- Page/Roll.
- semi-lift/direct lift.

Swing:

- bearing: center/rim/combination.
- (see Truss above).

Vertical Lift:

- (see Truss above).

Other:

- other: _____

16. MATERIALS (primary)

Superstructure	type	treatment/finish	source
main span:	<u>Concrete</u>	<u>Smooth</u>	_____
towers:	_____	_____	_____
railings:	<u>Concrete</u>	<u>Smooth</u>	_____
Substructure			
piers:	_____	_____	_____
abutments:	<u>Concrete</u>	<u>Smooth</u>	_____
wings:	<u>Concrete</u>	<u>Smooth</u>	_____
intrados/ribs:	<u>Concrete</u>	<u>Smooth</u>	_____
voussiors:	<u>Concrete</u>	<u>Incised; radiating</u>	_____

17. PHOTO NO's.

08-23 (23-30)

18. PREPARED BY:

AGENCY/ORGANIZATION:

Patricia A. Remy

PennDOT

; DATE: 10-26-82

Survey Number: C-20

Bridge Name and Address: Hammer Creek Bridge
L.R. 36011 over Hammer Creek
Lancaster County

Owner: Commonwealth of Pennsylvania
Department of Transportation
Transportation & Safety Building
Harrisburg, Pennsylvania 17120

Statement of Significance: The Hammer Creek Bridge is a representative example of an early twentieth century concrete bridge. This single span arch bridge was built in 1908. The Hammer Creek Bridge arch spans 72 feet and is capped with a continuous solid parapet wall. This parapet is embellished simply with incised lines, a feature typical of Pennsylvania's early twentieth century concrete highway bridges. Among the bridges nominated, it is a particularly well preserved example of an early type of concrete bridge in Pennsylvania.

Area of Significance: Engineering

Boundary Description: The nominated property consists of a 75 feet long by 25 feet wide rectangle whose vertices coincide with the outside corners of the bridge's wing walls, and includes only superstructure and substructure.

Acreage of Nominated Property: Less than one acre.

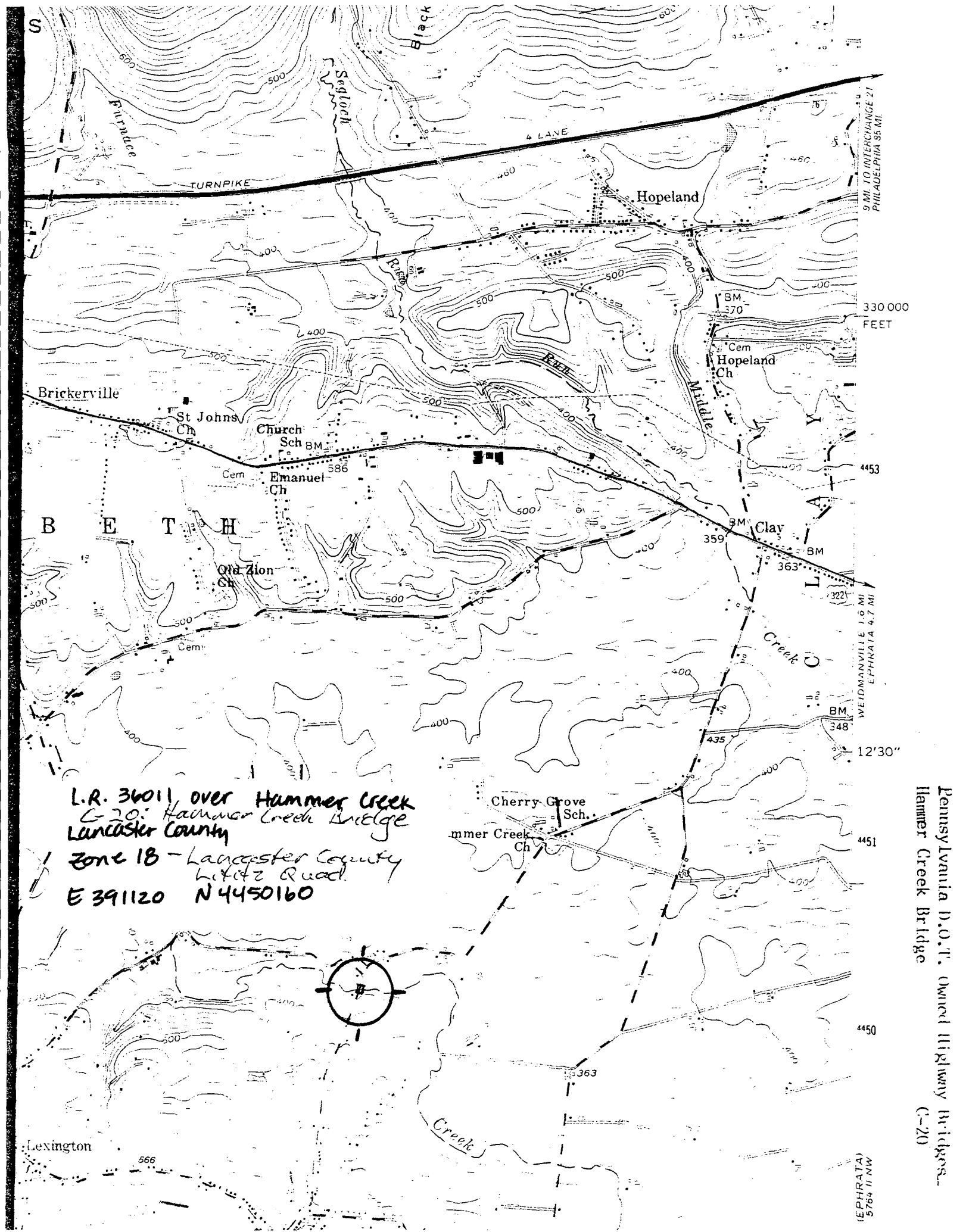

L.R. 36011 over Hammer Creek
 G-20: Hammer Creek Bridge
 Lancaster County
 Zone 18 - Lancaster County
 Lot 2 Road.
 E 391120 N 4450160

Pennsylvania D.O.T. Owned Highway Bridges -
 Hammer Creek Bridge
 G-20

(EPHRATA)
 5784 II NW