

9. HISTORICAL DATA

8. USGS QUAD. Milton

UTM's: Zone 18

E 3 4 3 3 0 0

N 4 5 4 9 2 0 0

E

N

Designer/Engineer:

James B. Long Noristown, Pa.

Builder/Contractor:

George W. Rockwell

Bridge Company:

North'd & Union Counties

Date(s): 1927 ; basis Inspection report

1927 ; basis Plaque

_____ ; basis

_____ ; basis

Use: Road over river present; Same original.

10. SITE PLAN

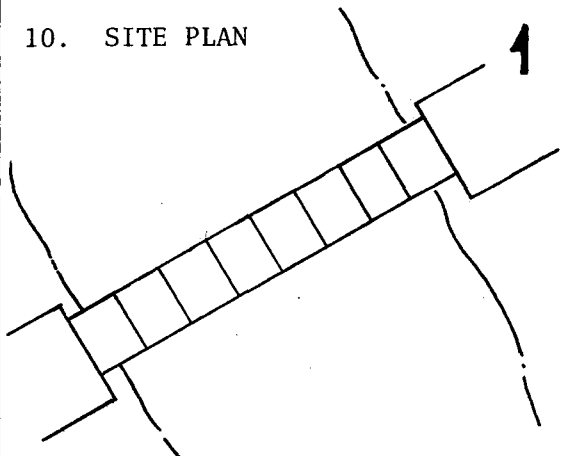

12. VIEW

no.

PHOTO

11. INTEGRITY

_____ altered; _____.

unaltered; _____.

_____ moved; _____.

Explain:

13. COMMENTS

Unusual features:

Long span arch bridge
 (large arches -9- span)
 (light towers)

Locale/environment:

Residential, partially wooded

Machinery (describe/identify type/
 equipment):

N/A

14. DIMENSIONS

spans: 9 no., 1080 ft. 0/A

main: 1 no., 120 ft.

secondary: 8 no., 120 ft.

approach: _____ no., _____ ft.

piers: _____ no.

towers: _____ no., _____ ft.

1. County Northumberland <i>W. Branch</i>	2. Municipality Boro of Watsontown <i>W. Branch</i>	3. Structure No. 14910124070010582	4. Survey Code 030-111 C-27
5. Present Name Watsontown River Bridge	6. Other name (historic name if any) N/A	7. Crossing L.R. 240 "spur"	over Susquehann River (W. Branch)

15. TYPE

CHARACTERISTICS

Truss: continuous/cantilever:

- webbing: _____.
- anchor span: _____.
- cantilever span: _____.
- suspended span: _____.
- thru/deck/low (pony): full-slope/half-hip.
- connections: pin/riveted.
- eyebars: loop welded/die forged.
- railing: _____.
- columns: _____.

Arch: masonry/metal:

- thru/deck/1/2-thru.
- fixed (hingeless) /1/2/3-hinged.
- ribs: solid/braced; crescent/parallel.
- spandrels: open/solid/braced.
- intrados/vault; ribbed/solid.
- shape: semi-circular/elliptical/segmental; stilted.
- skew 90°

Suspension:

- stiffening: braced-chain (1/2/3-hinged) /suspended truss.
- wire cable: twisted/parallel.
- eyebar chain.
- back-stay: straight/curved.

Bascule:

- single/double leaf.
- rolling lift: Schertzer.
- trunnion: simple (Chicago) /multiple (Strauss).
- counterweights: heel/overhead.
- Page/Rall.
- semi-lift/direct lift.

Swing:

- bearing: center/rim/combination.
- (see Truss above).

Vertical Lift:

- (see Truss above).

Other:

- other: _____.

16. MATERIALS (primary)

Superstructure	type	treatment/finish	source
main span:	Concrete	Smooth	_____.
towers:	_____	_____	_____.
railings:	Concrete	(with voids)	_____.
Substructure			
piers:	Concrete	Smooth	_____.
abutments:	Concrete	Smooth	_____.
wings:	Concrete	Smooth	_____.
intrados/ribs:	Concrete	Smooth	_____.
voussoirs:	Concrete	Smooth	_____.

17. PHOTO NO's.

03-18 (28-36)

18. PREPARED BY:

AGENCY/ORGANIZATION:

; DATE:

Survey Number: C-27

Bridge Name and Address: Watsontown River Bridge
L.R. 240 over West Branch of
Susquehanna River
Northumberland County & Union
County

Owner: Commonwealth of Pennsylvania
Department of Transportation
Transportation & Safety Building
Harrisburg, Pennsylvania 17120

Statement of Significance: The Watsontown River Bridge is an unusual example of a long, multiple-span open spandrel arch bridge. In overall appearance the nine arches of the bridge appear to be standard, ribbed open-spandrel arches, featuring spandrel arches and ornamental piers and lightposts. This is, however, the only open-spandrel arch bridge in this nomination which consists of solid barrels instead of individual arch ribs. Each barrel, then, carries transverse walls, rather than the standard spandrel-post-to-arch-rib configuration. Built in 1927, this open-spandrel arch is similar to the other long span bridges of that type in style and ornamentation.

Area of Significance: Engineering

Boundary Description: The nominated property consists of a 1,120 feet long by 28 feet wide rectangle whose vertices coincide with the outside corners of the bridge's wing walls, and includes only bridge superstructure and substructure.

Acreage of Nominated Property: One acre.

UNITED STATES
DEPARTMENT OF THE INTERIOR
GEOLOGICAL SURVEY

5555 111 NW
CONTOURSVILLE SOUTH

76° 52' 30" 343000m E 344 345 346 30
41° 07' 30"

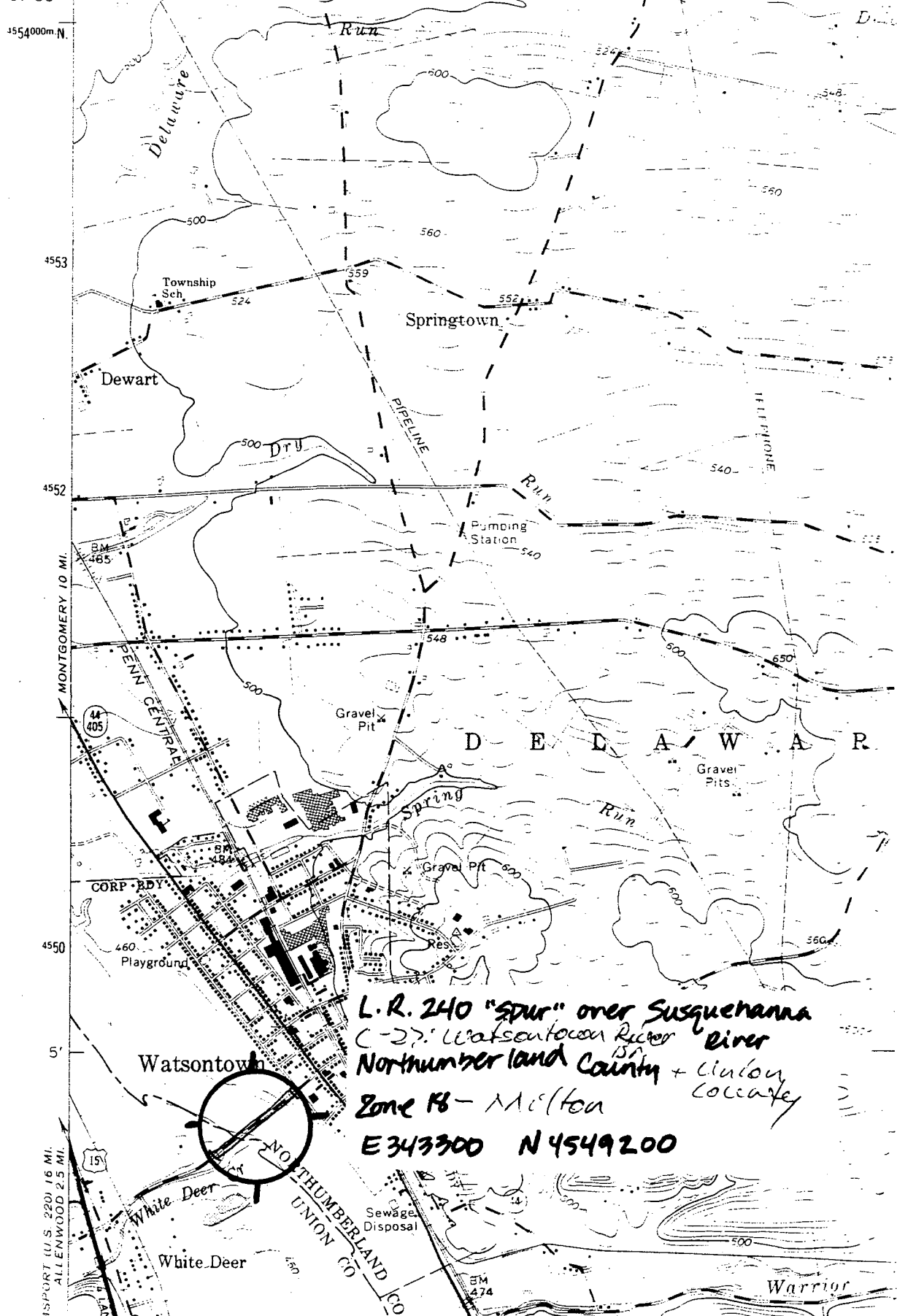

MONTGOMERY 10 MI.

MISPORT (U.S. 220) 16 MI.
ALLENWOOD 2.5 MI.

L.R. 240 "Spur" over Susquehanna
C-27: Watsonstown River
Northumberland County + Lincoln
County
Zone 18 - Milton
E 343300 N 4549200

