

9. HISTORICAL DATA

8. USGS QUAD. Everett West

UTM's: Zone 17

E	7	1	5	8	0	0
N	4	4	3	2	1	3
E						
N						

Designer/Engineer:

Unknown

Builder/Contractor:

Pittsburgh Construction Co.

Bridge Company:

Unknown

Date(s): 1935 ; basis District Bridge Files

1934 ; basis PA Dept. of Highways

\_\_\_\_\_ ; basis

\_\_\_\_\_ ; basis

Use: Vehicular present; Vehicular original.

10. SITE PLAN

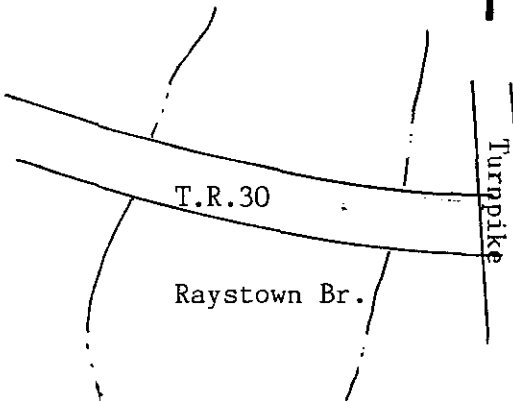

12. VIEW

no. 32

PHOTO

11. INTEGRITY

\_\_\_ altered; \_\_\_\_\_  
 unaltered; \_\_\_\_\_  
 \_\_\_ moved; \_\_\_\_\_

Explain:

13. COMMENTS

Unusual features:  
 Horizontal curve

Locale/environment: Rural rocky

Machinery (describe/identify type/  
 equipment):

N/A

14. DIMENSIONS

spans: 5 no., 580 ft. O/A  
 main: 3 no., 116 ft. each  
 secondary: \_\_\_ no., \_\_\_ ft.  
 approach: 2 no., 116 ft. each  
 piers: \_\_\_ no.  
 towers: \_\_\_ no., \_\_\_ ft.

1. County Bedford	2. Municipality Snake Spring Twp.	3. Structure No. 05119003910100914481	4. Survey Code 9-0 C-4
5. Present Name Bridge in Snake Spring Twp.	6. Other name (historic name if any) N/A	7. Crossing Tr30	over Raystown Br. Juniata River

15. TYPE

CHARACTERISTICS

Truss: continuous/cantilever:

webbing: \_\_\_\_\_  
 anchor span: \_\_\_\_\_  
 cantilever span: \_\_\_\_\_  
 suspended span: \_\_\_\_\_  
 thru/deck/low (pony): full-slope/half-hip.  
 connections: pin/riveted.  
 eyebars: loop welded/die forged.  
 railing: arcaded parapets  
 columns: \_\_\_\_\_

Arch: masonry/metal:

thru/deck/1/2-thru.  
 fixed (hingeless) /1/2/3-hinged.  
 ribs: solid/braced; crescent/parallel.  
 spandrels: open/solid/braced.  
 intrados/vault; ribbed/solid.  
 shape: semi-circular/elliptical/segmental; stilted.  
 skew

Suspension:

stiffening: braced-chain (1/2/3-hinged) /suspended truss.  
 wire cable: twisted/parallel.  
 eyebar chain.  
 back-stay: straight/curved.

Bascule:

single/double leaf.  
 rolling lift: Schertzer.  
 trunnion: simple (Chicago) /multiple (Strauss).  
 counterweights: heel/overhead.  
 Page/Rall.  
 semi-lift/direct lift.

Swing:

bearing: center/rim/combination.  
 (see Truss above).

Vertical Lift:

(see Truss above).

Other:

other: \_\_\_\_\_

16. MATERIALS (primary)

Superstructure	type	treatment/finish	source
main span:	<u>R.C.</u>	<u>smooth</u>	_____
towers:	_____	_____	_____
railings:	<u>R.C.</u>	<u>smooth</u>	_____
Substructure			
piers:	<u>Stone masonry</u>	<u>smooth</u>	_____
abutments:	<u>Stone Masonry</u>	<u>smooth</u>	_____
wings:	<u>Stone masonry</u>	<u>smooth</u>	_____
intrados/ribs:	<u>R.C.</u>	<u>smooth</u>	_____
voussoirs:	_____	_____	_____

17. PHOTO NO's.

18. PREPARED BY: J. Dain Davis  
 AGENCY/ORGANIZATION: PennDOT  
 ; DATE: 09-24-82

Survey Number: C-4

Bridge Name and Address: Bridge in Snake Spring Township  
L.R. 39 over Raystown Branch,  
Juniata River  
Bedford County

Owner: Commonwealth of Pennsylvania  
Department of Transportation  
Transportation & Safety Building  
Harrisburg, Pennsylvania 17120

Statement of Significance: The bridge in Snake Spring Township is an unusual example of a open-spandrel concrete arch bridge. One of fifteen open-spandrel concrete arch bridges in this nomination, this bridge consists of five 116 foot long arches built on high, skewed piers. Built in 1934, it is one of only two nominated open-spanded arches built on a skew. As such, it is a fairly rare representative of the additional engineering requirements involved in designing a skewed bridge rather than the usual straight bridge.

Area of Significance: Engineering

Boundary Description: The nominated property consists of a 700 feet long by 42 feet wide rectangle whose vertices coincide with the outside corners of the bridge's wing walls, and includes only superstructure and substructure.

Acreage of Nominated Property: Less than one acre.

Pennsylvania D.O.T. Owned Highway Bridges  
 Bridge in Snake Spring Twp. C-4

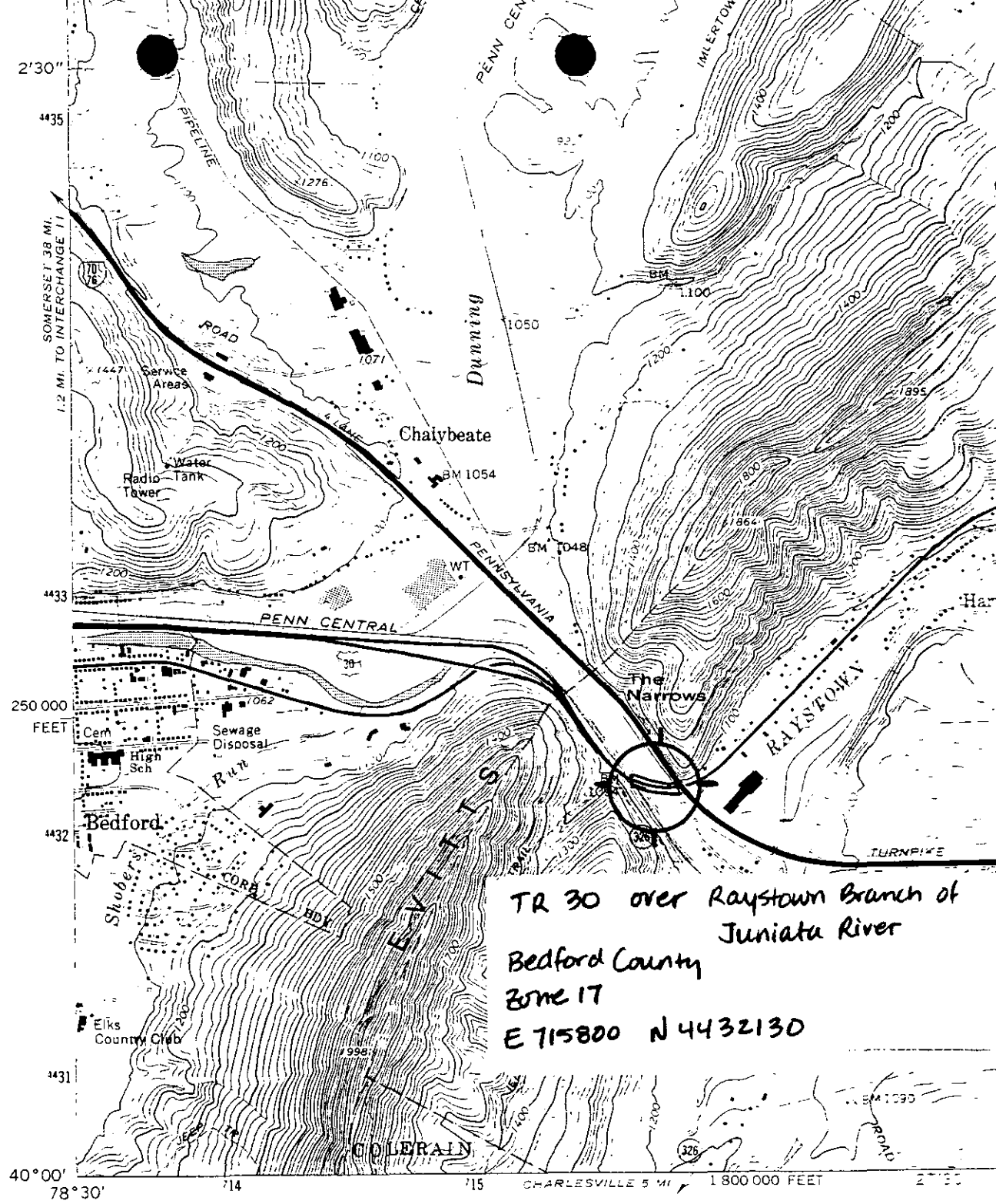

(RAINSBURG)  
 5263 / NE

Mapped, edited, and published by the Geological Survey  
 Control by USGS and USC&GS  
 Topography by photogrammetric methods from aerial photographs  
 taken 1967. Field checked 1968  
 Polyconic projection. 1927 North American datum  
 10,000-foot grid based on Pennsylvania coordinate system, south zone  
 1000-meter Universal Transverse Mercator grid ticks,  
 zone 17, shown in blue  
 Fine red dashed lines indicate selected fence and field lines where  
 generally visible on aerial photographs. This information is uncheckered  
 Relations shown in purple compiled in cooperation with  
 State of Pennsylvania, legends from series of photographs  
 taken 1973. This information not field checked

7°  
 1:24 MILS 1:39'  
 29 MILS

TM GRID AND 1973 MAGNETIC NORTH-  
 DECLINATION AT CENTER OF SHEET