

Survey Number: S-36

Bridge Name and Address: Frantz's Bridge  
L.R. 39060  
Lehigh County

Owner: Commonwealth of Pennsylvania  
Department of Transportation  
Transportation & Safety Building  
Harrisburg, Pennsylvania 17120

Statement of Significance: Frantz's Bridge is a multiple span stone arch bridge comprising three semi-circular arch spans of 32 feet, flanked by two long approach walls. It measures 166 feet long and was constructed of coursed rubble. The rock-faced ashlar voussoirs and contrasting parapet coping are the bridges only embellishments. This bridge appears to have been built in two phases as the stones above the arch crown are much smaller in size than the ones below. Frantz's Bridge was constructed in 1887 and is one of three stone bridges in this nomination which is located in Lehigh County; all three were built in the last quarter of the nineteenth century. This bridge is a well preserved representative example of multi-span stone bridges in Lehigh County. It combines very good integrity with the typical semi-circular arches and intermediate length found among other multi-span stone bridges in the nominated group.

Area of Significance: Engineering.

Boundary Description: The nominated property consists of a 166 feet long by 32 feet wide rectangle whose vertices coincide with the outside corners of the bridge's wing walls, and includes only bridge superstructure and substructure.

Acreage of Nominated Property: Less than one acre.

PENNSYLVANIA HISTORIC RESOURCE SURVEY FORM  
Bureau for Historic Preservation Box 1026  
PA Historical & Museum Commission Harrisburg, PA 17120

9. HISTORICAL DATA

8. USGS QUAD. Slatedale, PA  
UTM's: Zone 18  
E 4 4 5 0 0 0  
N 4 5 0 0 0 0 0  
E  
N

Designer/Engineer: Unknown  
Builder/Contractor: Unknown  
Bridge Company: Unknown

Date(s): 1887; basis PennDOT Records  
\_\_\_\_\_; basis \_\_\_\_\_  
\_\_\_\_\_; basis \_\_\_\_\_  
\_\_\_\_\_; basis \_\_\_\_\_  
Use: Vehicular present; Vehicular original.

10. SITE PLAN

1

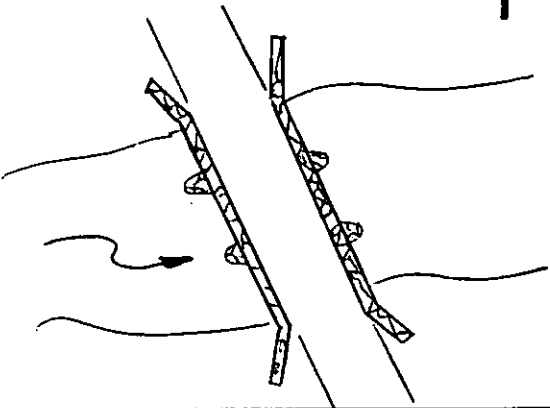

11. INTEGRITY

altered; \_\_\_\_\_  
 unaltered; \_\_\_\_\_  
moved; \_\_\_\_\_

Explain:

12. VIEW

no.



13. COMMENTS

Unusual features:

Locale/environment:

Rural

Machinery (describe/identify type/equipment):

14. DIMENSIONS 166 ft. overall

spans: 3 no., 166 ft. O/A  
main: 3 no., 32 ft. each  
secondary: \_\_\_\_\_ no., \_\_\_\_\_ ft.  
approach: \_\_\_\_\_ no., \_\_\_\_\_ ft.  
piers: 2 no. 4.5  
towers: \_\_\_\_\_ no., \_\_\_\_\_ ft.

1. County LEHIGH  
2. Municipality Lowhill Township  
3. Structure No. 3912010060101007984  
4. Survey Code 05-811  
5. Present Name Frantz's Bridge  
6. Other name (historic name if any)  
7. Crossing over Jordan Creek

15. TYPE 14

CHARACTERISTICS

Truss: continuous/cantilever:

- webbing: \_\_\_\_\_
- anchor span: \_\_\_\_\_
- cantilever span: \_\_\_\_\_
- suspended span: \_\_\_\_\_
- thru/deck/low (pony): full-slope/half-hip.
- connections: pin/riveted.
- eyebars: loop welded/die forged.
- railing: \_\_\_\_\_
- columns: \_\_\_\_\_

Arch: masonry/~~metal~~

- thru/deck/low
- fixed (hingeless) /1/2/3-hinged.
- ribs: solid/braced; crescent/parallel.
- spandrels: ~~open~~ /solid/braced
- intrados/vault; ribbed/solid.
- shape: semi-circular/~~elliptical/segmental~~
- skew None

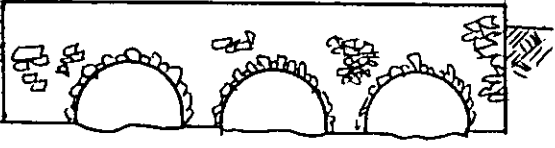

Suspension:

- stiffening: braced-chain (1/2/3-hinged) /suspended truss.
- wire cable: twisted/parallel.
- eyebar chain.
- back-stay: straight/curved.

Bascule:

- single/double leaf.
- rolling lift: Schertzer.
- trunnion: simple (Chicago) /multiple (Strauss).
- counterweights: heel/overhead.
- Page/Rall.
- semi-lift/direct lift!

Swing:

- bearing: center/rim/combination.
- (see Truss above).

Vertical Lift:

- (see Truss above).

Other:

- other: \_\_\_\_\_

16. MATERIALS (primary) 02, 12, 16

Superstructure	type	treatment/finish	source
main span:	_____	_____	_____
towers:	_____	_____	_____
railings:	Stone	Pointed	_____
Substructure			
piers:	Stone	Pointed	_____
abutments:	_____	_____	_____
wings:	_____	_____	_____
intrados/ <del>ribs</del> :	Stone	Gunite	_____
voussoirs:	_____	_____	_____

17. PHOTO NO's.  
05-03 (18-23)

18. PREPARED BY: R. J. Baransky  
AGENCY/ORGANIZATION: PennDOT  
DATE: 6/25/82

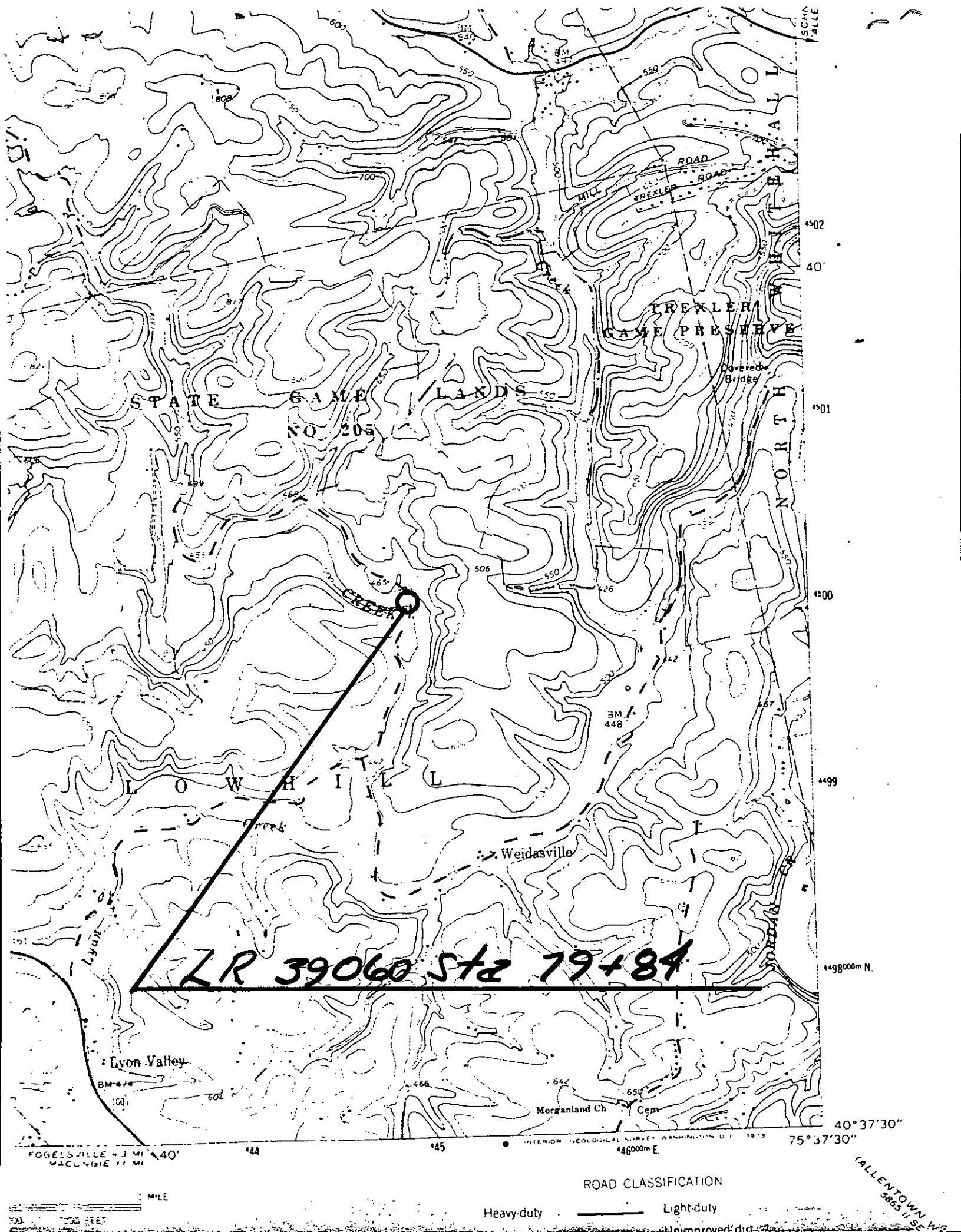

STATE GAME LANDS  
NO 205

FRENLER  
GAME PRESERVE

LOW WHITE CREEK

**LR 39060 Sta 79+84**

Lyon Valley

Weidasville

Morganland Ch

Cem

4502  
40'  
4501  
4500  
4499

4498000m N.

40° 37' 30"  
75° 37' 30"

FOGELSVILLE 3 MI  
MACLURGIE 11 MI

INTERIOR GEOLOGICAL SURVEY WASHINGTON D.C. 1973

ROAD CLASSIFICATION

Heavy-duty ——— Light-duty

VALLENTOWN  
5865 N. SE