

Survey Number: S-56  
Bridge Name and Address: 33rd Street Bridge in Philadelphia  
L.R. 67333 over Master Street  
Philadelphia County

Owner: Commonwealth of Pennsylvania  
Department of Transportation  
Transportation & Safety Building  
Harrisburg, Pennsylvania 17120

Statement of Significance: The 33rd Street Bridge in Philadelphia is an unusual single span stone arch bridge built about 1901. It is an excellent example of a skew arch built with brick ribs, in the manner described in contemporary texts. When viewed from inside the barrel these individual, obliquely-angled brick ribs are visible. The spandrel walls and voussoirs of this handsome overpass were constructed of ashlar. This is the only bridge in the nominated group that features skewed brick ribs.

**USE THIS COPY  
FOR DUPLICATING**

Area of Significance: Engineering.

Boundary Description: The nominated property consists of a 85 feet long by 65 feet wide rectangle whose vertices coincide with the outside corners of the bridge's wing walls, and includes only bridge superstructure and substructure.

Acreage of Nominated Property: Less than one acre.

**9. HISTORICAL DATA**

1. County Philadelphia  
 2. Municipality Philadelphia  
 3. Structure No. 167201031313010101131461  
 4. Survey Code 811 S-56  
 5. Present Name 33rd Street Bridge In Philadelphia  
 6. Other name (historic name if any) n/a  
 7. Crossing 33rd Street over Master Street

**8. USGS QUAD. Philadelphia**

UTM's: Zone  
 E 4 8 3 7 8 0  
 N 4 4 2 5 2 0 0  
 E  
 N

Designer/Engineer: Unknown  
 Builder/Contractor: Unknown  
 Bridge Company: Unknown

**10. SITE PLAN**

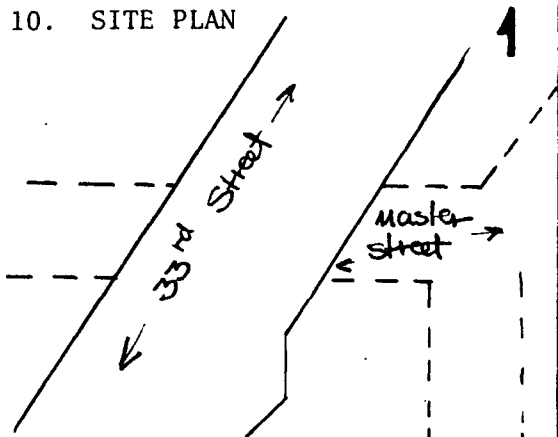

Date(s): 1901; basis PennDOT File  
 \_\_\_\_\_; basis  
 \_\_\_\_\_; basis  
 \_\_\_\_\_; basis  
 Use: Vehicular present; Vehicular original.

**11. INTEGRITY**

\_\_\_ altered; \_\_\_\_\_  
 X unaltered; \_\_\_\_\_  
 \_\_\_ moved; \_\_\_\_\_

Explain:

**12. VIEW**

no.

PHOTO

**13. COMMENTS**

Unusual features:  
 Ribbed brick intrados

Locale/environment: Urban

Machinery (describe/identify type/equipment):

**14. DIMENSIONS**

spans: \_\_\_ no., 85 ft. 0/A  
 main: 1 no., 41 ft.  
 secondary: \_\_\_ no., \_\_\_ ft.  
 approach: \_\_\_ no., \_\_\_ ft.  
 piers: \_\_\_ no.  
 towers: \_\_\_ no., \_\_\_ ft.

15. TYPE

CHARACTERISTICS

Truss: continuous/cantilever:

- webbing: \_\_\_\_\_.
- anchor span: \_\_\_\_\_.
- cantilever span: \_\_\_\_\_.
- suspended span: \_\_\_\_\_.
- thru/deck/low (pony): full-slope/half-hip.
- connections: pin/riveted.
- eyebars: loop welded/die forged.
- railing: \_\_\_\_\_.
- columns: \_\_\_\_\_.

Arch: masonry/metal:

- thru/deck/½-thru.
- fixed (hingeless) /1/2/3-hinged.
- ribs: solid/braced; crescent/parallel.
- spandrels: open/solid/braced.
- intrados/vault; ribbed/solid.
- shape: semi-circular/elliptical/segmental; stilted.
- skew

Suspension:

- stiffening: braced-chain (1/2/3-hinged) /suspended truss.
- wire cable: twisted/parallel.
- eyebar chain.
- back-stay: straight/curved.

Bascule:

- single/double leaf.
- rolling lift: Schertzer.
- trunnion: simple (Chicago) /multiple (Strauss).
- counterweights: heel/overhead.
- Page/Rall.
- semi-lift/direct lift.

Swing:

- bearing: center/rim/combination.
- (see Truss above).

Vertical Lift:

- (see Truss above).

Other:

- other: \_\_\_\_\_.

16. MATERIALS (primary)

Superstructure	type	treatment/finish	source
main span:	<u>masonry</u>	<u>semi-coursed</u>	_____.
towers:	_____	_____	_____.
railings:	_____	_____	_____.
Substructure			
piers:	_____	_____	_____.
abutments:	_____	_____	_____.
wings:	<u>masonry</u>	<u>semi-coursed</u>	_____.
intrados/ribs:	<u>brick</u>	<u>ribbed</u>	_____.
voussoirs:	<u>masonry</u>	_____	_____.

17. PHOTO NO's.  
06-22 (19-25)

18. PREPARED BY:  
AGENCY/ORGANIZATION: District 6-0  
; DATE: January 3, 1983



33rd STREET over MASTER ST.  
33rd Street Bridge in Philadelphia  
Philadelphia County  
Zone 18 - Philadelphia Broad  
E 48 3780 N 44 25200