

PENNSYLVANIA HISTORIC RESOURCE SURVEY FORM
 Bureau for Historic Preservation Box 1026
 PA Historical & Museum Commission Harrisburg, PA 17120

9. HISTORICAL DATA

8. USGS QUAD. Glen Richey

UTM's: Zone 17

E	7	1	1	1	4	0
N	4	5	3	8	6	4
E						
N						

Designer/Engineer:

Unknown

Builder/Contractor:

Unknown

Bridge Company:

King Bridge Company, Cleveland, Ohio

Date(s): 1893 ; basis Bride Unit File

1893 ; basis Bridge Plaque

_____ ; basis

_____ ; basis

Use: Vehicular present; Vehicular original.

10. SITE PLAN

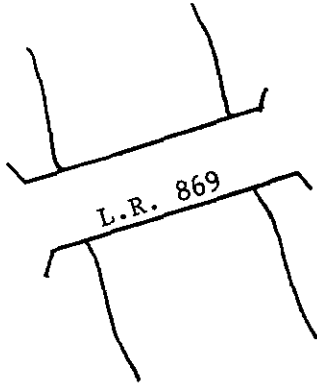

Date(s): 1893 ; basis Bride Unit File

1893 ; basis Bridge Plaque

_____ ; basis

_____ ; basis

Use: Vehicular present; Vehicular original.

11. INTEGRITY

altered; _____.

unaltered; _____.

moved; _____.

Explain:

Bolted splice plates on top chord.

12. VIEW

no.

PHOTO

13. COMMENTS

Unusual features:

Long span for age

Locale/environment:

Undeveloped, rural Evidence of an old foundation (12x12 hewed timber)

Machinery (describe/identify type/equipment):

14. DIMENSIONS

spans: 1 no., 215 ft. O/A

main: _____ no., _____ ft.

secondary: _____ no., _____ ft.

approach: _____ no., _____ ft.

piers: _____ no.

towers: _____ no., _____ ft.

1. County Clearfield
 2. Municipality Lawrence Twp. + Piche
 3. Structure No. 17110181519101012191710
 4. Survey Code 02-310 T-10
 5. Present Name Hopback Bridge
 6. Other name (historic name if any) Porter Bridge
 7. Crossing L.R. 869 over W. Br. Susquehanna River

15. TYPE

CHARACTERISTICS

Truss: continuous/cantilever:

- webbing: Pennsylvania
- anchor span: _____
- cantilever span: _____
- suspended span: _____
- thru/deck/low (pony): full-slope/half-hip.
- connections: pin/riveted.
- eyebars: loop welded/die forged.
- railing: guard rail (steel) over lattice
- columns: channels with lacing

Arch: masonry/metal

- thru/deck/1/2-thru.
- fixed (hingeless) /1/2/3-hinged.
- ribs: solid/braced; crescent/parallel.
- spandrels: open/solid/braced.
- intrados/vault; ribbed/solid.
- shape: semi-circular/elliptical/segmental; stilted.
- skew

Plaque:

Commissioners:
 Geo. I Thompson
 E. G. Gearhart
 John, McGaughey

- stiffening: braced-chain (1/2/3-hinged) /suspended truss.
- wire cable: twisted/parallel.
- eyebar chain.
- back-stay: straight/curved.

Bascule:

- single/double leaf.
- rolling lift: Schertzer.
- trunnion: simple (Chicago) /multiple (Strauss).
- counterweights: heel/overhead.
- Page/Rall.
- semi-lift/direct lift.

Swing:

- bearing: center/rim/combination.
- (see Truss above).

Vertical Lift:

- (see Truss above).

Other:

- other: _____

16. MATERIALS (primary)

Superstructure	type	treatment/finish	source
main span:	<u>steel</u>	_____	_____
towers:	_____	_____	_____
railings:	_____	_____	_____
Substructure			
piers:	_____	_____	_____
abutments:	<u>stone (sand)</u>	<u>coarsed ashlar, broken faced</u>	_____
wings:	<u>stone</u>	<u>striated</u>	_____
intrados/ribs:	_____	_____	_____
vousoirs:	_____	_____	_____

17. PHOTO NO's.
 02-14 (1-9)

18. PREPARED BY: K. Bartoo
 AGENCY/ORGANIZATION: _____
 ; DATE: Pa.DOT
9/82

NATIONAL REGISTER

Survey Number: T-10

Bridge Name and Address: Hogback Bridge
L.R. 869 over West Branch
Susquehanna River
Clearfield County

Owner: Commonwealth of Pennsylvania
Department of Transportation
Transportation & Safety Building
Harrisburg, Pennsylvania 17120

Statement of Significance: Hogback Bridge is an intact example of a typical Pennsylvania (Petit) truss. This pin-connected truss is one of eight Pennsylvania (Petit) included in this nomination. Hogback Bridge was built in 1893 by King Bridge Company of Cleveland, Ohio, one of the leading nineteenth century manufacturers of metal truss bridges in the United States. King Bridge Company, known as King Iron Bridge and Manufacturing Company from 1871 to 1893, built bridges continuously until the early twentieth century. As a very well preserved example of an often used bridge design in Pennsylvania; and as an example of a leading bridge manufacturer, this structure warrants listing on the National Register.

Area of Significance: Engineering.

Boundary Description: The nominated property consists of a 235 feet long by 25 feet wide rectangle whose vertices coincide with the outside corners of the bridge's wing walls, and includes only superstructure and substructure.

Acreage of Nominated Property: Less than one acre.

