

PENNSYLVANIA HISTORIC RESOURCE SURVEY FORM
 Bureau for Historic Preservation Box 1026
 PA Historical & Museum Commission Harrisburg, PA 17120

9. HISTORICAL DATA

8. USGS QUAD. Cambridge Springs

UTM's: Zone 17
 E | 5 | 7 | 7 | 9 | 7 | 0 |
 N | 4 | 6 | 2 | 8 | 5 | 0 | 0 |
 E | | | | | | | |
 N | | | | | | | |

Designer/Engineer:

Unknown

Builder/Contractor:

Unknown

Bridge Company:

Youngstown Bridge Company

Date(s): 1896 ; basis Form #488A

1896 ; basis bridge plaque

_____ ; basis

_____ ; basis

Use: Vehicular present; Vehicular original.

10. SITE PLAN

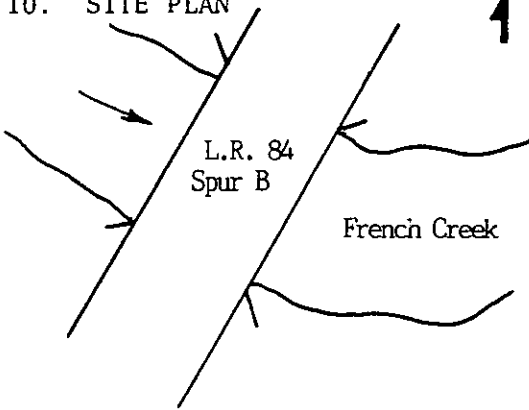

11. INTEGRITY

x altered; _____
 _____ unaltered; _____
 _____ moved; _____

Explain:

1948 - some truss members reinforced. 1973 - re-inforced floor system.

12. VIEW

no.

PHOTO

13. COMMENTS

Unusual features:

Cantilever sidewalk on upstream side. Ornamented hand railing.

Locale/environment:

Rural

Machinery (describe/identify type/equipment):

N/A

14. DIMENSIONS

spans: 1 no., 200 ft. O/A
 main: _____ no., _____ ft.
 secondary: _____ no., _____ ft.
 approach: _____ no., _____ ft.
 piers: _____ no.
 towers: _____ no., _____ ft.

1. County
 Crawford
 5. Present Name
 Bridge in Cambridge Springs

2. Municipality
 Cambridge Springs
 6. Other name (historic name if any)
 N/A

3. Structure No.
 120111018141511415131
 7. Crossing
 L.R. 84 Spur B
 over
 French Creek

4. Survey Code
 01-110 T-14

15. TYPE

CHARACTERISTICS

Truss: continuous/cantilever:

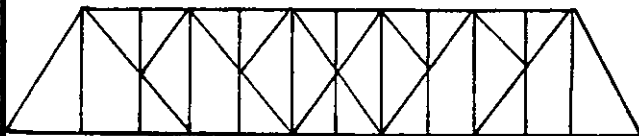

- webbing: _____
- anchor span: _____
- cantilever span: _____
- suspended span: _____
- thru/deck/low (pony): full-slope/half-hip.
- connections: pin/riveted.
- eyebars: loop welded/die forged.
- railing: diamond
- columns: angles & channels

Arch: masonry/metal:

- thru/deck/1/2-thru.
- fixed (hingeless) /1/2/3-hinged.
- ribs: solid/braced; crescent/parallel.
- spandrels: open/solid/braced.
- intrados/vault; ribbed/solid.
- shape: semi-circular/elliptical/segmental; stilted.
- skew

Suspension:

- stiffening: braced-chain (1/2/3-hinged) /suspended truss.
- wire cable: twisted/parallel.
- eyebar chain.
- back-stay: straight/curved.

Bascule:

- single/double leaf.
- rolling lift: Schertzer.
- trunnion: simple (Chicago) /multiple (Strauss).
- counterweights: heel/overhead.
- Page/Rall.
- semi-lift/direct lift.

Swing:

- bearing: center/rim/combination.
- (see Truss above).

Vertical Lift:

- (see Truss above).

Other:

- other: _____

16. MATERIALS (primary)

Superstructure	type	treatment/finish	source
main span:	<u>steel</u>	<u>paint</u>	<u>Carnegie, USA</u>
towers:	<u>steel</u>	<u>paint</u>	<u>Carnegie, USA</u>
railings:	<u>steel</u>	<u>paint</u>	<u>Carnegie, USA</u>
Substructure			
piers:	_____	_____	_____
abutments:	<u>Concrete</u>	_____	_____
wings:	<u>stone</u>	_____	_____
intrados/ribs:	_____	_____	_____
voussoirs:	_____	_____	_____

17. PHOTO NO's. Roll #8
8 exposures

18. PREPARED BY: D.W. Paskie
AGENCY/ORGANIZATION: PennDOT
; DATE: 7/29/82

Survey Number: T-14

Bridge Name and Address: Bridge in Cambridge Springs Borough
L.R. 84-Spur B over French Creek
Crawford County

Owner: Commonwealth of Pennsylvania
Department of Transportation
Transportation & Safety Building
Harrisburg, Pennsylvania 17120

Statement of Significance: The Bridge in Cambridge Springs Borough is a typical example of a Baltimore truss. It is one of only three representative examples of this truss type included in this nomination. It was built in 1896 by the Youngstown Bridge Company. This pin-connected through truss features a bridge plate, simple decorative railing, and typically configured members. It is a well preserved and fairly rare example of this type of a Baltimore truss.

Area of Significance: Engineering.

Boundary Description: The nominated property consists of a 200 feet long by 35 feet wide rectangle whose vertices coincide with the outside corners of the bridge's wing walls, and includes only superstructure and substructure.

Acreage of Nominated Property: Less than one acre.

L.R. 84 Spur B
T-14 Bridge at Cambridge Springs
Crawford County
Zone 17 - Cambridge Springs Quad
E 577970 N 4628500

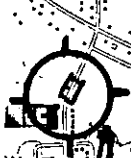

Golf Course FRENCH
Boat Ramp

Cambridge Springs

C A M B R I D G E

W O O D C O C K

