

PENNSYLVANIA HISTORIC RESOURCE SURVEY FORM
 Bureau for Historic Preservation Box 1026
 PA Historical & Museum Commission Harrisburg, PA 17120

9. HISTORICAL DATA

8. USGS QUAD. Geneva
 UTM's: Zone 17
 E 5 7 0 8 1 0
 N 4 6 0 4 2 9 0
 E
 N

Designer/Engineer:
 Unknown
 Builder/Contractor:
 county
 Bridge Company:
 Penn Bridge Company; Beaver Falls, PA

Date(s): 1888; basis form #432
 1888; basis bridge plaque
 ; basis
 ; basis

Use: Vehicular present; Vehicular original.

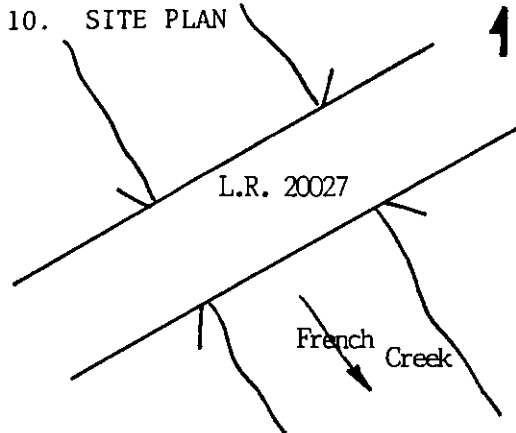

11. INTEGRITY
 altered; _____
 unaltered; _____
 moved; _____

Explain:
 1937 - floor system
 1946 - laminated floor -
 wheel quard - bituminous
 wearing surface

12. VIEW no.

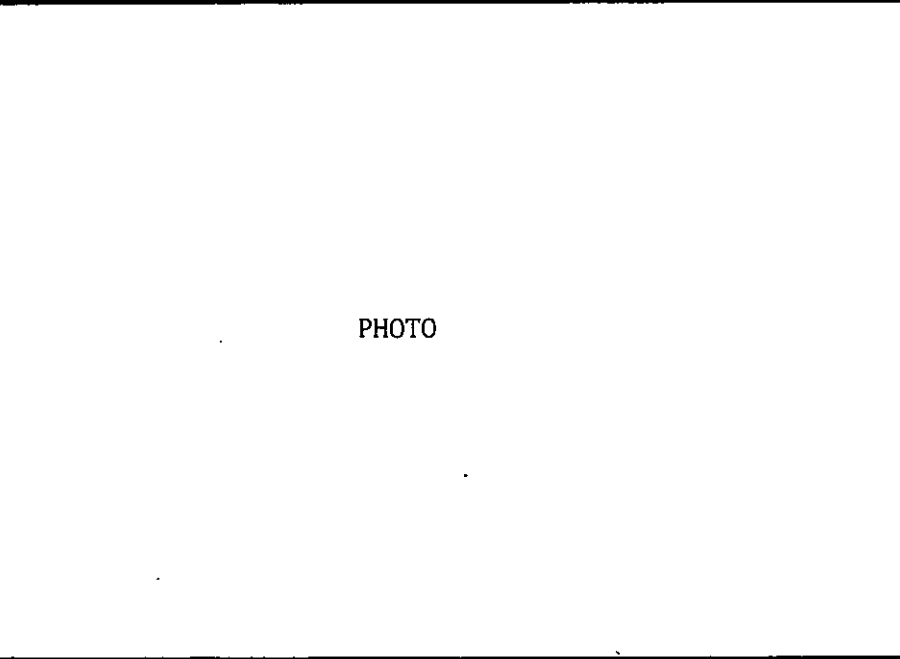

13. COMMENTS
 Unusual features:
 N/A

Locale/environment:
 Rural
 Machinery (describe/identify type/
 equipment):
 N/A

14. DIMENSIONS
 spans: 1 no., 158 ft. 0/A
 main: no., ft.
 secondary: no., ft.
 approach: no., ft.
 piers: no.
 towers: no., ft.

1. County: Crawford
 2. Municipality: West Mead Township
 3. Structure No.: L.R. 20027
 4. Survey Code: 01-310 7-16
 5. Present Name: Bridge in West Mead Township
 6. Other name (historic name if any): N/A
 7. Crossing: L.R. 20027 over French Creek

15. TYPE

CHARACTERISTICS

Truss: continuous/cantilever:

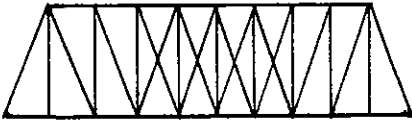

Arch: masonry/metal:

Suspension:

Bascule:

Swing:

Vertical Lift:

Other:

- webbing: Pratt
- anchor span: _____
- cantilever span: _____
- suspended span: _____
- thru/deck/low (pony): full-slope/half-hip.
- connections: pin/riveted.
- eyebars: loop welded/die forged. both
- railing: steel pipe
- columns: angles & channels

- thru/deck/1/2-thru.
- fixed (hingeless) /1/2/3-hinged.
- ribs: solid/braced; crescent/parallel.
- spandrels: open/solid/braced.
- intrados/vault; ribbed/solid.
- shape: semi-circular/elliptical/segmental; stilted.
- skew

- stiffening: braced-chain (1/2/3-hinged) /suspended truss.
- wire cable: twisted/parallel.
- eyebar chain.
- back-stay: straight/curved.

- single/double leaf.
- rolling lift: Schertzer.
- trunnion: simple (Chicago) /multiple (Strauss).
- counterweights: heel/overhead.
- Page/Rall.
- semi-lift/direct lift.

- bearing: center/rim/combination.
- (see Truss above).

- (see Truss above).

- other: _____

16. MATERIALS (primary)

| Superstructure | type | treatment/finish | source |
|----------------|-------|------------------|--------|
| main span: | steel | paint | _____ |
| towers: | steel | paint | _____ |
| railings: | steel | paint | _____ |
| Substructure | | | |
| piers: | _____ | _____ | _____ |
| abutments: | stone | masonry | _____ |
| wings: | stone | masonry | _____ |
| intrados/ribs: | _____ | _____ | _____ |
| voussoirs: | _____ | _____ | _____ |

17. PHOTO NO's.

01-25-(23-30)

Roll: #26

6 exposures

18. PREPARED BY: D.W. Paskie
AGENCY/ORGANIZATION:

PennDOT

; DATE: 8/18/82

Survey Number: T-16

Bridge Name and Address: Bridge in West Mead Township
L.R. 20027 over French Creek
Crawford County

Owner: Commonwealth of Pennsylvania
Department of Transportation
Transportation & Safety Building
Harrisburg, Pennsylvania 17120

Statement of Significance: The Bridge in West Mead Township is a typical Pratt through truss, built in 1888 by a nineteenth century Pennsylvania company, the Penn Bridge Company of Beaver Falls. Identified on the ornamental bridge plates located on both portals, the Penn Bridge Company was established in 1868, and built truss bridges until the early twentieth century. The single-span bridge in West Mead Township has not been altered and retains much of the nineteenth century character of site and structure. This Pratt truss is lightly structured of typical members, eyebars and riveted angles and channels with lacing bars. The joints on this span of moderate length are pin-connected. As a well preserved, lightly structured example of a bridge type used frequently in northwestern Pennsylvania, this structure warrants listing on the National Register.

Area of Significance: Engineering.

Boundary Description: The nominated property consists of a 178 feet long by 25 feet wide rectangle whose vertices coincide with the outside corners of the bridge's wing walls, and includes only superstructure and substructure.

Acreage of Nominated Property: Less than one acre.

