

TOTAL MILES  
 Township Road System 37.91  
 State Highway System 21.97  
 Total 59.88

LEGEND

- LIMITED ACCESS HIGHWAY
- STATE ROUTE AND NUMBER
- STATE MAINTAINED BRIDGE ON TOWNSHIP ROAD
- TOWNSHIP ROAD, NUMBER AND SEGMENT LENGTH IN MILES
- IMPASSABLE TOWNSHIP ROAD
- TURNBACK TOWNSHIP ROAD
- OTHER ROAD
- RAILROAD (IN SERVICE)
- RAILROAD ABANDONED (TRACK RETAINED)
- STATE BOUNDARY
- COUNTY BOUNDARY
- TOWNSHIP BOUNDARY
- CITY OR BOROUGH BOUNDARY
- MUNICIPAL BUILDING
- SPLIT MILEAGE BETWEEN MUNICIPALITIES

- 340 BRICK RIDGE LA
- 341 GREEN MEADOW CT
- 342 DAVIS AV
- 390 WEIRICH AV
- 392 CALDWELL AV
- 419 SPENCER AV
- 440 PLUM ST
- 444 PEACH ST
- 524 REK RD
- 525 NORMAN AV
- 526 OLD RD
- 527 HAINES RD
- 528 THE CIRCLE
- 529 LACOCK ST
- 532 MILLER RD
- 533 WOLF AV
- 534 A'PROUNT RD
- 535 BURTON ST
- 537 STEEL ST
- 538 ANDOTT RD
- 543 DYE RD
- 545 PRUGG RD
- 546 KIMBERLY DR
- 547 HELEN ST
- 548 MURPHY DR
- 549 JEANNE ST
- 550 BEALL AV
- 551 PAUL ST
- 552 VELTRI DR
- 553 TOPVIEW DR
- 554 BEVERLY DR
- 555 MORRISON AV
- 556 DIANE DR
- 557 MIDLAND DR
- 558 CORIEZ DR
- 559 BEATTY DR
- 560 CRESCENT DR
- 562 KLINE DR
- 563 WYLLIE AV
- 565 RODOLAN DR
- 567 MCCLAY RD
- 568 HANEY RD
- 576 CRIFETH ST
- 578 HAYES AV
- 580 BALDOW AV
- 582 HEWITT AV
- 584 HILLTOP LA
- 585 RAMSON DR
- 586 CORNELIA ST
- 588 VIRGINIA VIA
- 589 SHADY LA
- 590 EDGEWOOD AV
- 591 RUSSELL ST
- 623 WALONE RIDGE RD
- 647 LYNN RD
- 661 TAGGART AV
- 662 MULBERRY HILL RD
- 701 WARRA ST
- 702 MCCARREL AV
- 703 FORD ST
- 705 KERNS ST
- 709 GREEN ST
- 711 FINDLAY ST
- 885 ELIZABETH ST
- 911 ARLINGTON AV
- 913 ELLIS AV
- 915 SCOTT AV
- 917 CHARLES ST
- 925 ADDISON ST
- 927 HICKORY ST
- 931 SHEFFIELD ST
- 932 OAKWOOD ST
- 934 NICHOLS DR
- 936 BARNETT ST
- 938 HAWKINS ST
- 941 LINWOOD AV
- 943 BERRIHEL AV
- 945 WAYNE ST
- 946 MCGOVERN AV
- 947 BUENA VISTA ST
- 949 ERING ST
- 951 ONIO ST
- 963 WARY ST
- 965 WILLIAM ST
- 966 CHALLENGER RD
- 967 RACE ST
- 968 CARBON ST
- 969 PENNSYLVANIA AV
- 970 ARCH ST
- 971 VINE ST
- 972 MELDY LA
- 974 BELMONT ST
- 975 WILMINGTON ST
- 977 OLD CHESTNUT ST
- 980 GROVE AV
- 984 SMOKE ST
- 992 BLUEJAY DR
- 993 REDWING DR
- 994 ALBERT ST
- 995 HAROLD ST
- 997 MELVIN ST
- 998 MARK ST

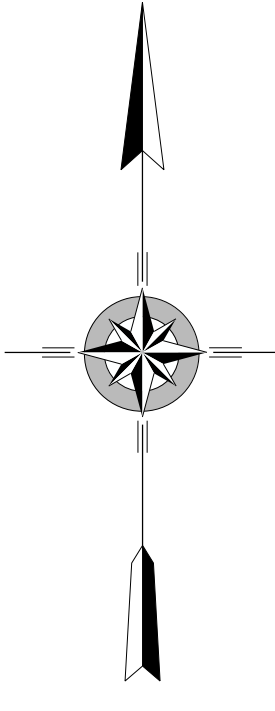
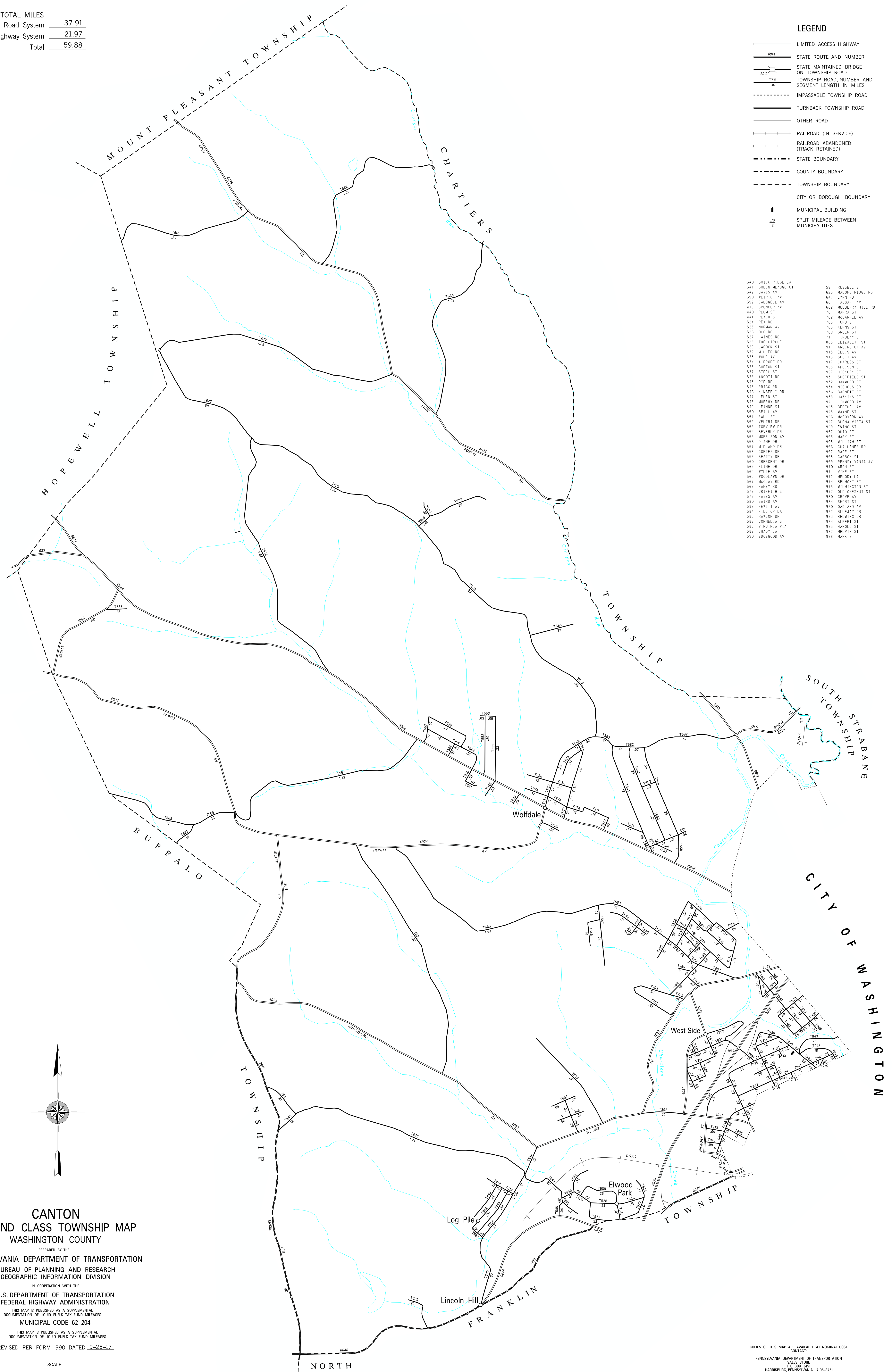

**CANTON**  
**SECOND CLASS TOWNSHIP MAP**  
**WASHINGTON COUNTY**  
 PREPARED BY THE  
**PENNSYLVANIA DEPARTMENT OF TRANSPORTATION**  
 BUREAU OF PLANNING AND RESEARCH  
 GEOGRAPHIC INFORMATION DIVISION  
 IN COOPERATION WITH THE  
**U.S. DEPARTMENT OF TRANSPORTATION**  
 FEDERAL HIGHWAY ADMINISTRATION  
 THIS MAP IS PUBLISHED AS A SUPPLEMENTAL  
 DOCUMENTATION OF LIQUID FUELS TAX FUND MILEAGES  
 MUNICIPAL CODE 62 204  
 THIS MAP IS PUBLISHED AS A SUPPLEMENTAL  
 DOCUMENTATION OF LIQUID FUELS TAX FUND MILEAGES  
 REVISED PER FORM 990 DATED 9-25-17.

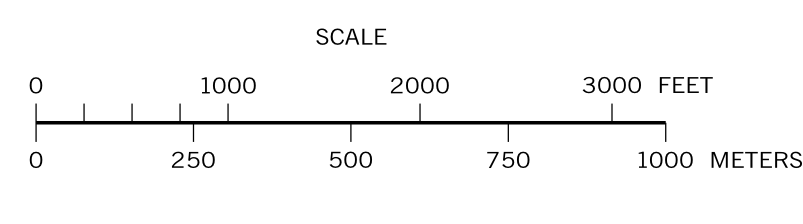

COPIES OF THIS MAP ARE AVAILABLE AT NOMINAL COST  
 CONTACT:  
 PENNSYLVANIA DEPARTMENT OF TRANSPORTATION  
 SALES STORE  
 P.O. BOX 3451  
 HARRISBURG, PENNSYLVANIA 17105-3451  
 TELEPHONE: (717) 787-6786