

POPULATION 5,652
(2010 Census)

TOTAL MILES	
Borough Road System	18.90
State Highway System	7.97
Total	26.87

LEGEND

- LIMITED ACCESS HIGHWAY
- STATE ROUTE AND NUMBER
- STATE MAINTAINED BRIDGE ON BOROUGH STREET
- BOROUGH STREET NAME AND SEGMENT LENGTH IN MILES
- TURNBACK BOROUGH STREET
- BOROUGH ALLEY
- OTHER ROAD
- RAILROAD
- STATE BOUNDARY
- COUNTY BOUNDARY
- TOWNSHIP BOUNDARY
- CITY BOUNDARY
- BOROUGH BOUNDARY
- MUNICIPAL BUILDING
- SPLIT MILEAGE BETWEEN MUNICIPALITIES
- SCHOOL, COLLEGE OR UNIVERSITY
- POINT OF INTEREST

- ADAMS CT
- ANDREWS CT
- ANTHRACITE ST
- ASH CT
- BAER CT
- BARBER ST
- BELLUS CT
- BENNETT ST
- BYRD ST
- CEDAR ST
- CHERRY DR
- CHESTNUT ST
- COLOGUE ST
- DONNAS WAY
- EAST PACKER AV
- FAIRWAY DR
- FIRST ST
- GRANT ST
- GROVE ST
- HARDING ST
- HARLAND ST
- HOLLY LA
- HOOVER ST
- HUNTERS CIR
- IDA CIR
- INDIAN CT
- JACKSON ST
- JEAN CIR
- JEAN ST
- JESSE ST
- KAUFMAN CT
- KEHN ST
- LAIRD CT
- LAIRD ST
- LAYTON ST
- LEHIGH ST
- LINCOLN CT
- LINCOLN ST
- MACKIN CT
- MARYS CIR
- MASON CT
- MASON ST
- MCCAULEY CT
- MCKINLEY ST
- MEMORIAL ST
- MINER ST
- MOSIER ST
- MOYER CT
- MUNDY CT
- ONEEPE AL
- OLD EXETER AV
- ORCHARD ST
- PARK LA
- PARK ST
- PEN AV
- PEPE CT
- PHIL CT
- PINE CT
- RED ASH CT
- ROOSEVELT ST
- SANOVIA ST
- SCARBORO AV
- SCHODLEY AV
- SHERMAN ST
- SILVER BELL DR
- STADIUM ST
- STEPHENS LA
- STURMER ST
- SULLIVAN ST
- SUSQUEHANNA AV
- THOMAS ST
- TRAYOR ST
- TROBACK DR
- UNION ST
- VALLEY ST
- VENETZ ST
- WARSAW ST
- WASHINGTON ST
- WEST PACKER AV
- WHITLOCK ST
- WILKERN ST
- WILSON ST

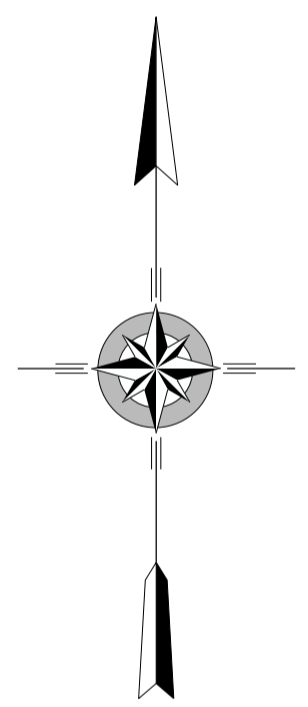
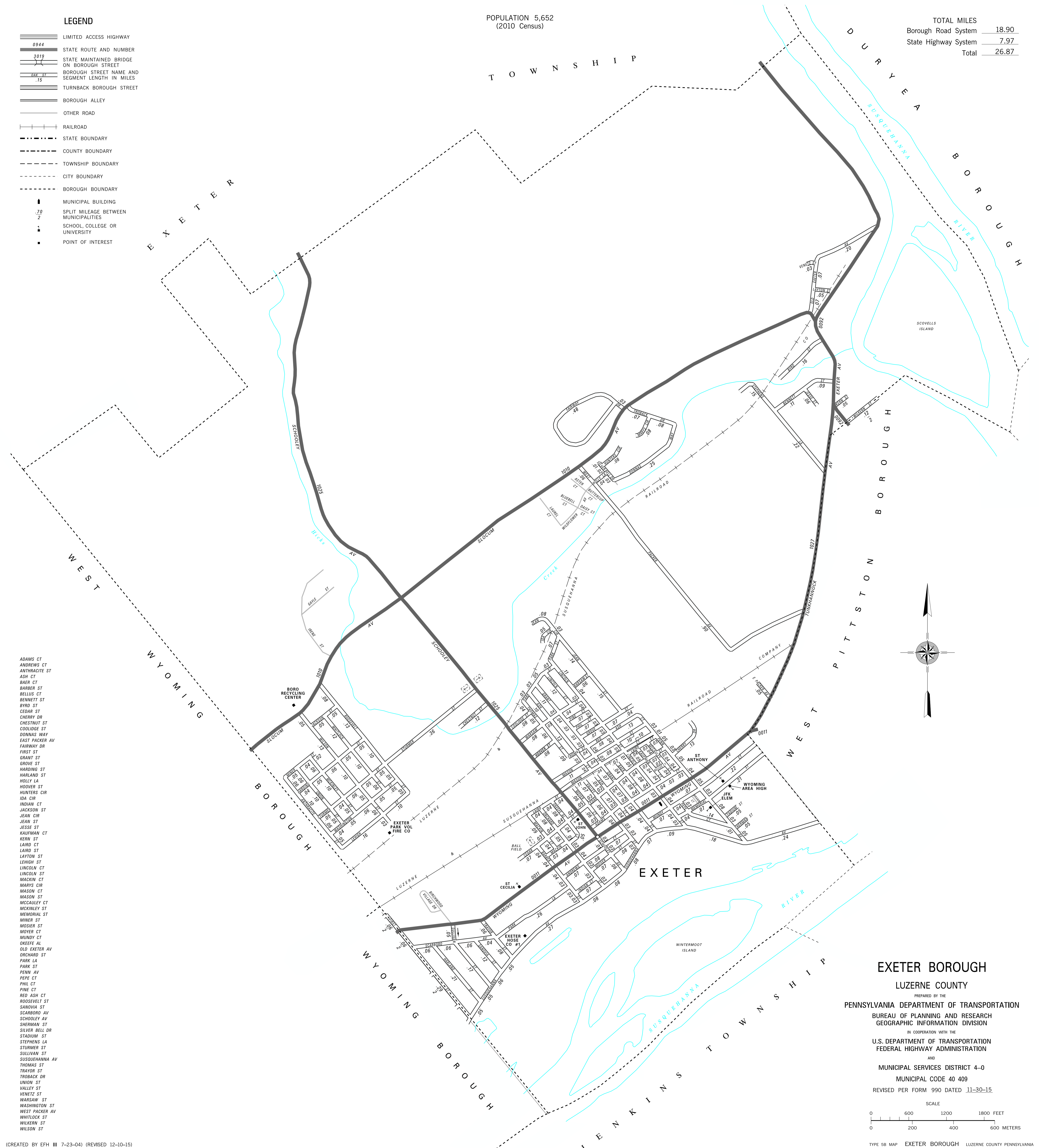

EXETER BOROUGH
LUZERNE COUNTY

PREPARED BY THE
PENNSYLVANIA DEPARTMENT OF TRANSPORTATION
BUREAU OF PLANNING AND RESEARCH
GEOGRAPHIC INFORMATION DIVISION
IN COOPERATION WITH THE
U.S. DEPARTMENT OF TRANSPORTATION
FEDERAL HIGHWAY ADMINISTRATION
AND
MUNICIPAL SERVICES DISTRICT 4-0
MUNICIPAL CODE 40 409
REVISED PER FORM 990 DATED 11-30-15

