

TOTAL MILES	
Township Road System	27.37
State Highway System	13.49
Total	40.86

- 393 YEAGER RD
- 395 SOUTH CHURCH RD
- 410 LAKE FRANCIS RD
- 458 GLEN SUMMIT SPUR
- 459 WOOD ST
- 460 PLEASANT VIEW DR
- 461 PONELL ST
- 462 ANNE ST
- 464 EDWARD ST
- 465 TERRACE DR
- 466 WOOD DR
- 467 ALBERT RD
- 469 DIVISION ST
- 470 HICKORY DR
- 471 OAK DR
- 472 SUNSET RD
- 473 SOUTH SUNSET RD
- 474 NORTH SUNSET RD
- 475 INDEPENDENCE RD
- 476 SEVATE DR
- 477 MAPLE DR
- 478 LAUREL DR
- 479 RED MAPLE AV
- 480 MAGNOLIA DR
- 481 SYCAMORE RD
- 482 RED MAPLE AVE SPUR
- 483 GLENDALE DR
- 484 FOREST DR
- 486 WALDEN DR
- 487 MYSTIC DR
- 488 HITCHING POST RD
- 489 PARK RD
- 490 WASHINGTON BLVD
- 491 MOUNTAIN RD
- 492 JEFFERSON DR
- 493 Foothill DR
- 494 YORKTOWN RD
- 495 RED COAT LA
- 499 OLD NORTH RD
- 500 REVERE RD
- 501 WASHINGTON PARK DR
- 502 JOAN DR
- 503 MORIO DR
- 504 KATHY DR
- 505 GREENWOOD HILLS DR
- 508 RENA DR
- 509 ANDOVER DR
- 510 ANDOVER DR
- 511 CONGRESS RD
- 512 CHARTER DR
- 513 COLONIAL DR
- 515 COURT ST
- 517 THOMAS DR
- 518 GARDNER LA
- 519 REBEL HILL RD
- 520 COLONELS RIDGE RD
- 521 BRANDYWYN DR
- 523 KEVIN DR
- 524 STEVEN DR
- 525 REGINA DR
- 526 FIRST AV
- 527 SECOND AV
- 528 ROCKLEDGE DR
- 529 TIMBERWOOD DR
- 530 MOUNTAINWOOD DR
- 531 WHITEHALL DR
- 532 FARM CT
- 533 DOE RUN TR
- 534 DEER RUN DR
- 536 BROOKFIELD WY
- 537 SPRING WILL RD
- 538 YEAGER AV
- 539 EAGLE RD
- 540 CHELSEY DR
- 541 STONEHALL CIR
- 542 STONE HEDGE PL
- 543 STONEY LA
- 544 STONE HEDGE CIR
- 546 ROBERTS DR
- 547 LEDGE DR
- 548 EVERGREEN LAKE DR
- 549 GROVE ST
- 550 THIRO AV
- 551 LAUREL RD
- 552 FERN DR
- 553 GRANDVIEW AV
- 554 MILL ST
- 555 COLONY DR
- 556 WESTBROOK DR
- 557 ELDE RD
- 578 BROOK HOLLOW RD
- 579 LARCHMONT WY
- 580 ORCHARDOVIEW LA
- 581 PHEASANT RUN LA
- 582 KESTREL RD
- 583 WERRANSER CT
- 584 VIREO DR
- 585 FINCH LA
- 586 TAYLOR CIR
- 587 EVERGREEN HILL DR

LEGEND

- LIMITED ACCESS HIGHWAY
- STATE ROUTE AND NUMBER ON TOWNSHIP ROAD
- TOWNSHIP ROAD, NUMBER AND SEGMENT LENGTH IN MILES
- IMPASSABLE TOWNSHIP ROAD
- OTHER ROAD
- RAILROAD (IN SERVICE)
- RAILROAD ABANDONED (TRACK RETAINED)
- STATE BOUNDARY
- COUNTY BOUNDARY
- TOWNSHIP BOUNDARY
- CITY OR BOROUGH BOUNDARY
- MUNICIPAL BUILDING
- SPLIT MILEAGE BETWEEN MUNICIPALITIES

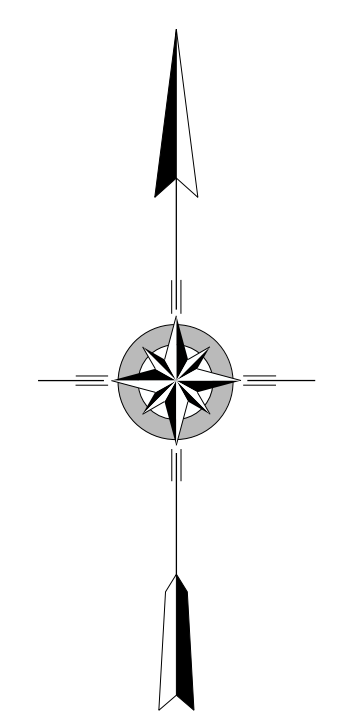
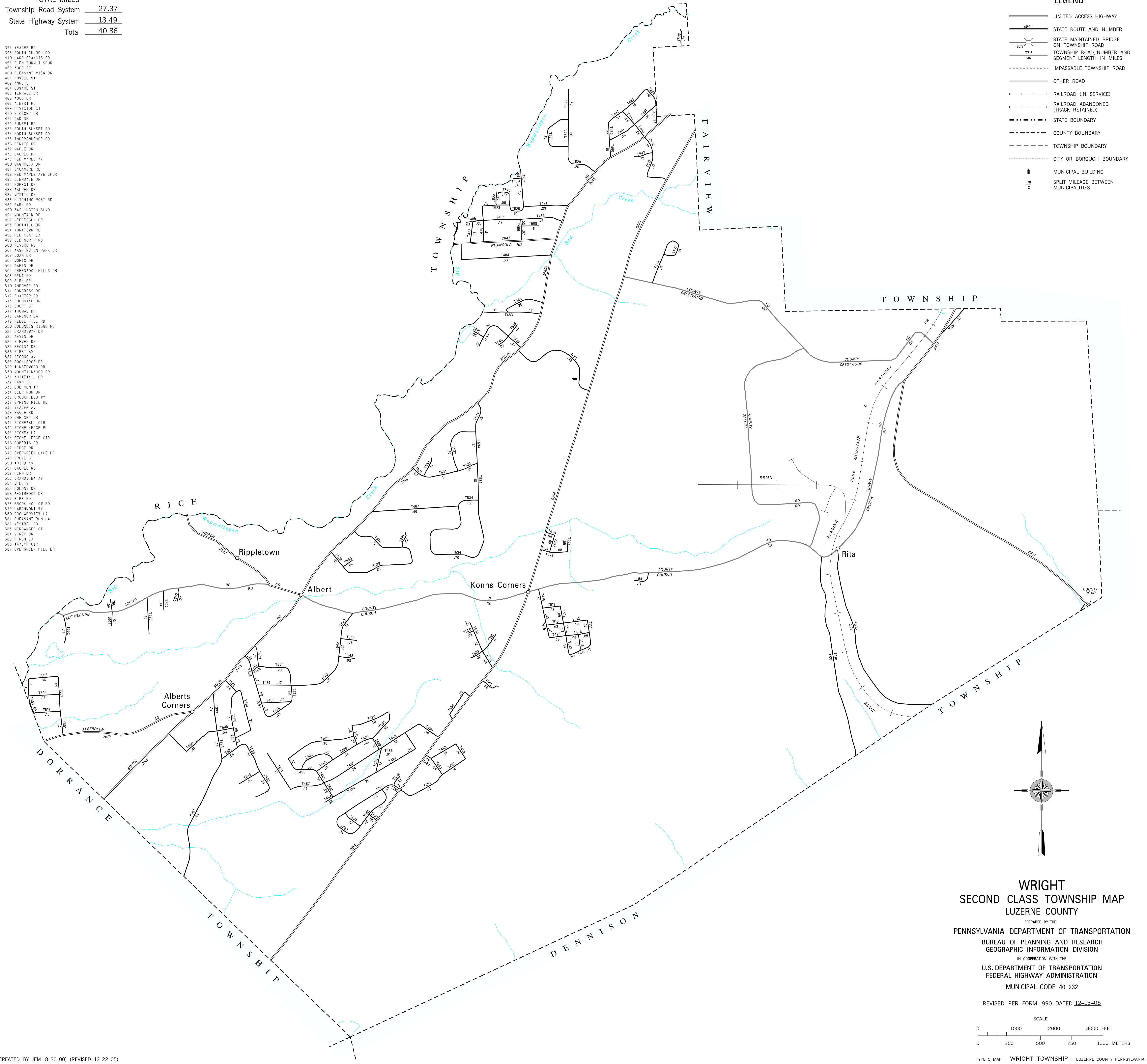

**WRIGHT
SECOND CLASS TOWNSHIP MAP
LUZERNE COUNTY**

PREPARED BY THE
PENNSYLVANIA DEPARTMENT OF TRANSPORTATION
 BUREAU OF PLANNING AND RESEARCH
 GEOGRAPHIC INFORMATION DIVISION
 IN COOPERATION WITH THE
 U.S. DEPARTMENT OF TRANSPORTATION
 FEDERAL HIGHWAY ADMINISTRATION
 MUNICIPAL CODE 40 232

REVISED PER FORM 990 DATED 12-13-05

