

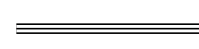

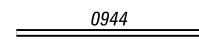

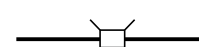
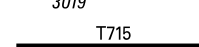
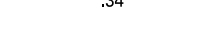

**LEGEND**

-  LIMITED ACCESS HIGHWAY
-  STATE ROUTE AND NUMBER
-  STATE MAINTAINED BRIDGE ON TOWNSHIP ROAD
-  TOWNSHIP ROAD, NUMBER AND SEGMENT LENGTH IN MILES
-  IMPASSABLE TOWNSHIP ROAD
-  OTHER ROAD
-  RAILROAD (IN SERVICE)
-  RAILROAD ABANDONED (TRACK RETAINED)
-  STATE BOUNDARY
-  COUNTY BOUNDARY
-  TOWNSHIP BOUNDARY
-  CITY OR BOROUGH BOUNDARY
-  MUNICIPAL BUILDING
-  SPLIT MILEAGE BETWEEN MUNICIPALITIES

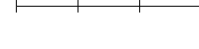
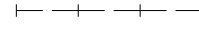
TOTAL MILES	
Township Road System	49.21*
State Highway System	14.45
Total	63.66

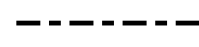
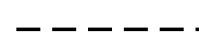
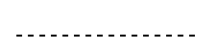
\* Includes ACT 32 Turnback Mileage of 14.27

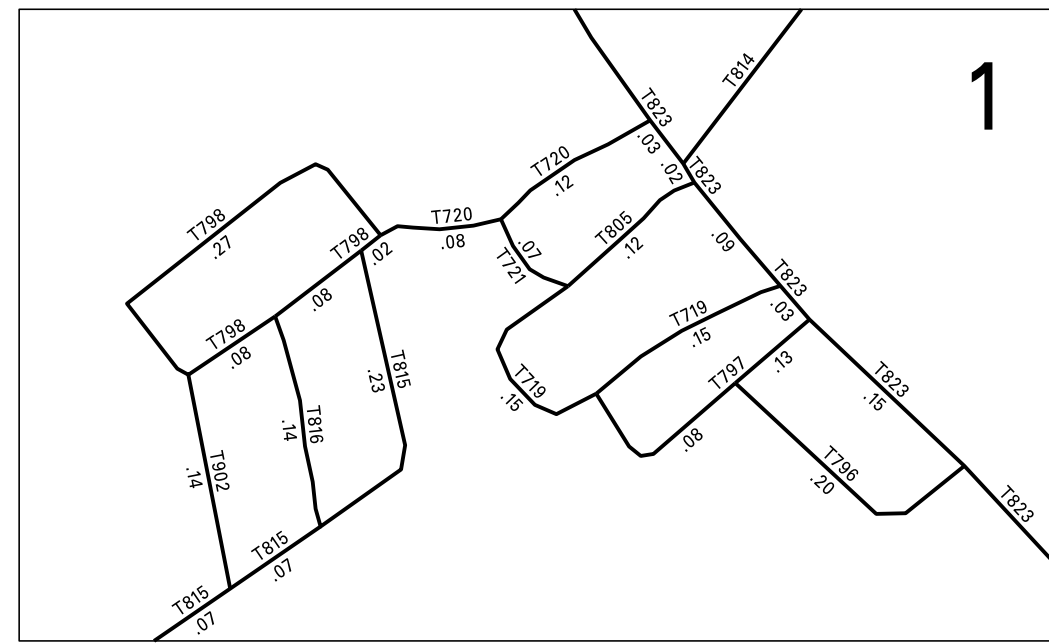

3:1

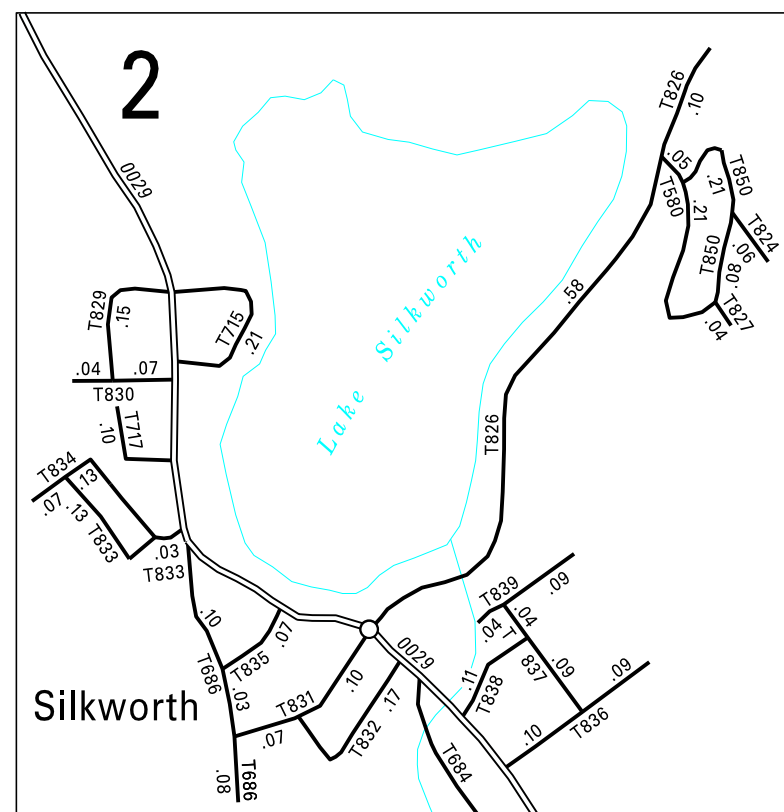

2:1

- 538 SWAMP RD
- 580 CEASE IER
- 583 SUTTON RD
- 585 TROKELL SWITCH RD
- 587 HAYFIELD RD
- 589 CHURCH RD
- 593 FERN RIDGE RD
- 597 PARK RD
- 676 SALT RD
- 682 SAWMILL RD
- 684 SATRE RD
- 686 JONES RD
- 700 MOUNTAIN VIEW DR
- 702 SMITH POND RD
- 704 DEER PARK RD
- 706 MARCHAKITUS RD
- 708 IDE RD
- 709 JUMPER RD
- 710 HOOVER RD
- 711 BRIARCREST RD
- 712 LOYALVILLE RD
- 713 BOYLE RD
- 715 VIRGINIA RD
- 716 CROOP RD
- 717 PEARL ST
- 718 CROSSEN RD
- 719 LAUREL DR
- 720 OAK DR
- 721 PARK DR
- 795 OLD ROUTE 115 RD
- 796 SUNSET DR
- 797 MAPLE DR
- 798 HILLTOP DR
- 799 TROJAN RD
- 800 WILL ST
- 801 FIREHOUSE RD
- 802 SLOCUM RD
- 803 CORNELL RD
- 805 YINE ST
- 807 THORNY APPLE DR
- 808 ROARING BROOK RD
- 809 FEDOR RD
- 810 LOYALVILLE RD
- 811 WEEKER RD
- 812 JACKSON RD
- 813 MARKET ST
- 814 FORTY SECOND ST
- 815 HEMLOCK DR
- 816 PINE ST
- 817 GREENWICH RD
- 818 LASALLE AV
- 819 AUBURN DR
- 820 PINE DR
- 821 WALNUTWOOD DR
- 822 HUNTSVILLE-IDETOWN RD
- 823 IDETOWN RD
- 824 EAST AV
- 825 PEACEFUL VALLEY RD
- 826 LAKESIDE DR
- 827 WEST AV
- 828 GOLF COURSE RD
- 829 GOODWIN DR
- 830 LAKE AV
- 831 ROBERTS ST
- 832 CAROL ST
- 833 COOK ST
- 834 SANDO ST
- 835 ELEANOR DR
- 836 SUMMIT RD
- 837 CEDAR RD
- 838 WILLOW RD
- 839 METROPOLITAN AV
- 840 CLEARVIEW DR
- 901 OUTLET RD
- 902 BIRCH ST
- 903 SARAH DR
- 904 YOLANDA DR
- 905 JAN DR
- 906 KARL DR

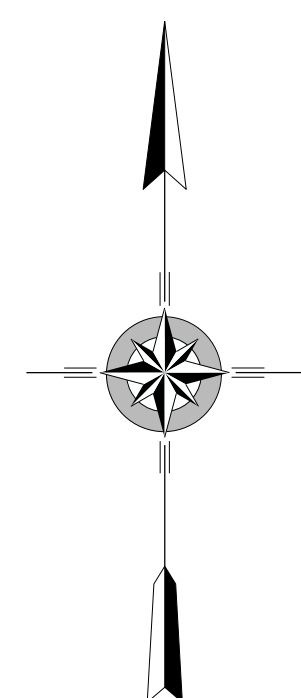
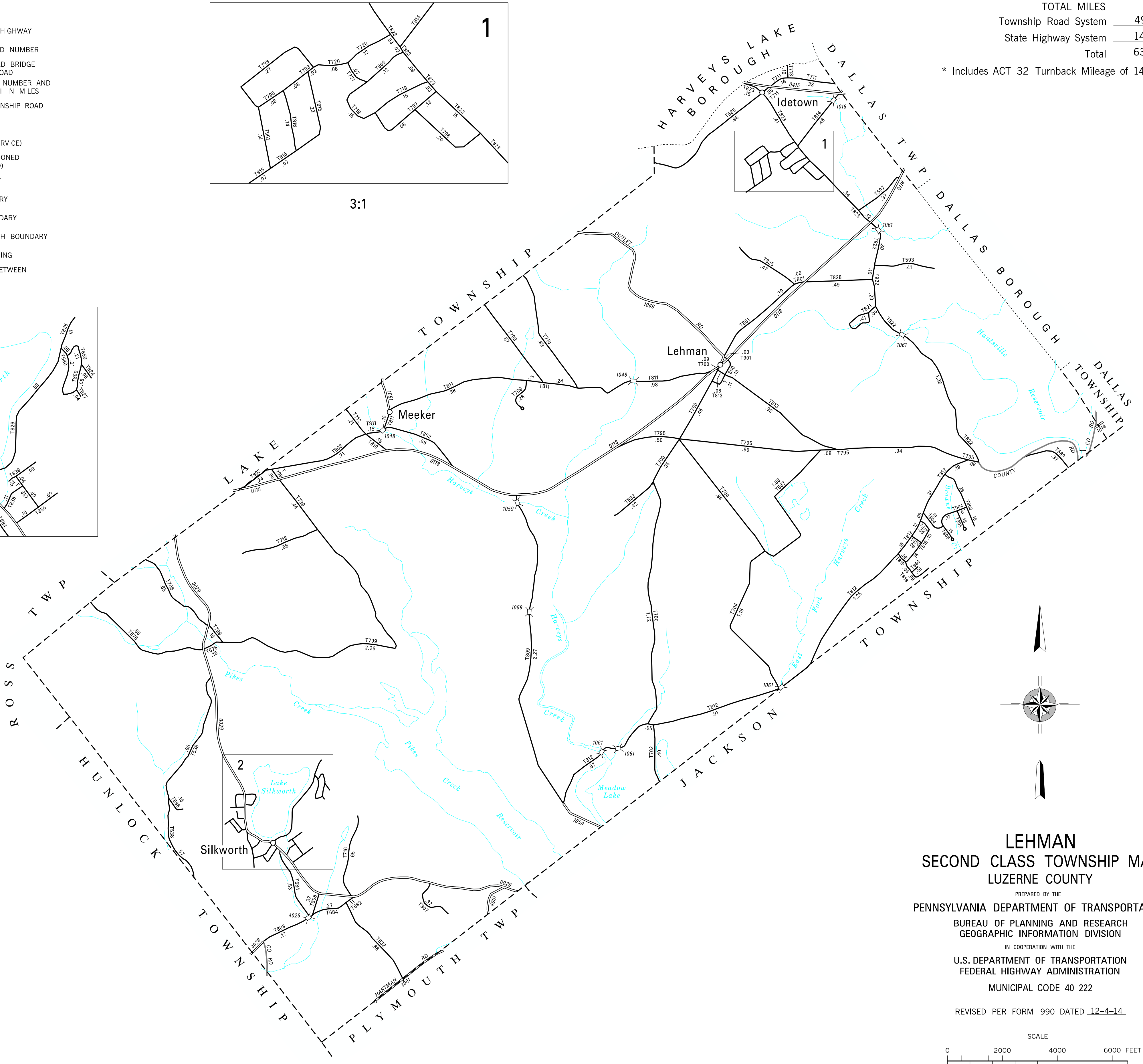

**LEHMAN  
SECOND CLASS TOWNSHIP MAP  
LUZERNE COUNTY**

PREPARED BY THE  
PENNSYLVANIA DEPARTMENT OF TRANSPORTATION  
BUREAU OF PLANNING AND RESEARCH  
GEOGRAPHIC INFORMATION DIVISION  
IN COOPERATION WITH THE  
U.S. DEPARTMENT OF TRANSPORTATION  
FEDERAL HIGHWAY ADMINISTRATION  
MUNICIPAL CODE 40 222

REVISED PER FORM 990 DATED 12-4-14

