

TOTAL MILES  
 Township Road System 73.18\*  
 State Highway System 25.50  
 Total 98.68

\* Includes ACT 32 Turnback Mileage of 4.10

- 309 WINE RD
- 313 JEFFERSON ST
- 316 SCHOOL RD
- 318 SPRAGGS RD
- 325 BOWLBY HILL RD
- 326 HUMMINGBIRD LA
- 328 STRAWN HILL RD
- 349 SHEPPARD RUN RD
- 351 THOMAS HILL RD
- 353 OLD CHURCH LA
- 355 SHARP RUN RD
- 365 WISE RUN RD
- 367 CALVERTS HILL RD
- 369 POWELL RIDGE RD
- 370 BILL EDDY HILL RD
- 371 KINGS SISTER HILL RD
- 373 RIDGE LA
- 377 TENNANT HILL RD
- 381 YEAGER RD
- 405 KIRBY HILL RD
- 427 JAY PHILLIPS HILL RD
- 428 DEER VALLEY RD
- 429 BULLDOG RUN RD
- 450 HOY HILL RD
- 451 OLD SCALE RD
- 452 LOG CABIN RD
- 454 SILD RD
- 468 MORRIS RUN RD
- 470 EDDYS RUN RD
- 472 BELL RUN RD
- 474 PHILLIPS RIDGE RD
- 475 KINGWOOD RD
- 476 MAPLE RUN RD
- 488 WRIGHTS RUN RD
- 490 RUSH RUN RD
- 491 CALICO RUN RD
- 492 STEWART RUN RD
- 493 ELLIS LA
- 514 HUNNEL LA
- 518 GOODWIN HILL RD
- 520 MOORE LA
- 523 FORNEY HOLLOW RD
- 524 DRIFT RIDGE RD
- 525 HILLSIDE LA
- 717 TUSTIN RUN RD
- 723 SIGBEE ST
- 724 HOOVERS RUN RD
- 725 FUNSTON AV
- 726 HOBSTON ST
- 727 LEE AV
- 728 PHILLIPS RD
- 730 WHEELER AV
- 731 CEMETERY ST
- 732 DENEY AV
- 733 FREEDOM ST
- 734 CHESTNUT ST
- 735 ORCHARD AV
- 736 ELKS AL
- 737 NO NAME RD
- 738 LANTZ AL
- 739 MAPLE AL
- 741 WALNUT ST
- 743 OAK ST
- 848 FULLER RD

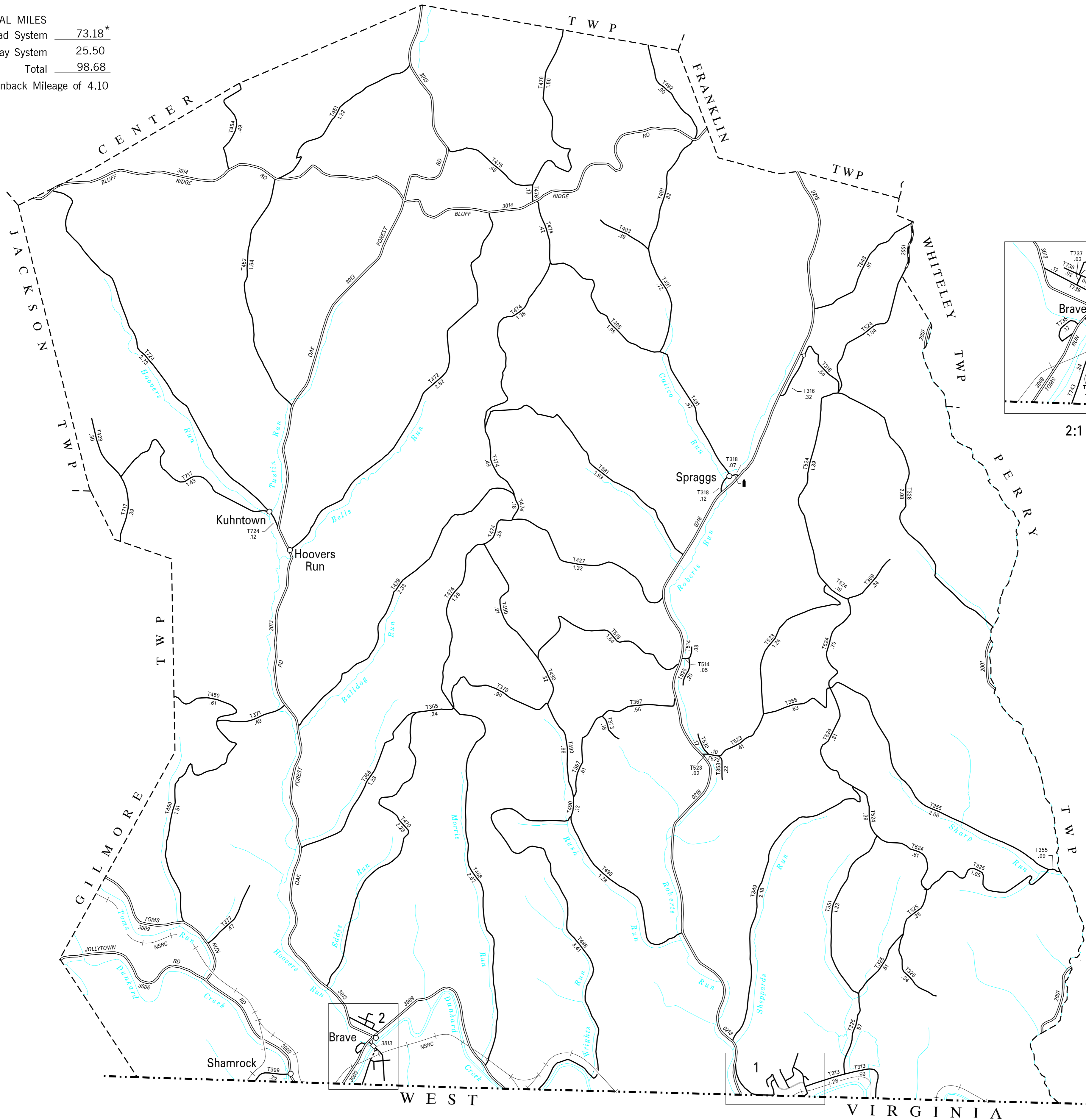

LEGEND

- LIMITED ACCESS HIGHWAY
- STATE ROUTE AND NUMBER
- STATE MAINTAINED BRIDGE ON TOWNSHIP ROAD
- TOWNSHIP ROAD, NUMBER AND SEGMENT LENGTH IN MILES
- IMPASSABLE TOWNSHIP ROAD
- OTHER ROAD
- RAILROAD (IN SERVICE)
- RAILROAD ABANDONED (TRACK RETAINED)
- STATE BOUNDARY
- TOWNSHIP BOUNDARY
- CITY OR BOROUGH BOUNDARY
- MUNICIPAL BUILDING
- SPLIT MILEAGE BETWEEN MUNICIPALITIES

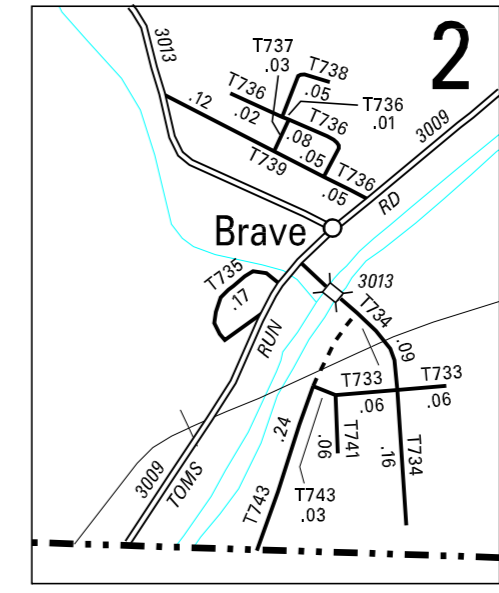

2:1

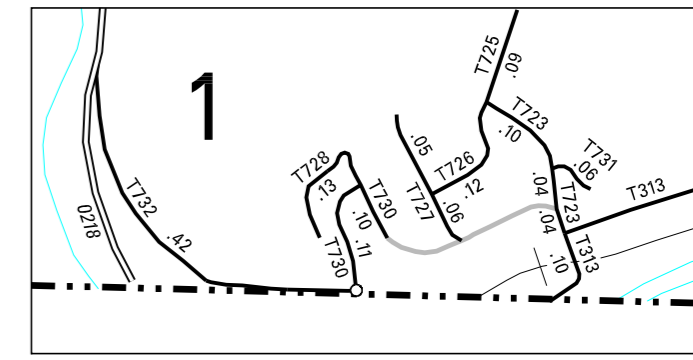

2:1

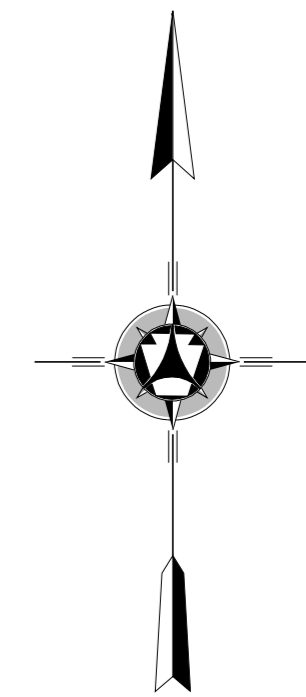

WAYNE  
 SECOND CLASS TOWNSHIP MAP  
 GREENE COUNTY

PREPARED BY THE  
 PENNSYLVANIA DEPARTMENT OF TRANSPORTATION  
 BUREAU OF PLANNING AND RESEARCH  
 GEOGRAPHIC INFORMATION DIVISION  
 IN COOPERATION WITH THE  
 U.S. DEPARTMENT OF TRANSPORTATION  
 FEDERAL HIGHWAY ADMINISTRATION  
 MUNICIPAL CODE 30 219

REVISED PER FORM 990 DATED 7-13-98

