

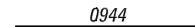

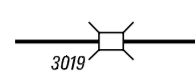

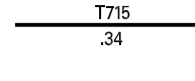





LEGEND

-  LIMITED ACCESS HIGHWAY
-  STATE ROUTE AND NUMBER
-  STATE MAINTAINED BRIDGE ON TOWNSHIP ROAD
-  TOWNSHIP ROAD, NUMBER AND SEGMENT LENGTH IN MILES
-  IMPASSABLE TOWNSHIP ROAD
-  OTHER ROAD
-  RAILROAD (IN SERVICE)
-  RAILROAD ABANDONED (TRACK RETAINED)
-  STATE BOUNDARY
-  COUNTY BOUNDARY
-  TOWNSHIP BOUNDARY
-  CITY OR BOROUGH BOUNDARY
-  MUNICIPAL BUILDING
-  SPLIT MILEAGE BETWEEN MUNICIPALITIES

TOTAL MILES	
Township Road System	20.35*
State Highway System	23.69
Total	44.04

* Includes ACT 32 Turnback Mileage of 0.10

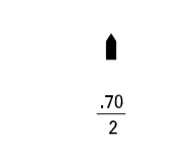
- 359 BEAL RD
- 360 WARWICK ST
- 361 MAIN (POLAND MINES) ST
- 362 MAIN ST
- 363 THIRD ST
- 365 THIRD ST
- 367 FIRST ST
- 369 SECOND ST
- 370 FIRST (SANDY RUN) ST
- 371 UPPER SANDY RD
- 372 DORA VILLAGE MAIN ST
- 373 DORA LA
- 374 SEVENTH POOL RD
- 376 SET STILL RD
- 380 NO NAME
- 393 DONHAM RD
- 394 ALICIA MAIN ST
- 395 LOCK RD
- 397 FIELD ST
- 401 MAPLE ST
- 402 ROSEDALE ST
- 403 BARGERSTON HOLLOW RD
- 405 WATER ST
- 411 CREEK RD
- 413 KIGER RD
- 416 COLVIN RD
- 418 FORD ST
- 419 MABEL HILL RD
- 420 BROWN ST
- 421 CHEVY ST
- 423 ROSE ST
- 424 TULIP DR
- 425 SHUBERT RD
- 501 KOIS RD
- 502 FIELDSON RD
- 503 LESLIE RD
- 505 HILLMAN ST
- 508 MEDICAL CENTER LA
- 509 ALLISON ST
- 510 FIRST ST
- 515 ROBENA RD
- 678 TURKEY KNOB RD
- 681 LOWER SANDY RD
- 688 HARTLEY RD
- 704 KOVACH RD
- 706 SIGSBEE RD
- 708 MAPLE RIDGE RD
- 710 CHESS MINE RD
- 739 DUNKARD ST
- 740 SUGAR GROVE RD
- 741 FIRST AV
- 743 OLD ROUTE 21 RD
- 745 SECOND ST
- 747 FORTH ST
- 749 FIFTH ST

* ENTIRE MILEAGE PAID TO GREENE TWP PER TURNBACK AGREEMENT.

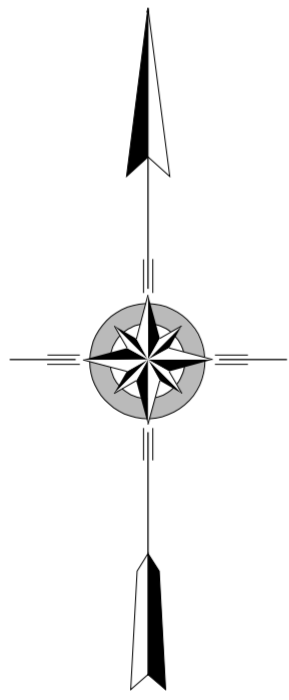
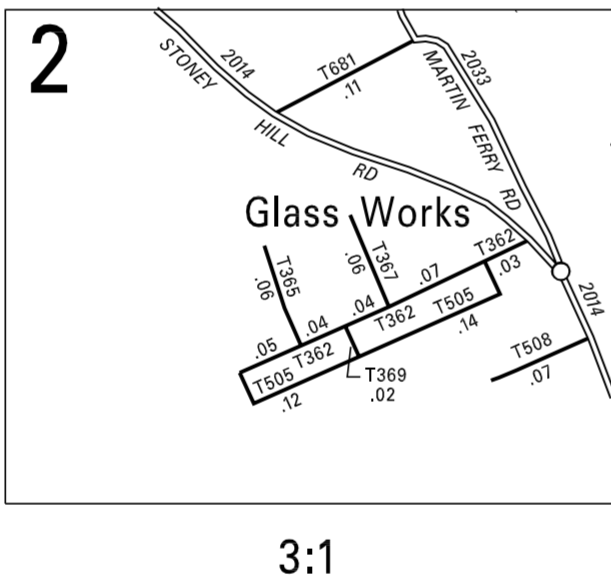

**MONONGAHELA
SECOND CLASS TOWNSHIP MAP
GREENE COUNTY**

PREPARED BY THE
PENNSYLVANIA DEPARTMENT OF TRANSPORTATION

BUREAU OF PLANNING AND RESEARCH
GEOGRAPHIC INFORMATION DIVISION

IN COOPERATION WITH THE

U.S. DEPARTMENT OF TRANSPORTATION
FEDERAL HIGHWAY ADMINISTRATION

MUNICIPAL CODE 30 212

REVISED PER FORM 990 DATED 10-16-06

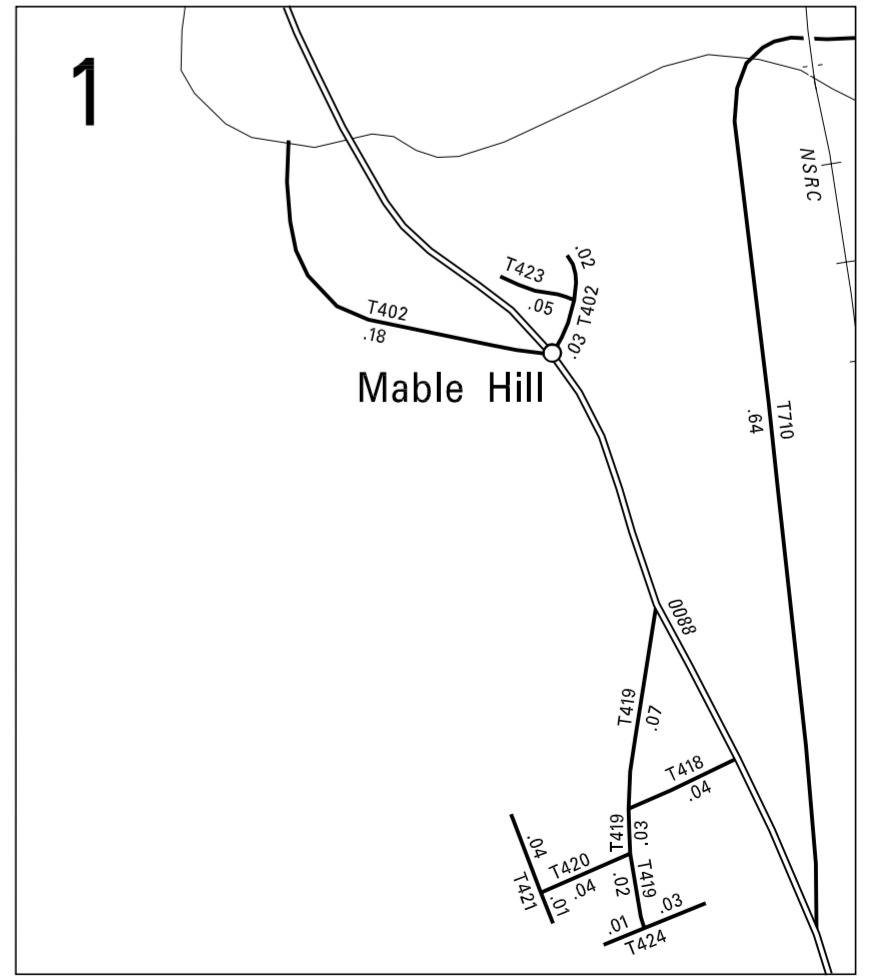
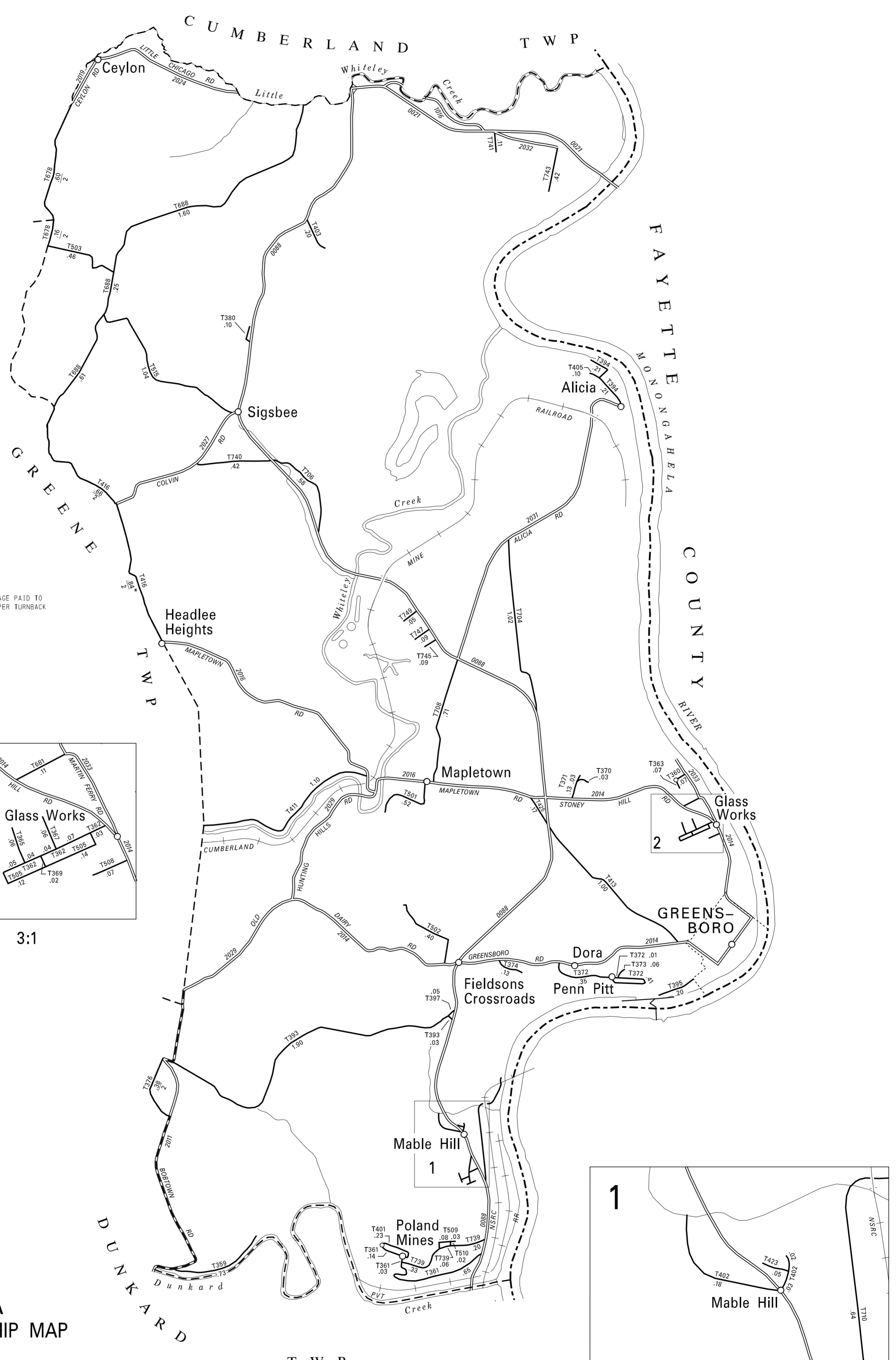
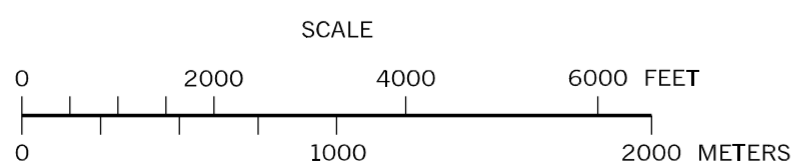

4:1