

**LEGEND**

- LIMITED ACCESS HIGHWAY
- STATE ROUTE AND NUMBER
- STATE MAINTAINED BRIDGE ON TOWNSHIP ROAD
- TOWNSHIP ROAD, NUMBER AND SEGMENT LENGTH IN MILES
- IMPASSABLE TOWNSHIP ROAD
- OTHER ROAD
- RAILROAD (IN SERVICE)
- RAILROAD ABANDONED (TRACK RETAINED)
- STATE BOUNDARY
- COUNTY BOUNDARY
- TOWNSHIP BOUNDARY
- CITY OR BOROUGH BOUNDARY
- MUNICIPAL BUILDING
- SPLIT MILEAGE BETWEEN MUNICIPALITIES

- |                      |                          |                          |
|----------------------|--------------------------|--------------------------|
| 321 KRYDER RD        | 360 DAVY RD              | 540 STERLING ST          |
| 322 ISLAND RD        | 361 SPRUCE RUN RD        | 541 CEDAR HEIGHTS ST     |
| 350 MILL ST          | 362 WETZEL RD            | 547 YOUNGS ADDITION RD   |
| 351 SOUTH MALLARD ST | 363 NITTANY RIDGE RD     | 551 JONES RD             |
| 352 DUCK RUN RD      | 364 HAVEN PINES RD       | 552 SOUTH HECKMAN GAP RD |
| 353 BEAGLE RD        | 365 EISENHOWER CROSSROAD | 554 NORTH MALLARD ST     |
| 354 RAG VALLEY RD    | 366 BURRELL RD           | 555 SHORTWAY RD          |
| 355 DUNKLE RD        | 368 STOVERS CROSSROAD    | 558 BELLE SPRINGS RD     |
| 356 HECKMAN GAP RD   | 522 HILL ST              | 560 EMERALD ST           |
| 357 RIDGE RD         | 538 FERNBERG RD          | 581 ASHLAND ST           |
| 358 AIR STRIP DR     | 539 LIZARDVILLE RD       | 582 EAST HAVEN PINES RD  |

|                      |              |
|----------------------|--------------|
| TOTAL MILES          |              |
| Township Road System | 27.56*       |
| State Highway System | 29.33        |
| <b>Total</b>         | <b>56.91</b> |

\* Includes ACT 32 Turnback Mileage of 0.47

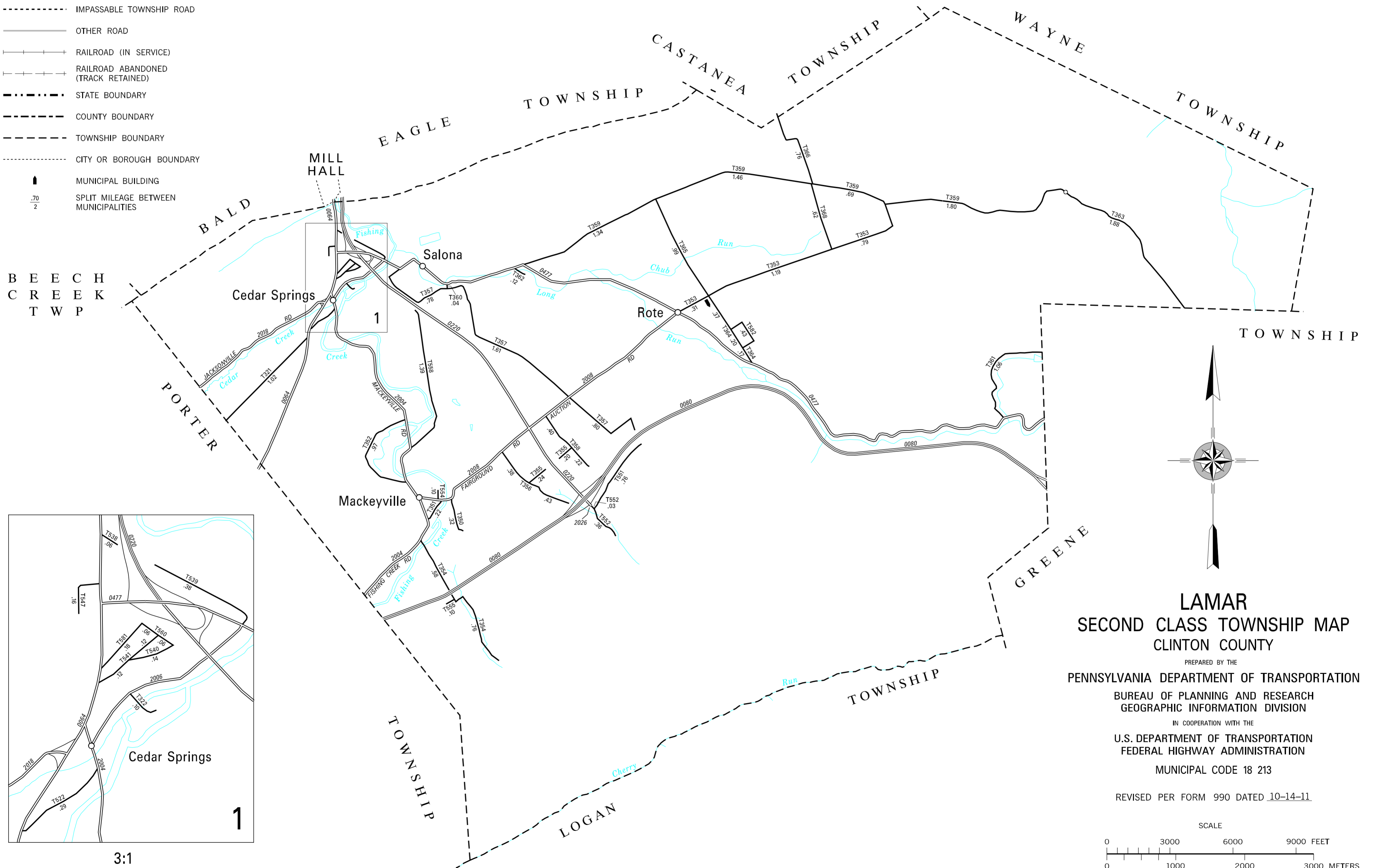

B E E C H  
C R E E K  
T W P

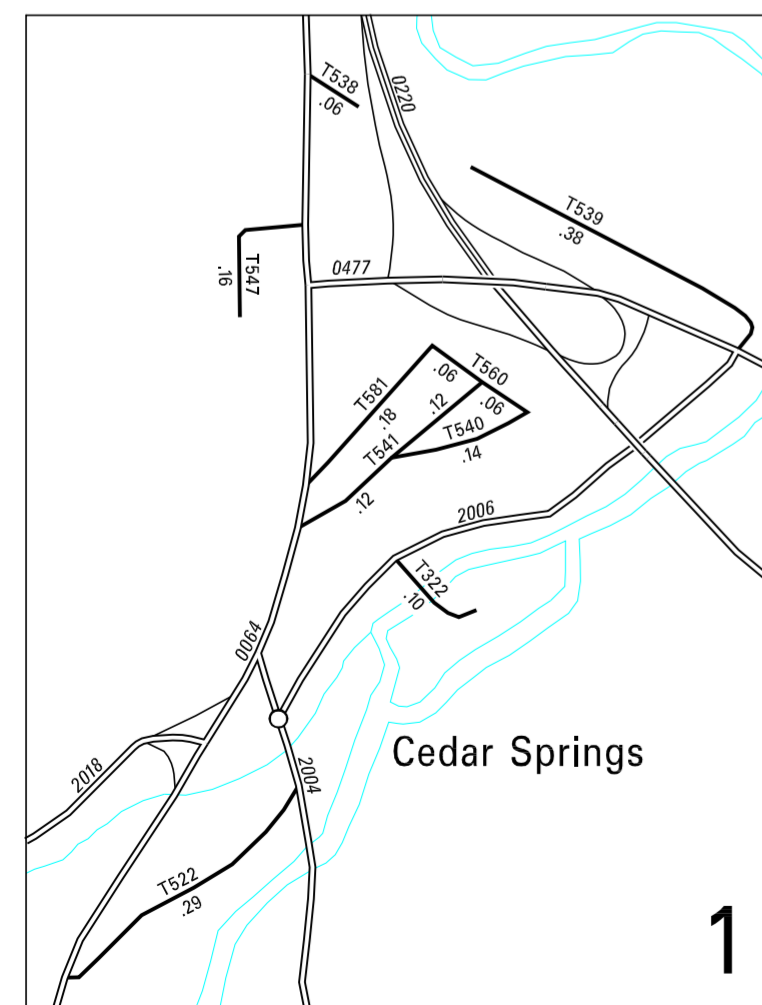

3:1

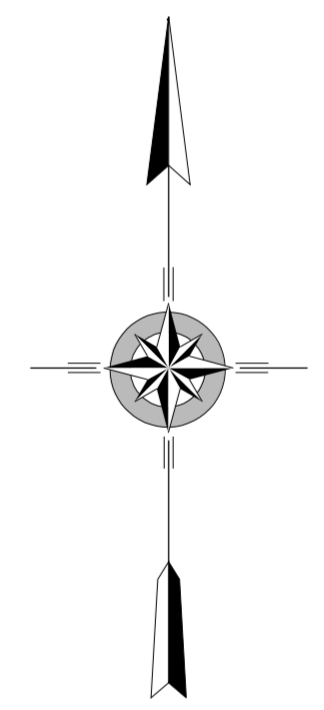

**LAMAR**  
**SECOND CLASS TOWNSHIP MAP**  
**CLINTON COUNTY**

PREPARED BY THE  
**PENNSYLVANIA DEPARTMENT OF TRANSPORTATION**  
BUREAU OF PLANNING AND RESEARCH  
GEOGRAPHIC INFORMATION DIVISION  
IN COOPERATION WITH THE  
**U.S. DEPARTMENT OF TRANSPORTATION**  
FEDERAL HIGHWAY ADMINISTRATION  
MUNICIPAL CODE 18 213

REVISED PER FORM 990 DATED 10-14-11

