

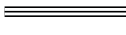

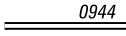

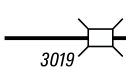

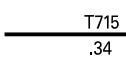
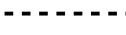

TOTAL MILES	
Township Road System	20.87*
State Highway System	20.49
Total	41.36

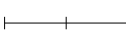
* Includes ACT 32 Turnback Mileage of 1.62

LEGEND

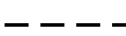
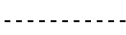
-  LIMITED ACCESS HIGHWAY
-  STATE ROUTE AND NUMBER
-  STATE MAINTAINED BRIDGE ON TOWNSHIP ROAD
-  TOWNSHIP ROAD, NUMBER AND SEGMENT LENGTH IN MILES
-  IMPASSABLE TOWNSHIP ROAD
-  OTHER ROAD
-  RAILROAD (IN SERVICE)
-  RAILROAD ABANDONED (TRACK RETAINED)
-  STATE BOUNDARY
-  COUNTY BOUNDARY
-  TOWNSHIP BOUNDARY
-  CITY OR BOROUGH BOUNDARY
-  MUNICIPAL BUILDING
-  SPLIT MILEAGE BETWEEN MUNICIPALITIES

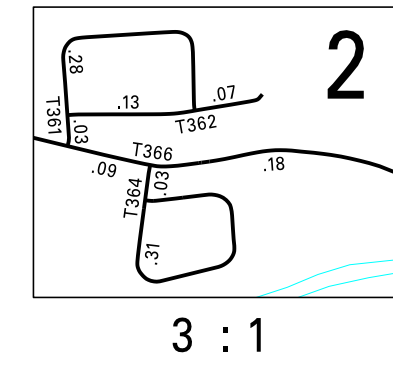
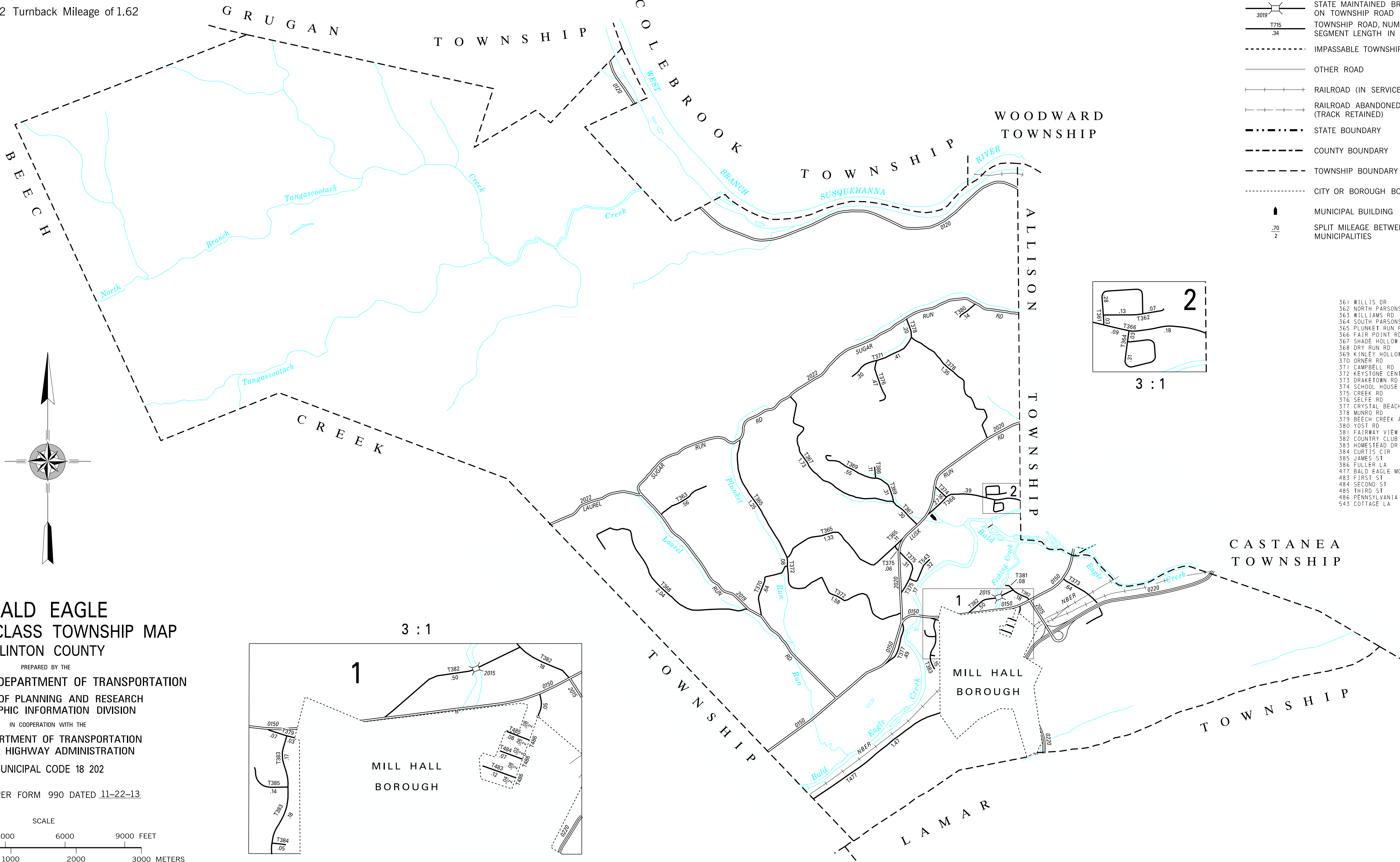

- 361 WILLIS DR
- 362 NORTH PARSONS DR
- 363 WILLIAMS RD
- 364 SOUTH PARSONS DR
- 365 PLUNKET RUN RD
- 366 FAIR POINT RD
- 367 SHADE HOLLOW RD
- 368 DRY RUN RD
- 369 KINLEY HOLLOW RD
- 370 ORNER RD
- 371 CAMPBELL RD
- 372 KEYSTONE CENTRAL DR
- 373 DRAKETOWN RD
- 374 SCHOOL HOUSE RD
- 375 CREEK RD
- 376 SELFE RD
- 377 CRYSTAL BEACH RD
- 378 MUNRO RD
- 379 BEECH CREEK AV
- 380 YOST RD
- 381 FAIRWAY VIEW DR
- 382 COUNTRY CLUB LA
- 383 HOMESTEAD DR
- 384 CURTIS CIR
- 385 JAMES ST
- 386 FULLER LA
- 477 BALD EAGLE MOUNTAIN RD
- 483 FIRST ST
- 484 SECOND ST
- 485 THIRD ST
- 486 PENNSYLVANIA AV
- 543 COTTAGE LA

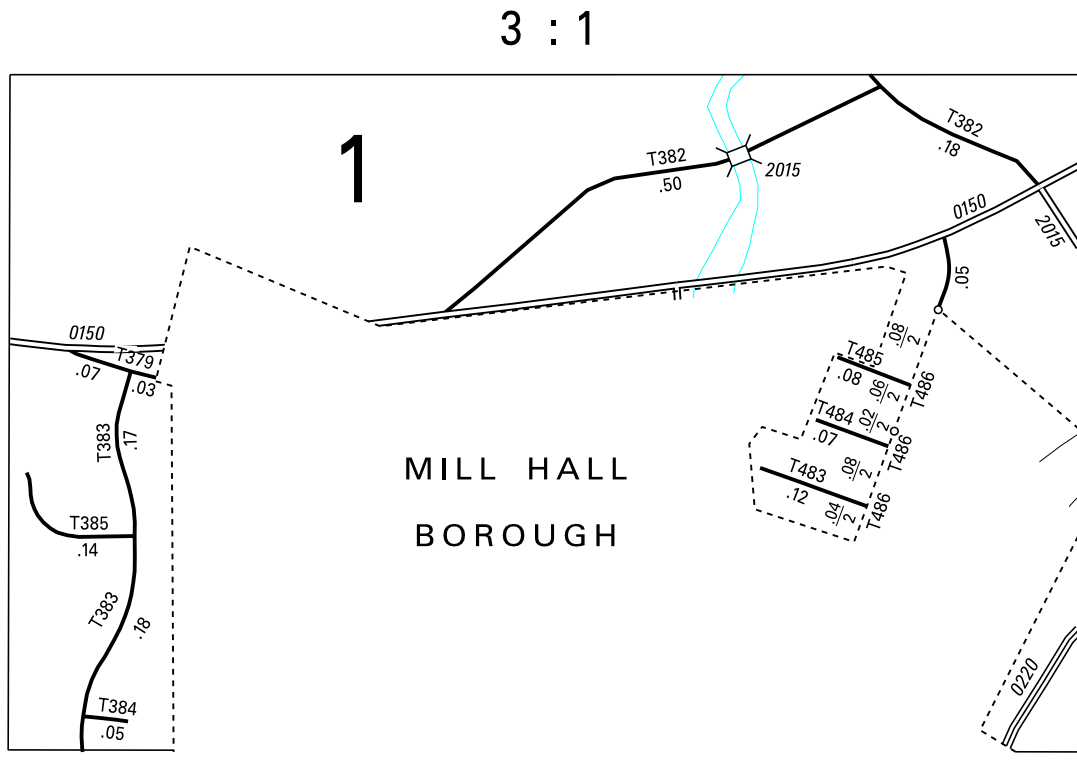

**BALD EAGLE
SECOND CLASS TOWNSHIP MAP
CLINTON COUNTY**

PREPARED BY THE
PENNSYLVANIA DEPARTMENT OF TRANSPORTATION
BUREAU OF PLANNING AND RESEARCH
GEOGRAPHIC INFORMATION DIVISION
IN COOPERATION WITH THE
U.S. DEPARTMENT OF TRANSPORTATION
FEDERAL HIGHWAY ADMINISTRATION
MUNICIPAL CODE 18 202
REVISED PER FORM 990 DATED 11-22-13

