

TOTAL MILES
 Township Road System 60.20*
 State Highway System 31.36
 Total 91.56
 * Includes ACT 32 Turnback Mileage of .53

LEGEND

- LIMITED ACCESS HIGHWAY
- STATE ROUTE AND NUMBER
- STATE MAINTAINED BRIDGE ON TOWNSHIP ROAD
- TOWNSHIP ROAD, NUMBER AND SEGMENT LENGTH IN MILES
- IMPASSABLE TOWNSHIP ROAD
- TURNBACK TOWNSHIP ROAD
- OTHER ROAD
- RAILROAD (IN SERVICE)
- RAILROAD ABANDONED (TRACK RETAINED)
- STATE BOUNDARY
- COUNTY BOUNDARY
- TOWNSHIP BOUNDARY
- CITY OR BOROUGH BOUNDARY
- MUNICIPAL BUILDING
- SPLIT MILEAGE BETWEEN MUNICIPALITIES

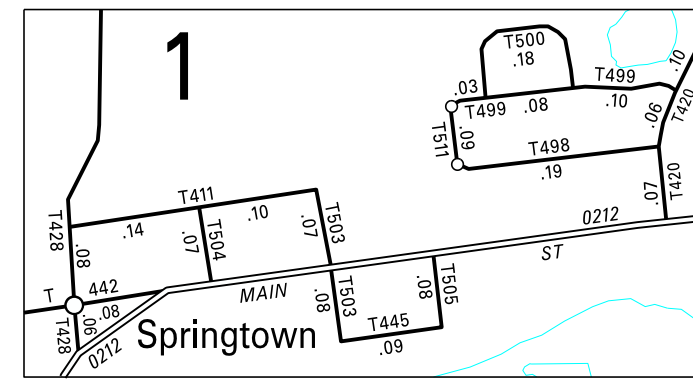

2:1

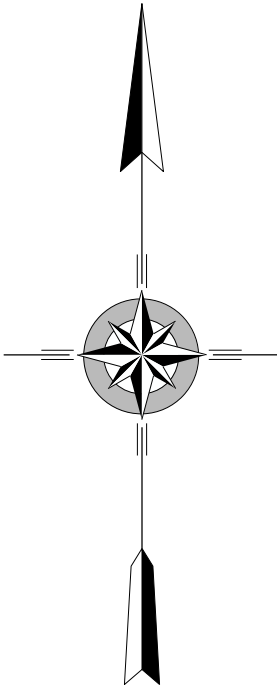

- | | |
|------------------------|------------------------|
| 354 ALLISON RD | 485 TOWNSHIP RD |
| 368 SALEM RD | 487 PARKLAND RD |
| 370 CROWTHERS RD | 489 PEPPERMINT RD |
| 391 DEER TRAIL RD | 491 HIGHPOINT RD |
| 392 GROSS RD | 493 FUNKS MILL RD |
| 393 TUMBLEBROOK RD | 495 MARTINS LA |
| 400 MOYER RD | 497 DOGWOOD RD |
| 401 BLUE CHURCH RD | 498 MOUNTAIN AV |
| 402 BANKO RD | 499 GREENWOOD DR |
| 403 BOODER RD | 500 LAKEVIEW DR |
| 404 SHALE RD | 501 HAYCOCK RUN RD |
| 405 BURSONVILLE RD | 502 COUNTY LINE RD |
| 406 BRIDGE ST | 503 CENTER ST |
| 407 CHESTNUT RD | 504 CHAPEL ST |
| 408 CHURCH RD | 505 MILL ST |
| 409 CLAY AV | 507 CARLTON RD |
| 410 CHERRY RD | 508 ALLAN DR |
| 411 CHURCH ST | 509 HIGHLAND LA |
| 412 COOKS CREEK RD | 511 SPRING HILL DR |
| 413 EBERT RD | 512 TROLLEY BRIDGE CIR |
| 414 GRUVERSVILLE RD | 514 CUT-OFF RD |
| 415 GROUSE LA | 515 SONNY LA |
| 416 WOODCOCK LA | 516 FREEH LA |
| 417 HICKORY LA | 517 HUNTER RD |
| 418 SPRINGHOUSE RD | 518 KEYSTONE RD |
| 419 HAUPTS BRIDGE RD | 519 HIGH MEADOW RD |
| 420 DRIFTING DR | 520 SHIRLEY LA |
| 421 HOTTLE RD | 521 JAKES PL |
| 423 SPRINGFIELD ST | 522 WOODBINE RD |
| 424 MAPLE RD | 523 HAWK RD |
| 425 KNECHTS BRIDGE RD | 524 EVERGREEN RD |
| 426 BERGER RD | |
| 427 KUNSMAN RD | |
| 428 LOWER SAUCON RD | |
| 429 MINE RD | |
| 430 MAGARREE LA | |
| 431 MINK RD | |
| 432 NEMETH RD | |
| 433 GLEN GARRIF LA | |
| 434 OAK LA | |
| 435 PLEASANT VIEW RD | |
| 436 PASSER RD | |
| 437 PLEASANT HOLLOW RD | |
| 438 FOVENSKI RD | |
| 439 QUARRY RD | |
| 440 ROCKY VALLEY RD | |
| 441 REED LA | |
| 442 SPRINGTOWN RD | |
| 443 SIDE LINE RD | |
| 444 TROLLEY BRIDGE RD | |
| 445 WALNUT ST | |
| 446 WALNUT LA | |
| 447 HILLTOP RD | |
| 448 WRECSICS RD | |
| 471 HICKON RD | |
| 475 ROUND HOUSE RD | |
| 477 WINDING RD | |
| 480 BUCKRAMPHM RD | |
| 483 SCHOOL RD | |
| 484 KELLERS RD | |

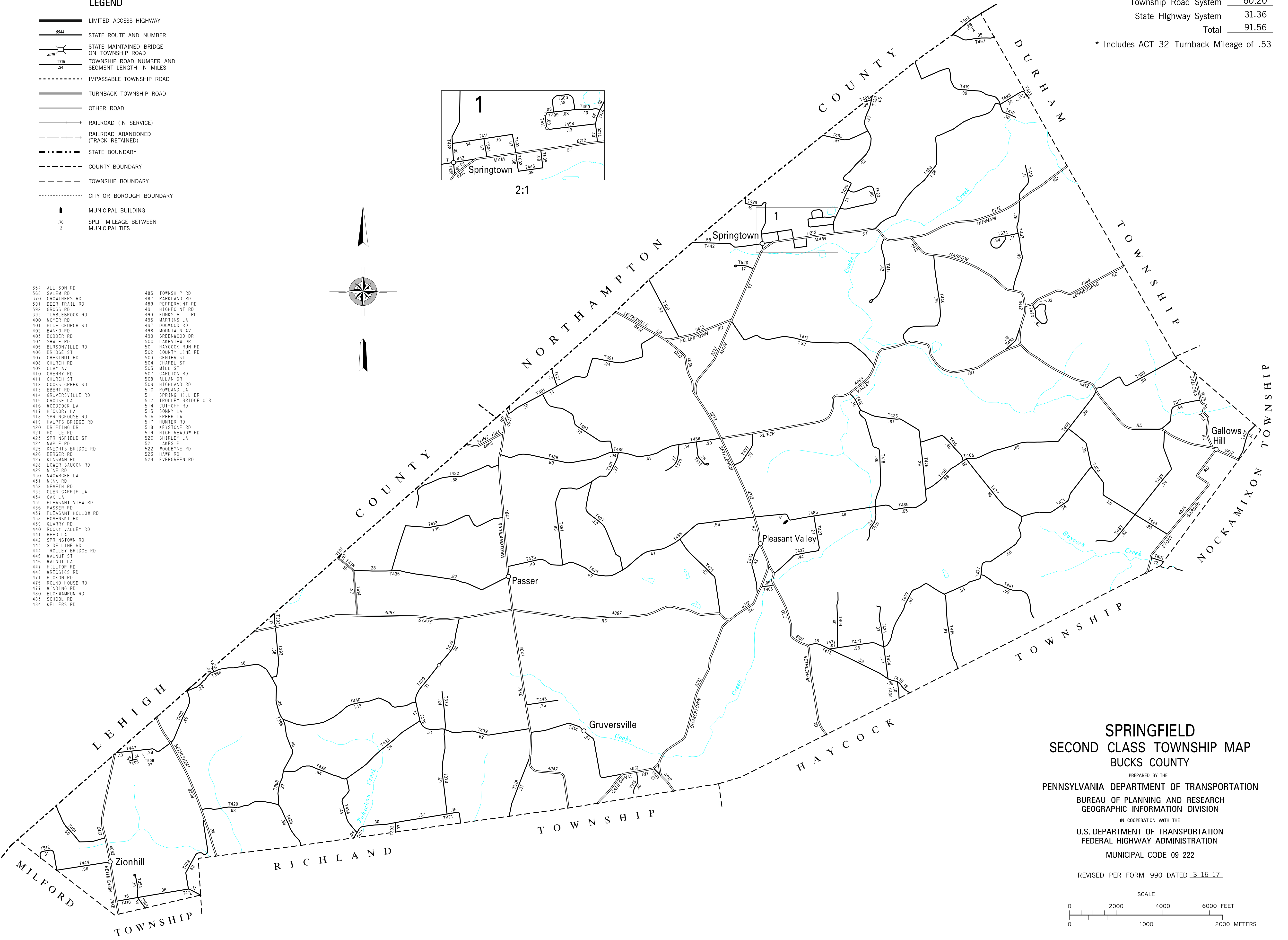

**SPRINGFIELD
 SECOND CLASS TOWNSHIP MAP
 BUCKS COUNTY**

PREPARED BY THE
 PENNSYLVANIA DEPARTMENT OF TRANSPORTATION
 BUREAU OF PLANNING AND RESEARCH
 GEOGRAPHIC INFORMATION DIVISION
 IN COOPERATION WITH THE
 U.S. DEPARTMENT OF TRANSPORTATION
 FEDERAL HIGHWAY ADMINISTRATION
 MUNICIPAL CODE 09 222
 REVISED PER FORM 990 DATED 3-16-17

